

# Terranova Ranch, Inc. 2023 Crop Map

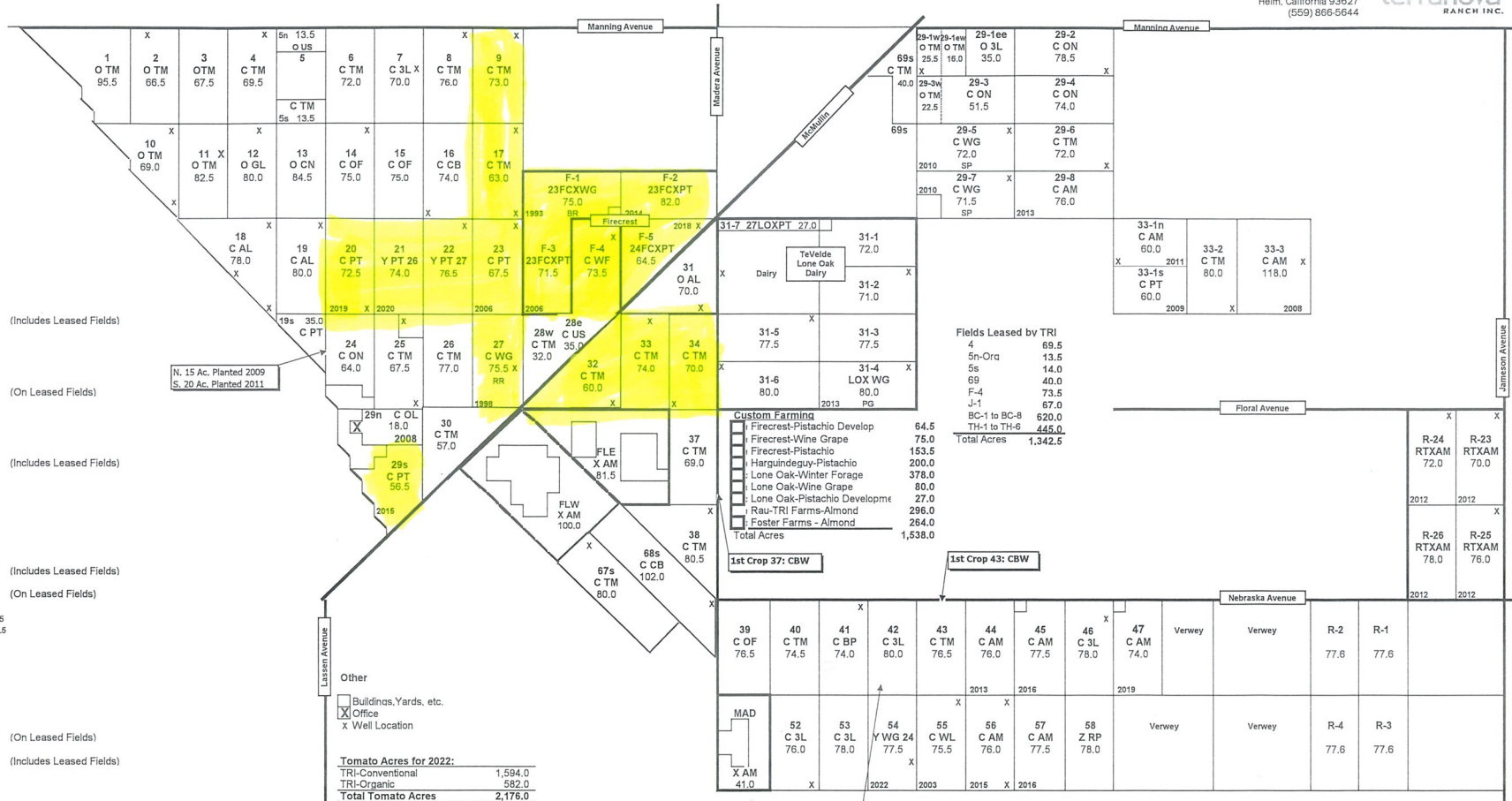

16729 W. Floral Ave. - P.O. Box 130  
Helm, California 93627  
(559) 866-5644



TRI Crop & Acres		
C AL = Alfalfa	412.5	(Includes Leased Fields)
C AM = Almond	635	
C AB = Cabbage	0	
C CB = Carrot, Bolthouse	176	
C BA = Carrot, Bolthouse Winter '23	145.5	
C BV = Carrot, Bolthouse Winter '24	0	
CR = Carrot, Summer '23	160	(On Leased Fields)
C VA = Carrot, Winter '23	0	
C CS = Corn Silage	0	
C GL = Garlic	0	
C OL = Olives	18	
C OF = Onion Fresh	226.5	
C ON = Onion Process	360	(Includes Leased Fields)
C BP = Pepper, Bell	74	
C CH = Pepper, Chili	0	
C PF = Pepper, Fall	0	
C PT = Pistachio	291.5	
C 3L = Seed Lettuce - 3 Star	382	
C 3S = Seed Prod-3 Star	0	
C US = Seed Prod-Universal	35	
C SS = Seed Prod-Caudill	0	(Includes Leased Fields)
C TM = Tomato	1,594.0	
C WL = Walnuts	75.5	(On Leased Fields)
C WF = Winter Forage	279	
C WC = Wine Grape	219	
RR = Rubired	75.5	
SP = Symphony	143.5	
O AL = Organic Alfalfa	70	
O CN = Organic Corn	84.5	
O CS = Organic Corn Silage	0	
O GL = Organic Garlic	80	
O BP = Organic Bell Pepper	0	
O SS = Organic Sd. N. Pacific	0	
O SG = Organic Sudan Grass	0	
O US = Organic Sd. Universal	13.5	(On Leased Fields)
O 3L = Organic Sd. Lettuce-3 Star	35	
O TM = Organic Tomato	582	(Includes Leased Fields)
O Wt = Organic Wheat	0	
Y AM = Develop Almonds	0	
Y PT = Develop Pistachio	150.5	
Y WC = Develop Wine Grapes	77.5	
Z LP = Fallow	66	
Z OP = Organic Fallow	0	
Z RP = Orchard Removal	78	
<b>Total Acres Farmed</b>	<b>6,242.5</b>	