

CALIFORNIA REGIONAL WATER QUALITY CONTROL BOARD
CENTRAL VALLEY REGION
ORDER NO. 75-069
REVISION AND AMENDMENT OF WATER QUALITY CONTROL PLAN (INTERIM)
BY THE ADDITION OF A PROHIBITION OF WASTE DISCHARGE FROM
SEPTIC TANKS OR CESSPOOLS WITHIN
EAST PORTERVILLE AREA
PORTERVILLE, TULARE COUNTY

The California Regional Water Quality Control Board, Central Valley Region, finds:

1. The Board adopted, on 15 June 1971, a Water Quality Control Plan (Interim), Basins 5A, B, C and D (hereafter "Interim Plan").
2. The Interim Plan contains areas where waste discharge from septic tanks and cesspools is prohibited.
3. On 21 March 1975 in the City Hall Council Chambers, 2326 Fresno Street, Fresno, after due public notice, the Regional Board conducted a public hearing at which evidence was received concerning the discharge from failing septic tanks and cesspools.
4. The East Porterville Area encompasses an unincorporated area generally southeast of the City of Porterville, and north of the Tule River. The area occupies the major portions of Sections 31 and 32 and a portion of Section 33 of T21S, R28E, MDB&M; and a portion of Section 36, T21S, R27E, MDB&M. The area is delineated on the attached map. The area has a long history of failing septic tanks.
5. A January 1975 random survey of 245 residences in the East Porterville Area by the Tulare County Health Department found: 1) that seventy four (74) percent of the residents in the area are dependent upon individual water systems; 2) that 26% of 100 sealed individual domestic wells contained excessive coliform bacteria; 3) that a community water system, serving 26% of the surveyed area, had to be disinfected last year; 4) that 22% of those surveyed reported failures within the last five (5) years; and 5) that surfacing sewage was visually observed throughout the area during the period of the survey.
6. Continued installation of septic tanks or cesspools will increase the threat to public health and will further unreasonably impair water quality.

IT IS HEREBY ORDERED THAT:

1. The discharge of waste within the East Porterville Area, Tulare County, as delineated on the attached map, from leaching or percolation systems installed after approval of this amendment by the State Water Resources Control Board is prohibited. An exemption to this prohibition may be granted after presentation by the proposed discharger of geologic and hydrologic evidence that leaching system disposal will not, individually or collectively, result in a pollution or nuisance.
2. The discharge of waste within the East Porterville Area, Tulare County, from leaching or percolation systems is prohibited after 1 January 1979. An exemption to this prohibition may be granted whenever the Regional Board finds that the continued operation of septic tanks, cesspools, or other means of disposal in a particular area will not, individually or collectively, directly, or indirectly, adversely affect water quality.

REVISION AND AMENDMENT OF WATER QUALITY CONTROL PLAN (INTERIM)
BY THE ADDITION OF A PROHIBITION OF WASTE DISCHARGE FROM
SEPTIC TANKS OR CESSPOOLS WITHIN EAST PORTERVILLE AREA,
PORTERVILLE, TULARE COUNTY

- 2 -

3. Chapter VI of the Interim Plan is revised by the addition of this prohibition, upon approval of the State Water Resources Control Board.

I, JAMES A. ROBERTSON, Executive Officer, do hereby certify the foregoing is a full, true, and correct copy of an order adopted by the California Regional Water Quality Control Board, Central Valley Region, on 21 March 1975.



JAMES A. ROBERTSON, Executive Officer

Amended 3/21/75

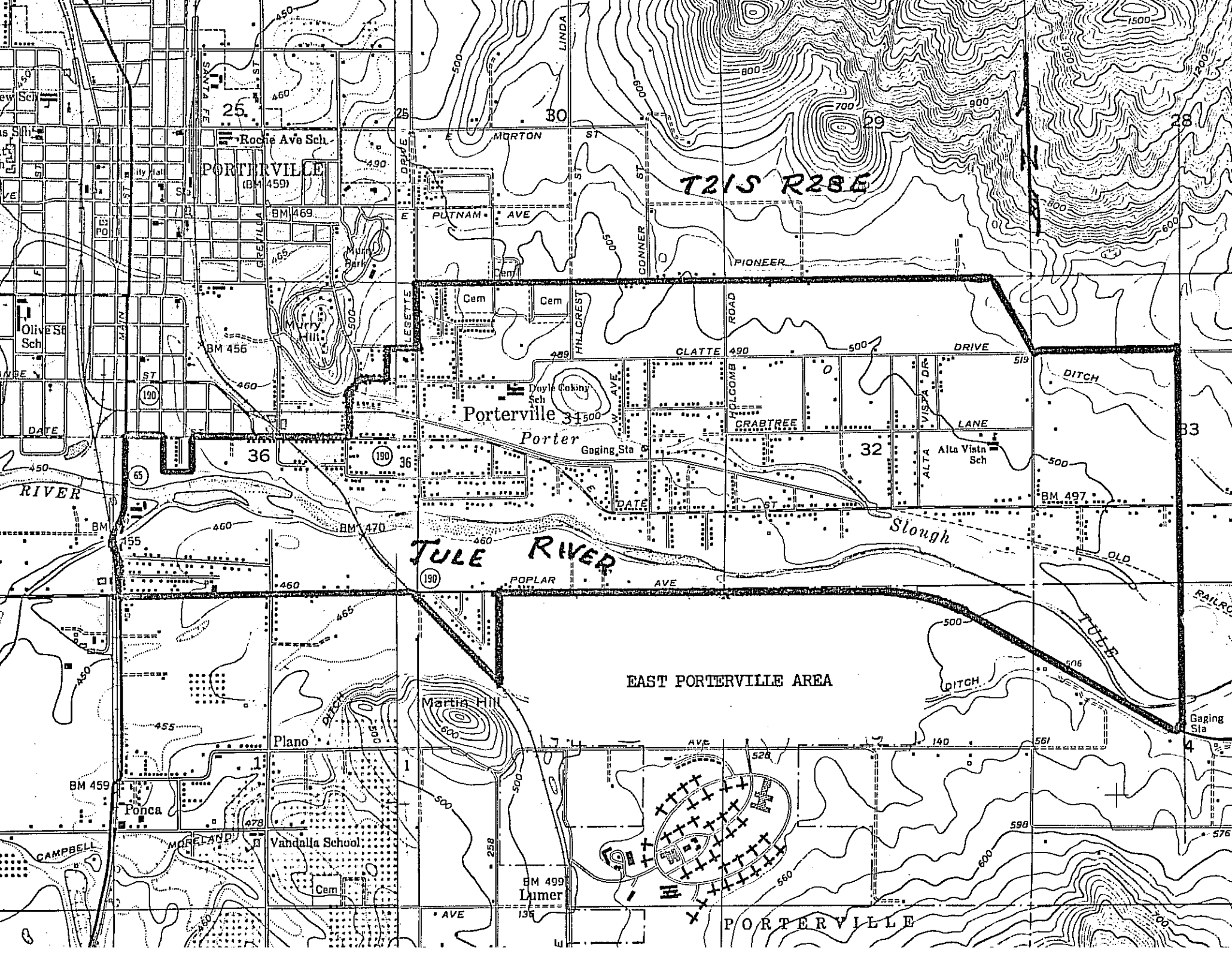

PORTERVILLE
(BM 459)

T215 R28E

Porterville 31
Porter

EAST PORTERVILLE AREA

PORTERVILLE