

CALIFORNIA REGIONAL WATER QUALITY CONTROL BOARD
COLORADO RIVER BASIN REGION

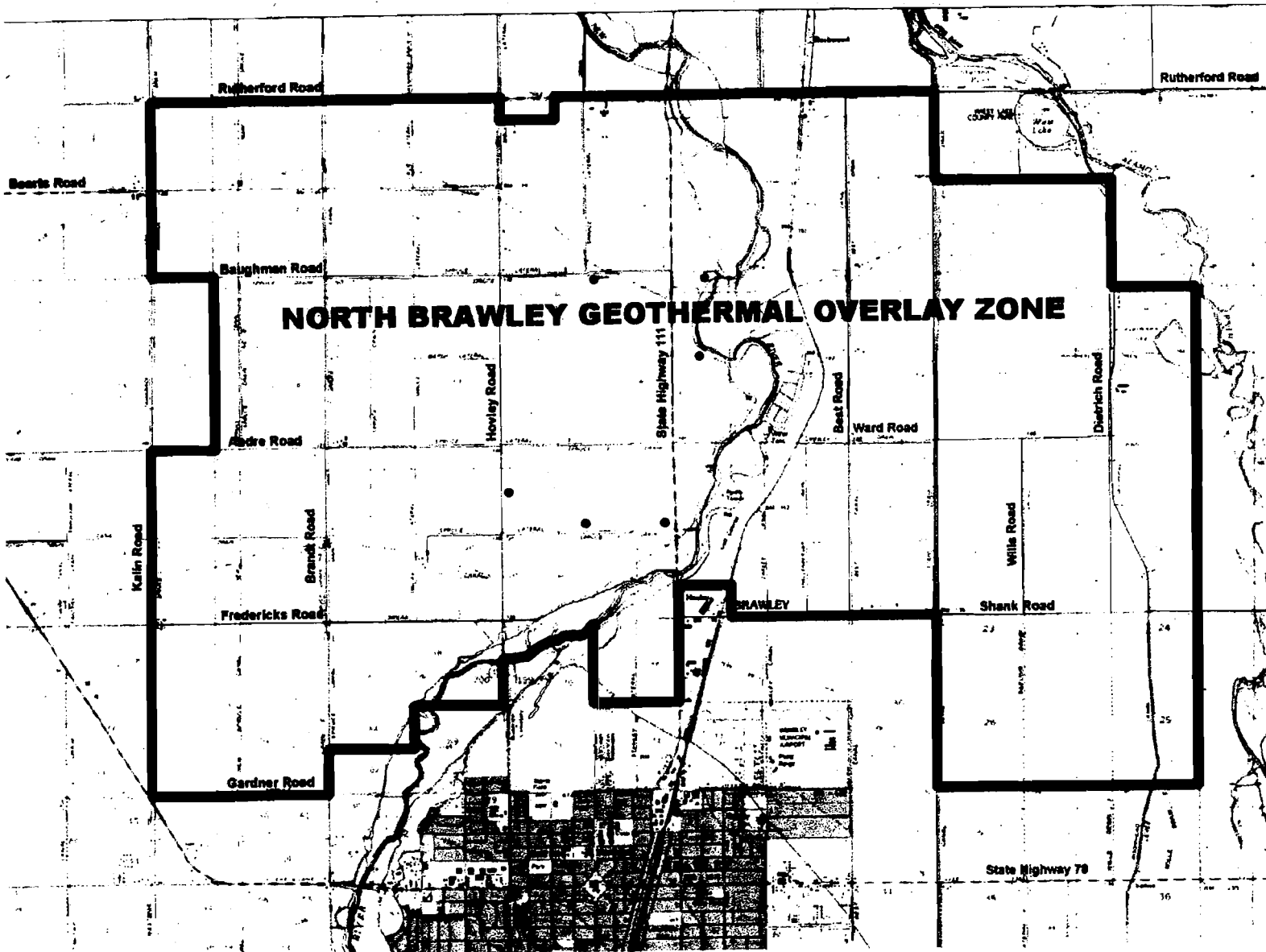

ATTACHMENT A

ORMAT NEVADA INC., OWNER/OPERATOR
NORTH BRAWLEY GEOTHERMAL EXPLORATION PROJECT
WELLFIELD MUD SUMPS
North Brawley Known Geothermal Resource Area (KGRA) - Imperial County
Board Order No. R7-2007-0012

CALIFORNIA REGIONAL WATER QUALITY CONTROL BOARD
COLORADO RIVER BASIN REGION

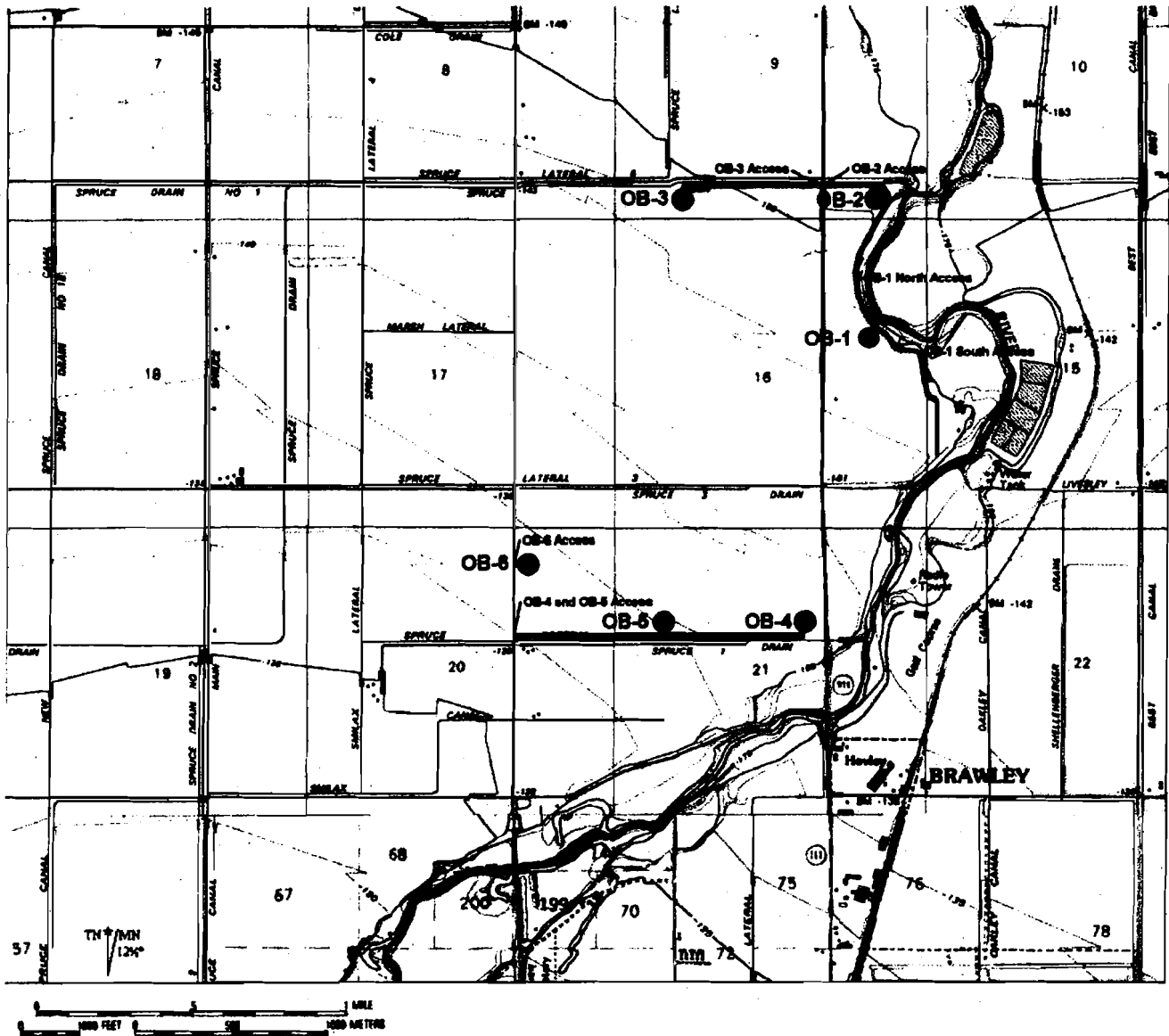

ATTACHMENT B

ORMAT NEVADA INC., OWNER/OPERATOR
NORTH BRAWLEY GEOTHERMAL EXPLORATION PROJECT
WELLFIELD MUD SUMPS
North Brawley Known Geothermal Resource Area (KGRA) - Imperial County
Board Order No. R7-2007-0012

CALIFORNIA REGIONAL WATER QUALITY CONTROL BOARD
COLORADO RIVER BASIN REGION

TYPICAL WELL PAD LAYOUT DIAGRAM
NORTH BRAWLEY GEOTHERMAL EXPLORATION PROJECT

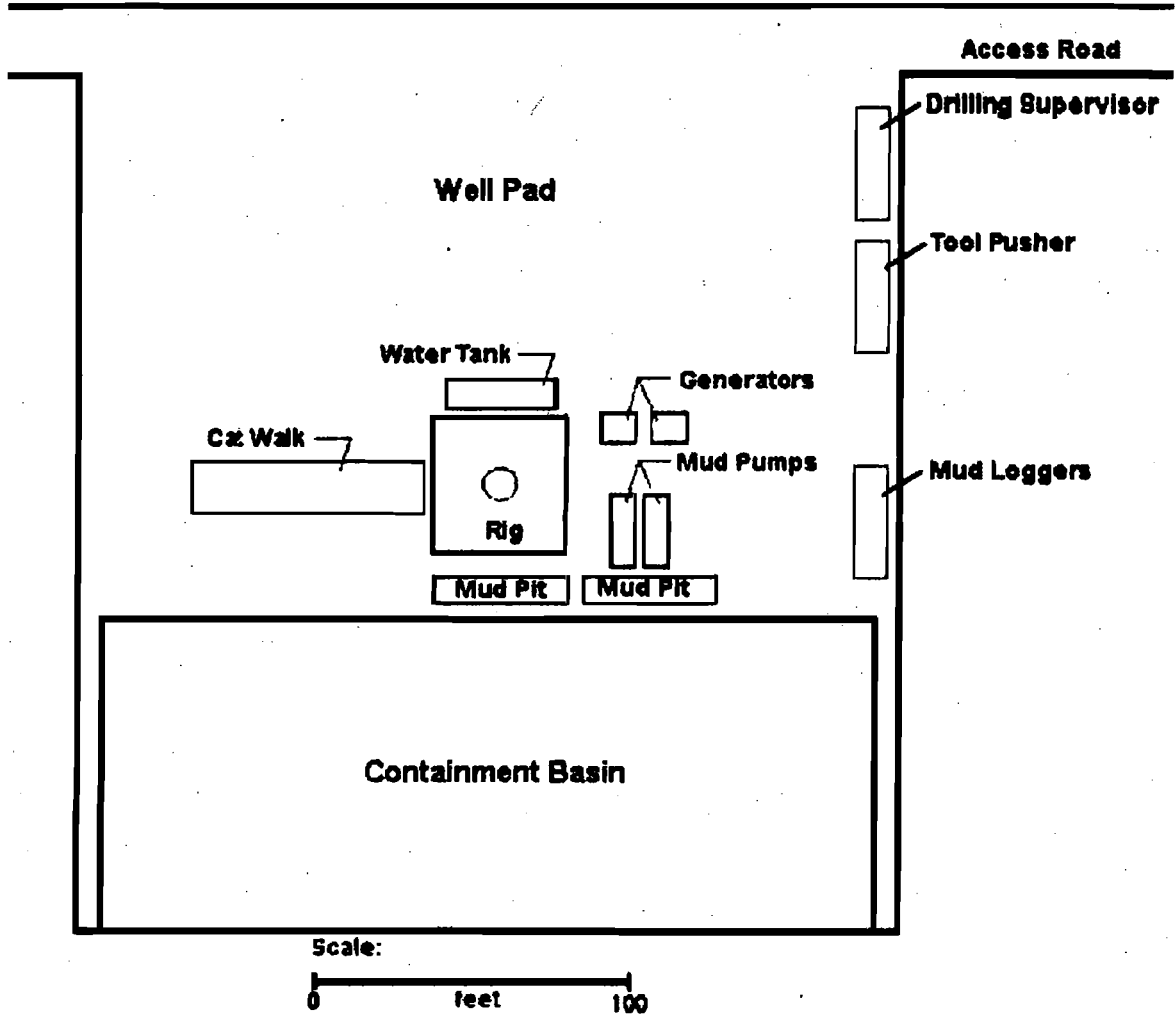

ATTACHMENT C

ORMAT NEVADA INC., OWNER/OPERATOR
NORTH BRAWLEY GEOTHERMAL EXPLORATION PROJECT
WELLFIELD MUD SUMPS
North Brawley Known Geothermal Resource Area (KGRA) - Imperial County
Board Order No. R7-2007-0012

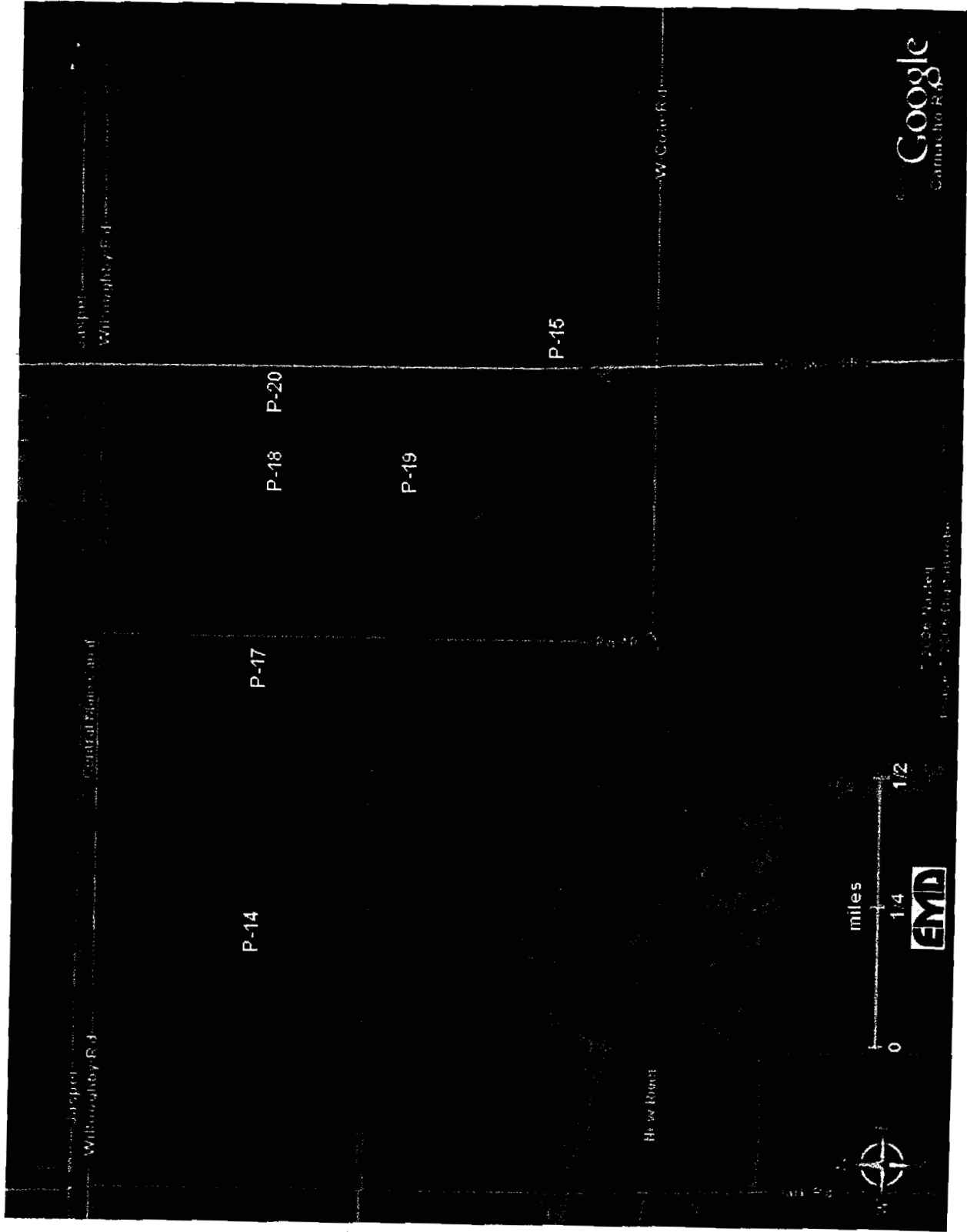

Figure 1 Proposed Exploration Well Sites and Highlighted Access Roads to the Well Sites