

**CALIFORNIA REGIONAL WATER QUALITY CONTROL BOARD
COLORADO RIVER BASIN REGION**

MONITORING AND REPORTING PROGRAM R7-2014-0015 – REVISION 1
FOR
IMPERIAL COUNTY GATEWAY SERVICES AREA, OWNER
PERCWATER, OPERATOR
GATEWAY OF THE AMERICAS WASTEWATER TREATMENT PLANT
East of Calexico - Imperial County

Location of Wastewater Treatment Facilities and Discharges:
Latitude/Longitude: 32° 41' 02"N, 115° 22' 18"W

A. Monitoring

1. This Monitoring and Reporting Program (MRP) describes requirements for monitoring a wastewater system and groundwater quality (when needed). This MRP is issued pursuant to California Water Code (CWC) Section 13267. The Discharger shall not implement any changes to this MRP unless and until a revised MRP is issued by the Executive Officer.
2. Water Code Section 13267 states, in part:

“In conducting an investigation specified in subdivision (a), the regional board may require that any person who has discharged, discharges, or is suspected of having discharged or discharging, or who proposes to discharge waste within its region, or any citizen or domiciliary, or political agency or entity of this state who has discharged, discharges, or is suspected of having discharged or discharging, or who proposes to discharge, waste outside of its region that could affect the quality of waters within its region shall furnish, under penalty of perjury, technical or monitoring program reports which the regional board requires. The burden, including costs, of these reports shall bear a reasonable relationship to the need for the report and the benefits to be obtained from the reports. In requiring those reports, the regional board shall provide the person with a written explanation with regard to the need for the reports, and shall identify the evidence that supports requiring that person to provide the reports.”
3. Water Code Section 13268 states, in part:

“(a) (1) Any person failing or refusing to furnish technical or monitoring program reports as required by subdivision (b) of § 13267, or failing or refusing to furnish a statement of compliance as required by subdivision (b) of Section 13399.2, or falsifying any information provided therein, is guilty of a misdemeanor, and may be liable civilly in accordance with subdivision (b). (b) (1) Civil liability may be administratively imposed by a regional board in accordance with Article 2.5 (commencing with § 13323) of Chapter 5 for a violation of subdivision (a) in an amount which shall not exceed one thousand dollars (\$1,000) for each day in which the violation occurs.”
4. The Discharger owns and operates the wastewater system that is subject to Board Order R7-2014-0015. The reports are necessary to ensure that the Discharger complies with the Order. Pursuant to Water Code Section 13267, the Discharger shall implement the MRP and shall submit the monitoring reports described herein.

5. All samples shall be representative of the volume and nature of the discharge or matrix of material sampled. The time, date, and location of each grab sample shall be recorded on the sample chain of custody form. If composite samples are collected, the basis for sampling (time or flow weighted) shall be approved by Colorado River Basin Water Board staff.
6. Field test instruments (such as those used to test pH, dissolved oxygen, and electrical conductivity) may be used provided that:
 - a. The user is trained in proper use and maintenance of the instruments;
 - b. The instruments are field calibrated prior to monitoring events at the frequency recommended by the manufacturer;
 - c. Instruments are serviced and/or calibrated by the manufacturer at the recommended frequency; and
 - d. Field calibration reports are submitted as described in the “Reporting” section of this MRP.
7. The collection, preservation and holding times of all samples shall be in accordance with United States Environmental Protection Agency (USEPA) approved procedures. Unless otherwise approved by the Regional Water Board’s Executive Officer, all analyses shall be conducted by a laboratory certified by the State Department of Health Services. All analyses shall be conducted in accordance with the latest edition of the “Guidelines Establishing Test Procedures for Analysis of Pollutants” (40 CFR Part 136), promulgated by the USEPA.
8. All monitoring instruments and devices used by the discharger to fulfill the prescribed monitoring program shall be properly maintained and calibrated as necessary to ensure their continued accuracy. In the event that continuous monitoring equipment is out of service for period greater than 24-hours, the Discharger shall obtain representative grab samples each day the equipment is out of service. The Discharger shall correct the cause(s) of failure of the continuous monitoring equipment as soon as practicable. The Discharger shall report the period(s) during which the equipment was out of service and if the problem has not been corrected, shall identify the steps which the Discharger is taking or proposes to take to bring the equipment back into service and the schedule for these actions.
9. Samples shall be collected at the location specified in the WDRs. If no location is specified, sampling shall be conducted at the most representative sampling point available.
10. Given the monitoring frequency prescribed by MRP R7-2014-0015, if only one sample is available for a given reporting period, compliance with monthly average, or weekly average Discharge Specifications, will be determined from that sample.
11. The Discharger shall comply with the following:
 - a. Samples and measurements taken for the purpose of monitoring shall be representative of the monitored activity.

- b. The Discharger shall retain records of all monitoring information, copies of all reports required by this Board Order, and records of all data used to complete the application for this Board Order, for a period of at least 5 years from the date of the sample, measurement, report or application.
 - c. Records of monitoring information shall include:
 - i. The date, exact place, and time of sampling or measurements.
 - ii. The individual(s) who performed the sampling or measurements.
 - iii. The date(s) analyses were performed.
 - iv. The individual(s) who performed the analyses.
 - v. The analytical techniques or methods used; and
 - vi. The results of such analyses.
12. If the facility is not in operation, or there is no discharge during a required reporting period, the Discharger shall forward a letter to the Regional Water Board indicating that there has been no activity during the required reporting period.

Influent Monitoring

13. Influent to the WWTP shall be monitored according to the following schedule:

<u>Constituent</u>	<u>Units</u>	<u>Type of Sample</u>	<u>Monitoring Frequency</u>	<u>Reporting Frequency</u>
Flow	MGD ¹	Meter Reading	Daily	Monthly
20°C BOD ₅ ²	mg/L ³	24-Hr. Composite	Monthly	Monthly
Total Suspended Solids	mg/L	24-Hr. Composite	Monthly	Monthly

WWTP Effluent Monitoring

14. Effluent from the WWTP shall be monitored according to the following schedule:

<u>Constituent</u>	<u>Units</u>	<u>Type of Sample</u>	<u>Monitoring Frequency</u>	<u>Reporting Frequency</u>
Hydrogen Ion (pH)	s.u. ⁴	Grab at Peak Flow	Weekly	Monthly
Dissolved Oxygen ⁵	mg/L	Grab at Peak Flow	Weekly	Monthly
20°C BOD ₅	mg/L	24 Hr. Composite	Monthly	Monthly

¹ Million Gallons per Day

² 5-day Biochemical Oxygen Demand at 20 degrees Celsius

³ Milligrams per Liter

⁴ Standard units

⁵ Dissolved Oxygen shall be monitored at the upper one foot layer of the evaporation/percolation ponds

<u>Constituent</u>	<u>Units</u>	<u>Type of Sample</u>	<u>Monitoring Frequency</u>	<u>Reporting Frequency</u>
Total Suspended Solids	mg/L	24 Hr. Composite	Monthly	Monthly
Settleable Solids	ml/L ⁶	24 Hr. Composite	Monthly	Monthly
Total Dissolved Solids	mg/L	Grab	Monthly	Monthly
Nitrate (As NO ₃)	mg/L	Grab	Monthly	Monthly
Total Nitrogen	mg/L	Grab	Monthly	Monthly
Ammonia	mg/L	Grab	Monthly	Monthly
Phosphate (As PO ₄)	mg/L	Grab	Monthly	Monthly
Total Coliforms	MPN/100mL ⁷	Grab	Monthly	Monthly
Fecal Coliforms	MPN/100mL	Grab	Monthly	Monthly
Volatile Organics (EPA Methods 601, 602)	µg/L ⁸	Grab	Annually	Annually
Pesticides (EPA Method 608)	µg/L	Grab	Annually	Annually

Water Supply to the Community

15. The domestic water supply shall be monitored according to the following schedule:

<u>Constituent</u>	<u>Units</u>	<u>Type of Sample</u>	<u>Monitoring Frequency</u>	<u>Reporting Frequency</u>
TDS	mg/L	Grab	Monthly	Monthly

Groundwater Monitoring

16. The Discharger shall monitor groundwater wells MW-1, 2, 3 and 4 according to the following schedule:

⁶ Milliliters per liter

⁷ Most Probable Number per 100 milliliters

⁸ Micrograms per liter

<u>Constituent</u>	<u>Units</u>	<u>Type of Sample</u>	<u>Monitoring Frequency</u>	<u>Reporting Frequency</u>
Depth to Groundwater (bgs) ⁹	ft	measurement	Monthly ¹⁰	Monthly ⁹
Total Dissolved Solids	mg/L	Grab	Monthly ⁹	Monthly ⁹
Total Nitrogen	mg/L	Grab	Monthly ⁹	Monthly ⁹
Nitrate as N	mg/L	Grab	Monthly ⁹	Monthly ⁹
pH	mg/L	Grab	Monthly ⁹	Monthly ⁹
Total Coliforms	MPN/100 mL ¹¹	Grab	Monthly ⁹	Monthly ⁹
Fecal Coliforms	MPN/100mL	Grab	Monthly	Monthly
General Minerals ¹²	mg/L	Grab	Annually	Annually
VOCs	µg/L	Grab	Annually	Annually

Sludge Monitoring

17. The Discharger shall report annually on the quantity, location and method of disposal of all sludge and similar solid materials being produced at the WWTP. If no sludge is disposed of during the year being reported, the Discharger shall state “No Sludge Removed” in the annual monitoring report. Sludge that is generated at the WWTP shall be sampled and analyzed for the following:

<u>Constituent</u>	<u>Units</u>	<u>Type of Sample</u>	<u>Monitoring Frequency</u>	<u>Reporting Frequency</u>
Arsenic	mg/kg ¹³	Composite	Annually	Annually
Cadmium	mg/kg	Composite	Annually	Annually
Copper	mg/kg	Composite	Annually	Annually
Lead	mg/kg	Composite	Annually	Annually
Mercury	mg/kg	Composite	Annually	Annually
Molybdenum	mg/kg	Composite	Annually	Annually
Nickel	mg/kg	Composite	Annually	Annually
Selenium	mg/kg	Composite	Annually	Annually
Zinc	mg/kg	Composite	Annually	Annually

⁹ Below ground surface

¹⁰ The Discharger may request to have the monitoring and reporting frequency revised after 24 months of continuous monitoring

¹¹ Most Probable Number per 100 milliliters

¹² At a minimum, Standard Minerals shall include: calcium, chloride, fluoride, iron, magnesium, manganese, nitrate, potassium, sodium, sulfate, barium, total alkalinity, and hardness

¹³ Milligrams per kilogram

<u>Constituent</u>	<u>Units</u>	<u>Type of Sample</u>	<u>Monitoring Frequency</u>	<u>Reporting Frequency</u>
Fecal Coliform	MPN/gram ¹⁴	Composite	Annually	Annually

B. Reporting

1. The Discharger shall inspect and document any operation/maintenance problems by inspecting each unit process. In addition, calibration of flow meters and equipment shall be performed in a timely manner and documented. Operation and Maintenance reports shall be submitted to the Colorado River Basin Water Board Office annually.
2. The Discharger shall arrange the data in Self-Monitoring Reports (SMRs) in tabular form so that the specified information is readily discernible. The data shall be summarized in such a manner as to clearly illustrate whether the facility is operating in compliance with WDRs. Where appropriate, the Discharger shall include supporting calculations (e.g., for monthly averages).
3. The results of any analysis taken, more frequently than required at the locations specified in this MRP shall be reported to the Colorado River Basin Water Board.
4. SMRs shall be certified under penalty of perjury to be true and correct, and shall contain the required information at the frequency designated in this MRP.
5. Each Report shall contain the following statement:

"I declare under the penalty of law that I have personally examined and am familiar with the information submitted in this document, and that based on my inquiry of those individuals immediately responsible for obtaining the information, I believe that the information is true, accurate, and complete. I am aware that there are significant penalties for submitting false information, including the possibility of a fine and imprisonment for knowing violations".
6. The SMRs, and other information requested by the Colorado River Basin Water Board, shall be signed by a principal executive officer or ranking elected official.
7. A duly authorized representative of the Discharger may sign the documents if:
 - a. The authorization is made in writing by the person described above;
 - b. The authorization specified an individual or person having responsibility for the overall operation of the regulated disposal system; and
 - c. The written authorization is submitted to the Colorado River Basin Water Board's Executive Officer.
8. The Discharger shall report any failure in the facility (wastewater treatment plant, and collection and disposal systems). The incident shall be reported immediately to the Colorado River Basin Water Board Executive Officer as soon as:

¹⁴ Most Probable Number per gram

- a. The Discharger has knowledge of the discharge,
- b. Notification is possible, and
- b. Notification will not substantially impede cleanup or other emergency measures.

Results of analyses performed shall be provided within 15 days of sample collection.

- 9. The Discharger shall attach a cover letter to the SMRs. The information contained in the cover letter shall clearly identify violations of the WDRs, discuss corrective actions taken or planned and the proposed time schedule of corrective actions. Identified violations should include a description of the requirement that was violated and a description of the violation.
- 10. Daily, weekly and monthly monitoring shall be submitted with the monthly monitoring report to the Colorado River Basin Water Board by the first day of the second month from end of monitoring period (i.e., January SMR shall be submitted by March 1). Annual reports shall be submitted by February 1 of each year.
- 11. The Discharger shall submit technical, monitoring and all documents that are normally mailed by the Discharger, such as regulatory documents, submissions, materials, data, and correspondence electronically. All information required to be submitted in accordance to this Board Order must be emailed prior to the regulatory due date. To accomplish electronic submittal of documents the Discharger shall convert the signed original report to Portable Document Format (PDF), other appropriate Microsoft application, such as Excel documents may also be emailed. Email all the documents to RB7-wdrs_paperless@waterboards.ca.gov. Documents that cannot otherwise be emailed should be transferred to a disk and/or sent hard copy via mail, to:

California Regional Water Quality Control Board
Colorado River Basin Region
73-720 Fred Waring, Suite 100
Palm Desert, CA 92260

ROBERT PERDUE
Executive Officer

Date

**CALIFORNIA REGIONAL WATER QUALITY CONTROL BOARD
COLORADO RIVER BASIN REGION**

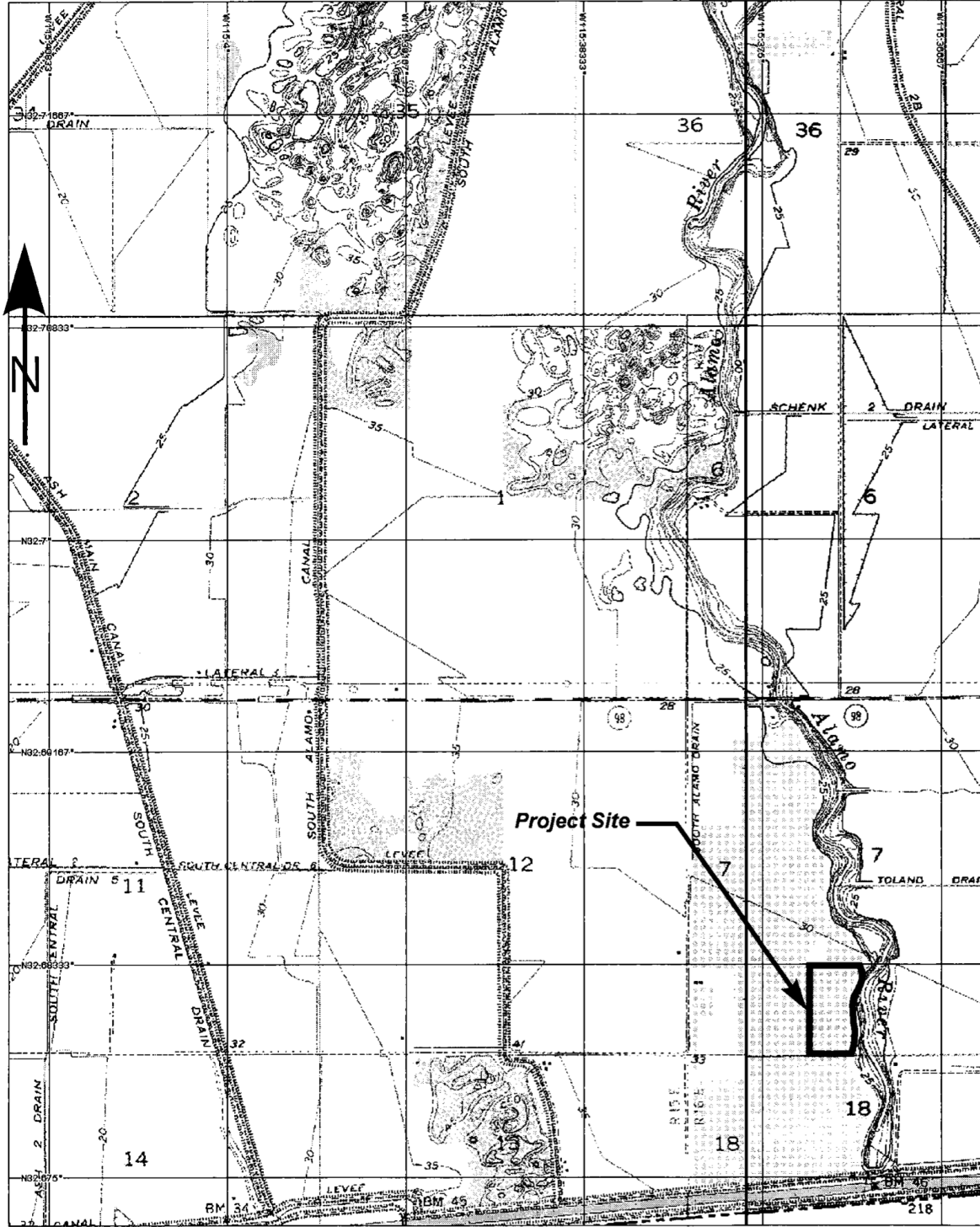

3-D TopoQuads Copyright © 1999 DeLorme Yarmouth, ME 04096 Source Data: USGS 1" = 60 ft Scale: 1:22,400 Detail: 13-2 Datum: WGS84

IMPERIAL COUNTY GATEWAY SERVICES AREA, OWNER
PERCWATER, OPERATOR
MUNICIPAL WASTEWATER TREATMENT PLANT
 East of Calexico - Imperial County
 Discharge Location: 32° 41' 02"N, 115° 22' 18"W

**CALIFORNIA REGIONAL WATER QUALITY CONTROL BOARD
COLORADO RIVER BASIN REGION**

