



Del Mar Analytical

2852 Alton Ave., Irvine, CA 92608 (949) 261-1022 FAX (949) 261-1228
 1014 E. Coldby Dr., Suite A, Colton, CA 92324 (909) 370-4667 FAX (909) 370-1046
 7277 Hayvenhurst, Suite B-12, Van Nuys, CA 91406 (818) 779-1844 FAX (818) 779-1843
 9484 Chesapeake Dr., Suite B05, San Diego, CA 92123 (858) 505-8598 FAX (858) 505-9589
 9830 South 51st St., Suite B-120, Phoenix, AZ 85044 (480) 785-0043 FAX (480) 785-0861

Environ-Irvine
 2010 Main Street, 9th Floor
 Irvine, CA 92614
 Attention: Bitu Tabatabai

Project ID: Valley Alhambra
 04-9065A
 Report Number: IKF0951

Sampled: 06/22/01
 Received: 06/22/01

METHOD BLANK/QC DATA

VOLATILE ORGANICS by GC/MS (EPA 5030B/8260B)

Analyte	Result	Reporting Limit	Units	Spike Level	Source Result	%REC %REC	RPD Limits RPD	RPD Limit	Data Qualifiers
Batch: 11F2825 Extracted: 06/28/01									
Blank Analyzed: 06/28/01 (11F2825-BLK1)									
Benzene	ND	2.0	ug/kg						
Bromobenzene	ND	5.0	ug/kg						
Bromochloromethane	ND	5.0	ug/kg						
Bromodichloromethane	ND	2.0	ug/kg						
Bromoform	ND	5.0	ug/kg						
Bromomethane	ND	5.0	ug/kg						
n-Butylbenzene	ND	5.0	ug/kg						
sec-Butylbenzene	ND	5.0	ug/kg						
tert-Butylbenzene	ND	5.0	ug/kg						
Carbon tetrachloride	ND	5.0	ug/kg						
Chlorobenzene	ND	2.0	ug/kg						
Chloroethane	ND	5.0	ug/kg						
Chloroform	ND	2.0	ug/kg						
Chloromethane	ND	5.0	ug/kg						
2-Chlorotoluene	ND	5.0	ug/kg						
4-Chlorotoluene	ND	5.0	ug/kg						
Dibromochloromethane	ND	2.0	ug/kg						
1,2-Dibromo-3-chloropropane	ND	5.0	ug/kg						
1,2-Dibromoethane (EDB)	ND	2.0	ug/kg						
Dibromomethane	ND	2.0	ug/kg						
1,2-Dichlorobenzene	ND	2.0	ug/kg						
1,3-Dichlorobenzene	ND	2.0	ug/kg						
1,4-Dichlorobenzene	ND	2.0	ug/kg						
Dichlorodifluoromethane	ND	5.0	ug/kg						
1,1-Dichloroethane	ND	2.0	ug/kg						
1,2-Dichloroethane	ND	2.0	ug/kg						
1,1-Dichloroethene	ND	5.0	ug/kg						
cis-1,2-Dichloroethene	ND	2.0	ug/kg						
trans-1,2-Dichloroethene	ND	2.0	ug/kg						
1,2-Dichloropropane	ND	2.0	ug/kg						
1,3-Dichloropropane	ND	2.0	ug/kg						
2,2-Dichloropropane	ND	2.0	ug/kg						
1,1-Dichloropropene	ND	2.0	ug/kg						
cis-1,3-Dichloropropene	ND	2.0	ug/kg						
trans-1,3-Dichloropropene	ND	2.0	ug/kg						
Ethylbenzene	ND	2.0	ug/kg						

Del Mar Analytical, Irvine
 Patty Mata
 Project Manager

The results pertain only to the samples tested in the laboratory. This report shall not be reproduced, except in full, without written permission from Del Mar Analytical.



Del Mar Analytical

2852 Alton Ave., Irvine, CA 92606 (949) 261-1022 FAX (949) 261-1228
 1014 E. Coldby Dr., Suite A, Colton, CA 92324 (909) 370-4687 FAX (909) 370-1046
 7277 Hayvenhurst, Suite B-12, Van Nuys, CA 91406 (818) 779-1844 FAX (818) 779-1843
 9484 Chesapeake Dr., Suite 805, San Diego, CA 92123 (858) 505-8586 FAX (858) 505-9589
 9830 South 51st St., Suite B-120, Phoenix, AZ 85044 (480) 785-0043 FAX (480) 785-0851

Environ-Irvine 2010 Main Street, 9th Floor Irvine, CA 92614 Attention: Bitu Tabatabai	Project ID: Valley Alhambra 04-9065A Report Number: IKF0951	Sampled: 06/22/01 Received: 06/22/01
--	---	---

METHOD BLANK/OC DATA

VOLATILE ORGANICS by GC/MS (EPA 5030B/8260B)

Analyte	Result	Reporting Limit	Units	Spike Level	Source Result	%REC %REC Limits	RPD RPD	Data Qualifiers
Batch: I1F2825 Extracted: 06/28/01								
Blank Analyzed: 06/28/01 (I1F2825-BLK1)								
Hexachlorobutadiene	ND	5.0	ug/kg					
Isopropylbenzene	ND	2.0	ug/kg					
p-Isopropyltoluene	ND	2.0	ug/kg					
Methylene chloride	ND	20	ug/kg					
Naphthalene	ND	5.0	ug/kg					
n-Propylbenzene	ND	2.0	ug/kg					
Styrene	ND	2.0	ug/kg					
1,1,1,2-Tetrachloroethane	ND	5.0	ug/kg					
1,1,2,2-Tetrachloroethane	ND	2.0	ug/kg					
Tetrachloroethene	ND	2.0	ug/kg					
Toluene	ND	2.0	ug/kg					
1,2,3-Trichlorobenzene	ND	5.0	ug/kg					
1,2,4-Trichlorobenzene	ND	5.0	ug/kg					
1,1,1-Trichloroethane	ND	2.0	ug/kg					
1,1,2-Trichloroethane	ND	2.0	ug/kg					
Trichloroethene	ND	2.0	ug/kg					
Trichlorofluoromethane	ND	5.0	ug/kg					
1,2,3-Trichloropropane	ND	10	ug/kg					
1,2,4-Trimethylbenzene	ND	2.0	ug/kg					
1,3,5-Trimethylbenzene	ND	2.0	ug/kg					
Vinyl chloride	ND	5.0	ug/kg					
o-Xylene	ND	2.0	ug/kg					
m,p-Xylenes	ND	2.0	ug/kg					
Surrogate: Dibromofluoromethane	52.9		ug/kg	50.0		106	85-125	
Surrogate: Toluene-d8	51.1		ug/kg	50.0		102	80-120	
Surrogate: 4-Bromofluorobenzene	51.5		ug/kg	50.0		103	80-120	
LCS Analyzed: 06/28/01 (I1F2825-BS1)								
Benzene	48.4	2.0	ug/kg	50.0		96.8	75-130	
Bromobenzene	49.9	5.0	ug/kg	50.0		99.8	75-130	
Bromochloromethane	50.2	5.0	ug/kg	50.0		100	70-140	
Bromodichloromethane	54.1	2.0	ug/kg	50.0		108	75-135	
Bromoform	52.8	5.0	ug/kg	50.0		106	55-130	
Bromomethane	44.8	5.0	ug/kg	50.0		89.6	65-140	
n-Butylbenzene	50.0	5.0	ug/kg	50.0		100	75-130	
sec-Butylbenzene	49.6	5.0	ug/kg	50.0		99.2	80-135	
tert-Butylbenzene	47.0	5.0	ug/kg	50.0		94.0	75-130	

Del Mar Analytical, Irvine
 Patty Mata
 Project Manager

The results pertain only to the samples tested in the laboratory. This report shall not be reproduced, except in full, without written permission from Del Mar Analytical.



Del Mar Analytical

2852 Alton Ave., Irvine, CA 92606 (949) 261-1022 FAX (949) 261-1228
 1014 E. Coldby Dr., Suite A, Colton, CA 92324 (909) 370-4887 FAX (909) 370-1048
 7277 Heyvenhurst, Suite B-12, Van Nuys, CA 91406 (818) 779-1844 FAX (818) 779-1843
 9484 Chesapeake Dr., Suite 805, San Diego, CA 92123 (858) 505-8596 FAX (858) 505-9589
 9830 South 51st St., Suite B-120, Phoenix, AZ 85044 (480) 785-0043 FAX (480) 785-0851

Environ-Irvine
 2010 Main Street, 9th Floor
 Irvine, CA 92614
 Attention: Bitu Tabatabai

Project ID: Valley Alhambra
 04-9065A
 Report Number: IKF0951

Sampled: 06/22/01
 Received: 06/22/01

METHOD BLANK/OC DATA

VOLATILE ORGANICS by GC/MS (EPA 5030B/8260B)

Analyte	Result	Reporting Limit	Units	Spike Level	Source Result	%REC %REC	Limit	RPD RPD	RPD Limit	Data Qualifiers
<u>Batch: I1F2825 Extracted: 06/28/01</u>										
<u>LCS Analyzed: 06/28/01 (I1F2825-BS1)</u>										
Carbon tetrachloride	49.8	5.0	ug/kg	50.0		99.6	70-160			
Chlorobenzene	51.8	2.0	ug/kg	50.0		104	75-130			
Chloroethane	48.5	5.0	ug/kg	50.0		97.0	65-135			
Chloroform	50.2	2.0	ug/kg	50.0		100	75-130			
Chloromethane	44.8	5.0	ug/kg	50.0		89.6	45-130			
2-Chlorotoluene	48.4	5.0	ug/kg	50.0		96.8	75-130			
4-Chlorotoluene	49.5	5.0	ug/kg	50.0		99.0	80-130			
Dibromochloromethane	51.9	2.0	ug/kg	50.0		104	70-140			
1,2-Dibromo-3-chloropropane	48.0	5.0	ug/kg	50.0		96.0	50-145			
1,2-Dibromoethane (EDB)	55.5	2.0	ug/kg	50.0		111	60-145			
Dibromomethane	51.6	2.0	ug/kg	50.0		103	65-135			
1,2-Dichlorobenzene	46.7	2.0	ug/kg	50.0		93.4	75-130			
1,3-Dichlorobenzene	47.4	2.0	ug/kg	50.0		94.8	75-130			
1,4-Dichlorobenzene	46.2	2.0	ug/kg	50.0		92.4	80-125			
Dichlorodifluoromethane	45.6	5.0	ug/kg	50.0		91.2	10-140			
1,1-Dichloroethane	50.5	2.0	ug/kg	50.0		101	75-135			
1,2-Dichloroethane	49.2	2.0	ug/kg	50.0		98.4	65-140			
1,1-Dichloroethene	50.7	5.0	ug/kg	50.0		101	70-145			
cis-1,2-Dichloroethene	48.0	2.0	ug/kg	50.0		96.0	70-130			
trans-1,2-Dichloroethene	50.4	2.0	ug/kg	50.0		101	75-140			
1,2-Dichloropropane	50.6	2.0	ug/kg	50.0		101	75-130			
1,3-Dichloropropane	55.9	2.0	ug/kg	50.0		112	65-140			
2,2-Dichloropropane	44.2	2.0	ug/kg	50.0		88.4	75-150			
1,1-Dichloropropene	47.2	2.0	ug/kg	50.0		94.4	75-140			
cis-1,3-Dichloropropene	52.8	2.0	ug/kg	50.0		106	65-135			
trans-1,3-Dichloropropene	53.6	2.0	ug/kg	50.0		107	65-140			
Ethylbenzene	50.7	2.0	ug/kg	50.0		101	75-135			
Hexachlorobutadiene	47.5	5.0	ug/kg	50.0		95.0	75-150			
Isopropylbenzene	49.1	2.0	ug/kg	50.0		98.2	80-135			
p-Isopropyltoluene	45.6	2.0	ug/kg	50.0		91.2	75-130			
Methylene chloride	50.1	2.0	ug/kg	50.0		100	70-125			
Naphthalene	45.0	5.0	ug/kg	50.0		90.0	50-145			
n-Propylbenzene	51.0	2.0	ug/kg	50.0		102	80-135			
Styrene	52.6	2.0	ug/kg	50.0		105	75-140			
1,1,1,2-Tetrachloroethane	52.7	5.0	ug/kg	50.0		105	75-135			
1,1,2,2-Tetrachloroethane	55.7	2.0	ug/kg	50.0		111	70-135			

Del Mar Analytical, Irvine
 Patty Mata
 Project Manager

The results pertain only to the samples tested in the laboratory. This report shall not be reproduced, except in full, without written permission from Del Mar Analytical.



Del Mar Analytical

2852 Alton Ave., Irvine, CA 92608 (949) 261-1022 FAX (949) 261-1228
 1014 E. Coldby Dr., Suite A, Colton, CA 92324 (909) 370-4667 FAX (909) 370-1046
 7277 Hayvenhurst, Suite B-12, Van Nuys, CA 91406 (818) 779-1844 FAX (818) 779-1843
 9484 Chesapeake Dr., Suite 805, San Diego, CA 92123 (858) 505-8596 FAX (858) 505-8689
 9830 South 51st St., Suite B-120, Phoenix, AZ 85044 (480) 785-0043 FAX (480) 785-0851

Environ-Irvine 2010 Main Street, 9th Floor Irvine, CA 92614 Attention: Bitu Tabatabai	Project ID: Valley Alhambra 04-9065A Report Number: IKF0951	Sampled: 06/22/01 Received: 06/22/01
--	---	---

METHOD-BLANK/OC DATA

VOLATILE ORGANICS by GC/MS (EPA 5030B/8260B)

Analyte	Result	Reporting Limit	Units	Spike Level	Source Result	%REC %REC Limits	RPD RPD	Data Qualifiers
Batch: I1F2825 Extracted: 06/28/01								
LCS Analyzed: 06/28/01 (I1F2825-BS1)								
Tetrachloroethene	53.5	2.0	ug/kg	50.0	107	75-130		
Toluene	47.2	2.0	ug/kg	50.0	94.4	75-130		
1,2,3-Trichlorobenzene	45.6	5.0	ug/kg	50.0	91.2	50-140		
1,2,4-Trichlorobenzene	48.0	5.0	ug/kg	50.0	96.0	70-130		
1,1,1-Trichloroethane	48.3	2.0	ug/kg	50.0	96.6	75-140		
1,1,2-Trichloroethane	52.0	2.0	ug/kg	50.0	104	65-130		
Trichloroethene	47.3	2.0	ug/kg	50.0	94.6	75-130		
Trichlorofluoromethane	55.7	5.0	ug/kg	50.0	111	55-145		
1,2,3-Trichloropropane	53.2	10	ug/kg	50.0	106	60-140		
1,2,4-Trimethylbenzene	50.5	2.0	ug/kg	50.0	101	80-130		
1,3,5-Trimethylbenzene	50.7	2.0	ug/kg	50.0	101	80-135		
Vinyl chloride	44.3	5.0	ug/kg	50.0	88.6	45-140		
o-Xylene	49.8	2.0	ug/kg	50.0	99.6	75-130		
m,p-Xylenes	100	2.0	ug/kg	100	100	75-135		
Surrogate: Dibromofluoromethane	53.3		ug/kg	50.0	107	85-125		
Surrogate: Toluene-d8	51.0		ug/kg	50.0	102	80-120		
Surrogate: 4-Bromofluorobenzene	52.1		ug/kg	50.0	104	80-120		

Matrix Spike Analyzed: 06/28/01 (I1F2825-MS1)				Source: IKF0951-01				
Analyte	Result	Reporting Limit	Units	Spike Level	Source Result	%REC %REC Limits	RPD RPD	Data Qualifiers
Benzene	46.5	2.0	ug/kg	50.0	ND	93.0 45-140		
Bromodichloromethane	52.6	2.0	ug/kg	50.0	ND	105 75-140		
Bromoform	56.4	5.0	ug/kg	50.0	ND	113 55-150		
Chlorobenzene	49.5	2.0	ug/kg	50.0	ND	99.0 75-135		
Chloroform	49.2	2.0	ug/kg	50.0	ND	98.4 75-140		
Dibromochloromethane	52.5	2.0	ug/kg	50.0	ND	105 70-140		
1,4-Dichlorobenzene	43.8	2.0	ug/kg	50.0	ND	87.6 80-145		
1,1-Dichloroethane	49.8	2.0	ug/kg	50.0	ND	99.6 70-150		
1,2-Dichloroethane	50.2	2.0	ug/kg	50.0	ND	100 65-145		
1,1-Dichloroethene	49.8	5.0	ug/kg	50.0	ND	99.6 70-165		
Ethylbenzene	48.3	2.0	ug/kg	50.0	ND	96.6 55-140		
Naphthalene	50.2	5.0	ug/kg	50.0	ND	100 65-175		
Tetrachloroethene	50.0	2.0	ug/kg	50.0	ND	100 75-200		
Toluene	45.4	2.0	ug/kg	50.0	ND	90.8 50-140		
Trichloroethene	45.2	2.0	ug/kg	50.0	ND	90.4 75-145		
Vinyl chloride	41.5	5.0	ug/kg	50.0	ND	83.0 45-160		
o-Xylene	47.5	2.0	ug/kg	50.0	ND	95.0 75-150		
m,p-Xylenes	95.3	2.0	ug/kg	100	ND	95.3 55-160		

Del Mar Analytical, Irvine
 Patty Mata
 Project Manager

The results pertain only to the samples tested in the laboratory. This report shall not be reproduced, except in full, without written permission from Del Mar Analytical.



Del Mar Analytical

2852 Alton Ave., Irvine, CA 92606 (949) 261-1022 FAX (949) 281-1228
 1014 E. Coldby Dr., Suite A, Colton, CA 92324 (909) 870-4667 FAX (909) 370-1048
 7277 Hayvenhurst, Suite B-12, Van Nuys, CA 91406 (818) 779-1844 FAX (818) 779-1843
 9484 Chesapeake Dr., Suite 805, San Diego, CA 92123 (858) 505-8596 FAX (858) 505-9589
 9830 South 51st St., Suite B-120, Phoenix, AZ 85044 (480) 785-0043 FAX (480) 785-0851

Environ-Irvine
 2010 Main Street, 9th Floor
 Irvine, CA 92614
 Attention: Bitu Tabatabai

Project ID: Valley Alhambra
 04-9065A
 Report Number: IKF0951

Sampled: 06/22/01
 Received: 06/22/01

METHOD BLANK/QC DATA

VOLATILE ORGANICS by GC/MS (EPA 5030B/8260B)

Analyte	Result	Reporting Limit	Units	Spike Level	Source Result	%REC %REC	%REC Limits	RPD RPD	RPD Limit	Data Qualifiers
Batch: IIF2825 Extracted: 06/28/01										
Matrix Spike Analyzed: 06/28/01 (IIF2825-MS1)					Source: IKF0951-01					
Surrogate: Dibromofluoromethane	54.4		ug/kg	50.0		109	85-125			
Surrogate: Toluene-d8	51.4		ug/kg	50.0		103	80-120			
Surrogate: 4-Bromofluorobenzene	52.4		ug/kg	50.0		105	80-120			
Matrix Spike Dup Analyzed: 06/28/01 (IIF2825-MSD1)					Source: IKF0951-01					
Benzene	46.2	2.0	ug/kg	50.0	ND	92.4	45-140	0.647	20	
Bromodichloromethane	51.9	2.0	ug/kg	50.0	ND	104	75-140	1.34	20	
Bromoform	54.3	5.0	ug/kg	50.0	ND	109	55-150	3.79	30	
Chlorobenzene	49.3	2.0	ug/kg	50.0	ND	98.6	75-135	0.405	20	
Chloroform	48.0	2.0	ug/kg	50.0	ND	96.0	75-140	2.47	20	
Dibromochloromethane	51.8	2.0	ug/kg	50.0	ND	104	70-140	1.34	25	
1,4-Dichlorobenzene	44.9	2.0	ug/kg	50.0	ND	89.8	80-145	2.48	25	
1,1-Dichloroethane	48.5	2.0	ug/kg	50.0	ND	97.0	70-150	2.64	20	
1,2-Dichloroethane	49.0	2.0	ug/kg	50.0	ND	98.0	65-145	2.42	25	
1,1-Dichloroethene	49.0	5.0	ug/kg	50.0	ND	98.0	70-165	1.62	20	
Ethylbenzene	48.2	2.0	ug/kg	50.0	ND	96.4	55-140	0.207	20	
Naphthalene	48.4	5.0	ug/kg	50.0	ND	96.8	65-175	3.65	40	
Tetrachloroethene	50.6	2.0	ug/kg	50.0	ND	101	75-200	1.19	25	
Toluene	44.7	2.0	ug/kg	50.0	ND	89.4	50-140	1.55	20	
Trichloroethene	45.3	2.0	ug/kg	50.0	ND	90.6	75-145	0.221	20	
Vinyl chloride	41.3	5.0	ug/kg	50.0	ND	82.6	45-160	0.483	30	
o-Xylene	47.5	2.0	ug/kg	50.0	ND	95.0	75-150	0.00	20	
m,p-Xylenes	95.6	2.0	ug/kg	100	ND	95.6	55-160	0.314	20	
Surrogate: Dibromofluoromethane	54.0		ug/kg	50.0		108	85-125			
Surrogate: Toluene-d8	51.1		ug/kg	50.0		102	80-120			
Surrogate: 4-Bromofluorobenzene	52.1		ug/kg	50.0		104	80-120			

Del Mar Analytical, Irvine
 Patty Mata
 Project Manager

The results pertain only to the samples tested in the laboratory. This report shall not be reproduced, except in full, without written permission from Del Mar Analytical.



Del Mar Analytical

2852 Alton Ave., Irvine, CA 92606 (949) 261-1022 FAX (949) 261-1228
 1014 E. Coldby Dr., Suite A, Colton, CA 92324 (909) 370-4667 FAX (909) 370-1046
 7277 Heyvenhurst, Suite B-12, Van Nuys, CA 91406 (818) 779-1844 FAX (818) 779-1843
 9484 Chesapeake Dr., Suite 805, San Diego, CA 92123 (858) 505-8596 FAX (858) 505-9589
 8630 South 51st St., Suite B-120, Phoenix, AZ 85044 (480) 785-0043 FAX (480) 785-0851

Environ-Irvine 2010 Main Street, 9th Floor Irvine, CA 92614 Attention: Bitu Tabatabai	Project ID: Valley Alhambra 04-9065A Report Number: IKF0951	Sampled: 06/22/01 Received: 06/22/01
--	---	---

METHOD BLANK/QC DATA

VOLATILE ORGANICS by GC/MS (EPA 5030B/8260B)

Analyte	Result	Reporting Limit	Units	Spike Level	Source Result	%REC %REC	%REC Limits	RPD RPD	RPD Limit	Data Qualifiers
Batch: 11F2908 Extracted: 06/29/01										
Blank Analyzed: 06/29/01 (11F2908-BLK1)										
Benzene	ND	2.0	ug/kg							
Bromobenzene	ND	5.0	ug/kg							
Bromochloromethane	ND	5.0	ug/kg							
Bromodichloromethane	ND	2.0	ug/kg							
Bromoform	ND	5.0	ug/kg							
Bromomethane	ND	5.0	ug/kg							
n-Butylbenzene	ND	5.0	ug/kg							
sec-Butylbenzene	ND	5.0	ug/kg							
tert-Butylbenzene	ND	5.0	ug/kg							
Carbon tetrachloride	ND	5.0	ug/kg							
Chlorobenzene	ND	2.0	ug/kg							
Chloroethane	ND	5.0	ug/kg							
Chloroform	ND	2.0	ug/kg							
Chloromethane	ND	5.0	ug/kg							
2-Chlorotoluene	ND	5.0	ug/kg							
4-Chlorotoluene	ND	5.0	ug/kg							
Dibromochloromethane	ND	2.0	ug/kg							
1,2-Dibromo-3-chloropropane	ND	5.0	ug/kg							
1,2-Dibromoethane (EDB)	ND	2.0	ug/kg							
Dibromomethane	ND	2.0	ug/kg							
1,2-Dichlorobenzene	ND	2.0	ug/kg							
1,3-Dichlorobenzene	ND	2.0	ug/kg							
1,4-Dichlorobenzene	ND	2.0	ug/kg							
Dichlorodifluoromethane	ND	5.0	ug/kg							
1,1-Dichloroethane	ND	2.0	ug/kg							
1,2-Dichloroethane	ND	2.0	ug/kg							
1,1-Dichloroethene	ND	5.0	ug/kg							
cis-1,2-Dichloroethene	ND	2.0	ug/kg							
trans-1,2-Dichloroethene	ND	2.0	ug/kg							
1,2-Dichloropropane	ND	2.0	ug/kg							
1,3-Dichloropropane	ND	2.0	ug/kg							
2,2-Dichloropropane	ND	2.0	ug/kg							
1,1-Dichloropropene	ND	2.0	ug/kg							
cis-1,3-Dichloropropene	ND	2.0	ug/kg							
trans-1,3-Dichloropropene	ND	2.0	ug/kg							
Ethylbenzene	ND	2.0	ug/kg							

Del Mar Analytical, Irvine
 Patty Mata
 Project Manager

The results pertain only to the samples tested in the laboratory. This report shall not be reproduced, except in full, without written permission from Del Mar Analytical.



2852 Alton Ave., Irvine, CA 92605 (949) 261-1022 FAX (949) 261-1228
 1014 E. Coldby Dr., Suite A, Colton, CA 92324 (909) 370-4667 FAX (909) 370-1046
 7277 Hayvenhurst, Suite B-12, Van Nuys, CA 91406 (818) 779-1844 FAX (818) 779-1843
 9484 Chesapeake Dr., Suite 805, San Diego, CA 92123 (858) 505-8596 FAX (858) 505-8589
 9830 South 51st St., Suite B-120, Phoenix, AZ 85044 (480) 785-0043 FAX (480) 785-0851

Environ-Irvine 2010 Main Street, 9th Floor Irvine, CA 92614 Attention: Bitu Tabatabai	Project ID: Valley Alhambra 04-9065A Report Number: IKF0951	Sampled: 06/22/01 Received: 06/22/01
--	---	---

METHOD BLANK/QC DATA

VOLATILE ORGANICS by GC/MS (EPA 5030B/8260B)

Analyte	Result	Reporting Limit	Units	Spike Level	Source Result	%REC %REC	RPD Limits RPD	RPD Limit	Data Qualifiers
Batch: I1F2908 Extracted: 06/29/01									
Blank Analyzed: 06/29/01 (I1F2908-BLK1)									
Hexachlorobutadiene	ND	5.0	ug/kg						
Isopropylbenzene	ND	2.0	ug/kg						
p-Isopropyltoluene	ND	2.0	ug/kg						
Methylene chloride	ND	20	ug/kg						
Naphthalene	ND	5.0	ug/kg						
n-Propylbenzene	ND	2.0	ug/kg						
Styrene	ND	2.0	ug/kg						
1,1,1,2-Tetrachloroethane	ND	5.0	ug/kg						
1,1,2,2-Tetrachloroethane	ND	2.0	ug/kg						
Tetrachloroethene	ND	2.0	ug/kg						
Toluene	ND	2.0	ug/kg						
1,2,3-Trichlorobenzene	ND	5.0	ug/kg						
1,2,4-Trichlorobenzene	ND	5.0	ug/kg						
1,1,1-Trichloroethane	ND	2.0	ug/kg						
1,1,2-Trichloroethane	ND	2.0	ug/kg						
Trichloroethene	ND	2.0	ug/kg						
Trichlorofluoromethane	ND	5.0	ug/kg						
1,2,3-Trichloropropane	ND	10	ug/kg						
1,2,4-Trimethylbenzene	ND	2.0	ug/kg						
1,3,5-Trimethylbenzene	ND	2.0	ug/kg						
Vinyl chloride	ND	5.0	ug/kg						
o-Xylene	ND	2.0	ug/kg						
m,p-Xylenes	ND	2.0	ug/kg						
Surrogate: Dibromofluoromethane	45.8		ug/kg	50.0		91.6	85-125		
Surrogate: Toluene-d8	49.5		ug/kg	50.0		99.0	80-120		
Surrogate: 4-Bromofluorobenzene	46.0		ug/kg	50.0		92.0	80-120		
LCS Analyzed: 06/29/01 (I1F2908-BS1)									
Benzene	54.7	2.0	ug/kg	50.0		109	75-130		
Bromobenzene	53.1	5.0	ug/kg	50.0		106	75-130		
Bromochloromethane	50.4	5.0	ug/kg	50.0		101	70-140		
Bromodichloromethane	51.2	2.0	ug/kg	50.0		102	75-135		
Bromoform	49.5	5.0	ug/kg	50.0		99.0	55-130		
Bromomethane	56.0	5.0	ug/kg	50.0		112	65-140		
n-Butylbenzene	50.6	5.0	ug/kg	50.0		101	75-130		
sec-Butylbenzene	52.2	5.0	ug/kg	50.0		104	80-135		
tert-Butylbenzene	50.9	5.0	ug/kg	50.0		102	75-130		

Del Mar Analytical, Irvine
 Patty Mata
 Project Manager

The results pertain only to the samples tested in the laboratory. This report shall not be reproduced, except in full, without written permission from Del Mar Analytical.



Del Mar Analytical

2852 Alton Ave., Irvine, CA 92606 (949) 261-1022 FAX (949) 261-1228
 1014 E. Colby Dr., Suite A, Colton, CA 92324 (909) 370-4667 FAX (909) 370-1046
 7277 Hayvenhurst, Suite B-12, Van Nuys, CA 91405 (818) 779-1844 FAX (818) 779-1843
 9484 Chesapeake Dr., Suite 805, San Diego, CA 92123 (858) 505-8586 FAX (858) 505-9589
 9830 South 51st St., Suite B-120, Phoenix, AZ 85044 (480) 785-0043 FAX (480) 785-0851

Environ-Irvine 2010 Main Street, 9th Floor Irvine, CA 92614 Attention: Bitu Tabatabai	Project ID: Valley Alhambra 04-9065A Report Number: IKF0951	Sampled: 06/22/01 Received: 06/22/01
--	---	---

METHOD BLANK/QC DATA

VOLATILE ORGANICS by GC/MS (EPA 5030B/8260B)

Analyte	Result	Reporting Limit	Units	Spike Level	Source Result	%REC %REC Limits	RPD RPD	Data Limit	Qualifiers
Batch: IIF2908 Extracted: 06/29/01									
LCS Analyzed: 06/29/01 (IIF2908-BS1)									
Carbon tetrachloride	59.6	5.0	ug/kg	50.0		119 70-160			
Chlorobenzene	54.2	2.0	ug/kg	50.0		108 75-130			
Chloroethane	49.9	5.0	ug/kg	50.0		99.8 65-135			
Chloroform	50.8	2.0	ug/kg	50.0		102 75-130			
Chloromethane	43.8	5.0	ug/kg	50.0		87.6 45-130			
2-Chlorotoluene	50.0	5.0	ug/kg	50.0		100 75-130			
4-Chlorotoluene	50.7	5.0	ug/kg	50.0		101 80-130			
Dibromochloromethane	51.2	2.0	ug/kg	50.0		102 70-140			
1,2-Dibromo-3-chloropropane	36.0	5.0	ug/kg	50.0		72.0 50-145			
1,2-Dibromoethane (EDB)	46.7	2.0	ug/kg	50.0		93.4 60-145			
Dibromomethane	50.1	2.0	ug/kg	50.0		100 65-135			
1,2-Dichlorobenzene	49.9	2.0	ug/kg	50.0		99.8 75-130			
1,3-Dichlorobenzene	51.6	2.0	ug/kg	50.0		103 75-130			
1,4-Dichlorobenzene	53.6	2.0	ug/kg	50.0		107 80-125			
Dichlorodifluoromethane	51.0	5.0	ug/kg	50.0		102 10-140			
1,1-Dichloroethane	46.8	2.0	ug/kg	50.0		93.6 75-135			
1,2-Dichloroethane	44.2	2.0	ug/kg	50.0		88.4 65-140			
1,1-Dichloroethene	51.7	5.0	ug/kg	50.0		103 70-145			
cis-1,2-Dichloroethene	47.9	2.0	ug/kg	50.0		95.8 70-130			
trans-1,2-Dichloroethene	52.4	2.0	ug/kg	50.0		105 75-140			
1,2-Dichloropropane	46.0	2.0	ug/kg	50.0		92.0 75-130			
1,3-Dichloropropane	49.4	2.0	ug/kg	50.0		98.8 65-140			
2,2-Dichloropropane	51.1	2.0	ug/kg	50.0		102 75-150			
1,1-Dichloropropene	51.1	2.0	ug/kg	50.0		102 75-140			
cis-1,3-Dichloropropene	52.5	2.0	ug/kg	50.0		105 65-135			
trans-1,3-Dichloropropene	50.9	2.0	ug/kg	50.0		102 65-140			
Ethylbenzene	56.7	2.0	ug/kg	50.0		113 75-135			
Hexachlorobutadiene	43.0	5.0	ug/kg	50.0		86.0 75-150			
Isopropylbenzene	50.4	2.0	ug/kg	50.0		101 80-135			
p-Isopropyltoluene	50.3	2.0	ug/kg	50.0		101 75-130			
Methylene chloride	45.9	2.0	ug/kg	50.0		91.8 70-125			
Naphthalene	34.7	5.0	ug/kg	50.0		69.4 50-145			
n-Propylbenzene	52.6	2.0	ug/kg	50.0		105 80-135			
Styrene	56.5	2.0	ug/kg	50.0		113 75-140			
1,1,1,2-Tetrachloroethane	58.5	5.0	ug/kg	50.0		117 75-135			
1,1,2,2-Tetrachloroethane	44.6	2.0	ug/kg	50.0		89.2 70-135			

Del Mar Analytical, Irvine
 Patty Mata
 Project Manager

The results pertain only to the samples tested in the laboratory. This report shall not be reproduced, except in full, without written permission from Del Mar Analytical.



Del Mar Analytical

2852 Alton Ave., Irvine, CA 92606 (949) 261-1022 FAX (949) 261-1228
 1014 E. Coldby Dr., Suite A, Colton, CA 92324 (909) 370-4667 FAX (909) 370-1046
 7277 Hayvenhurst, Suite B-12, Van Nuys, CA 91406 (818) 779-1844 FAX (818) 779-1843
 9484 Chesapeake Dr., Suite 805, San Diego, CA 92123 (666) 505-8596 FAX (658) 505-9589
 8830 South 51st St., Suite B-120, Phoenix, AZ 85044 (480) 785-0043 FAX (480) 785-0851

Environ-Irvine
 2010 Main Street, 9th Floor
 Irvine, CA 92614
 Attention: Bitu Tabatabai

Project ID: Valley Alhambra
 04-9065A
 Report Number: IKF0951

Sampled: 06/22/01
 Received: 06/22/01

METHOD BLANK/QC DATA

VOLATILE ORGANICS by GC/MS (EPA 5030B/8260B)

Analyte	Result	Reporting Limit	Units	Spike Level	Source Result	%REC	%REC Limits	RPD	RPD Limit	Data Qualifiers
Batch: I1F2908 Extracted: 06/29/01										
LCS Analyzed: 06/29/01 (I1F2908-BS1)										
Tetrachloroethene	59.3	2.0	ug/kg	50.0		119	75-130			
Toluene	54.6	2.0	ug/kg	50.0		109	75-130			
1,2,3-Trichlorobenzene	41.3	5.0	ug/kg	50.0		82.6	50-140			
1,2,4-Trichlorobenzene	45.8	5.0	ug/kg	50.0		91.6	70-130			
1,1,1-Trichloroethane	53.4	2.0	ug/kg	50.0		107	75-140			
1,1,2-Trichloroethane	46.2	2.0	ug/kg	50.0		92.4	65-130			
Trichloroethene	50.6	2.0	ug/kg	50.0		101	75-130			
Trichlorofluoromethane	50.3	5.0	ug/kg	50.0		101	55-145			
1,2,3-Trichloropropane	38.4	10	ug/kg	50.0		76.8	60-140			
1,2,4-Trimethylbenzene	50.0	2.0	ug/kg	50.0		100	80-130			
1,3,5-Trimethylbenzene	51.7	2.0	ug/kg	50.0		103	80-135			
Vinyl chloride	56.4	5.0	ug/kg	50.0		113	45-140			
o-Xylene	56.5	2.0	ug/kg	50.0		113	75-130			
m,p-Xylenes	118	2.0	ug/kg	100		118	75-135			
Surrogate: Dibromofluoromethane	47.0		ug/kg	50.0		94.0	85-125			
Surrogate: Toluene-d8	49.9		ug/kg	50.0		99.8	80-120			
Surrogate: 4-Bromofluorobenzene	49.2		ug/kg	50.0		98.4	80-120			

Matrix Spike Analyzed: 06/29/01 (I1F2908-MS1)

Source: IKF0787-07

Benzene	55.9	2.0	ug/kg	50.0	ND	112	45-140			
Bromodichloromethane	51.7	2.0	ug/kg	50.0	ND	103	75-140			
Bromoform	51.1	5.0	ug/kg	50.0	ND	102	55-150			
Chlorobenzene	52.9	2.0	ug/kg	50.0	ND	106	75-135			
Chloroform	51.7	2.0	ug/kg	50.0	ND	103	75-140			
Dibromochloromethane	51.1	2.0	ug/kg	50.0	ND	102	70-140			
1,4-Dichlorobenzene	53.5	2.0	ug/kg	50.0	ND	107	80-145			
1,1-Dichloroethane	49.7	2.0	ug/kg	50.0	ND	99.4	70-150			
1,2-Dichloroethane	45.6	2.0	ug/kg	50.0	ND	91.2	65-145			
1,1-Dichloroethane	52.2	5.0	ug/kg	50.0	ND	104	70-165			
Ethylbenzene	55.3	2.0	ug/kg	50.0	ND	111	55-140			
Naphthalene	38.9	5.0	ug/kg	50.0	ND	77.8	65-175			
Tetrachloroethene	57.7	2.0	ug/kg	50.0	ND	115	75-200			
Toluene	55.8	2.0	ug/kg	50.0	ND	112	50-140			
Trichloroethene	53.4	2.0	ug/kg	50.0	ND	107	75-145			
Vinyl chloride	58.9	5.0	ug/kg	50.0	ND	118	45-160			
o-Xylene	55.8	2.0	ug/kg	50.0	ND	112	75-150			
m,p-Xylenes	115	2.0	ug/kg	100	ND	115	55-160			

Del Mar Analytical, Irvine
 Patty Mata
 Project Manager

The results pertain only to the samples tested in the laboratory. This report shall not be reproduced, except in full, without written permission from Del Mar Analytical.



2852 Alton Ave., Irvine, CA 92608 (949) 261-1022 FAX (949) 261-1228
 1014 E. Coldby Dr., Suite A, Colton, CA 92324 (909) 370-4667 FAX (909) 370-1046
 7277 Hayvenhurst, Suite B-12, Van Nuys, CA 91406 (818) 779-1844 FAX (818) 779-1843
 9484 Chesapeake Dr., Suite 805, San Diego, CA 92123 (858) 505-8596 FAX (858) 505-9589
 8830 South 51st St., Suite B-120, Phoenix, AZ 85044 (480) 785-0043 FAX (480) 785-0851

Environ-Irvine 2010 Main Street, 9th Floor Irvine, CA 92614 Attention: Bitu Tabatabai	Project ID: Valley Alhambra 04-9065A Report Number: IKF0951	Sampled: 06/22/01 Received: 06/22/01
--	---	---

METHOD BLANK/QC DATA

VOLATILE ORGANICS by GC/MS (EPA 5030B/8260B)

Analyte	Result	Reporting Limit	Units	Spike Level	Source Result	%REC %REC Limits	RPD RPD	RPD Limit	Data Qualifiers
Batch: IIF2908 Extracted: 06/29/01									
Matrix Spike Analyzed: 06/29/01 (IIF2908-MS1)					Source: IKF0787-07				
Surrogate: Dibromofluoromethane	46.8		ug/kg	50.0		93.6 85-125			
Surrogate: Toluene-d8	49.8		ug/kg	50.0		99.6 80-120			
Surrogate: 4-Bromofluorobenzene	48.0		ug/kg	50.0		96.0 80-120			
Matrix Spike Dup Analyzed: 06/29/01 (IIF2908-MSD1)					Source: IKF0787-07				
Benzene	55.3	2.0	ug/kg	50.0	ND	111 45-140	1.08	20	
Bromodichloromethane	51.7	2.0	ug/kg	50.0	ND	103 75-140	0.00	20	
Bromoform	50.1	5.0	ug/kg	50.0	ND	100 55-150	1.98	30	
Chlorobenzene	52.7	2.0	ug/kg	50.0	ND	105 75-135	0.379	20	
Chloroform	52.3	2.0	ug/kg	50.0	ND	105 75-140	1.15	20	
Dibromochloromethane	50.3	2.0	ug/kg	50.0	ND	101 70-140	1.58	25	
1,4-Dichlorobenzene	52.7	2.0	ug/kg	50.0	ND	105 80-145	1.51	25	
1,1-Dichloroethane	50.1	2.0	ug/kg	50.0	ND	100 70-150	0.802	20	
1,2-Dichloroethane	44.3	2.0	ug/kg	50.0	ND	88.6 65-145	2.89	25	
1,1-Dichloroethene	53.7	5.0	ug/kg	50.0	ND	107 70-165	2.83	20	
Ethylbenzene	55.0	2.0	ug/kg	50.0	ND	110 55-140	0.544	20	
Naphthalene	36.6	5.0	ug/kg	50.0	ND	73.2 65-175	6.09	40	
Tetrachloroethene	57.5	2.0	ug/kg	50.0	ND	115 75-200	0.347	25	
Toluene	55.4	2.0	ug/kg	50.0	ND	111 50-140	0.719	20	
Trichloroethene	55.6	2.0	ug/kg	50.0	ND	111 75-145	4.04	20	
Vinyl chloride	60.3	5.0	ug/kg	50.0	ND	121 45-160	2.35	30	
o-Xylene	55.5	2.0	ug/kg	50.0	ND	111 75-150	0.539	20	
m,p-Xylenes	113	2.0	ug/kg	100	ND	113 55-160	1.75	20	
Surrogate: Dibromofluoromethane	46.6		ug/kg	50.0		93.2 85-125			
Surrogate: Toluene-d8	49.5		ug/kg	50.0		99.0 80-120			
Surrogate: 4-Bromofluorobenzene	48.4		ug/kg	50.0		96.8 80-120			

Del Mar Analytical, Irvine
 Patty Mata
 Project Manager

The results pertain only to the samples tested in the laboratory. This report shall not be reproduced, except in full, without written permission from Del Mar Analytical.



Del Mar Analytical

2852 Alton Ave., Irvine, CA 92608 (949) 281-1022 FAX (949) 281-1228
 1014 E. Coldby Dr., Suite A, Colton, CA 92324 (909) 370-4687 FAX (909) 370-1046
 7277 Hayvenhurst, Suite B-12, Van Nuys, CA 91406 (818) 779-1844 FAX (818) 779-1843
 9484 Chesapeake Dr., Suite 805, San Diego, CA 92123 (658) 505-8596 FAX (658) 505-9589
 9830 South 51st St., Suite B-120, Phoenix, AZ 85044 (480) 785-0043 FAX (480) 785-0851

Environ-Irvine 2010 Main Street, 9th Floor Irvine, CA 92614 Attention: Bitu Tabatabai	Project ID: Valley Alhambra 04-9065A Report Number: IKF0951	Sampled: 06/22/01 Received: 06/22/01
--	---	---

METHOD BLANK/QC DATA

METALS

Analyte	Result	Reporting Limit	Units	Spike Level	Source Result	%REC %REC	Limit	RPD RPD	Limit	Data Qualifiers
Batch: I1F2635 Extracted: 06/26/01										
Blank Analyzed: 06/26/01 (I1F2635-BLK1)										
Mercury	ND	0.020	mg/kg							
LCS Analyzed: 06/26/01 (I1F2635-BS1)										
Mercury	0.837	0.020	mg/kg	0.800		105	85-120			
Matrix Spike Analyzed: 06/26/01 (I1F2635-MS1)										
Mercury	0.985	0.020	mg/kg	0.800	0.044	118	65-135			Source: IKF0933-09
Matrix Spike Dup Analyzed: 06/26/01 (I1F2635-MSD1)										
Mercury	0.880	0.020	mg/kg	0.800	0.044	104	65-135	11.3	20	Source: IKF0933-09
Batch: I1F2642 Extracted: 06/26/01										
Blank Analyzed: 06/26/01 (I1F2642-BLK1)										
Antimony	ND	10	mg/kg							
Arsenic	ND	2.0	mg/kg							
Barium	ND	1.0	mg/kg							
Beryllium	ND	0.50	mg/kg							
Cadmium	ND	0.50	mg/kg							
Chromium	ND	1.0	mg/kg							
Cobalt	ND	1.0	mg/kg							
Copper	ND	1.0	mg/kg							
Lead	ND	2.0	mg/kg							
Molybdenum	ND	2.0	mg/kg							
Nickel	ND	1.0	mg/kg							
Selenium	ND	2.0	mg/kg							
Silver	ND	1.0	mg/kg							
Thallium	ND	10	mg/kg							
Titanium	ND	2.0	mg/kg							
Vanadium	ND	1.0	mg/kg							
Zinc	ND	5.0	mg/kg							

Del Mar Analytical, Irvine
 Patty Mata
 Project Manager

The results pertain only to the samples tested in the laboratory. This report shall not be reproduced, except in full, without written permission from Del Mar Analytical.



Del Mar Analytical

2852 Alton Ave., Irvine, CA 92606 (949) 261-1022 FAX (949) 261-1228
 1014 E. Coldby Dr., Suite A, Colton, CA 92324 (909) 370-4667 FAX (909) 370-1046
 7277 Hayvenhurst, Suite B-12, Van Nuys, CA 91406 (818) 778-1844 FAX (818) 778-1843
 9484 Chesapeake Dr., Suite 805, San Diego, CA 92123 (858) 505-8596 FAX (858) 505-9589
 9830 South 51st St., Suite B-120, Phoenix, AZ 85044 (480) 785-0043 FAX (480) 785-0851

Environ-Irvine
 2010 Main Street, 9th Floor
 Irvine, CA 92614
 Attention: Bitu Tabatabai

Project ID: Valley Alhambra
 04-9065A
 Report Number: IKF0951

Sampled: 06/22/01
 Received: 06/22/01

METHOD BLANK/QC DATA

METALS

Analyte	Result	Reporting Limit	Units	Spike Level	Source Result	%REC %REC	Limit	RPD RPD	RPD Limit	Data Qualifiers
Batch: I1F2642 Extracted: 06/26/01										
LCS Analyzed: 06/26/01 (I1F2642-BS1)										
Antimony	47.0	10	mg/kg	50.0		94.0	80-120			
Arsenic	45.3	2.0	mg/kg	50.0		90.6	80-120			
Barium	45.2	1.0	mg/kg	50.0		90.4	80-120			
Beryllium	45.6	0.50	mg/kg	50.0		91.2	80-120			
Cadmium	45.6	0.50	mg/kg	50.0		89.6	80-120			
Chromium	44.8	1.0	mg/kg	50.0		88.6	80-120			
Cobalt	44.3	1.0	mg/kg	50.0		91.0	80-120			
Copper	45.5	1.0	mg/kg	50.0		92.8	80-120			
Lead	46.4	2.0	mg/kg	50.0		89.8	80-120			
Molybdenum	44.9	2.0	mg/kg	50.0		87.6	80-120			
Nickel	43.8	1.0	mg/kg	50.0		89.2	80-120			
Selenium	44.6	2.0	mg/kg	50.0		92.4	80-120			
Silver	23.1	1.0	mg/kg	25.0		86.2	80-120			
Thallium	43.1	10	mg/kg	50.0		93.6	80-120			
Titanium	46.8	2.0	mg/kg	50.0		91.8	80-120			
Vanadium	45.9	1.0	mg/kg	50.0		94.4	80-120			
Zinc	47.2	5.0	mg/kg	50.0						
Matrix Spike Analyzed: 06/26/01 (I1F2642-MS1)										
Antimony	22.1	10	mg/kg	50.0	ND	44.2	75-125			M2
Arsenic	45.0	2.0	mg/kg	50.0	ND	87.2	75-125			
Barium	111	1.0	mg/kg	50.0	60	102	75-125			
Beryllium	44.4	0.50	mg/kg	50.0	ND	88.8	75-125			
Cadmium	44.2	0.50	mg/kg	50.0	1.5	85.4	75-125			
Chromium	63.8	1.0	mg/kg	50.0	16	95.6	75-125			
Cobalt	48.8	1.0	mg/kg	50.0	6.5	84.6	75-125			
Copper	62.9	1.0	mg/kg	50.0	16	93.8	75-125			
Lead	50.4	2.0	mg/kg	50.0	6.1	88.6	75-125			
Molybdenum	41.0	2.0	mg/kg	50.0	ND	81.5	75-125			
Nickel	56.6	1.0	mg/kg	50.0	14	85.2	75-125			
Selenium	43.7	2.0	mg/kg	50.0	ND	83.8	75-125			
Silver	22.4	1.0	mg/kg	25.0	ND	89.6	75-125			
Thallium	45.2	10	mg/kg	50.0	ND	83.0	75-125			
Titanium	1010	2.0	mg/kg	50.0	630	760	75-125			M-HA
Vanadium	84.6	1.0	mg/kg	50.0	29	111	75-125			
Zinc	89.1	5.0	mg/kg	50.0	45	88.2	75-125			

Del Mar Analytical, Irvine
 Patty Mata
 Project Manager

The results pertain only to the samples tested in the laboratory. This report shall not be reproduced, except in full, without written permission from Del Mar Analytical.



Del Mar Analytical

2852 Alton Ave., Irvine, CA 92606 (949) 261-1022 FAX (949) 261-1228
 1014 E. Coldby Dr., Suite A, Colton, CA 92324 (909) 370-4667 FAX (909) 370-1046
 7277 Hgyvenhurst, Suite B-12, Van Nuys, CA 91406 (818) 779-1844 FAX (818) 779-1843
 9484 Chesapeake Dr., Suite 805, San Diego, CA 92123 (858) 505-8596 FAX (858) 505-8589
 8830 South 51st St., Suite B-120, Phoenix, AZ 85044 (480) 785-0043 FAX (480) 785-0851

Environ-Irvine 2010 Main Street, 9th Floor Irvine, CA 92614 Attention: Bitu Tabatabai	Project ID: Valley Alhambra 04-9065A Report Number: IKF0951	Sampled: 06/22/01 Received: 06/22/01
--	---	---

METHOD BLANK/QC DATA

METALS

Analyte	Result	Reporting Limit	Units	Spike Level	Source Result	%REC %REC	Limits	RPD RPD	RPD Limit	Data Qualifiers
Batch: 11F2642 Extracted: 06/26/01										
Matrix Spike Dup Analyzed: 06/26/01 (11F2642-MSD1)					Source: IKF0956-01					
Antimony	23.3	10	mg/kg	50.0	ND	46.6	75-125	5.29	20	M2
Arsenic	46.4	2.0	mg/kg	50.0	ND	90.0	75-125	3.06	20	
Barium	117	1.0	mg/kg	50.0	60	114	75-125	5.26	20	
Beryllium	45.8	0.50	mg/kg	50.0	ND	91.6	75-125	3.10	20	
Cadmium	46.5	0.50	mg/kg	50.0	1.5	90.0	75-125	5.07	20	
Chromium	66.5	1.0	mg/kg	50.0	16	101	75-125	4.14	20	
Cobalt	50.8	1.0	mg/kg	50.0	6.5	88.6	75-125	4.02	20	
Copper	66.8	1.0	mg/kg	50.0	16	102	75-125	6.01	20	
Lead	52.2	2.0	mg/kg	50.0	6.1	92.2	75-125	3.51	20	
Molybdenum	42.6	2.0	mg/kg	50.0	ND	84.7	75-125	3.83	20	
Nickel	58.9	1.0	mg/kg	50.0	14	89.8	75-125	3.98	20	
Selenium	46.4	2.0	mg/kg	50.0	ND	89.2	75-125	5.99	20	
Silver	23.4	1.0	mg/kg	25.0	ND	93.6	75-125	4.37	20	
Thallium	47.0	10	mg/kg	50.0	ND	86.6	75-125	3.90	20	
Titanium	1080	2.0	mg/kg	50.0	630	900	75-125	6.70	20	M-HA
Vanadium	89.3	1.0	mg/kg	50.0	29	121	75-125	5.41	20	
Zinc	94.1	5.0	mg/kg	50.0	45	98.2	75-125	5.46	20	

Del Mar Analytical, Irvine
 Patty Mata
 Project Manager

The results pertain only to the samples tested in the laboratory. This report shall not be reproduced, except in full, without written permission from Del Mar Analytical.



Del Mar Analytical

2852 Alton Ave., Irvine, CA 92606 (949) 261-1022 FAX (949) 261-1228
1014 E. Coldby Dr., Suite A, Colton, CA 92324 (909) 370-4667 FAX (909) 370-1046
7277 Hayvenhurst, Suite B-12, Van Nuys, CA 91406 (818) 779-1844 FAX (818) 779-1843
9484 Chesapeake Dr., Suite 805, San Diego, CA 92123 (858) 505-8596 FAX (858) 505-9589
9830 South 51st St., Suite B-120, Phoenix, AZ 85044 (480) 785-0043 FAX (480) 785-0851

Environ-Irvine
2010 Main Street, 9th Floor
Irvine, CA 92614
Attention: Bitu Tabatabai

Project ID: Valley Alhambra
04-9065A
Report Number: IKF0951

Sampled: 06/22/01
Received: 06/22/01

DATA QUALIFIERS AND DEFINITIONS

- M-HA Due to high levels of analyte in the sample, the MS/MSD calculation does not provide useful spike recovery information. See Blank Spike (LCS).
- M2 The MS and/or MSD were below the acceptance limits due to sample matrix interference. See Blank Spike (LCS).
- ND Analyte NOT DETECTED at or above the reporting limit or MDL, if MDL is specified.
- NR Not reported.
- RPD Relative Percent Difference

Del Mar Analytical, Irvine
Patty Mata
Project Manager

The results pertain only to the samples tested in the laboratory. This report shall not be reproduced, except in full, without written permission from Del Mar Analytical.

IKF0951 <Page 33 of 33>

ENVIRON

2010 Main St., Suite 900
 Irvine, California 92614
 (949) 261-5151
 (949) 261-8202 (FAX)

CHAIN-OF-CUSTODY

PAGE 1 of 2

PROJECT NAME: VALLEY ALHAMBRA FIELD PERSON: ALEX MARR
 PROJECT NUMBER: 04-9065A PROJECT MANAGER: BITA TABATABAI
 PROJECT LOCATION: 4900 E. VALLEY BL DATE: 6/22/01

SAMPLER	SIGNATURE	YEAR	SAMPLE DATE	SAMPLE TIME	MATRIX (S) SOIL (G) GAS (W) WATER	NUMBER OF CONTAINERS	FILTERED/UNFILTERED (F/U)	PRESERVATION (SEE KEY)	ANALYSIS REQUIRED	COMMENTS
SBI-2-2.5	<i>Alex Marr</i>	6-22	1246	S	1	4	100	✓	✓ EPA 8260B EPA 6010	Please send analyses to Bita Tabatabai @ 949-261-5151
SBI-5-5.5			1254		1			✓	✓	
SBI-9.2-9.7			1300		1			✓	✓	
SBI-13-13.5			1307		1			✓	✓	
SB2-2-2.5			1325		1			✓	✓	
SB2-5-5.5			1335		1			✓	✓	
SB2-9.2-9.7			1340		1			✓	✓	
SB2-14-14.5			1347		1			✓	✓	
TOTAL									6	92

RELINQUISHED BY: *Alex Marr* TIME/DATE: 6/22/01 @ 1700 RECEIVED BY: *Steve Meridian* TIME/DATE: 1700 6-22-01
 RELINQUISHED BY: *Steve Meridian* TIME/DATE: 6-22-01 1755 RECEIVED BY: *Alex Marr* TIME/DATE: 6/22/01 1755
 RELINQUISHED BY: _____ TIME/DATE: _____ RECEIVED BY: _____ TIME/DATE: _____

TURNAROUND TIME (CIRCLE ONE) SAME DAY 24 HOURS 48 HOURS 72 HOURS 5 DAYS (NORMAL)

SAMPLE INTEGRITY INTACT ON-ICE FILE LOSS/CORRECT

H = HOLD N = HNO3 S = H2SO4 U = UNKNOWN NO = NONE O = OTHER

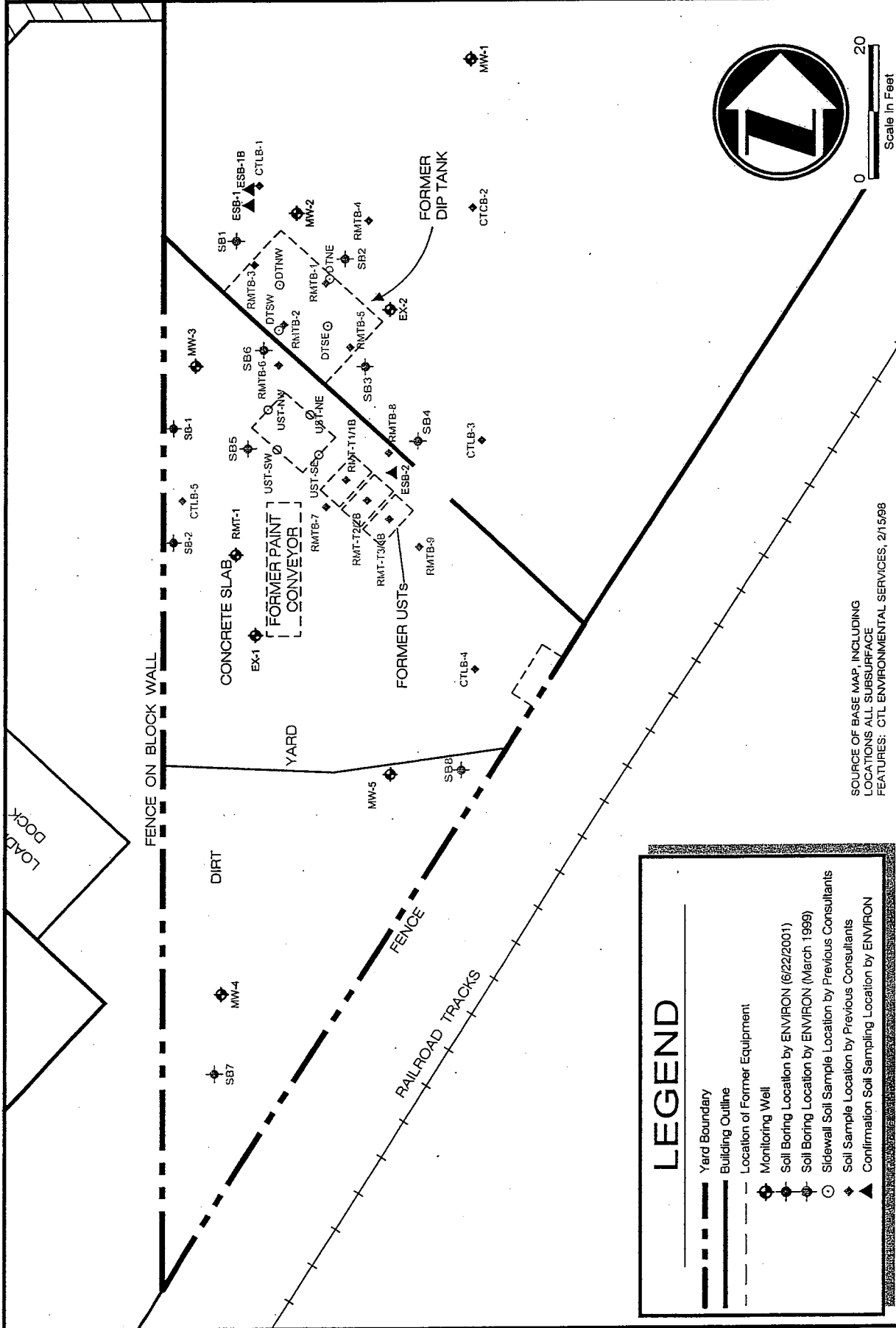

SOURCE OF BASE MAP, INCLUDING LOCATIONS ALL SUBSURFACE FEATURES: CTL ENVIRONMENTAL SERVICES, 2/15/98

LEGEND

- Yard Boundary
- Building Outline
- Location of Former Equipment
- ◆ Monitoring Well
- ◆ Soil Boring Location by ENVIRON (6/22/2001)
- Soil Boring Location by ENVIRON (March 1999)
- Sidewall Soil Sample Location by Previous Consultants
- ◆ Soil Sample Location by Previous Consultants
- ◆ Confirmation Soil Sampling Location by ENVIRON

Figure 5

Confirmation Soil Sampling Locations

4900 East Valley Boulevard
Los Angeles, California

ENVIRON

Exhibit D

ENVIRON

October 15, 2002

Mr. J.T. Liu, P.E.
Mr. David Young
California Regional Water Quality Control Board
Los Angeles Region
320 West Fourth Street, Suite 200
Los Angeles, California 90013

Re: Request for Post-Remediation Monitoring
4900 East Valley Boulevard
Los Angeles, California (SLIC No. 967)

Dear Messrs. Liu and Young:

Enclosed please find the Third Quarter 2002 ground water monitoring report for 4900 East Valley Boulevard, Los Angeles, California (Site).

On October 8, 2002, Dr. George Linkletter, Bitu Tabatabai, and Eddie Arslanian of ENVIRON International Corporation (ENVIRON) met with you, as representatives from the California Regional Water Quality Control Board – Los Angeles Region (Regional Board), at the Site to review the history of chemical use at the Site and prior site characterization activities, and to discuss the status of remedial activities.

As discussed at the meeting, the 2-PHASE™ Extraction system used to treat volatile organic compounds (VOCs) in soil and ground water at the Site has been very effective. VOCs in ground water have decreased from concentrations of upwards of 4,800 micrograms per liter ($\mu\text{g/l}$) of tetrachloroethene, the primary VOC constituent at the Site, to near or below its maximum contaminant level of 5 $\mu\text{g/l}$, as established by the United States Environmental Protection Agency.

At the conclusion of the meeting, we requested, and you verbally agreed, that we be allowed to shut down the 2-PHASE™ Extraction system and to commence ground water monitoring to evaluate VOC rebound effects, if any. The system was shut down in your presence at approximately 2:00 p.m. on October 8, 2002. ENVIRON has tentatively scheduled the Fourth Quarter 2002 ground water monitoring event for the first week of December 2002. As you requested, ENVIRON will notify the Regional Board of the exact date, approximately one week in advance, once it has been scheduled.

October 15, 2002

On behalf of the entities that have assumed the task of addressing the presence of chlorinated solvents in the soil and ground water at the Site, we wish to restate our appreciation for your prompt attention to our request for a meeting to review the recent efforts to complete the remediation of this Site. As you can see from the monitoring data, it appears that we are very close to the point at which we will request closure, and we will further appreciate the Regional Board's expedited review of future submittals in anticipation of achieving a "closure" status.

Very truly yours,

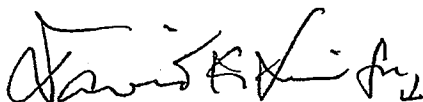

George O. Linkletter, Ph.D., R.G. (No. 3728)
Principal



Bita Tabatabai, P.E. (No. C51294)
Manager

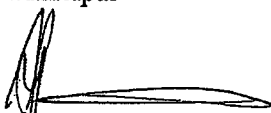

Eddie Arslanian
Senior Associate

\\Losangelesnt1\projects\AA\Alhambra\Regional Board Correspondence\Cover Letter for 2002 3Q Ground Water Report.doc

Enclosure

Copy: Mr. Robert Anderson, Leggett & Platt
Ms. Joan Donnellan, Leland, Parachini, Steinberg, Matzger & Melnick, LLP
Mr. Gary Herman, S.D. Herman Co., Inc

Exhibit E

-----Original Message-----

From: Eddie Arslanian
Sent: Wednesday, December 10, 2003 9:21 AM
To: 'David Young'
Cc: Ju-Tseng Liu; George Linkletter; Bitu Tabatabai
Subject: RE: Work Plan for Valley Alhambra Property

David, we will analyze the soil/gw samples by 8260B instead of 8021B. Historical soil samples have been analyzed by 8260B. However, please note that the quarterly gw samples have been historically analyzed by 8021B. Therefore, there could be some discrepancies in the gw samples results now between the 8021B and 8260B.

we are trying to arrange the sampling activities for next thursday the 18th. I will let you know once it gets finalized.

thanks.

-----Original Message-----

From: David Young [mailto:dyoung@rb4.swrcb.ca.gov]
Sent: Tuesday, December 09, 2003 4:17 PM
To: EArslanian@environcorp.com
Cc: Ju-Tseng Liu
Subject: Work Plan for Valley Alhambra Property

Hi Eddie,

I reviewed the Work Plan for Confirmation Soil Sampling and Final Round of Ground Water Sampling at Valley Alhambra Property, dated December 3, 2003. The only comment I have is with regard to analysis for VOCs. Due to the nature of this sampling event (confirmation sampling for site closure), VOCs should be analyzed in both soil and ground water by EPA Method 8260B. This analytical method covers a broader range of analytes, which is helpful information in determining if the site is eligible for closure. Other than this issue, everything else appears appropriate. Please let me know when you are planning on doing the proposed work so I can arrange my schedule to be there. Thanks, and let me know if you have any questions.

David A. Young
Engineering Geologist
Site Cleanup II
(213) 576-6744

The energy challenge facing California is real. Every Californian needs to take immediate action to reduce energy consumption
***For a list of simple ways to reduce demand and cut your energy costs, see the tips at: <http://www.swrcb.ca.gov/news/echallenge.html>

Exhibit F

From: [Eddie Arslanian](#)

Sent: Fri 1/16/2004 4:04 PM

To: ['Ju-Tseng Liu'](#); ['David Young'](#)

Cc: [Bita Tabatabai](#); [George Linkletter](#)

Subject: Valley-Alhambra: Confirmation Soil and Ground Water Sampling Results

Attachments: [9065af3n Figure 3.pdf\(252KB\)](#) [Table 1.xls\(32KB\)](#) [Table 2.xls\(19KB\)](#) [Table 3.xls\(19KB\)](#) [Table 4.xls\(20KB\)](#)

[View As Web Page](#)

Gentlemen,

As mutually agreed in our meeting on November 18, 2003, ENVIRON conducted confirmation soil sampling and one final round of ground water sampling at the Site prior to the LARWQCB's issuance of a "No Further Action" designation for the site. The sampling activities were conducted to evaluate the presence of volatile organic compounds (VOCs), in addition to 1,4-dioxane, 1,2,3-trichloropropane (1,2,3-TCP), Title 22 metals, polychlorinated biphenyls (PCBs), and organochloride pesticides.

Ground Water Sample Results

Ground water sampling activities were conducted on December 18, 2003. In summary, VOC concentrations (PCE, TCE, cis-1,2-DCE) were consistent or lower than concentrations measured in prior quarters. Detected Title 22 metal concentrations were indicative of background concentrations and below California Maximum Contaminant Levels. Concentrations of 1,4-dioxane, 1,2,3-TCP, PCBs, and organochloride pesticides were not found above their respective laboratory reporting limits (RLs). Table 1 includes historical and recent results of VOCs found in ground water. Table 2 includes detected Title 22 dissolved metals found in ground water.

Soil Sample Results

Confirmation soil sampling activities were conducted on December 22, 2003 and January 6, 2004. The attached figure shows the locations of the confirmation soil samples approved by the LARWQCB, ESB-1 and ESB-2. PCE was found at concentrations ranging from below laboratory RLs of 4 micrograms per kilogram (ug/kg) to 140 ug/kg at ESB1-10'. The concentration of PCE at ESB1-12 was lower at 37 ug/kg. Other VOCs detected included toluene at up to 320 ug/kg, ethylbenzene up to 19 ug/kg, and xylenes up to 108 ug/kg. Detected Title 22 metal concentrations were indicative of background concentrations. Concentrations of 1,4-dioxane, 1,2,3-TCP, PCBs, and organochloride pesticides were not found above their respective laboratory RLs. Table 2 summarizes the analytical data for soil samples.

Based on the results of the soil and ground water samples presented herein, ENVIRON recommends that the LARWQCB issue a "No Further Action" designation for the site. We will submit a full report including all laboratory analytical results, data validation reports, and figures within the next couple of weeks.

Upon receiving your verbal authorization, ENVIRON will remove the remediation equipment and abandon the wells from the site. Furthermore, ENVIRON will assist the LARWQCB with preparation of the Site Closure Form.

Thank you.

<<9065af3n Figure 3.pdf>> <<Table 1.xls>> <<Table 2.xls>> <<Table 3.xls>> <<Table 4.xls>>

Eddie Arslanian, P.E.
ENVIRON International Corporation

707 Wilshire Boulevard, Suite 4950
Los Angeles, California 90017
Tel: 213.943.6326
Fax: 213.943.6301

<<9065af3n Figure 3.pdf>> <<Table 1.xls>> <<Table 2.xls>> <<Table 3.xls>> <<Table
4.xls>>

Exhibit G

From: Eddie Arslanian
Sent: Wednesday, February 11, 2004 11:31 AM
To: 'Ju-Tseng Liu'; 'David Young'
Cc: Bitu Tabatabai; George Linkletter
Subject: Status on 4900 Valley Boulevard

Gentlemen,

We would like to inquire about the status of the "No Further Action" request for the site.

Could you please inform us as to when we can expect to receive a response from the Regional Board? Our client and the existing tenant at the site are eager to remove the remediation equipment and restore the site.

Thank you.

Eddie Arslanian, P.E.

ENVIRON International Corporation

707 Wilshire Boulevard, Suite 4950

Los Angeles, California 90017

Tel: 213.943.6326

Fax: 213.943.6301

Exhibit H

From: Eddie Arslanian
To: 'David Young'; 'Ju-Tseng Liu'
Cc: George Linkletter; Bitu Tabatabai
Subject: RE: Valley Alhambra Closure
Attachments:  Case review form.doc(59KB)

Sent: Thu 3/25/2004 6:55 PM

[View As Web Page](#)

Gentlemen,

Attached for your review, please find the closure form. If you have any questions, please contact me.

-----Original Message-----

From: David Young [<mailto:dyoung@rb4.swrcb.ca.gov>]
Sent: Tuesday, February 24, 2004 10:55 AM
To: Eddie Arslanian
Cc: Ju-Tseng Liu
Subject: Valley Alhambra Closure

Hi Eddie. After talking with management about this case we need the following to be completed:

- 1) A closure report that summarizes assessment/remediation at the site with a section addressing confirmation sampling results (soil/water). Within this section provide justification of why it is acceptable to leave 140 ug/kg in soil @ 10 ft bgs. Feel free to include any other pertinent information that would support closing this case.
- 2) Submit a case review form (attached) electronically for the Regional Board to review/edit.
- 3) Submit 2 hard copies of the closure report as well as an electronic copy, which you can send to my email address (dyoung@rb4.swrcb.ca.gov).

Thanks, and call me if you have any questions at (213) 576-6744.

David A. Young
Engineering Geologist
Site Cleanup II

The energy challenge facing California is real. Every Californian needs to take immediate action to reduce energy consumption

***For a list of simple ways to reduce demand and cut your energy costs, see the tips at:
<http://www.swrcb.ca.gov/news/echallenge.html> ***

<<Case review form.doc>>

Exhibit I

From: [Ju-Tseng Liu \[JLIU@rb4.swrcb.ca.gov\]](mailto:JLIU@rb4.swrcb.ca.gov)

Sent: Wed 6/30/2004 2:07 PM

To: [Eddie Arslanian](#)

Cc: [David Young](#)

Subject: RE:Closure Review for Valley Alhambra

Attachments:

[View As Web Page](#)

**** Reply Requested When Convenient ****

Hi Eddie:

Thanks for the email. I have talked with Dave today and he has begun working on the NFA for Valley Alhambra. JT

J.T. Liu
Senior Water Resources Control Engineer
Los Angeles Regional Water Quality Control Board
Site Cleanup Unit II

(213) 576-6667 (tel)
(213) 576-6717 (fax)
E-Mail: Jliu@rb4.swrcb.ca.gov

>>> "Eddie Arslanian" <EARslanian@environcorp.com> 06/30/04 12:59PM >>>

Hello David,

Can you provide me an update on this?

THanks.

-----Original Message-----

From: Ju-Tseng Liu [<mailto:JLIU@rb4.swrcb.ca.gov>]
Sent: Wednesday, June 16, 2004 2:02 PM
To: Eddie Arslanian
Cc: David Young
Subject: RE: Review of NFA Forms for two sites

**** Reply Requested When Convenient ****

Hi Eddie:

Thanks for your email. Dave Young is now working on another priority brownfield site closure. I will ask Dave to give you a call to provide an update to you. Take care. JT

J.T. Liu
Senior Water Resources Control Engineer
Los Angeles Regional Water Quality Control Board
Site Cleanup Unit II

(213) 576-6667 (tel)
(213) 576-6717 (fax)
E-Mail: Jliu@rb4.swrcb.ca.gov

>>> "Eddie Arslanian" <EArslanian@environcorp.com> 06/15/04 09:36AM >>>
JT, thank you for your expedited review of the West Valley Cleaners NFA form.

I still haven't heard from David Young on the Valley Alhambra form. Could you please give us an update?
We would like to move forward with well abandonment activities to completely get out of the way of the
new tenant at the site.

Thanks in advance.

-----Original Message-----

From: Ju-Tseng Liu [mailto:JLIU@rb4.swrcb.ca.gov]
Sent: Tuesday, May 25, 2004 11:53 AM
To: Eddie Arslanian
Cc: Arthur Heath; David Young
Subject: Re: Review of NFA Forms for two sites

** Reply Requested When Convenient **

Eddie:

Thanks for your email. We are making some minor revisions of the closure letter for West Valley Cleaners
and will submit the closure packet to upper management for approval tomorrow.

I will ask Dave Young to give you an update on Valley Alhambra closure. Take care. JT

J.T. Liu
Senior Water Resources Control Engineer
Los Angeles Regional Water Quality Control Board
Site Cleanup Unit II

(213) 576-6667 (tel)
(213) 576-6717 (fax)
E-Mail: Jliu@rb4.swrcb.ca.gov

>>> "Eddie Arslanian" <EArslanian@environcorp.com> 05/25/04 09:19AM >>>

> Dear JT,

>

> Could you please give me an update on the review status for the following sites?

>

> * SLIC No. 1006 (West Valley Cleaners, a.k.a., Tampa Vanowen Shopping Center): Dr. Arthur Heath
informed us last week that he submitted the NFA package to you for review.

>

> * SLIC No. 967 (Valley-Alhambra): We sent the NFA package to you and David Young on March 25,
2004. I have followed up with David Young on a couple of occasions but I think he's been pretty busy.

>

> Please call me at 213-943-6326 if you have any questions. Thank you

>

>

>

>

>

> Eddie Arslanian, P.E.
> ENVIRON International Corporation
> 707 Wilshire Boulevard, Suite 4950

> Los Angeles, California 90017
> Tel: 213.943.6326
> Fax: 213.943.6301
>

Exhibit J

From: [Eddie Arslanian](#)

Sent: Tue 8/10/2004 9:19 AM

To: ['David Young'](#)

Cc: [Bita Tabatabai](#)

Subject: Valley-Alhambra: Site History for NFA Form

Attachments:

[View As Web Page](#)

David, I received your voice message. Below, I have included a section on site history you can use for the closure form. It is an excerpt taken from our Interim Remedial Action Plan document dated April 30, 2001.

Can you please give us your timeframe for finalizing the forms? Thanks.

1.1 Site Description and History

The Site is located at 4900 East Valley Boulevard, Los Angeles, California in an industrial area of Los Angeles, California. North and south of the Site are manufacturing and distribution facilities, to the west is Valley Boulevard, and to the east are railroad tracks and industrial buildings.

From January 1972 to January 31, 1993, the Site was occupied by Harris Hub/Contract Metal Fabricators/Dresher, Inc. In 1990, Leggett and Platt purchased the business and continued the operation. Activities included receiving finished metal bed frames to be painted and assembled. As part of the painting process, two dip tanks and three USTs using paints was used (Figure 2). The three 750-gallon USTs were removed from the Site under the direction of the City of Los Angeles Fire Department (Fire Department). The subsurface investigations conducted during this time and subsequently are described in ENVIRON's Response to Request for Subsurface Site Assessment Work Plan dated April 30, 2001 (ENVIRON 2001c). Currently, the building is used as a warehouse for the storage of used garments by City Mission Industries, Inc. The warehouse operations since 1995 include sorting, pressing, bundling, and storage of the garments and various used furniture.

Eddie Arslanian, P.E.
ENVIRON International Corporation
707 Wilshire Boulevard, Suite 4950
Los Angeles, California 90017
Tel: 213.943.6326
Fax: 213.943.6301