

- LICENSE 1062 PLACE-OF-USE
- LICENSE 4060 PLACE-OF-USE
- EXISTING DIVERSION POINTS LICENSE 1062  
DIVERSION POINT 2 ALSO USED FOR LICENSE 4060

**POINTS OF DIVERSION - LICENSE 1062 AND LICENSE 4060**

License	Located on Parcel No.	Diversion Point Also Known As	Name of Point of Diversion in May 1954 Permit	Map Diversion Point	Point of Diversion Location Described in May 1954 Permit	Latitude Reported in SWRCB Database	Longitude Reported in SWRCB Database	Calculated Easting X Coordinate (NAD83-SPII)	Calculated Northing Y Coordinate (NAD83-SPII)	40-acre subdivision of public land survey or projection thereof	Section	Township	Range	B & M
1062	225-0102-001	unknown	MILE 9.8L	1	SOUTH TWO HUNDRED (200) FEET AND WEST TWO THOUSAND ONE HUNDRED FIFTY (2150) FEET FROM NE CORNER OF SECTION 12, T 9 N, R 3 E, MDB&M, BEING WITHIN NW1/4 OF NE1/4 OF SAID SECTION 12. (3.33 CUBIC FEET PER SECOND.)	38.65632276	-121.60326333	6,674,958	2,001,088	NW 1/4 OF NE 1/4	12	T9N	R3E	MD
1062 & 4060	225-0102-009	North River Pump	MILE 9.3L	2	SOUTH TWO THOUSAND TWO HUNDRED NINETY TWO (2292) FEET AND WEST EIGHT HUNDRED FORTY (840) FEET FROM NE CORNER OF SECTION 12, T 9 N, R 3 E, MDB&M, BEING WITHIN SE1/4 OF NE1/4 OF SAID SECTION 12. (1.34 CUBIC FEET PER SECOND - LICENSE 1062 AND 1.87 CUBIC FEET PER SECOND - LICENSE 4060.)	38.64999031	-121.59839636	6,676,358	1,998,788	SE 1/4 OF NE 1/4	12	T9N	R3E	MD
1062	225-0102-041	Pump 6	MILE 7.9L	3	SOUTH THREE THOUSAND FOUR HUNDRED FIFTY (3450) FEET AND WEST ONE THOUSAND SIX HUNDRED FEET FROM NE CORNER OF SECTION 7, T 9 N, R 4 E, MDB&M, BEING WITHIN NW1/4 OF SE1/4 OF SAID SECTION 7. (1.8 CUBIC FEET PER SECOND)	38.64854355	-121.58336538	6,680,658	1,997,188	NW 1/4 OF SE 1/4	7	T9N	R4E	MD
1062	225-0102-047	Pump 4	MILE 7.8L	4	SOUTH TWO THOUSAND NINE HUNDRED THIRTY (2930) FEET AND WEST SEVEN HUNDRED FIFTY (750) FEET FROM NE CORNER OF SECTION 7, T 9 N, R 4 E, MDB&M, BEING WITHIN NW1/4 OF SE1/4 OF SAID SECTION 7. (1.17 CUBIC FEET PER SECOND)	38.64827671	-121.57984783	6,681,658	1,998,188	NE 1/4 OF SE 1/4	7	T9N	R4E	MD
1062 & 4060	031-0200-047	Sacramento County Water Agency - Freeport Regional Water Authority Intake	n/a	5	n/a	38.4724213	-121.5065788	6,702,931	1,934,251	NE1/4 OF SW1/4	11	T7N	R4E	MD

Easting and Northing Coordinates from SWRCB Permit 21209 - Application 30454  
Calculated latitude and calculated longitude from easting/northing coordinates

MAP TO ACCOMPANY PETITION TO CHANGE  
 POINT OF DIVERSION AND PLACE-OF-USE  
 FOR LICENSES 1062 & 4060 APPLICATIONS  
 1061 & 14494, RESPECTIVELY  
 BY  
 SACRAMENTO COUNTY WATER AGENCY

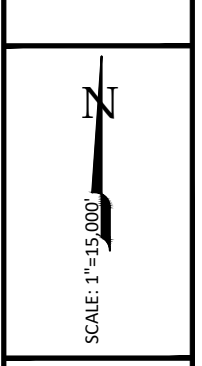
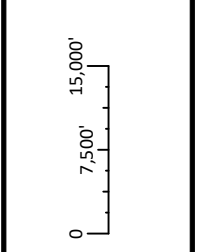

**SURVEYOR'S CERTIFICATE:**  
 I, JAMES L. WHITE, OF THE SACRAMENTO COUNTY (CALIFORNIA) SURVEY SECTION, DO HEREBY CERTIFY THAT THIS EXHIBIT WAS PREPARED BY ME (OR UNDER MY IMMEDIATE SUPERVISION) ON AUGUST 13-20, 2018, AS A SUBORDINATE DEPICTION OF THE SACRAMENTO COUNTY WATER AGENCY RESOLUTION NO. WA-2844 DESCRIPTION APPROVED BY THE BOARD OF SUPERVISORS ON MARCH 26, 2013, AND FROM RECORDED MAPS AND DEEDS FILED FOR RECORD IN THE OFFICE OF THE COUNTY RECORDER OF SACRAMENTO COUNTY, AND FROM U.S. GEOLOGICAL SURVEY 30x60-MINUTE SACRAMENTO AND LODI TOPOGRAPHIC QUADRANGLES, AND THAT THIS EXHIBIT CORRECTLY REPRESENTS THE PROJECT DESCRIBED IN THE ACCOMPANYING APPLICATION AND SHOWS THE LOCATION OF STREAMS AND DITCHES IN THE IMMEDIATE VICINITY.

S/ JAMES L. WHITE  
 CALIFORNIA PROFESSIONAL LAND SURVEYOR NO. 7722  
 09/04/2018  
 (DATE)