

CALIFORNIA REGIONAL WATER QUALITY CONTROL BOARD
CENTRAL COAST REGION
1102-A Laurel Lane
San Luis Obispo, California 93401

ORDER NO. 90-20

WASTE DISCHARGE REQUIREMENTS
FOR
WILBUR-ELLIS COMPANY
SALINAS, MONTEREY COUNTY

The California Regional Water Quality Control Board, Central Coast Region (hereafter Board), finds:

1. Wilbur-Ellis Company (hereafter Discharger), Post Office Box 1286, Fresno, California 93715, owns and operates a pesticide/fertilizer sales and application business at 20750 Spence Road, Salinas, Monterey County. The facility is located in Section 20, T15S, R4E, MD B&M, shown on Attachments "A" and "B". The Discharger has operated at this site since 1980.
2. Discharger sells pesticides and applies them to agricultural farmlands using ground application equipment.
3. Dilute rinsewaters containing pesticide residues are treated onsite using sedimentation, ozonation and carbon filtration. Treated rinsewater is reused for rinsing equipment. Tank sediments and spent carbon are recycled, or disposed at a regulated site, as required. Storm drainage is diverted away from areas where it may become contaminated and is discharged into a drainageway tributary to the Salinas River.
4. Domestic wastes are discharged to a septic tank/leachfield system.
5. Well logs from the vicinity indicate underlying geology to consist of topsoil and clay to a depth of approximately 20 feet, below which is a mixture of sand, gravel and clay. The aquifer underlying the site is considered to be an unconfined aquifer.
6. The Monterey County Flood Control and Water Conservation District reports the first encountered ground water ranges from about 50 to 80 feet beneath ground surface and moves in a north-northwesterly direction. Ground water gradient may vary depending on the season and nearby agricultural pumping rates.

7. These waste discharge requirements are being revised pursuant to Title 23, Chapter 3, Subchapter 9, Section 2232.2 (Periodic Review of Waste Discharge Requirements). The discharge has been regulated by Waste Discharge Requirements Order No. 85-17, adopted by the Board on January 11, 1985.
8. The Water Quality Control Plan, Central Coastal Basin, (Basin Plan) was originally adopted by the Board on March 14, 1975, and approved by the State Water Resources Control Board on March 20, 1975. It is updated periodically. The Basin Plan incorporates statewide plans and policies by reference and contains a strategy for protecting beneficial uses of State Waters. The Basin Plan states that whenever the existing water quality is better than what is established by objectives, the existing quality shall be maintained.
9. The Basin Plan designates the following beneficial uses for ground water underlying the site: domestic and municipal supply, agricultural supply and industrial supply. Deeper aquifers are currently used for domestic supply. Existing and anticipated beneficial uses of nearby surface water (Salinas River) include: agricultural and industrial supply; ground water recharge; contact and noncontact water recreation; wildlife habitat; cold freshwater habitat; warm freshwater habitat; fish migration; and, fish spawning.
10. Discharge of waste is a privilege, not a right, and authorization to discharge is conditional upon the discharge complying with provisions of Division 7 of the California Water Code and any more stringent effluent limitations necessary to implement water quality control plans, to protect beneficial uses, and to prevent nuisance. Compliance with this Order should assure conditions are met and mitigate any potential adverse changes in water quality due to the facility's operation.
11. These requirements are for an existing facility and their adoption is exempt from the provisions of the California Environmental Quality Act (Public Resources Code, Section 21000, et seq.) in accordance with Section 15301, Chapter 3, Title 14, of the California Code of Regulations (Existing Facilities Exemption).
12. On December 4, 1989, the Board notified the Discharger and interested persons of its intent to issue revised requirements for this facility, provided them a copy of the proposed Order, and gave them an opportunity to submit their written views and recommendations.

13. In a public hearing on January 12, 1990, the Board heard and considered all comments pertaining to the discharge of waste at the facility and found this Order consistent with the above findings.

IT IS HEREBY ORDERED, pursuant to authority in Section 13263 of the California Water Code, Wilbur-Ellis Company, its agents, successors, and assigns, shall maintain compliance with the following:

(Note: Other prohibitions and conditions, definitions and the method of determining compliance are contained in the attached "Standard Provisions and Reporting Requirements for Waste Discharge Requirements," dated January, 1984. Applicable paragraphs are referenced in paragraph C-3.)

A. Discharge Prohibitions

1. Discharge, overflow, bypass, leakage, seepage, and overspray of any waste or contaminated site runoff water to drainageways and adjacent properties are prohibited.
2. Discharge of hazardous materials at the site, other than to impermeable containment vessels, is prohibited.

B. Discharge Specifications

1. Empty pesticide containers shall be disposed of only at a disposal site approved by the Regional Board to receive these wastes. Opened and non-waterproof containers shall be properly stored and protected to prevent spillage, overtopping and leakage which could impact surface or ground water quality.
2. Hazardous waste, if generated, shall be discharged to a regulated waste disposal site approved by the Board to receive hazardous and/or toxic waste, or recycled or treated onsite, unless it is demonstrated by analysis that the waste is non-hazardous/non-toxic and the Executive Officer acknowledges same in writing.
3. Fertilizer storage tank sludge and fertilizer spill cleanup material may be applied to farmland in accordance with good agricultural practice.

4. Residues from pesticide spill cleanup and/or other activity, such as yard scraping, shall be discharged to an appropriate waste disposal site approved by the Board, unless it is demonstrated by analysis that the material can be safely applied at non-regulated sites and application is approved in writing by the Executive Officer.
5. Surface drainage shall be intercepted and diverted away from areas where the water may be contaminated by business activities.
6. All storm drainage contaminated as a result of operations at this facility shall be contained and properly disposed.
7. Collected and stored rinsewater containing pesticide and fertilizer residues shall be disposed of in accordance with the law and in a manner approved by the Board. If applied to farmland, they shall be applied in amounts considered to be sound agricultural practice.
8. Storage and transport of hazardous materials shall be in compliance with state laws and regulations.
9. Discharger shall cleanup, remove and relocate any material discharged at this site in violation of these requirements.

C. Provisions

1. Discharger shall maintain a copy of this Order and an Operation Plan at the site where they are always available to operating personnel and regulatory authorities. Whenever a substantial change in operation is made that varies from the existing plan, the plan shall be updated and the discharger shall promptly notify the Board and submit a copy of the updated plan.
2. This Board considers the property owner to have a continuing responsibility for correcting any problems which may arise in the future as a result of this business operation or of water applied to this property during subsequent use of the land for other purposes.
3. Discharger shall comply with items of the attached "Standard Provisions and Reporting Requirements for Waste Discharge Requirements", dated January, 1984, listed below:

- A. 7, and 18 through 24.
 - B. 1 and 3 through 7.
 - C. 1, 3, 5, 6, 7, and 10 through 15.
 - E. 1 through 4.
 - F. 1, 2, 6, 8, 13, 15, 16, 18 and 19.
4. Discharger shall notify the Regional Board's Executive Officer and the Monterey County Health Department of significant spills within four hours.
 5. Discharger shall comply with "Monitoring and Reporting Program No. 90-20," as specified by the Executive Officer.
 6. Order No. 85-17, "Waste Discharge Requirements for Wilbur-Ellis Company, Salinas, Monterey County," adopted by the Board on January 11, 1985, is hereby rescinded.
 7. Pursuant to Title 23, Chapter 3, Sub-Chapter 9, of the California Code of Regulations, the Discharger must submit a written report to the Executive Officer not later than July 1, 1994, that addresses:
 - a. Whether there will be changes in the continuity, character, location, or volume of wastewater over the subsequent five years; and,
 - b. Whether, in the Discharger's opinion, there is any portion of the Order that is incorrect, obsolete, or otherwise in need of revision.

I, WILLIAM R. LEONARD, Executive Officer, do hereby certify the foregoing is a full, true, and correct copy of an Order adopted by the California Regional Water Quality Control Board, Central Coast Region, on January 12, 1990.

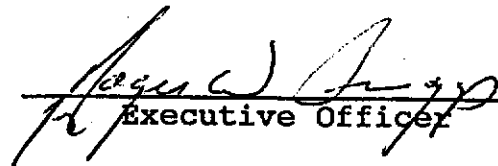
Executive Officer

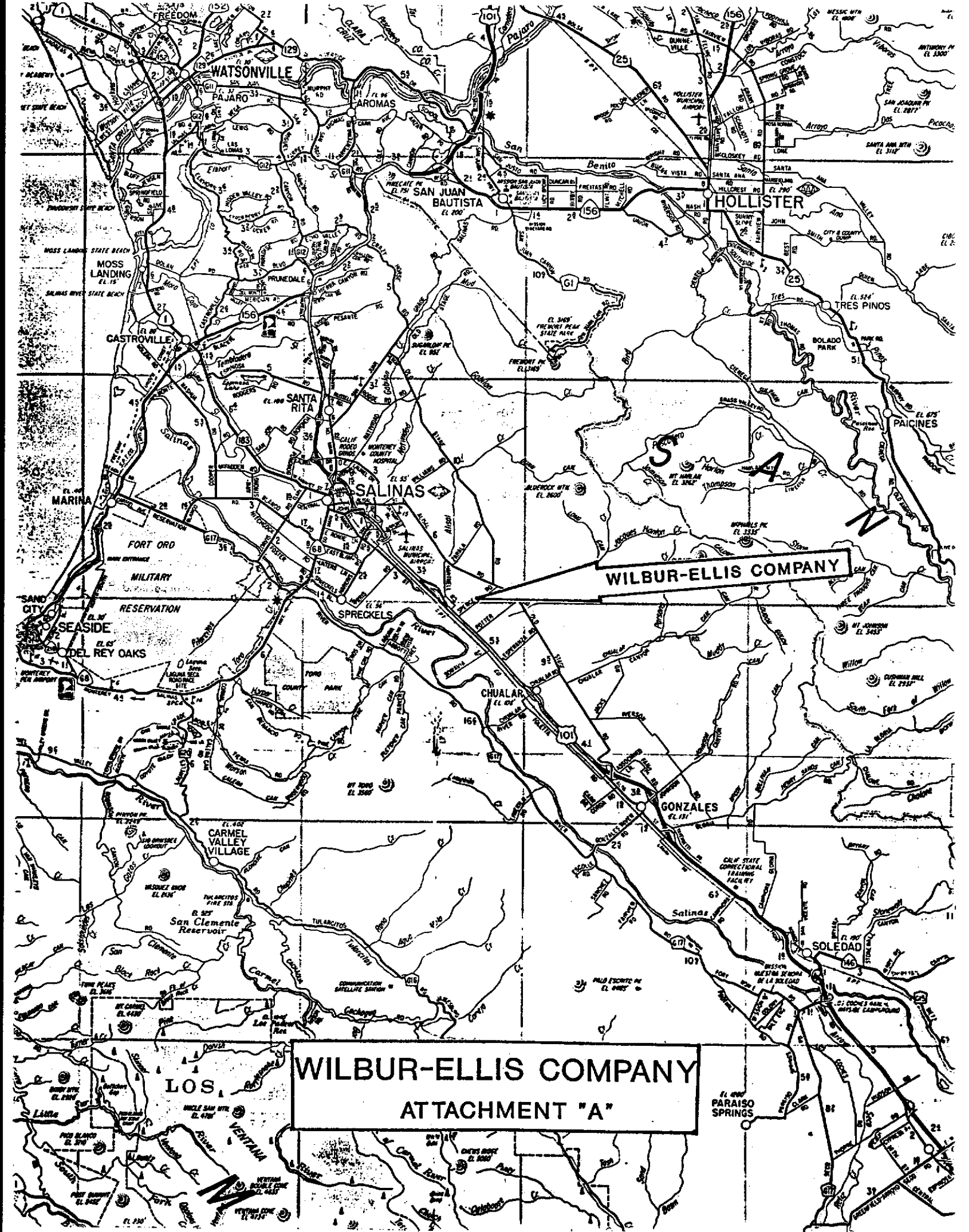

WILBUR-ELLIS COMPANY

WILBUR-ELLIS COMPANY
ATTACHMENT "A"

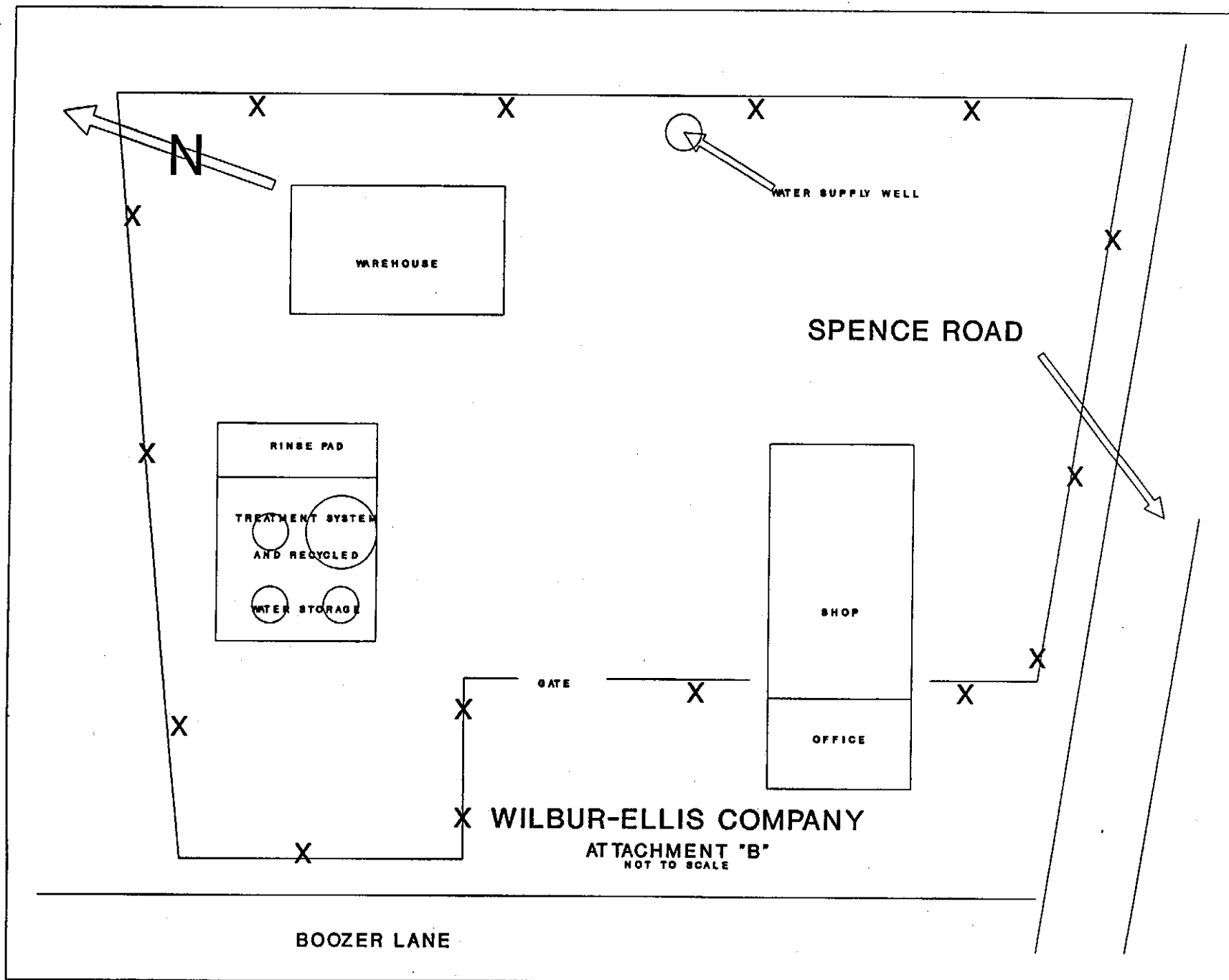

N

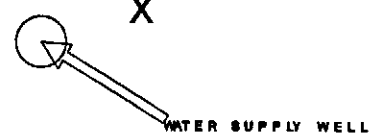

SPENCE ROAD

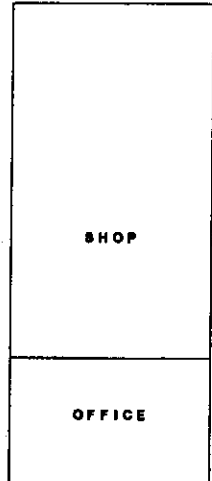
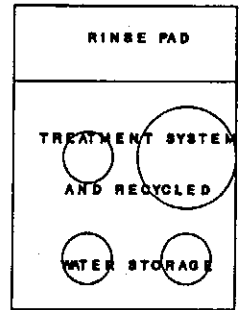

GATE

WILBUR-ELLIS COMPANY

ATTACHMENT "B"
NOT TO SCALE

BOOZER LANE

CALIFORNIA REGIONAL WATER QUALITY CONTROL BOARD
CENTRAL COAST REGION

MONITORING AND REPORTING PROGRAM NO. 90-20

FOR
WILBUR-ELLIS COMPANY,
SALINAS, MONTEREY COUNTY

WASTE DISPOSAL/REUSE MONITORING

Records shall be kept of the quantities of rinsewater and captured storm runoff subsequently disposed offsite. The following shall be reported:

Volume of liquids and solids containing Group I waste that are transported and disposed offsite. Disposal site(s) shall be properly identified.

Volume of fertilizer residues disposed offsite (including that applied to farmlands).

Disposal/reuse sites shall be properly identified.

Records shall be kept of all significant spills and subsequent cleanup actions. These shall be reported to the Board.

At least annually, fertilizer rinsewater disposed offsite shall be sampled and analyzed for nutrient constituents and site specific pesticide residues.

Analytical data shall be submitted with monitoring reports.

GROUND WATER MONITORING

By March 1, 1990, at least three ground water monitoring wells shall be constructed to the first encountered ground water. The wells shall be constructed under the supervision of a registered geologist, registered engineer, or a certified engineering geologist. The wells shall be constructed in accordance with the California Water Code, Division 7, Chapter 10, and implementing regulations.

At least one well shall be installed upgradient and two immediately downgradient of the site. The wells must be constructed to allow sampling the first encountered ground water and placed to detect any chemicals from the facility reaching ground water.

Prior to sampling, the ground water elevations shall be measured. Wells shall then be purged of at least four saturated casing volumes (preferably until pH, temperature and electrical conductivity reach steady state), and then be allowed to recover. Once recovered, the wells shall be sampled. Samples shall be analyzed for the four

major pesticide groups, fertilizer nutrients and volatile organic chemicals (e.g. EPA Method 624). Depending on the results, subsequent samples may be analyzed for site specific compounds. Following the initial sampling, samples shall be collected twice annually in March and September.

In lieu of constructing ground water monitoring wells, a site audit and assessment may be performed, as outlined in a letter from the Executive Officer to Wilbur-Ellis Company dated October 17, 1989.

REPORTING

Monitoring reports containing data from the previous quarter shall be submitted by the 20th of January, April, July and October. The laboratory analysis sheets for ground water monitoring and fertilizer rinsate monitoring shall be submitted in addition to the tabulated data.

ORDERED BY

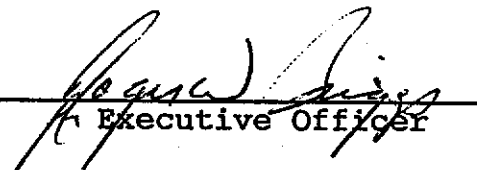
Executive Officer

January 12, 1990

Date

sm18:90-20.MRP