

CALIFORNIA REGIONAL WATER QUALITY CONTROL BOARD
COLORADO RIVER BASIN REGION

ORDER NO. 89-025

WASTE DISCHARGE REQUIREMENTS
FOR
I.V. TOMATO GRADING STATION
Northwest of Westmorland - Imperial County

The California Regional Water Quality Control Board, Colorado River Basin Region, finds that:

1. Norman Meek (hereinafter referred to as the discharger), 449 Pine Avenue, Holtville, CA 92250, submitted a Report of Waste Discharge, dated January 5, 1989.
2. The discharger proposes to discharge an average of 15,000 gallons-per-day of wastewater from a tomato grading station located about 7 miles northwest of Westmorland (southeast corner of Bannister Road and Highway 86), as indicated on the attached site map. For final disposal, the wastewater would be discharged to an on-site evaporation-percolation pond located in the W $\frac{1}{2}$ of Section 10, T13S, R12E, SBB&M.
3. The purpose of the facility is to test and grade the tomatoes by personnel from U.S. Department of Agriculture (USDA) prior to being shipped to processors. The facility operates as follows: Trucks carrying tomatoes from the farmers' fields arrive at the grading station, are first weighed and then proceed to the testing station. Several tomato samples are taken from each truck by an automatic sampling device. The samples are then weighed, checked and tested for color, quality and suitability by USDA personnel. At the testing station some tomatoes fall off the trucks onto the concrete slab. Damaged or crushed tomatoes are removed and put in a bin. The concrete slab is then washed clean by water supplied from an Imperial Irrigation District canal. This washwater would be discharged to the proposed evaporation-percolation pond.

The grading station is used only during the tomato harvesting season, May through July of each year.

4. The Water Quality Control Plan for the Colorado River Basin Region of California was adopted by the Regional Board on November 14, 1984.
5. The Basin Plan delineates the location of proposed discharge to be in the Imperial Hydrologic Unit. The beneficial uses of ground water at some locations of the hydrologic unit are:

*Superseded
by Bd. Ord.
#94-029
3/15/94*

- a. Municipal supply
- b. Industrial supply

However, ground water at the proposed pond site is not beneficially used.

- 6. The discharger reports that there are no water wells in the vicinity of the proposed pond site.
- 7. Imperial County Planning Department adopted on January 25, 1989 a Negative Declaration for this project. This Negative Declaration (C. U. P. 830-88) indicates that said project would not have a significant adverse effect on surface or ground water quality.
- 8. The proposed discharge is exempt from the provisions of Subchapter 15, Chapter 3, Title 23 of the California Code of Regulations in accordance with Section 2511 of same Subchapter 15.
- 9. The Board has notified the discharger and interested agencies and persons of its intent to update waste discharge requirements for the discharge.
- 10. The Board in a public meeting heard and considered all comments pertaining to the existing discharge.

IT IS HEREBY ORDERED that the discharger shall comply with the following:

A. Discharge Specifications

- 1. Neither the treatment nor the discharge of wastewater shall create pollution or nuisance as defined in Section 13050 of the California Water Code.
- 2. A minimum depth of freeboard of at least two (2) feet shall be maintained in the earthen pond.
- 3. Adequate protective works shall be provided to assure that flood or surface drainage waters do not erode or otherwise render portions of the treatment and discharge facility inoperable.
- 4. There shall be no surface flow of wastewater away from the pond into the Trifolium Storm Drain or into any channel which drains to the New River or the Salton Sea.
- 5. Treatment of wastewater shall be conducted by technical procedures which will maintain an aerobic environment in the pond.
- 6. Wastewater discharged to the pond shall be substantially free of decomposable organic matter.
- 7. The discharger shall provide approved solid waste containers on-site for the proper disposal of all solid waste.

B. Provisions

1. Prior to any modifications in this facility which would result in material change in the quality or quantity of wastewater discharged, or any material change in location of discharge, the discharger shall report in writing to the Regional Board.
2. The discharger shall comply with "Monitoring and Reporting Program No. 89-025", and future revisions thereto, as specified by the Executive Officer.
3. In the event of any change in operation, or in control or ownership of land or waste disposal facilities owned or controlled by the discharger, the discharger shall:
 - a. Notify this Board of such change; and
 - b. Transmit a copy of this Order to the succeeding owner or operator, and file a copy of the transmittal letter with this Board.

I, Phil Gruenberg, Executive Officer, do hereby certify the foregoing is a full, true and correct copy of an Order adopted by the California Regional Water Quality Control Board, Colorado River Basin Region, on March 22, 1989.

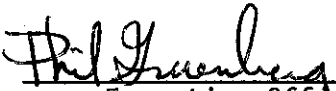
Executive Officer

CALIFORNIA REGIONAL WATER QUALITY CONTROL BOARD
COLORADO RIVER BASIN REGION

MONITORING AND REPORTING PROGRAM NO. 89-025
FOR
I.V. TOMATO GRADING STATION
Northwest of Westmorland - Imperial County

Location of Discharge: W $\frac{1}{2}$ of Section 10, T13S, R12E, SBB&M

MONITORING

The discharger shall submit a status report at the end of each operating season on the following:

1. Whether or not the grading station had been in operation for that season.
2. Estimated volume of daily discharge of wastewater to the pond in gallons-per-day for the entire season.
3. List of proposed changes (if any) for the next operating season concerning the disposal of wastewater to the pond.

REPORTING

The status report for each operating season shall be signed by a duly authorized person and submitted to the Regional Board by not later than August 15 of each year.

Submit monitoring reports to:

California Regional Water Quality Control Board
Colorado River Basin Region
73-271 Highway 111, Suite 21
Palm Desert, CA 92260

ORDERED BY:

Phil Greenberg
Executive Officer

March 22, 1989
Date

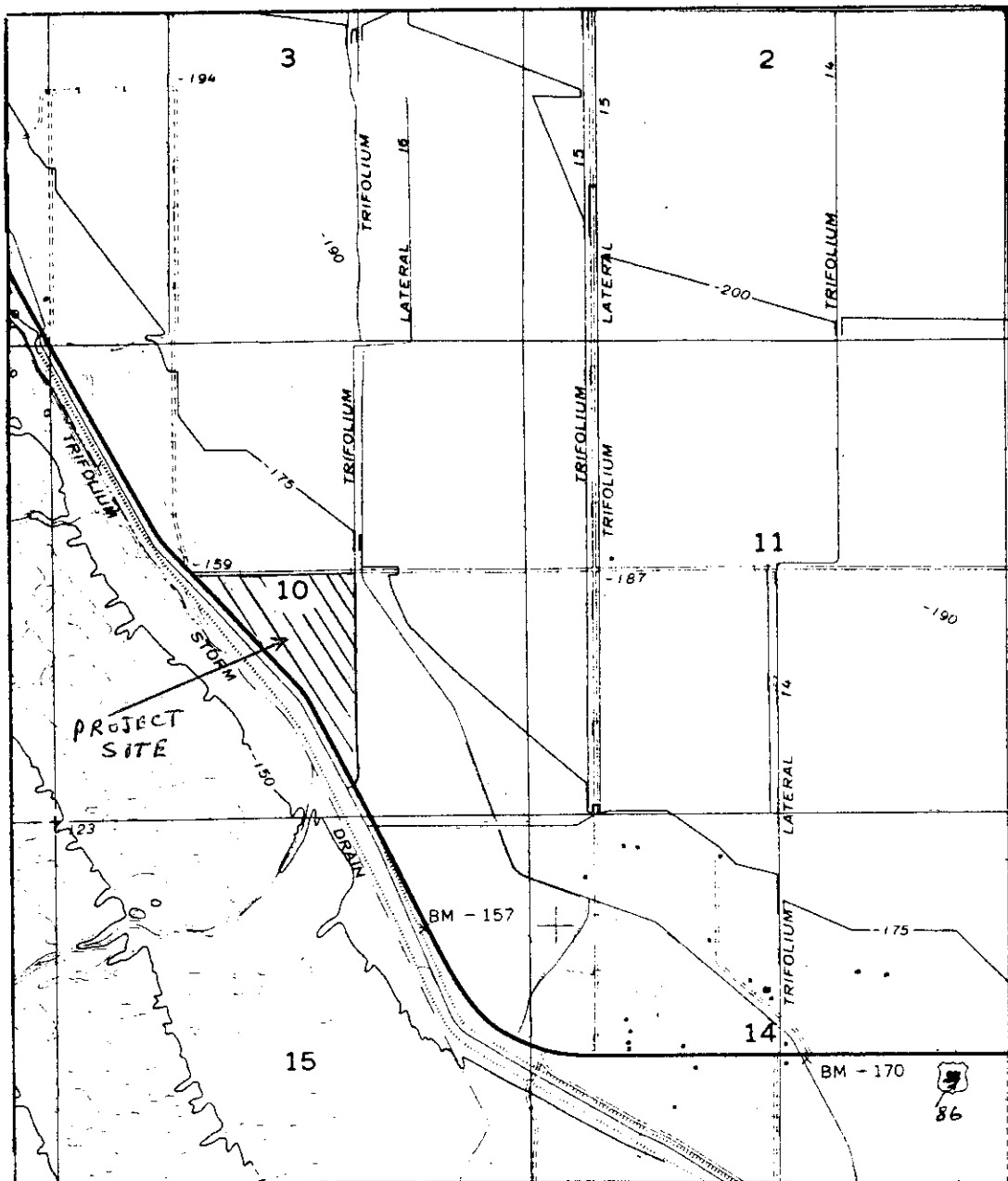

SITE MAP

I.V. TOMATO GRADING STATION
Northwest of Westmorland - Imperial County
W $\frac{1}{2}$ of Section 10, T13S, R12E, SBB&M
USGS Calipatria 7.5 min Topographic Map

Order No. 89-025