

CALIFORNIA REGIONAL WATER QUALITY CONTROL BOARD
COLORADO RIVER BASIN REGION

ORDER NO. 89-045

WASTE DISCHARGE REQUIREMENTS
FOR
DESERT HILLS FACTORY STORES
Cabazon - Riverside County

The California Regional Water Quality Control Board, Colorado River Basin Region, finds that:

1. Al Snyder (hereinafter referred to as the discharger), 508 N. Pacific Coast Highway, Redondo Beach, CA 90254, submitted a report of waste discharge, dated April 25, 1989.
2. The discharger is discharging a maximum of 22,500 gallons-per-day of domestic sewage from a retail shopping center, which consists of a 192-seat food court (7 fast-food restaurants) and 49 retail stores with 8 public restroom facilities. The wastewater is to be discharged into septic tank/seepage pit disposal systems located in the N $\frac{1}{2}$ of Section 7, T3S, R2E, SBB&M.
3. The discharger is reserving areas of sufficient size for possible future 100 percent replacement of the seepage pits.
4. There are no wells within 200 feet of the discharge facilities described in Findings No. 2 and 3 (above).
5. The discharge area is underlain by recent alluvial fan deposits consisting of mainly rocks and coarse sand. The reported depth to the water table from records of nearby wells in the discharge area is approximately 500 feet below ground surface.
6. The Water Quality Control Plan for the Colorado River Basin Region of California was adopted by the Regional Board on November 14, 1984.
7. The Basin Plan delineates the location of discharge to be in the San Gorgonio Hydrologic Subunit, which has the following beneficial uses of ground water:
 - a. Municipal supply
 - b. Industrial supply
 - c. Agricultural supply
8. The Board has notified the discharger and interested agencies and persons of its intent to prescribe waste discharge requirements for the proposed discharge.

CHANGE OF OWNERSHIP
11/38/90
90-081

3/29/95
superseded by
Order No. 95-035

9. The Board in a public meeting heard and considered all comments pertaining to the proposed discharge.
10. The Riverside County Board of Supervisors approved Environmental Impact Report No. 286 (approval date November 22, 1988), for this shopping center. The Regional Board has reviewed this EIR. The below waste discharge requirements are designed to mitigate any significant adverse effects on water quality.

IT IS HEREBY ORDERED, the discharger shall comply with the following:

A. Discharge Specifications

1. Neither the treatment nor the discharge of wastewater shall create pollution or nuisance as defined in Division 7 of the California Water Code.
2. No wastewater other than domestic sewage shall be discharged at this location.
3. Wastewater discharged subsurface shall be retained underground with no surfacing.
4. Adequate measures shall be taken to assure that flood or surface drainage waters do not erode or otherwise render portions of the discharge facilities inoperable.
5. Septic tank cleanings shall be discharged only by a duly authorized service.

B. Provisions

1. Sufficient land area shall be reserved for possible future 100 percent replacement of the seepage pits, until such time as this complex is connected to a municipal sewerage system.
2. The discharger shall comply with "Monitoring and Reporting Program No. 89-045", and future revisions thereto, as specified by the Executive Officer.
3. Prior to any modifications in this facility which would result in material change in the quality or quantity of wastewater discharged, or any material change in location of discharge, the discharger shall report in writing to the Regional Board.
4. Prior to any change of ownership of this commercial complex, the discharger shall:
 - a. Specify as a condition of transfer that the area specified in Provision B.1 (above) remain servient to the development for the purpose of providing additional subsurface sewage disposal

capacity, until such time as this complex is connected to a municipal sewerage system.

- b. Transmit a copy of this Order to the succeeding owner or operator, and file a copy of the transmittal letter with this Board.

I, Phil Gruenberg, Executive Officer, do hereby certify the foregoing is a full, true and correct copy of an Order adopted by the California Regional Water Quality Control Board, Colorado River Basin Region, on June 28, 1989.

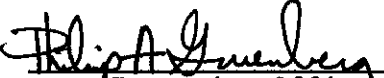
Executive Officer

CALIFORNIA REGIONAL WATER QUALITY CONTROL BOARD
COLORADO RIVER BASIN REGION

MONITORING AND REPORTING PROGRAM NO. 89-045
FOR
DESERT HILLS FACTORY STORES
Cabazon - Riverside County

Location of Discharge: Portion of the N $\frac{1}{2}$ of Section 7, T3S, R2E, SBB&M

MONITORING

The discharger shall submit an annual status report on the following:

1. Estimate of the maximum daily flow of sewage discharged to the sewerage systems.
2. List any proposed changes in the sewage disposal facilities during the upcoming year.

REPORTING

1. Annual reports shall be submitted to the Regional Board by January 15th of each year to:

California Regional Water Quality Control Board
Colorado River Basin Region
73-271 Highway 111, Suite 21
Palm Desert, CA 92260

2. Report immediately any surfacing of wastewater or other failures of the system by telephone and follow-up by letter.

ORDERED BY:

Philip A. Greenberg
Executive Officer

June 28, 1989
Date

CALIFORNIA REGIONAL WATER QUALITY CONTROL BOARD - 7

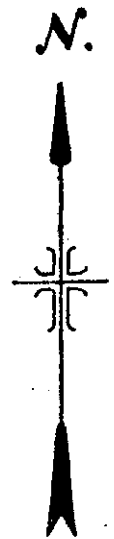
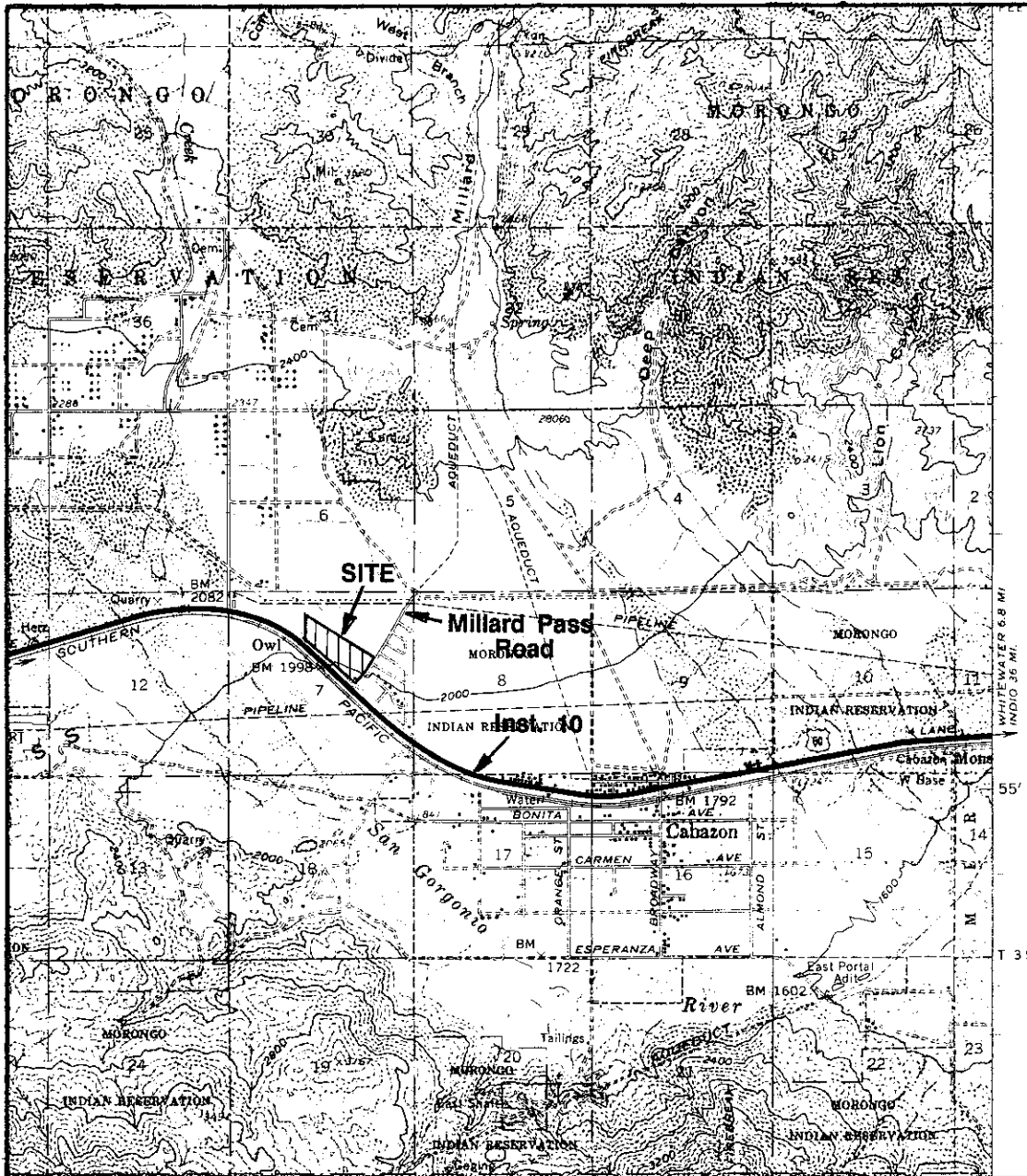

Scale:
1" = 1 mi.

SITE MAP

DESERT HILLS FACTORY STORES
Cabazon - Riverside County
Portion of N $\frac{1}{2}$ of Section 7, T3S, R2E, SBB&M
USGS Banning 15 min. Topographic Map

Order No. 89-045

○ PRIMARY SEEPAGE PITS,
20 FEET BELOW INLET.

SCALE: 1"=210'±

○ EXPANSION SEEPAGE PITS,
20 FEET BELOW INLET.

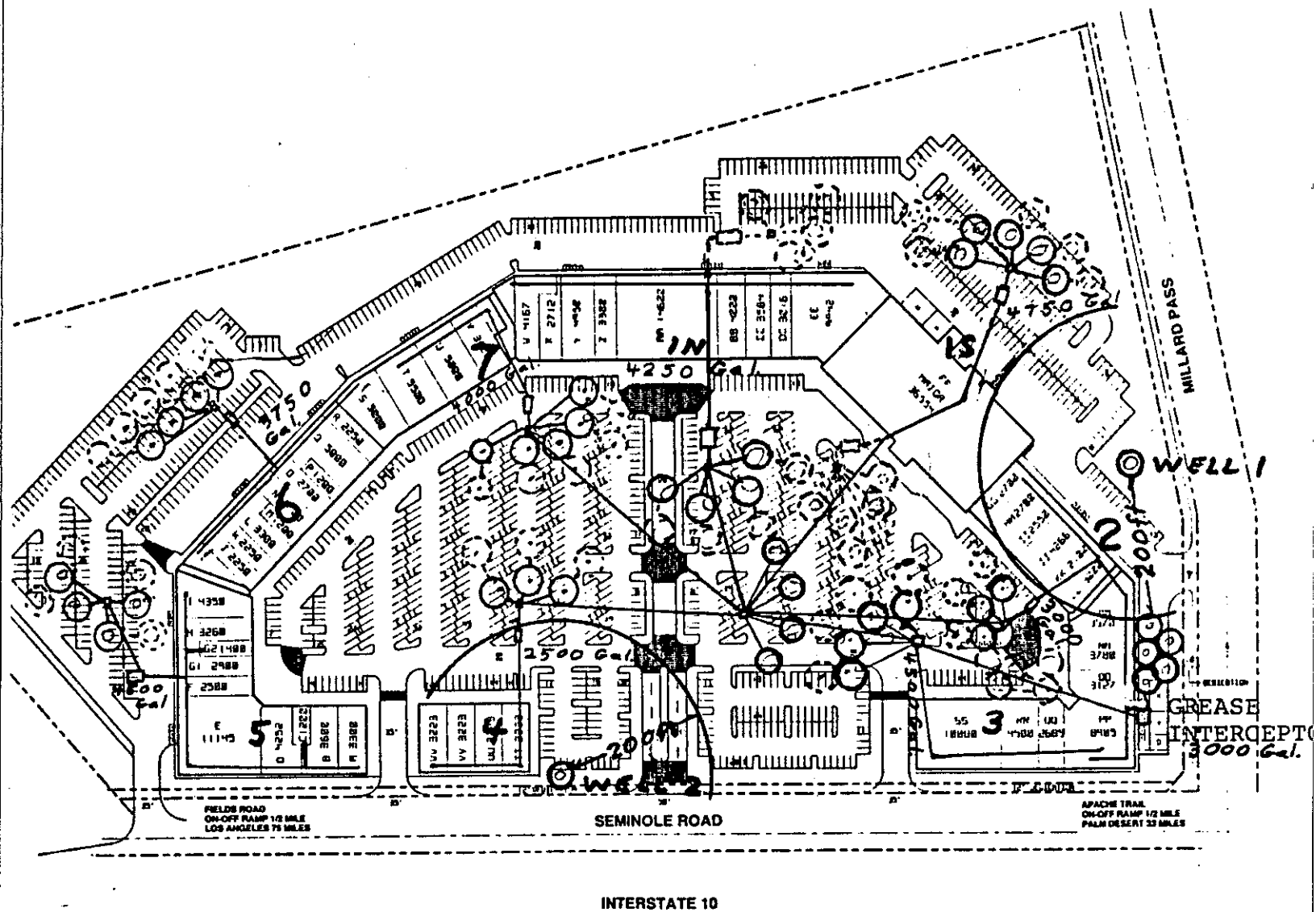

SEPTIC TANKS

DESERT HILLS FACTORY STORES

PRELIMINARY SEWAGE DISPOSAL FACILITIES SKETCH