

**CALIFORNIA REGIONAL WATER QUALITY CONTROL BOARD,
LAHONTAN REGION
PUBLIC HEARING SCHEDULED FOR
JANUARY 16-17, 2013**

**TRANSMITTAL OF PROSECUTION TEAM'S WRITTEN MATERIALS
FOR CONSIDERATION OF COMPLAINT NO. R6T-2012-0049**

FOR

**ADMINISTRATIVE CIVIL LIABILITY ISSUED TO
ARIMOL GROUP, INC.
LAKE ARROWHEAD
SAN BERNARDINO COUNTY
WDID NO. 6B36C363433**

TABLE OF CONTENTS

SECTION I:	List of Witnesses
SECTION II:	Summary of Testimony
SECTION III:	List of Exhibits
SECTION IV:	Exhibits
SECTION V:	List of Documents Included by Reference

SECTION I

LIST OF WITNESSES

LIST OF WITNESSES

1. Jan Zimmerman, P.G., Engineering Geologist, Regional Water Quality Control Board, Lahontan Region
2. Patrice Copeland, P.G., Senior Engineering Geologist, Regional Water Quality Control Board, Lahontan Region
3. Mike Plaziak, P.G, Supervising Engineering Geologist, Regional Water Quality Control Board, Lahontan Region
4. Lisa Scorable, P.G., Engineering Geologist, Regional Water Quality Control Board, Lahontan Region
5. Scott C. Ferguson, P.E., Senior Water Resource Control Engineer, Chief - Enforcement and Special Projects Unit, Regional Water Quality Control Board, Lahontan Region
6. Charles L. Curtis, P.E., Supervising Water Resource Control Engineer, Manager - Cleanup and Enforcement Division, Regional Water Quality Control Board, Lahontan Region
7. Lauri Kemper, P.E., Assistant Executive Officer, Regional Water Quality Control Board, Lahontan Region
8. Gerald Horner, Economist, State Water Resources Control Board
9. Joanna Gibson, California Department of Fish and Game
10. Jeff Brandt, California Department of Fish and Game
11. Terri Rahhal, Planning Director, Land Use Services, San Bernardino County
12. John Gomes, Site Representative for Arimol Group, Inc.
13. Bobby Rabun, Site Manager for Arimol Group, Inc.
14. Paul Christopher, Land Surveyor, Environmental Hightech Engineering
15. Bryant Bergeson, Civil Engineer, Kadtec Engineering
16. Gerald Montgomery, Construction Stormwater Consultant, Montgomery & Associates
17. Joyce Hunting, Conservation Planning and Biology Lead, PMC Consulting
18. Summer Pardo, Associate Biologist, PMC Consulting

19. Brian Pattison, Concerned Citizen, No Serenity
20. Curtis and Tami Bayer, Concerned Citizens, No Serenity
21. Alissa Blackburn, Concerned Citizen
22. Bruce Risher, Concerned Citizen
23. Don Fischer, Sierra Club, San Bernardino Mountains Group
24. Hugh Bialecki, Save Our Forest Association, Inc.
25. Lyle Barkley, Barkley Plumbing

SECTION II

SUMMARY OF TESTIMONY

**SUMMARY OF TESTIMONY OF JAN ZIMMERMAN, PATRICE COPELAND,
MIKE PLAZIAK, GERALD HORNER, LISA SCORALLE, SCOTT C. FERGUSON,
CHARLES L. CURTIS AND LAURI KEMPER**

- Evidence showing Arimol Group, Inc. (Arimol) and/or its representatives are developing five properties northeast of the intersection of Meadowbrook Road and Cedar Court in Lake Arrowhead (Site);
- Evidence showing Arimol initiated Site grading activities in excess of one acre without first obtaining coverage under Order No. 2009-0009-DWQ (Construction General Permit);
- Evidence showing Arimol discharged waste and fill material to surface waters of the United States without first obtaining federal Clean Water Act section 401/404 Certification for dredge and fill activities on the Site;
- Evidence supporting violations of Water Board Cleanup and Abatement Order No. R6V-2012-0008 for failure to submit acceptable reports as specified in the Order;
- Legal authority for the Water Board to impose administrative civil liability for unauthorized discharges to waters of the United States;
- Legal authority for the Water Board to impose administrative civil liability for violations of Cleanup and Abatement Order No. R6V-2012-0008;
- Application of Enforcement Policy administrative civil liability methodology and supporting information; and
- Recommendation to the Water Board.

**SUMMARY OF TESTIMONY OF JOANNA GIBSON AND JEFF BRANDT,
CALIFORNIA DEPARTMENT OF FISH AND GAME**

- Authenticate copies of California Department of Fish and Game documentation and communications with Arimol Group, Inc. and/or its representatives

**SUMMARY OF TESTIMONY OF TERRI RAHHAL, PLANNING DIRECTOR,
LAND USE SERVICES, SAN BERNARDINO COUNTY**

- Authenticate copies of documentation and communications between San Bernardino County Land Use Services and Arimol Group, Inc. and/or its representatives

**SUMMARY OF TESTIMONY OF
JOHN GOMES, SITE REPRESENTATIVE AND
BOBBY RABUN, SITE MANAGER FOR
ARIMOL GROUP, INC., SERENITY LODGE, AND/OR SERENITY
CONFERENCE AND RETREAT CENTER**

- Meadowbrook Site grading and construction activities, and development/land use purposes.

**SUMMARY OF TESTIMONY OF PAUL CHRISTOPHER OF
ENVIRONMENTAL HIGHTECH ENGINEERING,
BRYANT BERGESON OF KADTEC ENGINEERING,
GERALD MONTGOMERY OF MONTGOMERY AND ASSOCIATES,
JOYCE HUNTING AND SUMMER PARDO OF PMC CONSULTING -
CONSULTANTS FOR BILL MOLLER/ARIMOL GROUP, INC.**

- Meadowbrook Site grading, development, and construction activities and land use purposes; surveying and engineering; storm water permitting and compliance; wetland delineation, wetland/surface water permitting and compliance.

**SUMMARY OF TESTIMONY OF BRIAN PATTISON, CURTIS AND TAMI BAYER,
ALISSA BLACKBURN, BRUCE RISHER, DON FISCHER AND HUGH BIALECKI**

- Meadowbrook Site history, grading, construction and development activities, surface water impacts and related complaints.

**SUMMARY OF TESTIMONY OF LYLE BARKLEY,
BARKLEY PLUMBING**

- Site construction activities, and plumbing systems and installation.

SECTION III

LIST OF EXHIBITS

LIST OF EXHIBITS

Exhibit No.	Description of Exhibit
1	San Bernardino County Stop Work Order dated October 14, 2011, Water Board Complaint Report dated October 17, 2011 and other complaints received by Water Board staff
2	Water Board staff's 1 st Site Inspection Report for October 21, 2011 Site Inspection
3	Water Board Notice of Noncompliance dated November 21, 2011 to Arimol Group, Inc.
4	Water Board SEL email dated January 27, 2012 to Bill Moller/Arimol Group, Inc. (details staff's 3 rd Site Inspection on that date)
5	Water Board SEL email dated February 6, 2012 to Bill Moller/Arimol Group, Inc.
6	Water Board SEL email dated March 16, 2012 to Bill Moller/Arimol Group, Inc. (details staff's 5 th Site Inspection on that date)
7	Water Board SEL email dated April 10, 2012 to Bill Moller/Arimol Group, Inc. (details staff's 6 th Site Inspection on April 3, 2012)
8	Arimol Group, Inc. April 13, 2012 letter to Water Board
9	Arimol Group, Inc. Notice of Intent dated April 13, 2012
10	Water Board SEL email dated April 20, 2012 to Bill Moller/Arimol Group, Inc.
11	Water Board SEL email dated June 11, 2012 to Bill Moller/Arimol Group, Inc.
12	Bill Moller/Arimol Group, Inc. June 14, 2012 email response to Water Board June 11, 2012 SEL
13	Water Board Notice of Violation (NOV) dated June 20, 2012 to Bill Moller/Arimol Group, Inc. (w/o attachments)
14	Water Board SEL email dated August 20, 2012 to Bill Moller/Arimol Group, Inc.
15	Water Board staff's August 23, 2012 email response to Bill Moller/Arimol's August 23, 2012 email

LIST OF EXHIBITS, continued

16	Water Board Comments on Revised Grading Plan Submittal and Notice of Continued Violation of CAO, dated October 19, 2012 (w/o attachments)
17	State Board Economist's Revised Economic Benefit Analysis dated November 21, 2012

SECTION IV

EXHIBITS

EXHIBIT NO. 1

APN 0336-134-02

County of San Bernardino
BUILDING AND SAFETY DIVISION

To ARIMOL GROUP INC

Address 985 MEADOWBROOK Date 10-14-11

CORRECTION NOTICE COMPLAINT

Permit No. NO PERMIT

STOP ALL WORK

#1 OBTAIN FISH & GAME APPROVAL

#2 SUBMIT GRADING & EROSION CONTROL PLANS

#3 APPLY FOR ALL NECESSARY PERMITS

Comply WITH-IN 15 DAYS

... WILL
... ACTUAL
... THIS
PROPERTY INTO COMPLIANCE. THESE FEES
ARE IN ADDITION TO ANY OTHER FEES AND
FINES.

- Please make corrections and call for reinspection.
- Please make corrections and proceed with work.

T. [Signature]
Inspector

12-1347-489 Rev. 2/00

CRWQCB REG6

REC'D 1-23 RECEIVED NOV 2 - 2011

FILE	

COMPLAINT/SPILL NOTIFICATION REPORT FORM

Jan-pls. coordinate with Keith's unit for SW issues. P.

County: <u>San Bernardino, CA</u>		Initials		Date		
WDID or project file name:		Rec'd by: <u>JMB</u>		10/17/11		
Notes: <u>1.8 acre site, 785 Meadow Brook, Lake Arrowhead</u> <u>* unauthorized grading & infilling of (2) inst perennial streams</u>		Sv. Eng. Geologist / Officer in Charge		<u>Dji</u> 10-17-11		
		Sr. Eng		<u>Dji</u> 10-17-11		
		Assign to:		<u>JMB</u> 10-17-11		
		Sr. Eng				
		Sv. Eng. Geologist				
Complainant or spill reported by: <u>Brian Pattison</u>		Complainant's Agency:				
Discharger/Responsible Party: <u>Bill Mueller (?)</u>		Complainant's phone: <u>(909) 337-0728</u> <u>(909) 754-7563</u>				
Complainant Mailing address: <u>27463 Meadow Drive</u> <u>Lake Arrowhead, CA</u>		Complainant's Fax:				
		Complainant's email (optional):				
Date reported: <u>10/17/11</u>		Time reported: <u>9:50 am</u>		Received by: <u>JMB</u>		
Spill date:		Spill time		Assigned to:		
Hazardous Release? <input type="checkbox"/> Yes <input type="checkbox"/> No	Prop 65 notified? <input type="checkbox"/> Yes <input type="checkbox"/> No	Who notified prop 65?:	Date Prop 65 notified:	Regulated facility? <input type="checkbox"/> Yes <input type="checkbox"/> No	Violation? <input type="checkbox"/> Yes <input type="checkbox"/> No	CIWQS Violation #
Facility Name						
Location; Address or description of where spill is located		<u>785 Meadow Brook, Lake Arrowhead</u>				
City: <u>Lake Arrowhead / Crest Park</u>		Coordinate System: <u>NAD83</u> Method: <u>Google Earth</u>				
Rate or Volume:		Substance released:				
Description of spill event		<u>Caller states the new landowner is performing unauthorized grading on a 1.8-acre site. (2) perennial drainages have been filled w/ditching directed to an existing 30" culvert. NO BMPs in place, work started 2 weeks ago (~Oct 1, 2011?)</u>				
Discharge to surface water, ground (ground water), or impervious surface?: <u>surface water</u> <u>(2) perennial streams</u>		Name of Surface water: <u>unknown</u>				
Samples collected? <input type="checkbox"/>		Photos? <input type="checkbox"/>		Photo info:		
Disinfection Details						
Other Agencies notified?		<u>CDPE / Joanna Gibson ; San Bernardino County Building & Safety</u>				
Status of repair, correction, and cleanup						
Recommended Action:		<u>informal inspection & prepare recommendation for enforcement committee as necessary</u>				
Complainant notified of findings? <input type="checkbox"/> Yes <input type="checkbox"/> No		Date notified:				
NPDES spill report due in 5 days <input type="checkbox"/> Yes <input type="checkbox"/> No		Date NPDES report due:		Date received:		
Report of other spills due in 10 days <input type="checkbox"/> Yes <input type="checkbox"/> No		Date 10 working day report due:		Date received:		
Date(s) follow-up reports submitted:						
Date Action Complete:		Spill DB ID #				

From: Tami Bayer <dappledesigns@verizon.net>
To: <jzimmerman@waterboards.ca.gov>
Date: 1/18/2012 4:43 PM
Subject: Photos of Crest Park Meadow
Attachments: summer2011A.jpg; winter2011B.jpg

Hi Jan,

Thank you for taking my call this afternoon about the damage in Crest Park. I found photos taken from my back deck which overlooks the meadow that I've attached for you. One was taken last winter and the other was taken over the summer. I hope these are helpful in some way. We will work to compile more photos from the rest of the community at the meeting on Friday night.

Tami Bayer

Jan Zimmerman - Serenity Lodge Abatement Order No. R6V-2012-0008

From: <noserenity@verizon.net>
To: <jzimmerman@waterboards.ca.gov>, <jgibson@dfg.ca.gov>
Date: 3/15/2012 3:05 PM
Subject: Serenity Lodge Abatement Order No. R6V-2012-0008
Attachments: serenitylot4.jpg; serenitylot4c.jpg; serenitylot4a.jpg; serenitylot4b.jpg

Dear Jan and Joanna,

I'm writing to inform you that the owners of the Serenity Lodge had heavy equipment operating on the meadow area again on Tuesday, March 13th. They dug out what appears to be a place to pour a foundation for yet another home. They currently have 3 homes under construction, and this fourth home is right next to the stream bed they damaged back in October 2011. I'm attaching 4 photographs of this further damage. Also, on this same day KABC, channel 7 news filmed me and the view from the back deck of our home for a news story. You can see some of the new damage in their video footage. Here's the link to the news story if you'd like to see the video:
http://abclocal.go.com/kabc/story?section=news/local/inland_empire&id=8580043

Please feel free to contact us if you need any other information. My home phone number is (909)337-6042 and my cell phone number is (909)649-1789

Thank you,
Tami Bayer

Jan Zimmerman - Serenity-Crest Park Inspection 03/16/2012

From: Jeff Brandt <JBrandt@dfg.ca.gov>
To: <mollabolla@yahoo.com>
Date: 3/16/2012 3:41 PM
Subject: Serenity-Crest Park Inspection 03/16/2012
CC: Brady Hill <BHill@dfg.ca.gov>, Jeff Brandt <JBrandt@dfg.ca.gov>, JoannaGibson <JGIBSON@dfg.ca.gov>, Rick Fischer <RFISCHER@dfg.ca.gov>, <dbaker@lusd.sbcounty.gov>, Jan Zimmerman <JZimmerman@waterboards.ca.gov>, Mike Plaziak <mplaziak@waterboards.ca.gov>, Patrice Copeland <PCopeland@waterboards.ca.gov>, <bryant2662@yahoo.com>

Good afternoon Mr. Moller.

Please read your streambed agreement, I believe you have several significant compliance issues. We prepared the agreement to allow you to install and monitor BMPs to protect jurisdictional streambed and habitat. To date your focus has been on other aspects of construction.

Again, we request you coordinate a meeting with the County and other permitting agencies.

thank you, Jeff

Jeff Brandt
 Department of Fish and Game
 Habitat Conservation Branch
 Inland Deserts Region

3602 Inland Empire Blvd., Suite C-220
 Ontario, CA 91764
 Phone: (909) 987-7161
 Fax: (909) 481-2945
 Email: JBrandt@dfg.ca.gov

>>> Jan Zimmerman <JZimmerman@waterboards.ca.gov> 3/16/2012 1:09 PM >>>
 Mr. Moller,

I inspected your Crest Park site this morning and met with the site manager Bobby Rabun. I noted new construction on the western portion of the site adjacent to the creek (pipe culvert) and the spring that had been diverted. The footings had been dug for the foundation but no concrete had been poured. This construction appears to be within 30-feet of the headwall of the new pipe culvert. Has this work been authorized by the County? Today, I walked the site with Mr. Rabun and pointed out to him the areas that need BMP maintenance or placement of additional BMPs to stabilize the disturbed soils on the site. It is imperative that the BMPs be installed and maintained in light of the forecasted storm for this weekend.

1. There is still stockpiled soil along the top of the slope at the outlet of the culvert pipe. This soil will need to be removed eventually, but in the interim I recommend that plastic sheeting be placed and staked along the banks to keep the sediment and debris from being washed into the channel. Straw waddle or silt fencing should be placed at the top of as a second line of defense to prevent erosion of the channel banks. **This area needs to be your number 1 priority.**
2. Straw waddle needs to be staked and the ends need to overlap to provide coverage and be effective (it also

needs to be trenched in, but I forgot to tell Mr. Rabun so I am letting you know now). Along the southern portion of the site the majority of the straw waddle is crushed and needs to be replaced and the ends do not overlap. Most if not all of the straw waddle on the southern end of the site needs to be reset or replaced and then restaked.

3. Silt fencing needs to be tacked on the up-slope side of the stake and the bottom of the fence needs to be trenched in to provide a sediment "catch" and be effective. Most of the silt fencing on site is tacked on the downslope side of the stake and is not trenched in. There are many areas along the southern boundary of the site where the bottom of the fence is hanging above the ground in excess of 10-12 inches and therefore is not acting as an effective BMP. The silt fencing will need to be reinstalled correctly.

4. The placement of the straw waddle across the top of the graded pad in the main part of the meadow area is good. Additional rows of straw waddle should be placed (arcuate-shaped pointing downslope) to capture and slow the flows as they move from west to east across the site.

5. Concentrated flows should be discouraged through the use of waddle, sand bags, hay bales, etc.

Please let me know if you have any questions regarding my recommendations above. Please keep us posted on the intensity of the storm at your site and whether or not the BMPs have failed or are still functioning.

Thank you.

Jan M. Zimmerman, PG
Engineering Geologist
Lahontan Regional Water Quality Control Board

Phone: 760/241-7376
Fax: 760/241-7308
jzimmerman@waterboards.ca.gov

Jan Zimmerman - cleanup and abatement order R6V-2012-0008

From: <squeaker@ix.netcom.com>
To: <jcass@waterboards.ca.gov>, <pcopeland@waterboards.ca.gov>, <jzimmerman@waterboards.ca.gov>, <jgibson@dfg.ca.gov>
Date: 3/30/2012 4:04 PM
Subject: cleanup and abatement order R6V-2012-0008

Interested parties-

I am the vice president of the Crestline-Lake Arrowhead Water Agency but in this email, I AM SPEAKING TO YOU AS A CREST PARK RESIDENT. I have been following this case for some time and met, on the site several weeks ago, with Jan Zimmerman and otherS, giving her background information on the conditions of the meadow and brook that Mr. Moller has destroyed.

I just wanted to alert you to the fact that despite the above noted cleanup and abatement order, that Mr. Moller is continuing to build and is presently pouring the concrete foundations of the latest building near the headwall he illegally installed at the creek. If possible, could I be informed of any future agency actions or responses?

Bruce D. Risher

From: Joanna Gibson <JGIBSON@dfg.ca.gov>
To: Brady Hill <Bhill@dfg.ca.gov>, Rick Fischer <RFISCHER@dfg.ca.gov>, Don -LUS Baker <Donald.Baker@lus.sbcounty.gov>, <Shannon.L.Pankratz@usace.army.mil>, <JZimmerman@waterboards.ca.gov>
CC: Jeff Brandt <JBrandt@dfg.ca.gov>
Date: 4/18/2012 8:48 AM
Subject: Serenity project, Crest Park
Attachments: 1600-2011-0244-R6 NOV Ltr.pdf

Good Morning,

FYI - the attached NOV letter was sent to the Applicant, Mr. Moller, and the consultant, Mr. Bryant Bergeson, on Friday, April 13, 2012.

Please let me know if you have any questions.

Joanna

Joanna Gibson
Environmental Scientist
CA Department of Fish and Game
Inland Deserts Region
3602 Inland Empire Blvd., Suite C-220
Ontario, CA 91764
(909) 987-7449 (voice)
(909) 481-2945 (fax)
jgibson@dfg.ca.gov



California Natural Resources Agency
DEPARTMENT OF FISH AND GAME
Inland Deserts Region
3602 Inland Empire Blvd., Suite C-220
Ontario, CA 91764
(909) 484-0459
www.dfg.ca.gov

EDMUND G. BROWN, Jr., Governor
CHARLTON H. BONHAM, Director



April 13, 2012

Mr. Bill Moller
Arimol Group, Inc.
P.O. Box 2895
Lake Arrowhead, CA 92352

Subject: Notice of Violation of Fish and Game Code Section 1602
Notification No. 1600-2011-0244-R6

Dear Mr. Moller:

On January 26, 2012, the Department of Fish and Game (Department) issued you a Streambed Alteration Agreement (Agreement) (No. 1600-2011-0244-R6) to partially address unauthorized impacts to Department jurisdictional areas located north and east of Meadowbrook Road, in the community of Crest Park, County of San Bernardino. The Agreement stated that the full extent of impacts, at the time of drafting the Agreement, were unquantified and undisclosed, and that the Applicant would identify and mitigate the full extent of impacts under a separate Lake and Streambed Alteration Notification.

The Agreement authorized two specific scopes of work only, and required the submission of a new Lake and Streambed Alteration Agreement Notification and a habitat restoration plan. The two specific scopes of work authorized in the Agreement were limited to:

1. Installation of Best Management Practices (BMPs) across the project site (as described in Measure 2.3); and
2. Removal of approximately 10 cubic yards of sediment and vegetative debris that was stockpiled in the ephemeral drainage at the southeastern corner of the property, adjacent to the "driveway" (depicted on plans provided to the Department during a site visit on January 20, 2012). Stockpiled material shall be placed in the "overflow parking" area, and BMPs shall be installed to prevent runoff.

Requirements of the Agreement included:

1. Measure 3.1, Identification of Full Project Impacts: By March 30, 2012, Permittee shall submit a separate Lake and Streambed Alteration Agreement Notification which identifies total project impacts incurred to date, as well as those proposed

Conserving California's Wildlife Since 1870

ARIMOL-0035

in the overall, larger, project scope. The Notification shall include mitigation to address impacts associated with the violations noted above, and mitigation for additional impacts associated with the larger project scope.

2. Measure 3.2, Habitat Restoration: Permittee shall submit a habitat restoration plan that addresses all impacts to jurisdictional areas within the project site. The habitat restoration plan shall include a detailed plant palette. The Department encourages the Permittee to consult with a qualified Biologist in the development of the habitat restoration plan. The habitat restoration plan shall be submitted with the Lake and Streambed Alteration Agreement Notification, due to the Department no later than March 30, 2012.

The Agreement also included the following Avoidance and Minimization measure:

Measure 2.2, Nonnative plant species: DFG recommends the use of native plants to the greatest extent feasible in the landscaped areas adjacent to and/or near mitigation/open space areas and within or adjacent to stream channels. Permittee shall not plant, seed, or otherwise introduce invasive nonnative plant species to the landscaped areas adjacent to and/or near mitigation/open space areas and within or adjacent to stream channels (minimum 100 foot setback from open space areas and 150 foot setback from stream channels and wetland/riparian mitigation sites). Invasive nonnative plant species not to be used include those species listed on the "California Invasive Plant Inventory, February 2006" and the "February 2007 Inventory Update", (which are updates to Lists A & B of the California Exotic Pest Plant Council's list of "Exotic Pest Plants of Greatest Ecological Concern in California as of October 1999"). This list includes: pepper trees, pampas grass, fountain grass, ice plant, myoporum, black locust, capeweed, tree of heaven, periwinkle, bush lupine, sweet alyssum, English ivy, French broom, Scotch broom, Spanish broom, and pepperweed. A copy of the complete list can be obtained by contacting the California Invasive Plant Council by phone at (510) 843-3902, at their website at www.cal-ipc.org, or by email at info@cal-ipc.org.

On March 30, 2012, the Department received three, single-sheet plan copies, titled: BMP Erosion Control Plan; Streambed Grading Plan; and Habitat Restoration Plan. The plans were submitted with a two-page document titled: Streambed Notes. These documents do not provide sufficient information to satisfy Measures 3.1 and 3.2 of the Agreement. Total project impacts incurred to date, as well as those proposed in the overall, larger project scope are not identified; mitigation to address impacts associated with the violations noted above, and mitigation for additional impacts associated with the larger project scope has not been proposed; a separate Lake and Streambed Alteration Agreement Notification has not been submitted; and a detailed plant palette was not submitted. Furthermore, the Habitat Restoration Plan lists planting of only one species on site, an invasive nonnative species, specifically prohibited in Measure 2.2 of the Agreement.

Mr. Bill Motter, Arimol Group, Inc.
April 13, 2012
Page 3 of 4

Because additional work, including construction of infrastructure, has occurred on site following execution of the Agreement, and the Department did not receive deliverables detailed in Measures 3.1 and 3.2 of the Agreement by March 30, 2012, the project violates the requirement in Fish and Game Code section 1602 that a project be conducted in accordance with an approved Agreement.

Based on the above, you will need to correct the violation by halting all work onsite within and adjacent to Department jurisdictional areas (placement and maintenance of BMPs are exempt, and shall continue as necessary), and submit a separate Lake and Streambed Alteration Agreement Notification which identifies total project impacts incurred to date, as well as those proposed in the overall, larger, project scope. The Notification shall include mitigation to address impacts associated with the violations noted above, and mitigation for additional impacts associated with the larger project scope. Please continue to maintain the BMPs on site and submit the new Lake or Streambed Alteration Agreement Notification to the Department's Region 6 administrative office (Department of Fish and Game, Region 6, ATTN: Streambed Team, 4665 Lampson Avenue, Suite J, Los Alamitos, CA 90720) no later than April 20, 2012.

After the Department receives the new Lake or Streambed Alteration Agreement Notification, staff from the Department's Habitat Conservation Planning and Law Enforcement Division will schedule a meeting with you to review the Notification and project compliance. Please note that the new Agreement that will be drafted by the Department following receipt of the new Lake or Streambed Alteration Agreement Notification shall include measures proposed by the Department to protect fish and wildlife resources, and these measures will not be subject to arbitration (refer to Section 1614 of the Fish and Game Code).

If you do not take immediate steps to bring your project into compliance and submit a complete and thorough Lake or Streambed Alteration Agreement Notification to the Department by April 20, 2012, the Department will pursue other options, including enforcement, or referring the matter to the District Attorney's Office or the Attorney General's Office for civil or criminal prosecution.

If you have any questions regarding this letter, please contact Warden Rick Fischer at 951-288-7651 or by email at rfischer@dfg.ca.gov; or Joanna Gibson at 909-987-7449 or by email at jgibson@dfg.ca.gov.

Sincerely,



Rick Fischer
Warden, Law Enforcement Division

Mr. Bill Moller, Arimol Group, Inc.
April 13, 2012
Page 4 of 4

cc: Lieutenant Brady Hill, Law Enforcement Division, CDFG
Jeff Brandt, California Department of Fish and Game
Joanna Gibson, California Department of Fish and Game
Jan Zimmerman, Lahontan Regional Water Quality Control Board

ec: Mr. Bryant Bergeson, Kadtec.



San Bernardino Mountains Group

San Geronimo Chapter

PO Box 708
Blue Jay, CA 92317

www.sanbernardinomountainsierraclub.org/mountains

4/10/12

20 April 2012

Ms. Jan Zimmerman
Lahontan Regional Water Quality Control Board
14440 Civic Drive, Suite 200
Victorville, CA 92392

CRWQCB REG 66	RECEIVED
JZ	APR 23 2012

RE: Clean-up and Abatement Order R6V-2012-0008 for 1.8 Acre Parcel at 1031 Meadowbrook Road, Lake Arrowhead (Crest Park), CA

Dear Ms. Zimmerman,

The San Bernardino Mountains Group of the Sierra Club wishes to express our profound concern for the serious disregard of the clean-up and abatement order given to Mr. Moller of Arimol Group to stop further development on the referenced property. As you know, construction and excavation is continuing at an extensive level including the laying of concrete and building a foundation for yet another residence on this site.

Sierra Club members have followed this project from an environmental viewpoint, particularly the destruction of the perennial streambed and riparian vegetation on Meadowbrook. Mr. Moller has not followed correct environmental procedures before and during the construction involved with this project, including the restoration of the streambed.

And we are not alone in our concerns; this project is deeply controversial. Many individual residents and local organizations have expressed reservations and opposition to this project.

We would like to strongly encourage your agency to continue aggressively pursuing this issue so that local individuals and organizations can feel reassured that this development will proceed according to the legal guidelines that Lahontan is authorized to enforce. Toward that end, the San Bernardino Mountains Group of the Sierra Club request to be copied in all future correspondence regarding this project and site restorations. Please send all further information to our PO Box listed above to my attention, or to my email address (Xcountrydon@charter.net)

Thank you for your consideration of this request.

Sincerely,

Don Fischer
Conservation Co-Chair
San Bernardino Mountains Group
Sierra Club

CC: Hugh Bialecki, President, Save Our Forest Association
Drew Feldmann, Conservation Chair, San Bernardino Valley Audubon Society

Jan Zimmerman - Re: Abatement Order R6V-2012-0008

From: Jan Zimmerman
To: noserenity@verizon.net
Date: 5/2/2012 8:45 AM
Subject: Re: Abatement Order R6V-2012-0008
CC: Copeland, Patrice; Plaziak, Mike

Tami,

Thank you for the email. The Water Board has authorized Mr. Moller to remove stockpiled soils from the top of the channel bank on the east side of the property, directly south of the property owned by Mr. Pattison. If there is equipment mobilized in other parts of the site that are disturbing the channel or streambed we would appreciate any photographs that you would be able to provide. We value the communities involvement and appreciate your assistance.

Thank you.

Jan M. Zimmerman, PG
Engineering Geologist
Lahontan Regional Water Quality Control Board

Phone: 760/241-7376
Fax: 760/241-7308
jzimmerman@waterboards.ca.gov

>>> <noserenity@verizon.net> 5/2/2012 8:14 AM >>>

I'm writing to inform you that heavy equipment is currently on the meadow in Crest Park excavating near the most recently built foundation directly next to the damaged stream bed. It is very foggy this morning, so it's difficult to get good documentation of what is happening. I shot 2 minutes of video and took a few photos. Please let me know if you'd like me to send these to you. We appreciate any assistance you can offer to ensure the orders issued are followed. My husband saw Bill Moller at the site as he drove by a few minutes ago while this was happening. Please let me know if you need any additional information.

Tami Bayer
(909)337-6042

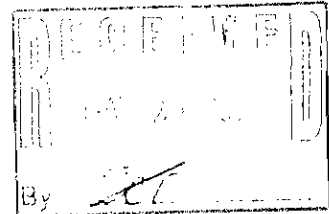

Save Our Forest Association, Inc.

21 May 2012

Post Office Box 126 • Rim Forest, California 92378

Ms. Jan Zimmerman
Lahontan Regional Water Quality Control Board
14440 Civic Drive, Suite 200
Victorville, CA 92392

Ref: Arimol Group Abatement Order R6V-2012-0008, 1031 Meadowbrook Road,
Lake Arrowhead, CA

Dear Ms. Zimmerman,

The Save Our Forest Association, Inc. (SOFA), is appalled at the wanton disregard of the abatement order that has been demonstrated by Mr. Moller of the Arimol Group. There seems to be no one person or government entity taking responsibility for the environmental damage being wrought in our community by someone following a profit-driven enterprise.

The SOFA Board of Directors, along with members of our local chapter of the Sierra Club and the San Bernardino Valley Audubon Society, have seen the bulldozing of a perennial streambed and riparian habitat at the above property. We have been in contact with the San Bernardino County Board of Supervisors and are frustrated with an overall limited response to the outrageous actions by Mr. Moller.

Similar activities locally have taken place only a few miles away at the Eagle Ridge at Arrowhead LP property (Admin Civil Liability Complaint No. R6V-2008-001) just a few years ago. That property ended up in a \$11 million foreclosure and partial bank sale as construction site run-off contaminated Grass Valley Creek and Lake for two successive winters. We trust that your agency will respond in the strongest possible fashion to prevent the destruction of additional rare and precious riparian habitat here in the San Bernardino Mountains and force out-of-control developers to obey the law.

Thank you for your ongoing review of this project and notification to SOFA of actions taken by the Lahontan Regional Water Quality Control Board.

Sincerely,

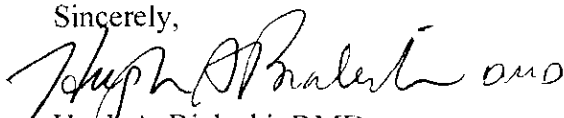
Hugh A. Bialecki, DMD
President, Save Our Forest Association

✓ cc: Mr. Scott Ferguson, Chief
Enforcement and Special Projects Unit

Enforcement File Serenity Lodge

ARIMOL-0041

COMPLAINT/SPILL NOTIFICATION REPORT FORM

✓ to OLB

County: <i>San Bernardino</i>		Initials		Date		
WDID or project file name: <i>Arimol Group, 6B36C3634433</i>		Rec'd by: <i>JMT</i>		<i>5/31/12</i>		
Notes: <i>Residences would like to see development stopped; discharger is recalcitrant who regard to CAO; concerned the discharger will not comply w/ requirements of CAO</i>		Sv. Eng. Geologist / Officer in Charge		<i>PJC 5-31-12</i>		
		Sr. Eng		<i>PJC 5-31-12</i>		
		Assign to:		<i>JMZ</i>		
		Sr. Eng				
		Sv. Eng. Geologist				
Complainant or spill reported by: <i>Don Fisher, Chair Person</i>		Complainant's Agency: <i>Sierra Club</i>				
Discharger/Responsible Party: <i>Bill Moller, Arimol Group</i>		Complainant's phone:				
Complainant Mailing address:		Complainant's Fax:				
		Complainant's email (optional):				
Date reported: <i>5/31/12</i>		Time reported: <i>1:00PM</i>		Received by: <i>JMT</i>		
Spill date: <i>ongoing</i>		Spill time		Assigned to:		
Hazardous Release? <input type="checkbox"/> Yes <input type="checkbox"/> No	Prop 65 notified? <input type="checkbox"/> Yes <input type="checkbox"/> No	Who notified prop 65?	Date Prop 65 notified:	Regulated facility? <input type="checkbox"/> Yes <input type="checkbox"/> No	Violation? <input type="checkbox"/> Yes <input type="checkbox"/> No	CIWQS Violation #
Facility Name: <i>Serenity Lodge, Arimol Group</i>						
Location; Address or description of where spill is located						
City: <i>West Park, Lake Arrowhead</i>						
Lat: Datum: Coordinate System: Method:						
Rate or Volume:		Substance released:				
Description of spill event		<i>discharger continues construction w/ one structure near completion w/in 30 feet of creek; concrete pad/foundation work in meadow area in central portion of site completed w/in last week</i>				
Discharge to surface water, ground (ground water), or impervious surface?:				Name of Surface water:		
Samples collected? <input type="checkbox"/>		Photos? <input type="checkbox"/>		Photo info:		
Disinfection Details						
Other Agencies notified?						
Status of repair, correction, and cleanup						
Recommended Action:		<i>inspect site; provide copy of comments on technical reports</i>				
Complainant notified of findings? <input checked="" type="checkbox"/> Yes <input type="checkbox"/> No		Date notified: <i>5/31/12</i>				
NPDES spill report due in 5 days <input type="checkbox"/> Yes <input type="checkbox"/> No		Date NPDES report due:		Date received:		
Report of other spills due in 10 days <input type="checkbox"/> Yes <input type="checkbox"/> No		Date 10 working day report due:		Date received:		
Date(s) follow-up reports submitted:						
Date Action Complete:				Spill DB ID #		

Zimmerman, Jan@Waterboards

From: Joanna Gibson <JGIBSON@dfg.ca.gov>
Sent: Wednesday, August 22, 2012 1:54 PM
To: mollabolla@yahoo.com
Cc: Jeff Brandt; Rick Fischer; Don - LUS Baker; Summer Pardo; Shannon.L.Pankratz@usace.army.mil; Zimmerman, Jan@Waterboards; Copeland, Patrice@Waterboards
Subject: 1600-2012-0050-R6 - New Residences at 1031 Meadowbrook Road

Mr. Bill Moller
Arimol Group Inc.
PO Box 2895
Lake Arrowhead, CA 92352

Subject: Incomplete Notification of Lake or Streambed Alteration
Notification No. 1600-2011-0050-R6

Dear Mr. Moller:

The Department has reviewed the response letter submitted by PMC World, received by the Department on July 25, 2012, for the above-referenced project. Please note that as of today, August 22, 2012, your notification is still incomplete because the information listed below is either missing or insufficient. The Department requests a response and the following information as soon as possible:

1. Regarding Figure 2, Historic Jurisdictional Features, the Department has the following comments: a) Please revise the figure to include the ephemeral stream that occurs along the eastern edge of the "Project Study Area." This feature was at least partially identified on sheet C-2 (identified as an "existing gully") of your previous submission (dated June 15, 2012; received by the Department June 28, 2012); b) Please revise the figure to include the ephemeral stream that occurs along the southern edge of the "Project Study Area." This feature was identified on plans received by the Department on March 30, 2012 (refer to BMP Erosion Control Plan, Streambed Grading Plan, and Habitat Restoration Plan [sheets C-1, C-2, and C-3 respectively; all dated 8/22/11]); c) The Department does not concur with the location of the northern-most spring. During a site visit on January 20, 2012, the Department observed that the spring had been piped and diverted from close to Meadowbrook Road. Please revise Figure 2 to reflect this information.

2. Based on the information submitted, the Department does not believe that the impact acreage has been fully assessed. Impacts have been stated as 0.26 acres of shrub wetland, 0.005 acre of springs, 611 feet of ephemeral stream channel, and 399 feet of spring drainage. Please clarify the area of impact (in acres) to wet meadow habitat and ephemeral stream channel. Please also illustrate on an aerial photograph the areas of impact to wet meadow habitat and ephemeral stream channel.

3. The Department requested the following information on July 19, 2012: "Please also provide a jurisdictional delineation for any areas being developed to the west of Meadowbrook Road. As stated previously, the Department is requesting that total project impacts incurred to date, as well as those of the larger, overall, project scope (which includes the area to the west of Meadowbrook Road) be identified and disclosed to the Department." As of today, August 22, 2012, this information has not been provided to the Department.

4. The Department requested the following information on July 19, 2012: "Regarding the Habitat Mitigation and Monitoring Plan: (1) please provide a map detailing areas where riparian restoration will occur, where wet meadow restoration will occur, and where spring restoration will occur." As of today, August 22, 2012, this information has not been provided to the Department.

5. Plans submitted to the Department on July 25, 2012, do not show restoration of jurisdictional features to pre-impact

3. Re
rest

conditions. In these plans, the proposed alignment of the main stream has been modified, and does not follow pre-impact alignment. The southern feature is also missing from these plans. The Department expects that all jurisdictional areas will be restored. If restoration is not proposed, the Department will review these plans as a new project proposal. Please note that the Department will require a copy of your CEQA document when reviewing your project proposal.

6. Plans submitted to the Department on July 25, 2012, show that riprap is included in the restoration design. Please clarify the need for riprap in the restoration design.

7. Thank you for providing the species assemblage information from "What Grows Here" on CalFlora. Have you researched the sourcing of these species from local areas/local native nurseries? Please note that the Department will require a final plant palette. Please provide more information on where planting will occur within areas to be restored.

8. The Department received a copy of "Existing Site Plan Conditions" on July 25, 2012. The Plan shows two "existing houses" (next to "1", and "3") that were not present during the Department's site visit on January 20, 2012. Are the entire footprint areas of these structures disclosed on the plans? Please provide the setback distance for structure "1" from the pre-impact alignment of the main streambed, and the southern most spring. Please provide the setback distance for structure "3" from the spring. Please also provide more information on the location of the two "proposed houses" in relation to all Department jurisdictional areas and restoration areas. Please ensure that ALL Department jurisdictional areas are identified in your assessment.

Please note that you may not proceed with your project until your Notification is deemed complete, and you have obtained a Lake or Streambed Alteration Agreement, if required. If you have any questions regarding this matter or need additional information, please contact me at the phone number or email address below.

Joanna Gibson
Environmental Scientist
CA Department of Fish and Game
Inland Deserts Region
3602 Inland Empire Blvd., Suite C-220
Ontario, CA 91764
(909) 987-7449 (voice)
(909) 481-2945 (fax)
jgibson@dfg.ca.gov

>>> Joanna Gibson 7/19/2012 4:16 PM >>>
Mr. Moller,

The Department has reviewed the response letter submitted by PMC, received by the Department on June 28, 2012, for the above referenced project. Please note that as of today July 19, 2012, your notification is still incomplete because the information listed below is either missing or insufficient. To allow the Department to continue our review of your notification, please provide a response and the following information:

1. Total project impacts incurred to date, as well as those proposed in the larger, overall, project scope have still not been provided to the Department. As previously requested, please identify impacts to streambed, riparian habitat, wet meadow habitat, and springs. Please ensure that the impact areas are identified on an aerial photograph, and that the impacts to each of these features is detailed in a table. The information provided on the "Stream Bed Grading Plan" and the "Habitat Mitigation and Monitoring Plan" does not adequately address this request. Please submit an aerial photograph detailing the historic location of the streambed, the riparian habitat, the wet meadow habitat, and the springs. To assist with Department review please ensure that each of these features are identified by polygons overlaid on the aerial photograph. Please also overlay the total acreage of each of the features on the map. Please also provide a jurisdictional delineation for any areas being developed to the west of Meadowbrook Road. As stated previously, the Department is requesting that total project impacts incurred to date, as well as those of the larger, overall, project scope (which includes the area to the west of Meadowbrook Road) be identified and disclosed to the Department.

2. Please clarify if the headwall will remain in place? As previously requested, please provide copies of your authorizations for the installation of the headwall.

3. Regarding the Habitat Mitigation and Monitoring Plan: (1) please provide a map detailing areas where riparian restoration will occur, where wet meadow restoration will occur, and where spring restoration will occur; (2) please remove *Nassella pulchra*, *Baccharis pilularis*, and *Carex barbarae* from the species list. Please specify the sub specific epithet of *Juncus balticus*, and the specific epithet and sub specific epithet (where necessary) for *Eriogonum*, *Lupinus*, *Artemesia*, and *Chrysothamnus*; (3) the HMMP notes that areas "requiring hydroseeding/planting will be determined and delineated by the project engineer..." Please note that the Department will request copies of the habitat restoration qualifications of the selected engineer. The Department encourages oversight by a habitat restoration ecologist with expertise in the local area; (4) please note that the Department will request that the mitigation areas contain no more than 5% nonnative plant species, and that there is a documented absence of all plant species with rates of dispersal and establishment listed as High or Moderate on the California Invasive Plant Inventory; (5) the Department may request different success criteria to those specified in the HMMP; and (6) monitoring methods should include accepted quantitative methodologies.

4. As previously requested, please provide photographic documentation supporting your statement that "Old culverts associated with the springs were removed and replaced to maintain the existing site hydrology..." The Department requested an analysis of historic and recent aerial photography to support this statement. No information related to this request has been provided to the Department. Please submit this information.

Please note that you may not proceed with your project until your Notification is deemed complete, and you have obtained a Lake or Streambed Alteration Agreement, if required. If you have any questions regarding this matter or need additional information, please contact me at the phone number or email address below.

Joanna Gibson
Environmental Scientist
CA Department of Fish and Game
Inland Deserts Region
3602 Inland Empire Blvd., Suite C-220
Ontario, CA 91764
(909) 987-7449 (voice)
(909) 481-2945 (fax)
jjgibson@dfg.ca.gov

>>> Joanna Gibson 5/11/2012 3:34 PM >>>
Mr. Bill Moller
Arinmol Group Inc.
PO Box 2895
Lake Arrowhead, CA 92352

Subject: Incomplete Notification of Lake or Streambed Alteration
Notification No. 1600-2011-0050-R6

Dear Mr. Moller:

On April 20, 2012, the Department of Fish and Game (Department) received your Notification of Lake or Streambed Alteration (Notification) for the New Residences at 1031 Meadowbrook Road Project. For your reference, your Notification has been assigned the number: 1600-2012-0050-R6. Today, May 11, 2012, the Department determined that your Notification is incomplete because the information below is either missing or insufficient. To allow the Department to continue our review of your notification, please provide a response and the following information:

1. As stated on site during our site visit on January 20, 2012, and in Measure 3.1 of Agreement 1600-2011-0244-R6, the Department requested that you identify the TOTAL project impacts incurred to date, as well as those proposed in the OVERALL, LARGER, PROJECT SCOPE. Notification 1600-2012-0050-R6 only identifies impacts to APN: 0336-13-402. During our site visit on January 20, 2012, staff from the Department and the Lahontan Regional Water Quality

Control Board observed direct impacts to two springs to the west of APN: 0336-13-402. Staff asked that you fully identify and disclose impacts to the springs, and to any other jurisdictional areas within your larger, project scope, including potential impacts to the west of the project site (west of Meadowbrook Road). Please provide this information as soon as possible.

2. The Department does not concur with the historic streambed alignment depicted in Figure 2. Please conduct a thorough analysis of all available historic and recent aerial photography to map the pre-impact location of the streambed, associated riparian vegetation, and the associated meadow. Please also ensure that the springs to the west of APN: 0336-13-402 are mapped, and any other jurisdictional areas west of the project site, and west of Meadowbrook Road, are mapped.

3. Once the revised mapping is complete, please provide updated impact acreages to riparian vegetation, and riparian meadow habitats. The Department does not concur with the impact acreage to riparian habitat/riparian scrub and riparian meadow/wet meadow identified in the Notification, and in the Streambed Restoration Plan. Please note that acreage values also differ between these two documents.

4. Page 1 of the Restoration Plan states: "This Restoration Plan does not incorporate the removal of the culvert and headwall per U.S. Army Corps of Engineer regulatory staff from the Los Angeles District..." Please provide a copy of your 404 permit which authorized the installation of the headwall and culvert. Please also provide copies of your current 404 application, and all written correspondence with Ms. Pankratz that authorized the installation of the culvert and headwall; or written correspondence that authorizes that the culvert and headwall shall remain in place.

5. Please provide photographic documentation supporting your statement on page 1 of the Restoration Plan that "Old culverts associated with the springs were removed and replaced to maintain the existing site hydrology..." Please conduct an analysis of historic and recent aerial photography to support your statement. Please provide the Department with copies of this analysis.

6. Please provide a revised native seed and plant palette mix for the restoration site. Please ensure that only native species indicative of this local area and appropriate to the elevation of the site are proposed.

7. Please note that in addition to a minimum of five years of monitoring of the restoration site, the Department will also require that the mitigation site meets specific success criteria, and that it be protected, and preserved and managed in perpetuity. These criteria shall be outlined in a Habitat Mitigation and Monitoring Plan (HMMP), submitted by the Permittee, and shall be a requirement of the new Streambed Alteration Agreement.

Please note that you may not proceed with your project until your Notification is deemed complete, and you have obtained a Lake or Streambed Alteration Agreement, if required. If you have any questions regarding this matter or need additional information, please contact me at the phone number or email address below.

Sincerely,

Joanna Gibson

Environmental Scientist
CA Department of Fish and Game
Inland Deserts Region
3602 Inland Empire Blvd., Suite C-220
Ontario, CA 91764
(909) 987-7449 (voice)
(909) 481-2945 (fax)
jgibson@dfg.ca.gov

Jan Zimmerman - Meadowbrook Woods- Serenity Retreat and Conference Center

From: Bruce Risher <risherbruce@gmail.com>
To: <jzimmerman@waterboards.ca.gov>
Date: 2/5/2012 12:41 AM
Subject: Meadowbrook Woods- Serenity Retreat and Conference Center
CC: <jbrandt@dfg.ca.gov>, <shannon.l.pankratz@usace.army.mil>
Attachments: Arimol.pdf; 20120201144800598.pdf; 20120201145333460.pdf

These three documents were sent to Chris Kelly, Director of San Bernardino Land Use Services, by the Crestline-Lake Arrowhead Water Agency (CLAWA).

CRESTLINE-LAKE ARROWHEAD WATER AGENCY

A Public Agency
P.O. BOX 3880 PHONE (909) 338-1779
24116 CREST FOREST DRIVE
CRESTLINE, CALIFORNIA 92325

February 1, 2012

Directors

STEPHEN L. PLEASANT, President
BRUCE D. RISHER
NORMAN C. MEEK
THOMAS L. SUTTON
KENNETH A. EATON

General Manager

ROXANNE M. HOLMES

Assistant General Manager/Board Secretary

JENNIFER A. SPINDLER

Ms. Chris Kelly
County of San Bernardino
Land Use Services Department
385 North Arrowhead Avenue, First Floor
San Bernardino, CA 92415-0187

Re: Arimol Group Inc. No. B201109433, APN 0336-134-02-0000

Dear Ms. Kelly:

This Agency wants to call to your attention what may be an irregularity in the processing of a large residential complex in the San Bernardino Mountains. It appears that the residential complex is being approved piecemeal as if single family homes on residential lots, when in fact the units are part of a large conference and retreat center, as evidenced by signage off Highway 18 and in the neighborhood (copies attached) and the website www.serenitylodgelakearrowhead.com. One of the lots in question is APN 0336-134-02-0000, referenced above, but it appears that the complex also includes units on APNs 336-131-08, 336-131-09, 336-134-03 and 336-134-05. The Agency also currently provides retail water to APNs 336-121-25, 336-134-04 and 336-136-01, as well as another structure located on School Road (we believe on APN 336-121-25), which are listed in the Arimol name.

The issue came to our attention when the developer, Arimol Group Inc., requested two will-serve letters for water service to two single family homes in October, 2011 (APNs 336-134-03 & 336-134-05); then two additional will-serve letters in November, 2011 (APNs 336-131-08 & 336-131-09); and then two more in December, 2011 (APN 336-134-02). All of these will-serve letters were for individual residential lots, either adjacent to each other or across the street from each other. However, we noticed that the most recent request was for two will-serve letters to serve two separate structures on a single lot, including one structure with approximately 10,000 square feet of interior space, 7 bedrooms, 7 1/2 baths, racquetball courts, a basketball court and a gymnasium.

In addition, we see that the same corporation has acquired what used to be the Lutheran Camp across the street (APN 336-121-25). We are advised by County Fire that a complex consisting of five or more structures has different fire protection requirements than what would apply to five individual single family homes. We also understand that the environmental assessment of a multi-unit residential complex on a piecemeal basis may violate the California Environmental Quality Act, and that as a responsible agency this Agency may have an obligation to call these concerns to your attention for investigation and further review.

We ask that you conduct your own independent review of the applications submitted for County approval of the units involved in this complex to ensure that it is being processed properly and that all applicable conditions are addressed and satisfied. We have seen enough to warrant further inquiry, and feel obligated to call this to your attention. We would appreciate receiving a response once you have been able to complete that further review. Enclosed for your reference are copies of correspondence between the Agency and the Arimol Group regarding this project, and a map prepared by the Agency's engineers.

Yours very truly,

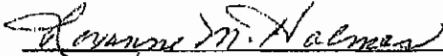
Roxanne M. Holmes,
General Manager

Cc: Don Baker, Plan Reviewer
San Bernardino County Fire Protection District

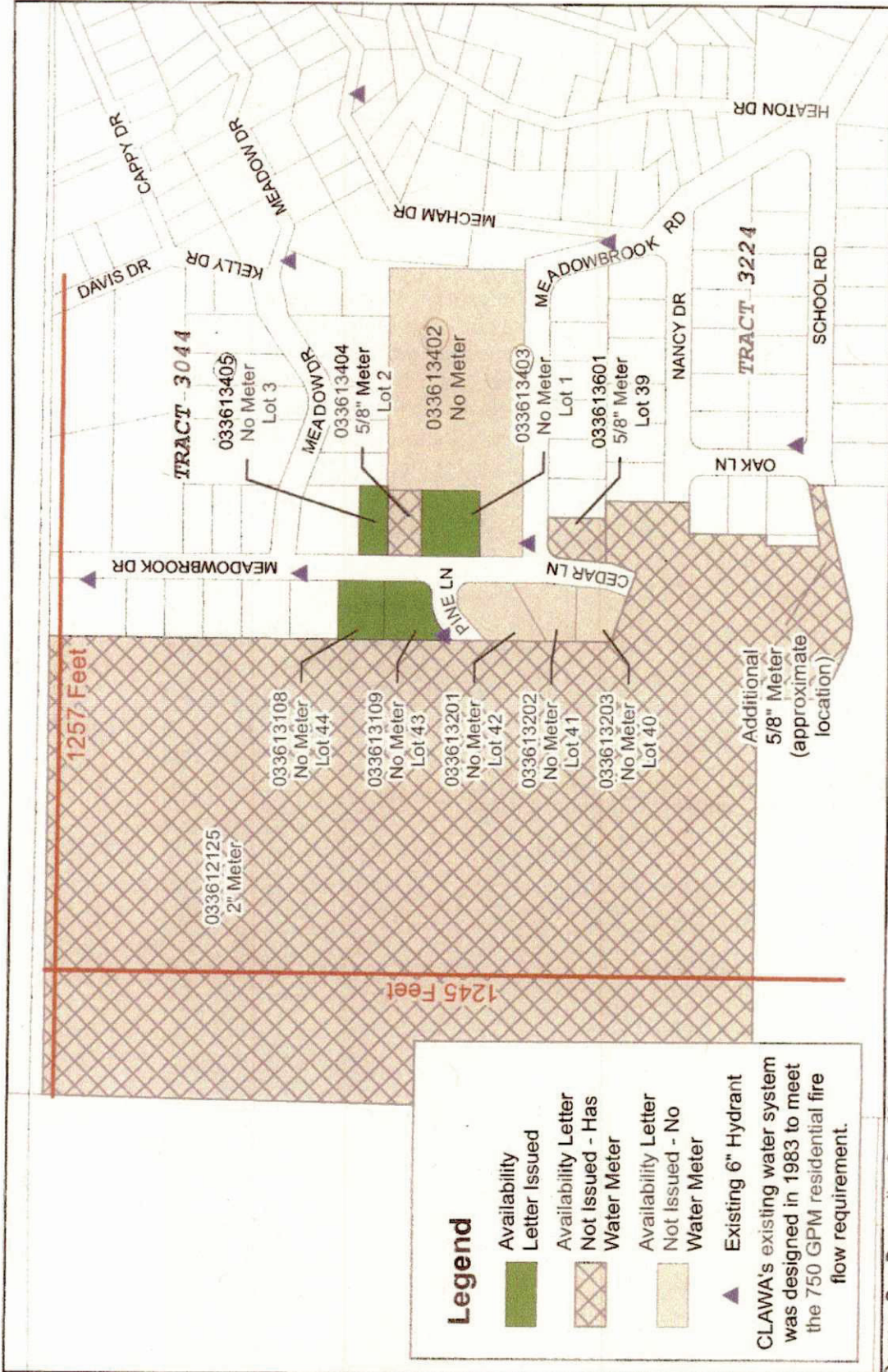

Parcels Owned By Arimol Group Inc.
 Map Created Feb. 1, 2012



Albert A. **WEBB** Associates

Source: San Bernardino Co., 2011

CRESTLINE-LAKE ARROWHEAD WATER AGENCY

A Public Agency
P.O. BOX 3880 PHONE (909) 338-1779
24116 CREST FOREST DRIVE
CRESTLINE, CALIFORNIA 92325

Directors

STEPHEN L. PLEASANT, President
BRUCE D. RISHER
NORMAN C. MEEK
THOMAS L. SUTTON
KENNETH A. EATON

General Manager

ROXANNE M. HOLMES

Assistant General Manager/Board Secretary

JENNIFER A. SPINDLER

February 1, 2012

Meadowbrook Cedar, Inc.
P.O. Box 2895
Lake Arrowhead, CA 92352

RE: APN 336-134-05

Gentlemen:

We are in receipt of your drawings for the proposed property located at 977 Meadowbrook Road (APN 336-134-05). At this time the information submitted to the Agency is incomplete. Please submit to the Agency the following information:

- A copy of the approved Building Permit, as issued by the County of San Bernardino.
- A copy of all fire department requirements, as issued by San Bernardino County Fire Protection District.
- A copy of all future irrigation and landscape plans.

Once we are in receipt of the above information, we will review and advise you of the meter cost and backflow requirements.

Yours very truly,

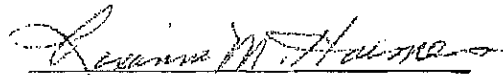

Roxanne M. Holmes,
General Manager

JAN 26 2012

Arimol Group Inc.

--PO Box 2895, Lake Arrowhead, CA 92352--

Roxanne M. Holmes
Crestline-Lake Arrowhead Water Agency
PO Box 3880
Crestline, CA. 92325

1/25/2012

Dear Ms. Holmes:

RE: Water Service Availability for APN 336-134-02
Address: 1031 A and 1031 B Meadow Brook Road.

We received your letter requesting further information on our proposed two residences for will serve letters. The information on the letter you sent to us is not correct.

There are not 2 large structures of 9,000 square feet, only one. On our submitted plot plan we show 2 new proposed residences, one of 9,900 sq. ft. and another of 1664 sq. ft.

The proposed 9,900 square feet building has 7 bedrooms and 7 and 1/2 bathrooms. Half the house consists of an indoor racquetball court, a basketball court and a gym. The house is similar in size to other 7 bathroom homes in your district that you provide water services.

The other proposed building is a 1664 square foot home with 6 bedrooms and 4 bathrooms, similar to the other 4 separate lots you have previously approved, "will serve" water letters. They are lots 974, 977, 986 and 995 Meadow brook Road.

The San Bernardino Building Department has approved these 2 residences on the single parcel pending the districts "will serve" water letter. We are out of plan check and ready to pull our building permit and begin construction. According to the current residential zoning laws we could have subdivided this parcel into 6 lots and build 6 houses on the property, but we choose not to. This property is zoned R-14.000 and is for Residential use only.

In your letter, you mentioned that this appears to be potentially involved in the Agency's Retail Improvement District "C". This is not a commercial or retail project. I do not understand your statement for occupation by multiple tenants on the same property and nature and scope of the proposed use. We are building two new residential houses in a residential zone, which is for residential use only per County zoning ordinances. Our proposed use is consistent to San Bernardino County's district overlay.

cc - MR
PH
JS

The 1664 sq. ft. house requires a 1-inch water meter and a 1-1/2 main service for the bathrooms and fire sprinklers. The 9,900 sq. ft. house requires a 1-inch meter with a 2-inch water service for the bathrooms and fire sprinklers.

If you would like to meet with us, to clarify any issues, please feel free to call. My phone number is 424-634-2331.

If this clears up the matter of proposed use, we have provided the attached, "will serve" letter request along with a check for \$200.00.

Sincerely



Bill Moller

Animol Group Inc. President

JAN 26 2012

32013A-050

12/20/2011

977 Meadowbrook

FIRE SPRINKLER CALCULATION SHEET
 N.F.P.A. RESIDENTIAL HYDRAULIC CALCULATIONS SHEET
 (TAKEN FROM FIGURE A-4-4.3(1) OF N.F.P.A. PAMPHLET 130)

C16	584001	CALCULATIONS:
CITY: BARKLEY PLUMBING		KADTEC
CONTRACTOR: CRESTLINE PLUMBING		P.O. BOX 6885
OWNER: BILL MOLLER		CRESTLINE, CA. 92325
STREET: PO BOX 2895		(909) 336-8970 / FAX (909) 337-2211
LOT: 3		R.C.E. 48805
TRACT: 3224		
APN: 0336-134-05		
OWNER PH: (424) 634-2331		

RECEIVED
 DEC 29 2011
 S.B. CO. FIRE DEPT.

CALC. A SINGLE HEAD CALCULATION

PRESSURE:	75 psi	AGENCY:	FIRE DEPT.	SPRINKLER HEAD TYPE:	TYCO (concealed)
NUMBER OF HEADS:	1	19 GPM		C - FACTOR:	150
TOTAL FLOW:		19 GPM		K - FACTOR:	4.9
PRESSURE FOR SPRINKLER		15 PSI		Avg. I.D. 1.00 in:	1.108
DOMESTIC SUPPLY		5 GPM		Avg. I.D. 1.50 in:	1.602
TOTAL AMOUNT REQUIRED		24 GPM			
MAX DISTANCE WALL:		7 FT.		FRICITION 1.00 in	0.092033
				FRICITION 1.50 in	0.015348

	Individual Loss	Total Pressure
A. STATIC WATER PRESSURE AT SOURCE (10% off)	7.50	67.50 PSI
B. PIPE SIZE (1.50") 73 FT. X 0.01535	1.12	66.38 PSI
C. DEDUCT REDUCED PRESSURE DEVICE	0.00	66.38 PSI
D. DEDUCT METER LOSS		
METER SIZE (1.00")		
TOTAL METER LOSS	7.00	59.38 PSI
E. DEDUCT HEAD LOSS/GAIN FOR ELEVATION		
SYSTEM CONTROL VALVE.		
(HIGHEST ELEV. MINUS SOURCE ELEV.)		
HEAD ELEVATION: 5807		
SOURCE ELEVATION: 5591		
TOTAL: 16 X 0.434 =	6.94	52.44 PSI
F. DEDUCT PRESSURE LOSS FOR PIPING FROM		
G. PUMP	0.00 PSI	
SOURCE TO FARTHEST SPRINKLER.		
73 PIPE (1.00")..... 73		
1 CHECK VALVES..... 4		
3 ELBOWS (90 DEG.)... 21		
2 ELBOWS (45 DEG.).. 2		
4 TEES..... 20		
3 T-RUNS..... 3		
1 VALVES..... 1		
2 COUPLINGS..... 2		
TOTAL 126 X 0.09203 =	11.60	
TOTAL PRESSURE AVAILABLE AT FARTHEST SPRINKLER		40.84 PSI
MINIMUM PRESSUER REQUIRED		15.00 PSI
EXCESS PRESSURE		25.84 PSI



FIRE SPRINKLER CALCULATION SHEET

N.F.P.A. RESIDENTIAL HYDRAULIC CALCULATIONS SHEET

(TAKEN FROM FIGURE A-4-4.3(1) OF N.F.P.A. PAMPHLET 130)

C16 584001 CITY: BARKLEY PLUMBING CONTRACTOR: CRESTLINE PLUMBING OWNER: BILL MOLLER STREET: PO BOX 2895 LOT: 3 TRACT: 3224 APN: 0336-134-05 OWNER PH: (424) 634-2331	CALCULATIONS: KADTEC P.O. BOX 6885 CRESTLINE, CA. 92325 (909) 336-6970 / FAX (909) 337-2211 R.C.E. 48805
---	---

ALC. B 2 HEADS CALCULATION

PRESSURE: 75 psi	AGENCY: FIRE DEPT.	SPRINKLER HEAD TYPE: TYCO (concealed)
NUMBER OF HEADS: 2	19 GPM	C - FACTOR: 150
TOTAL FLOW: 38 GPM		K - FACTOR: 4.9
PRESSURE FOR SPRINKLER 15 PSI		Avg. I.D. 1.00 in: 1.109
DOMESTIC SUPPLY 5 GPM		Avg. I.D. 1.50 in: 1.602
TOTAL AMOUNT REQUIRED 43 GPM		
MAX DISTANCE WALL: 7 FT.		FRICTION 1.00 in 0.270688
		FRICTION 1.50 in 0.045142

	Individual Loss	Total Pressure
A. STATIC WATER PRESSURE AT SOURCE (10% off)	7.50	67.50 PSI
B. PIPE SIZE (1.50") 73 FT. X 0.04514	3.30	64.20 PSI
C. DEDUCT REDUCED PRESSURE DEVICE	0.00	64.20 PSI
D. DEDUCT METER LOSS		
METER SIZE (1.00")		
TOTAL METER LOSS	7.00	57.20 PSI
E. DEDUCT HEAD LOSS/GAIN FOR ELEVATION		
SYSTEM CONTROL VALVE.		
(HIGHEST ELEV. MINUS SOURCE ELEV.)		
HEAD ELEVATION: 5607		
SOURCE ELEVATION: 5591		
TOTAL: 16 X 0.434 =	6.94	50.26 PSI
F. DEDUCT PRESSURE LOSS FOR PIPING FROM		
G. PUMP	0.00 PSI	
SOURCE TO FARTHEST SPRINKLER.		
73 PIPE (1.00")..... 73		
1 CHECK VALVES..... 4		
3 ELBOWS (90 DEG.)... 21		
2 ELBOWS (45 DEG.).. 2		
4 TEES..... 20		
3 T-RUNS..... 3		
1 VALVES..... 1		
2 COUPLINGS..... 2		
TOTAL 126 X 0.27069 =	34.11	16.15
TOTAL PRESSURE AVAILABLE AT FARTHEST SPRINKLER		16.15 PSI
MINIMUM PRESSURE REQUIRED		15.00 PSI
EXCESS PRESSURE		1.15 PSI



Jan 17 2012

**Arimol Group Inc
PO Box 2895
Lake Arrowhead, CA. 92352**

Jan 17, 2012

Att:

Enclosed is a check in the amount of \$ 200.00 requesting, Will Serve Letters for new construction of 2 single family residences at the following addresses.

**1031 (A) Meadowbrook Road, Crest Park, CA 92326
APN #0336-134-02**

**1031 (B) Meadowbrook Road, Crest Park, CA. 92326
APN #0336-134-02**

Thank you

Bill Moller



CRESTLINE-LAKE ARROWHEAD WATER AGENCY

A Public Agency
P.O. BOX 3880 PHONE (909) 338-1779
24116 CREST FOREST DRIVE
CRESTLINE, CALIFORNIA 92325

January 11, 2012

Directors

STEPHEN L. PLEASANT, *President*
BRUCE D. RISHER
NORMAN C. MEEK
THOMAS L. SUTTON
KENNETH A. EATON

General Manager

ROXANNE M. HOLMES

Assistant General Manager/Board Secretary

JENNIFER A. SPINDLER

ARIMOL Group, Inc.
P.O. Box 2895
Lake Arrowhead, CA 92352

RE: Water Service Availability for Development on APN 336-134-02, etc.

Dear Sirs:

Your request for a water availability letter for the proposed development on Assessor's Parcel Number 336-134-02 was presented to this Agency's Board of Directors for discussion at its meeting of January 5, 2012. Noting that the proposed development includes two large structures of more than 9,000 square feet, and multiple bathrooms, for occupation by multiple tenants on the same parcel, the Board questioned the nature and scope of the proposed use, the fire flow requirements, possible landscaping irrigation demands, and potential concerns about the capacity of existing water supply facilities needed to satisfy that demand.

Therefore, the Board adopted a motion to require the preparation of a feasibility study to be prepared by the Agency's consulting engineers to assess the projected water supply demands for the proposed development, the adequacy of existing facilities to service that demand, and if existing capacity is insufficient, the system upgrades that would be needed to provide water service to the development.

Our preliminary research indicates that said APN 336-134-02, along with other large-size parcels and a number of smaller-size recorded tract lots, all appear to be potentially involved in this developer's phased improvement program within the Agency's retail Improvement District 'C' in the Meadowbrook (Crest Park) area.

Please provide the Agency with a deposit of \$20,000.00 to cover the Agency's current estimate of the consulting fees needed to prepare the feasibility study. If the deposit proves to be insufficient, the Agency will request an additional sum to cover

actual costs incurred. Conversely, if actual costs prove to be less than the amount of the deposit, the Agency will refund the balance to you.

To assist the Agency's engineers in preparing the feasibility study, please also provide a set of your development plans and any drawings, a copy of the County's conditions of approval, a copy of the local fire department's on site fire flow and fire sprinkler requirements, the number of domestic fixture units, and the maximum landscape irrigation flow required for the development. In addition, the Agency must have your ultimate development plans and preliminary time schedules for all of your properties within the Meadowbrook/Crest Park area. All such information will help expedite the preparation of the study and minimize the engineering costs incurred in preparing the study.

Enclosed and returned is your check number 1753 in the amount of \$200.00 for a water availability letter from the Agency. Once the feasibility study has been completed, you will be required to resubmit a letter requesting a water availability letter from the Agency with the appropriate fees.

Please note, prior to any work commencing, that you must submit the required deposit and all necessary information to the Agency.

Yours very truly,

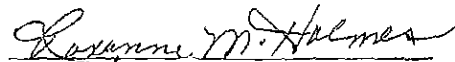

Roxanne M. Holmes,
General Manager

**Arimol Group Inc
PO Box 2895
Lake Arrowhead, CA. 92352**

Dec 7, 2011

DEC 21 2011

Att:

Enclosed is a check in the amount of \$ 200.00 requesting for 2 Will Serve Letters for new construction of 2 residences at the following addresses.

**1031 (A) Meadowbrook Road, Crest Park, CA 92326
APN #0336-134-02**

**1031 (B) Meadowbrook Road, Crest Park, CA. 92326
APN #0336-134-02**

Thank you

Bill Moller



CRESTLINE-LAKE ARROWHEAD WATER AGENCY

A Public Agency
P.O. BOX 3880 PHONE (909) 338-1779
24116 CREST FOREST DRIVE
CRESTLINE, CALIFORNIA 92325

November 4, 2011

Directors

STEPHEN L. PLEASANT, *President*
BRUCE D. RISHER
NORMAN C. MEEK
THOMAS L. SUTTON
KENNETH A. EATON

General Manager

ROXANNE M. HOLMES

Assistant General Manager/Board Secretary

JENNIFER A. SPINDLER

Arimol Group, Inc.
P.O. Box 2895
Lake Arrowhead, CA 92352

RE: Assessor's Parcel Number 336-131-08

Gentlemen:

This letter will confirm that the Crestline-Lake Arrowhead Water Agency is prepared to provide domestic water service to a single family residence, Assessor's Parcel Number 336-131-08, upon deposit of sums sufficient to cover Agency fees and charges, and upon compliance with the Agency's rules, regulations, ordinances, resolutions, policies and procedures.

Please be advised that prior to preparation of plans for development or construction, it will be necessary for you to confer with the local fire protection agency to ascertain any conditions or requirements in the development of your property to protect against fire hazards.

This service availability letter will expire automatically one year after the date of execution by the Agency unless a domestic meter has been installed by the Agency to serve your lot before that date. You are urged to make the necessary arrangements with the Agency for the installation of a meter as soon as possible.

Yours very truly,



Roxanne M. Holmes, General Manager

RMH: js

CRESTLINE-LAKE ARROWHEAD WATER AGENCY

A Public Agency
P.O. BOX 3880 PHONE (909) 338-1779
24116 CREST FOREST DRIVE
CRESTLINE, CALIFORNIA 92325

November 4, 2011

Directors

STEPHEN L. PLEASANT, *President*
BRUCE D. RISHER
NORMAN C. MEEK
THOMAS L. SUTTON
KENNETH A. EATON

General Manager

ROXANNE M. HOLMES

Assistant General Manager/Board Secretary

JENNIFER A. SPINDLER

Arimol Group, Inc.
P.O. Box 2895
Lake Arrowhead, CA 92352

RE: Assessor's Parcel Number 336-131-09

Gentlemen:

This letter will confirm that the Crestline-Lake Arrowhead Water Agency is prepared to provide domestic water service to a single family residence, Assessor's Parcel Number 336-131-09, upon deposit of sums sufficient to cover Agency fees and charges, and upon compliance with the Agency's rules, regulations, ordinances, resolutions, policies and procedures.

Please be advised that prior to preparation of plans for development or construction, it will be necessary for you to confer with the local fire protection agency to ascertain any conditions or requirements in the development of your property to protect against fire hazards.

This service availability letter will expire automatically one year after the date of execution by the Agency unless a domestic meter has been installed by the Agency to serve your lot before that date. You are urged to make the necessary arrangements with the Agency for the installation of a meter as soon as possible.

Yours very truly,

Roxanne M. Holmes, General Manager

RMH: js

**Arimol Group Inc
PO Box 2895
Lake Arrowhead, CA. 92352**

Att:

Enclosed is a check in the amount of \$ 200.00 requesting for 2 Will Serve Letters for new construction of 2 residences at the following addresses.

986 Meadowbrook Road, Crest Park, CA 92326
APN #0336-131-09

974 Meadowbrook Road, Crest Park, CA. 92326
APN #0336-131-08

Thank you

Bill Moller

CRESTLINE-LAKE ARROWHEAD WATER AGENCY

A Public Agency
P.O. BOX 3880 PHONE (909) 338-1779
24116 CREST FOREST DRIVE
CRESTLINE, CALIFORNIA 92325

October 31, 2011

Directors

STEPHEN L. PLEASANT, President
BRUCE D. RISHER
NORMAN C. MEEK
THOMAS L. SUTTON
KENNETH A. EATON

General Manager

ROXANNE M. HOLMES

Assistant General Manager/Board Secretary

JENNIFER A. SPINDLER

Arimol Group, Inc.
P.O. Box 2895
Lake Arrowhead, CA 92352

RE: Assessor's Parcel Number 336-134-03

Gentlemen:

This letter will confirm that the Crestline-Lake Arrowhead Water Agency is prepared to provide domestic water service to a single family residence, Assessor's Parcel Number 336-134-03, upon deposit of sums sufficient to cover Agency fees and charges, and upon compliance with the Agency's rules, regulations, ordinances, resolutions, policies and procedures.

Please be advised that prior to preparation of plans for development or construction, it will be necessary for you to confer with the local fire protection agency to ascertain any conditions or requirements in the development of your property to protect against fire hazards.

This service availability letter will expire automatically one year after the date of execution by the Agency unless a domestic meter has been installed by the Agency to serve your lot before that date. You are urged to make the necessary arrangements with the Agency for the installation of a meter as soon as possible.

Yours very truly,

Roxanne M. Holmes, General Manager

RMH: js

CRESTLINE-LAKE ARROWHEAD WATER AGENCY

A Public Agency
P.O. BOX 3880 PHONE (909) 338-1779
24116 CREST FOREST DRIVE
CRESTLINE, CALIFORNIA 92325

October 31, 2011

Directors

STEPHEN L. PLEASANT, *President*
BRUCE D. RISHIER
NORMAN C. MEEK
THOMAS L. SUTTON
KENNETH A. EATON

General Manager

ROXANNE M. HOLMES

Assistant General Manager/Board Secretary

JENNIFER A. SPINDLER

Arimol Group, Inc.
P.O. Box 2895
Lake Arrowhead, CA 92352

RE: Assessor's Parcel Number 336-134-05

Gentlemen:

This letter will confirm that the Crestline-Lake Arrowhead Water Agency is prepared to provide domestic water service to a single family residence, Assessor's Parcel Number 336-134-05, upon deposit of sums sufficient to cover Agency fees and charges, and upon compliance with the Agency's rules, regulations, ordinances, resolutions, policies and procedures.

Please be advised that prior to preparation of plans for development or construction, it will be necessary for you to confer with the local fire protection agency to ascertain any conditions or requirements in the development of your property to protect against fire hazards.

This service availability letter will expire automatically one year after the date of execution by the Agency unless a domestic meter has been installed by the Agency to serve your lot before that date. You are urged to make the necessary arrangements with the Agency for the installation of a meter as soon as possible.

Yours very truly,



Roxanne M. Holmes, General Manager

RMH: js

ARIMOL Group INC.
P.O. Box 2895
Lake Arrowhead, CA.
92352

OCT 26 2011

NOV 18 11

ATT. Note: Requestj will serve letter for
each letter - \$ 200.⁰⁰
Enclosed is a check for \$ 150.⁰⁰

for a flow test for a
request to build 2 new
residences at 977 and
995 - Meadowbrook Road
Crest Park, CA. 92326 along
with plans.

977 - Meadowbrook Rd
APN # 0336-134-05

995 - Meadowbrook Rd.
APN # 0336-134-03

Thank you

Bill Moll

Ph. 424-634-2331

Jan Zimmerman - RE: Meadowbrook Road

From: "Baker, Don - LUS" <Donald.Baker@lus.sbcounty.gov>
To: 'Jan Zimmerman' <JZimmerman@waterboards.ca.gov>
Date: 2/1/2012 4:24 PM
Subject: RE: Meadowbrook Road

No if this was some kind of common development it would need planning approval. The lots are separate and permits are being obtained parcel by parcel as any other permits or construction would be done. They just happen to be owned by one group.

Don

From: Jan Zimmerman [mailto:JZimmerman@waterboards.ca.gov]
Sent: Wednesday, February 01, 2012 3:25 PM
To: Baker, Don - LUS
Subject: RE: Meadowbrook Road

Thanks Don. I am wondering though, would multiple grading permits for adjacent parcels be considered a larger plan of common development? Does the County depend on the developer to disclose whether or not these projects are related or is it because the construction is in phases the county looks at them separately?

Thanks again.

Jan M. Zimmerman, PG
Engineering Geologist
Lahontan Regional Water Quality Control Board

Phone: 760/241-7376
Fax: 760/241-7308
jzimmerman@waterboards.ca.gov

>>> "Baker, Don - LUS" <Donald.Baker@lus.sbcounty.gov> 2/1/2012 2:21 PM >>>

Afternoon,

No grading permits have been submitted or approved. One house plan was submitted and approved at this time and it was for APN 0336-134-05. Other plans have been submitted but are in the review process. They are for APN 0336-134-02,03. 02 parcel has two houses that are intended for the site as it is a large enough lot to have two units on it by Development code requirements. this lot is one that has been graded but has not submitted grading plans for the site at this time and requires submittal and approvals prior to any construction.

Two other lots APN 036-131-08,09 have plan submittals also but as of this time are not approved. A total of six

houses have been submitted for approval and only one has been approved at this time.

You could contact Daniel Avera at (909) 387-8311 and request that the permit information be sent you if applicable.

*Don Baker, Plans Examiner
Building & Safety Division
Land Use Services Department
County of San Bernardino
(909) 387-4246
dbaker@lusd.sbcounty.gov*

From: Jan Zimmerman [mailto:JZimmerman@waterboards.ca.gov]
Sent: Wednesday, February 01, 2012 12:27 PM
To: Baker, Don - LUS
Subject: RE: Meadowbrook Road

Don,
I understand that there are 4 or 5 grading permits that have already been issued to Arimol for this development and 2 or 3 more still in review. Please confirm how many permits have been issued and how many are in review. Also, how can I get a copy of the permits issued to Arimol for this development?

Thanks.

Jan M. Zimmerman, PG
Engineering Geologist
Lahontan Regional Water Quality Control Board

Phone: 760/241-7376
Fax: 760/241-7308
jzimmerman@waterboards.ca.gov

>>> "Baker, Don - LUS" <Donald.Baker@lus.sbcounty.gov> 1/28/2012 7:22 AM >>>

thanks

*Don Baker, Plans Examiner
Building & Safety Division
Land Use Services Department*

County of San Bernardino
(909) 387-4246
dbaker@lusc.sbcounty.gov

From: Jan Zimmerman [mailto:JZimmerman@waterboards.ca.gov]
Sent: Friday, January 27, 2012 4:42 PM
To: mollabolla@yahoo.com
Cc: Jeff Brandt; JGIBSON@dfg.ca.gov; Baker, Don - LUS; Shannon L SPL Pankratz; Patrice Copeland; bryant2662@yahoo.com
Subject: Meadowbrook Road

Mr. Moller,

Today I reinspected your property at 1031 Meadowbrook Road, Crest Park. The intent of the inspection was to document the condition of the site and to determine compliance with our verbal order of 01/20/2012 to install an effective combination of sediment and erosion control best management practices (BMPs) to stabilize the disturbed areas. On 01/20/2012, I specifically requested that BMPs be placed at the inlet and outlet of the newly installed culvert, particularly sediment and erosion control BMPs on the slope opposite the point of discharge from the pipe culvert. At the time of my inspection, the only BMPs observed onsite were staked straw waddles along the southern portion of the site. No BMPs were observed at the inlet and no controls were observed at the outlet. The current condition of this site poses a significant threat to water quality and measures must be taken immediately to stabilize the exposed soils and to prevent unauthorized discharge to waters of the State. We request that you implement an effective combination of erosion and sediment control BMPs to stabilize the entire site by February 3, 2012, or within 24 hours of a forecasted rain event, whichever comes first. Please notify this office via email when BMP installation is complete. Please include a photographic log with your notification to document the implementation.

If you have any questions, please do not hesitate to contact me.

Jan M. Zimmerman, PG
Engineering Geologist
Lahontan Regional Water Quality Control Board

Phone: 760/241-7376
Fax: 760/241-7308
jzimmerman@waterboards.ca.gov

From: Joanna Gibson <JGIBSON@dfg.ca.gov>
To: bryant bergeson <bryant2662@yahoo.com>
CC: Jeff Brandt <JBrandt@dfg.ca.gov>, Rick Fischer <RFISCHER@dfg.ca.gov>, "S...
Date: 1/31/2012 11:18 AM
Subject: 1600-2011-0244-R6 - 1031 Meadowbrook Road, Crest Park, CA

Mr. Bergeson,

Please provide an update on the installation of BMPs at the above mentioned property. Also, per Condition 3.3 of Agreement 1600-2011-0244-R6, please provide a copy of the weekly report on the monitoring of the BMPs.

Thank you,
Joanna

Joanna Gibson
Environmental Scientist
CA Department of Fish and Game
Inland Deserts Region
3602 Inland Empire Blvd., Suite C-220
Ontario, CA 91764
(909) 987-7449 (voice)
(909) 481-2945 (fax)
jgibson@dfg.ca.gov

Jan Zimmerman - Executed Agreement 1600-2011-0244-R6

From: Juan Torres <JTORRES@dfg.ca.gov>
To: bryant bergeson <bryant2662@yahoo.com>
Date: 1/27/2012 8:20 AM
Subject: Executed Agreement 1600-2011-0244-R6
CC: Jeff Brandt <JBrandt@dfg.ca.gov>, Joanna Gibson <JGIBSON@dfg.ca.gov>, <S...
Attachments: 1600-2011-0244-R6 Agreement.pdf

Mr. Bergeson,

Attached is the executed Agreement # 1600-2011-0244-R6. A hard copy will follow soon. CDFG wants to coordinate future activities required by the Agreement with the RWQCB so please consider coordination with both agencies.

If you have any questions please contact us.

Sincerely,

Juan J. Lopez Torres
Department of Fish and Game
Habitat Conservation Branch
Inland Deserts Region
3602 Inland Empire Blvd., Suite C-220
Ontario, CA 91764
Phone: (909) 484-3979
Fax: (909) 481-2945
Email: Jtorres@dfg.ca.gov

CALIFORNIA DEPARTMENT OF FISH AND GAME
INLAND DESERTS REGION
3602 INLAND EMPIRE BLVD., SUITE C-220
ONTARIO, CA 91764



STREAMBED ALTERATION AGREEMENT
NOTIFICATION No. 1600-2011-0244-R6

ARIMOL GROUP INC.
NEW RESIDENCES AT 1031 MEADOWBROOK ROAD PROJECT

This Streambed Alteration Agreement (Agreement) is entered into between the California Department of Fish and Game (DFG) and Arimol Group, Inc., (Permittee), represented by Mr. Bill Moller.

RECITALS

WHEREAS, pursuant to Fish and Game Code (FGC) section 1602, Permittee notified DFG on October 25, 2011, that Permittee intends to complete the project described herein.

WHEREAS, pursuant to FGC section 1603, DFG has determined that the project could substantially adversely affect existing fish or wildlife resources and has included measures in the Agreement necessary to protect those resources.

WHEREAS, Permittee has reviewed the Agreement and accepts its terms and conditions, including the measures to protect fish and wildlife resources.

NOW THEREFORE, Permittee agrees to complete the project in accordance with the Agreement.

PROJECT LOCATION

The project is located within several unnamed tributaries to Lake Arrowhead, at 1031 Meadowbrook Road, in the community of Crest Park, County of San Bernardino, State of California; Latitude 34.235039, Longitude -117.204833.

PROJECT DESCRIPTION

Prior to notification, Permittee impacted streambeds and associated riparian vegetation at the above mentioned location. Permittee installed a minimum of 200 feet of 30-inch corrugated metal pipe and a concrete headwall within one ephemeral drainage, disturbed the bed and bank and placed rock riprap within a second ephemeral drainage, removed vegetation and stockpiled sediment and vegetative debris within a third ephemeral drainage, diverted and undergrounded approximately 100-feet of flow from a natural spring, and removed a minimum of 0.3 acres of *Salix spp.* dominated riparian habitat across the project site. Total impacts are estimated to include approximately 0.5

acres of jurisdictional areas, consisting entirely of ephemeral streambed habitat.

This Agreement has been prepared to partially address the unauthorized impacts to approximately 0.5 acres of jurisdictional areas at the project site. This Agreement authorizes two specific scopes, any future work on the project, related infrastructure, or restoration shall be authorized under a separate Lake and Streambed Alteration Agreement Notification.

This Agreement authorizes the Permittee to:

1. Install Best Management Practices (BMPs) across the project site;
2. Remove approximately 10 cubic yards of sediment and vegetative debris that was stockpiled in the ephemeral drainage at the southeastern corner of the property, adjacent to the "driveway" (depicted on plans provided to the Department during a site visit on January 20, 2012). Stockpiled material shall be placed in the "overflow parking" area, and BMPs shall be installed to prevent runoff.

PROJECT IMPACTS

This project has the potential to adversely affect existing native fish and wildlife resources that occur within, and/or have the potential to occur within ephemeral tributaries to Lake Arrowhead, within the vicinity of the community of Crest Park and surrounds, County of San Bernardino.

This Agreement partially addresses the adverse effects of the unauthorized activities at the project site. The full extent of impacts is currently unquantified and undisclosed and will be identified and mitigated under a separate Lake and Streambed Alteration Agreement Notification. The installation of BMPs and removal of stockpiled sediment and vegetative debris will result in temporary impacts to approximately 100 square feet of previously disturbed jurisdictional areas. These areas consist of ephemeral streambed and streambank. No trees or living vegetation shall be removed as a result of the project.

MEASURES TO PROTECT FISH AND WILDLIFE RESOURCES

1. Administrative Measures

Permittee shall meet each administrative requirement described below.

- 1.1 Documentation at Project Site. Permittee shall make the Agreement, any extensions and amendments to the Agreement, and all related notification materials and documents, readily available at the project site at all times to present to DFG personnel, or personnel from another state, federal, or local agency upon request.

- 1.2 Providing Agreement to Persons at Project Site. Permittee shall provide copies of the Agreement and any extensions and amendments to the Agreement to all persons who will be working on the project at the project site on behalf of Permittee, including but not limited to contractors, subcontractors, inspectors, and monitors.
- 1.3 Notification of Conflicting Provisions. Permittee shall notify DFG if Permittee determines or learns that a provision in the Agreement might conflict with a provision imposed on the project by another local, state, or federal agency. In that event, DFG shall contact Permittee to resolve any conflict.
- 1.4 Project Site Entry. Permittee agrees that DFG personnel may enter the project site at any time to verify compliance with the Agreement.
- 1.5 Take of Listed Species. The issuance of this Agreement does not authorize the take of any state and/or federally listed threatened, endangered, or fully protected species.
- 1.6 Take of Nesting Birds. Sections 3503, 3503.5, and 3513 of the FGC prohibit take of all birds and their active nests, including raptors and other migratory non-game birds (as listed under the Migratory Bird Treaty Act).

2. Avoidance and Minimization Measures

To avoid or minimize adverse impacts to the fish and wildlife resources identified above, Permittee shall implement each measure listed below.

- 2.1 Lighting Impacts. No lighting shall be allowed to impact jurisdictional areas, and the lighting and fencing for infrastructure adjacent to jurisdictional areas shall be designed or reviewed by a qualified biologist to allow wildlife to move within the open space and conserved areas without hindrance.
- 2.2 Nonnative plant species. DFG recommends the use of native plants to the greatest extent feasible in the landscaped areas adjacent to and/or near mitigation/open space areas and within or adjacent to stream channels. Permittee shall not plant, seed, or otherwise introduce invasive nonnative plant species to the landscaped areas adjacent to and/or near mitigation/open space areas and within or adjacent to stream channels (minimum 100 foot setback from open space areas and 150 foot setback from stream channels and wetland/riparian mitigation sites). Invasive nonnative plant species not to be used include those species listed on the "California Invasive Plant Inventory, February 2006" and the "February 2007 Inventory Update", (which are updates to Lists A & B of the California Exotic Pest Plant Council's list of "Exotic Pest Plants of Greatest Ecological Concern in California as of October 1999"). This list includes: pepper trees, pampas grass, fountain grass, ice plant, myoporum, black locust, capeweed, tree of heaven,

periwinkle, bush lupine, sweet alyssum, English ivy, French broom, Scotch broom, Spanish broom, and pepperweed. A copy of the complete list can be obtained by contacting the California Invasive Plant Council by phone at (510) 843-3902, at their website at www.cal-ipc.org, or by email at info@cal-ipc.org.

- 2.3 Best Management Practices. Permittee shall actively implement best management practices (BMPs) to prevent erosion and the discharge of sediment in to streams and lakes. BMPs shall be monitored daily and repaired if necessary to ensure maximum erosion and sediment control. All fiber rolls, straw waddles, and/or hay bales utilized within and adjacent to the project site shall be free of nonnative plant materials. Fiber rolls or erosion control mesh shall be made of loose-weave mesh that is not fused at the intersections of the weave, such as jute, or coconut (coir) fiber, or other products without welded weaves. Non-welded weaves reduce entanglement risks to wildlife by allowing animals to push through the weave, which expands when spread.
- 2.4 Pollution and Litter. Permittee shall comply with all litter and pollution laws. All contractors, subcontractors, and employees shall also obey these laws and it shall be the responsibility of Permittee to ensure compliance.
- 2.7.1 Permittee shall not allow water containing mud, silt, or other pollutants from grading, aggregate washing, or other activities to enter a lake, streambed, or flowing stream or be placed in locations that may be subjected to high storm flows.
- 2.7.2 Spoil sites shall not be located within a lake, streambed, or flowing stream or locations that may be subjected to high storm flows, where spoil shall be washed back into a lake, streambed, or flowing stream where it will impact streambed habitat and aquatic or riparian vegetation.
- 2.7.3 Raw cement/concrete or washings thereof, asphalt, paint, or other coating material, oil or other petroleum products, or any other substances which could be hazardous to fish and wildlife resources resulting from project related activities shall be prevented from contaminating the soil and/or entering the waters of the State. These materials, placed within or where they may enter a lake, streambed, or flowing stream by Permittee or any party working under contract or with the permission of Permittee, shall be removed immediately.
- 2.7.4 No broken concrete, cement, debris, soil, silt, sand, bark, slash, sawdust, rubbish, or washings thereof, oil or petroleum products, or other organic or earthen material from any construction or associated activity of whatever nature shall be allowed to enter into or be placed where it may be washed by rainfall or runoff into waters of the State. When operations are completed, any excess materials or debris shall be removed from the work

area. No rubbish shall be deposited within 150 feet of the high water mark of any lake, streambed, or flowing stream.

- 2.7.5 No equipment maintenance shall be done within or near any lake, streambed, or flowing stream where petroleum products or other pollutants from the equipment may enter these areas under any flow.

3. Mitigation Measures

To mitigate for adverse impacts to the fish and wildlife resources identified above that cannot be avoided or minimized, Permittee shall implement each measure listed below.

3.1 Identification of Full Project Impacts. **By March 30, 2012**, Permittee shall submit a separate Lake and Streambed Alteration Agreement Notification which identifies total project impacts incurred to date, as well as those proposed in the overall, larger, project scope. The Notification shall include mitigation to address impacts associated with the violations noted above, and mitigation for additional impacts associated with the larger project scope.

3.2 Habitat Restoration. Permittee shall submit a habitat restoration plan that addresses all impacts to jurisdictional areas within the project site. The habitat restoration plan shall include a detailed plant palette. The Department encourages the Permittee to consult with a qualified Biologist in the development of the habitat restoration plan. The habitat restoration plan shall be submitted with the Lake and Streambed Alteration Agreement Notification, **due to the Department no later than March 30, 2012.**

3.3 Monitoring of BMPs. The Permittee shall submit weekly reports detailing the success and/or failure of the BMPs. The reports shall include photographs taken from pre-established photostations and a discussion of any necessary maintenance activities. Reports shall be submitted to DFG until BMPs have been removed from the project site. Reports shall be mailed to DFG Inland Deserts Region at the address below under Contact Information. **Please reference SAA # 1600-2011-0244-R6.**

4. Reporting Measures

Permittee shall meet each reporting requirement described below.

- 4.1 Notification to CNDDDB. If any sensitive species are observed on or in proximity to the project site, or during project surveys, Permittee shall submit California Natural Diversity Data Base (CNDDDB) forms and maps to the CNDDDB within five working days of the sightings, and provide the regional DFG office with copies of the CNDDDB forms and survey maps. The CNDDDB form is available online at: www.dfg.ca.gov/whdab/pdfs/natspec.pdf. **This information shall be mailed within five days to:** DFG Natural Diversity Data Base, 1807 13th Street, Suite

202, Sacramento, CA 95814, Phone (916) 324-3812. A copy of this information shall also be mailed within five days to DFG Inland Deserts Region at the address below under Contact Information. **Please reference SAA # 1600-2011-0244-R6.**

CONTACT INFORMATION

Any communication that Permittee or DFG submits to the other shall be in writing and any communication or documentation shall be delivered to the address below by U.S. mail, fax, or email, or to such other address as Permittee or DFG specifies by written notice to the other.

To Permittee:

Mr. Bill Moller
Arimol Group, Inc.
P.O. Box 2895
Lake Arrowhead, CA 92352
mollabolla@yahoo.com

To DFG:

Department of Fish and Game
Inland Deserts Region
Lake and Streambed Alteration Program
Attn: Ms. Joanna Gibson
3602 Inland Empire Blvd., Suite C-220
Ontario, CA 91764
Notification #1600-2011-0244-R6
(909) 481-2945 (fax)
jgibson@dfg.ca.gov

LIABILITY

Permittee shall be solely liable for any violations of the Agreement, whether committed by Permittee or any person acting on behalf of Permittee, including its officers, employees, representatives, agents or contractors and subcontractors, to complete the project or any activity related to it that the Agreement authorizes.

This Agreement does not constitute DFG's endorsement of, or require Permittee to proceed with the project. The decision to proceed with the project is Permittee's alone.

SUSPENSION AND REVOCATION

DFG may suspend or revoke in its entirety the Agreement if it determines that Permittee or any person acting on behalf of Permittee, including its officers, employees, representatives, agents, or contractors and subcontractors, is not in compliance with the Agreement.

Before DFG suspends or revokes the Agreement, it shall provide Permittee written notice by certified or registered mail that it intends to suspend or revoke. The notice shall state the reason(s) for the proposed suspension or revocation, provide Permittee an opportunity to correct any deficiency before DFG suspends or revokes the Agreement, and include instructions to Permittee, if necessary, including but not limited to a directive to immediately cease the specific activity or activities that caused DFG to issue the notice.

ENFORCEMENT

Nothing in the Agreement precludes DFG from pursuing an enforcement action against Permittee instead of, or in addition to, suspending or revoking the Agreement.

Nothing in the Agreement limits or otherwise affects DFG's enforcement authority or that of its enforcement personnel.

OTHER LEGAL OBLIGATIONS

This Agreement does not relieve Permittee or any person acting on behalf of Permittee, including its officers, employees, representatives, agents, or contractors and subcontractors, from obtaining any other permits or authorizations that might be required under other federal, state, or local laws or regulations before beginning the project or an activity related to it.

This Agreement does not relieve Permittee or any person acting on behalf of Permittee, including its officers, employees, representatives, agents, or contractors and subcontractors, from complying with other applicable statutes in the FGC including, but not limited to, FGC sections 2050 et seq. (threatened and endangered species), 3503 (bird nests and eggs), 3503.5 (birds of prey), 5650 (water pollution), 5652 (refuse disposal into water), 5901 (fish passage), 5937 (sufficient water for fish), and 5948 (obstruction of stream).

Nothing in the Agreement authorizes Permittee or any person acting on behalf of Permittee, including its officers, employees, representatives, agents, or contractors and subcontractors, to trespass.

AMENDMENT

DFG may amend the Agreement at any time during its term if DFG determines the amendment is necessary to protect an existing fish or wildlife resource.

Permittee may amend the Agreement at any time during its term, provided the amendment is mutually agreed to in writing by DFG and Permittee. To request an amendment, Permittee shall submit to DFG a completed DFG "Request to Amend Lake or Streambed Alteration" form and include with the completed form payment of the corresponding amendment fee identified in DFG's current fee schedule (see Cal. Code Regs., tit. 14, § 699.5).

TRANSFER AND ASSIGNMENT

This Agreement may not be transferred or assigned to another entity, and any purported transfer or assignment of the Agreement to another entity shall not be valid or effective, unless the transfer or assignment is requested by Permittee in writing, as specified below, and thereafter DFG approves the transfer or assignment in writing.

The transfer or assignment of the Agreement to another entity shall constitute a minor amendment, and therefore to request a transfer or assignment, Permittee shall submit to DFG a completed DFG "Request to Amend Lake or Streambed Alteration" form and include with the completed form payment of the minor amendment fee identified in DFG's current fee schedule (see Cal. Code Regs., tit. 14, § 699.5).

EXTENSIONS

In accordance with FGC section 1605(b), Permittee may request one extension of the Agreement, provided the request is made prior to the expiration of the Agreement's term. To request an extension, Permittee shall submit to DFG a completed DFG "Request to Extend Lake or Streambed Alteration" form and include with the completed form payment of the extension fee identified in DFG's current fee schedule (see Cal. Code Regs., tit. 14, § 699.5). DFG shall process the extension request in accordance with FGC 1605(b) through (e).

If Permittee fails to submit a request to extend the Agreement prior to its expiration, Permittee must submit a new notification and notification fee before beginning or continuing the project the Agreement covers (Fish & G. Code, § 1605, subd. (f)).

EFFECTIVE DATE

The Agreement becomes effective on the date of DFG's signature, which shall be: 1) after Permittee's signature; 2) after DFG complies with all applicable requirements under the California Environmental Quality Act (CEQA); and 3) after payment of the

applicable FGC section 711.4 filing fee listed at:
http://www.dfg.ca.gov/habcon/ceqa/ceqa_changes.html.

TERM

This Agreement shall expire on **March 30, 2012**, unless it is terminated or extended before then. All provisions in the Agreement shall remain in force throughout its term. Permittee shall remain responsible for implementing any provisions specified herein to protect fish and wildlife resources after the Agreement expires or is terminated, as FGC section 1605(a)(2) requires.

AUTHORITY

If the person signing the Agreement (signatory) is doing so as a representative of Permittee, the signatory hereby acknowledges that he or she is doing so on Permittee's behalf and represents and warrants that he or she has the authority to legally bind Permittee to the provisions herein.

AUTHORIZATION

This Agreement authorizes only the project described herein. If Permittee begins or completes a project different from the project the Agreement authorizes, Permittee may be subject to civil or criminal prosecution for failing to notify DFG in accordance with FGC section 1602.

CONCURRENCE

The undersigned accepts and agrees to comply with all provisions contained herein.

FOR ARIMOL GROUP, INC.



Bill Moller
President

1-22-12
Date

FOR DEPARTMENT OF FISH AND GAME

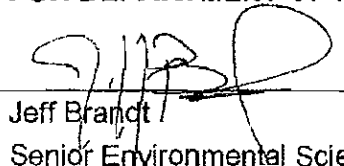

Jeff Brandt
Senior Environmental Scientist

1.26.12
Date

Prepared by: Joanna Gibson
Environmental Scientist

Jan Zimmerman - Re: 1600-2011-0244-R6 - 1031 Meadowbrook Road, Crest Park, CA

From: bryant bergeson <bryant2662@yahoo.com>
To: Jeff Brandt <JBrandt@dfg.ca.gov>
Date: 1/24/2012 6:37 AM
Subject: Re: 1600-2011-0244-R6 - 1031 Meadowbrook Road, Crest Park, CA
CC: "JGIBSON@dfg.ca.gov" <JGIBSON@dfg.ca.gov>, "Shannon.L.Pankratz@usace.arm...
Attachments: MX-2600N_20120123_161752.pdf

sorry, we forgot to attach the permit
bryant

From: Jeff Brandt <JBrandt@dfg.ca.gov>
To: bryant2662@yahoo.com
Cc: Jeff Brandt <JBrandt@dfg.ca.gov>; Joanna Gibson <JGIBSON@dfg.ca.gov>; Rick Fischer <RFISCHER@dfg.ca.gov>; Shannon.L.Pankratz@usace.army.mil; JZimmerman@waterboards.ca.gov; mollabolla@yahoo.com
Sent: Monday, January 23, 2012 5:28 PM
Subject: 1600-2011-0244-R6 - 1031 Meadowbrook Road, Crest Park, CA

Good afternoon Bryant.

The permit was not attached. We will process the permit within a day--please execute and return it ASAP.

To respond to your questions, we don't know the extent of the impacts and used a conservative estimate for the area. See the project description, we avoided quantifying the total impacts. As discussed, you will provide a better estimate of the impacts as you are developing the scope.

The BMP and sediment removal work outlined is exempt from CEQA.

Please cc the County planner on your response.

Thank you, Jeff

Sent from Jeff Brandt's Blackberry

-----Original Message-----

From: bryant bergeson <bryant2662@yahoo.com>
Cc: Gibson, Joanna <JGIBSON@dfg.ca.gov>
To: Brandt, Jeff <JBrandt@dfg.ca.gov>
Cc: Shannon.L.Pankratz@usace.army.mil <Shannon.L.Pankratz@usace.army.mil>
Cc: JZimmerman@waterboards.ca.gov <JZimmerman@waterboards.ca.gov>
To: bergeson, bryant <bryant2662@yahoo.com>
Cc: mollabolla@yahoo.com <mollabolla@yahoo.com>

Sent: 1/23/2012 4:35:41 PM
Subject: Re: 1600-2011-0244-R6 - 1031 Meadowbrook Road, Crest Park, CA

Jeff,

Attached is the signed agreement from Bill Moller.
1/21/12 the straw waddles staked with wood stakes.
1/22/12 removed bad waddle (green mesh)
No more work until weather permits and signatures are in order.

See attached pictures

We have some questions:

1. On page 1 and page 2 of 10, paragraph "Project Description", you mentioned we disturbed approximately 0.5 acres of jurisdictional areas. Does that mean that because we are less than 1 acre, does the State Water Board has fewer requirements?

2. On page 8 and page 9 of 10, paragraph "Effective Date", section 711.4 #3 it mentions a fee to be paid. We went to the web site, http://www.dfg.ca.gov/habcon/ceqa/ceqa_changes.html, to pay the CEQA fee and can't figure out which fee to pay or are we exempt?

thank you, Bryant

Bryant Bergeson
Civil Engineer, P.E. 48805
Phone: (909) 336-6970 (ext. 102)
Fax: (909) 337-2211
Address: 26748 HWY 189, Blue Jay, CA 92317
Mail: P.O. Box 6885 Crestline, CA 92325
E-Mail: bryant@kadtec.com

From: Jeff Brandt <JBrandt@dfg.ca.gov>
To: bryant bergeson <bryant2662@yahoo.com>
Cc: Joanna Gibson <JGIBSON@dfg.ca.gov>; "Shannon.L.Pankratz@usace.army.mil" <Shannon.L.Pankratz@usace.army.mil>; "JZimmerman@waterboards.ca.gov" <JZimmerman@waterboards.ca.gov>; "mollabolla@yahoo.com" <mollabolla@yahoo.com>
Sent: Sunday, January 22, 2012 12:58 PM
Subject: 1600-2011-0244-R6 - 1031 Meadowbrook Road, Crest Park, CA

Dear Mr. Moller.

On January 20, 2012, Department of Fish and Game (Department) staff visited the construction site at 1031 Meadowbrook Road, Crest Park, CA. During the visit, we observed the site had been significantly altered and several streams had been altered. The activities within the streams included diverting the flow of the two ephemeral streams, discharging into a stream, removing vegetation from the streams, grading and filling the streams, placing a corrugated metal pipe culvert to dewater a portion of a stream, constructing headwalls, obstructing flow within the streams, and designing structures to be constructed within and adjacent to streams. These activities are subject to Fish and Game Code section 1602.

Fish and Game Code section 1602 requires a person to notify the Department before: 1) substantially

file://C:\Documents and Settings\staff\Local Settings\Te

diverting or obstructing the natural flow of a river, stream, or lake; 2) substantially changing the bed, channel, or bank of a river, stream, or lake; 3) using any material from the bed, channel, or bank of a river, stream, or lake; and/or 4) depositing or disposing of debris, waste, material containing crumbled, flaked, or ground pavement where it may pass into a river, stream, or lake.

In this case, the Department has determined that notification was required because the activities are substantial and have significantly altered the flow and riparian habitat associated with the stream. The sites are also likely to produce significant discharges of sediment into the streams due to the nature of the activities and the lack of adequate best management practices to control onsite erosion.

In order to address this violation, we have prepared this streambed alteration agreement to address remedial work/interim actions that must be done to control erosion and the site. Enclosed is a draft Agreement that includes interim measures the Department has determined are necessary to protect existing fish and wildlife resources. This agreement has been prepared to address significant site problems and does not authorize permanent work associated with future projects. Because you submitted the Notification in response to the Department's request after we identified the violation, Fish and Game Code Section 1614 applies to your project. As a result, a draft Agreement will not be subject to arbitration.

Please be advised the Department may not execute the Agreement until it has complied with the California Environmental Quality Act (CEQA) (Public Resources Code section 21000 et seq.) as the lead or a responsible agency. Please note that the draft Agreement may be subject to change upon receipt and review of the environmental document for the project. At the meeting you noted you are working with the County of San Bernardino to process several other projects onsite.

Please note you may also need to check in with the County of San Bernardino, Regional Water Quality Control Board and the US Army Corps. The Department recommends you coordinate with the County of San Bernardino and host a meeting with the above entities so we may coordinate a response that both addresses the violation and allows you to progress with your plans to develop the site.

thank you, Jeff

Jeff Brandt
Department of Fish and Game
Habitat Conservation Branch
Inland Deserts Region

3602 Inland Empire Blvd., Suite C-220
Ontario, CA 91764
Phone: (909) 987-7161
Fax: (909) 481-2945
Email: JBrandt@dfg.ca.gov

>>> bryant bergeson <bryant2662@yahoo.com> 1/20/2012 2:04 PM >>>

Hello All,

Thanks for meeting with us today. We understand that a lot of tractor work and brush removal was done without the proper approvals. We also understand that water courses may have change from original because an old non-functioning pipe was removed and a pipe of similar size was put in it's place. To help preserve the original flows and sediment retention, we propose BMP's throughout the property. We

file://C:\Documents and Settings\staff\Local Settings\

will fix the straw wattles with wood stake anchoring. We will hay bail in more extreme cases and environmental netting in other places. We will also fix the netting at the construction site. We will take out the pipe and redesign the drainage at the appropriate time. In the spring we will re-vegetate. All the plans will be designed and approved by the appropriate agency prior to work commencing.

Sincerely yours,

Bill Moller
ARIMOL Group Inc.

Jan Zimmerman - Re: Photo's of Stream Bed alteration at Crest Park Site/ Arimol Group complaint

From: Jan Zimmerman
To: brianpattison@live.com; jgibson@dfg.ca.gov; noserenity@verizon.net
Date: 1/23/2012 8:41 AM
Subject: Re: Photo's of Stream Bed alteration at Crest Park Site/ Arimol Group complaint
CC: Copeland, Patrice

Curtis,

Thank you for the photographs. We appreciate your assistance and willingness to share these with us.

Jan M. Zimmerman, PG
Engineering Geologist
Lahontan Regional Water Quality Control Board

Phone: 760/241-7376
Fax: 760/241-7308
jzimmerman@waterboards.ca.gov

>>> <noserenity@verizon.net> 1/22/2012 12:58 PM >>>
I am attaching PDF files showing the following

- Aerial photos clearly showing a running stream including a stream running from the spring diverted by the camp house.
- Photo's showing the day of grading and dropping of storm drain pipes. If Arimol is claiming to your entities that he did not lay in pipe, these will show he is patently untruthful.
- Photo's showing the flora growth along the streambed and withing the bulldozed area in general

I'm sending this for Brian Pattison and have hard copies as well for you to examine. We had 105 residents at our community meeting and have raised the call for any/all photo's of the meadow before destruction, during work, etc..

I will send these over several emails as file size is large.

Thank you so much for your assistance.

Curtis Bayer, Coordinator
No Serenity Community Group

Jan Zimmerman - Arimol Group, Request for Information

From: Jan Zimmerman
To: attorneyknez@gmail.com
Date: 1/18/2012 5:08 PM
Subject: Arimol Group, Request for Information
CC: Copeland, Patrice

Mr. Knez,

We received your fax and request for information regarding a property in Crest Park Community of Lake Arrowhead, which is owned by the Arimol Group. The Water Board did receive a response to our Notice of Non-Compliance dated November 21, 2011. We are in the process of reviewing that response to determine compliance and whether or not future actions are warranted. In any information that you can share with us would be appreciated as we continue our investigation. As you requested we will send you a copy of the contents of our file.

If you have any questions, please do not hesitate to contact us.

Thank you.

Jan M. Zimmerman, PG
Engineering Geologist
Lahontan Regional Water Quality Control Board

Phone: 760/241-7376
Fax: 760/241-7308
jjzimmerman@waterboards.ca.gov

From: Tami Bayer <dappledesigns@verizon.net>
To: <jzimmerman@waterboards.ca.gov>
Date: 1/18/2012 4:43 PM
Subject: Photos of Crest Park Meadow
Attachments: summer2011A.jpg; winter2011B.jpg

Hi Jan,

Thank you for taking my call this afternoon about the damage in Crest Park. I found photos taken from my back deck which overlooks the meadow that I've attached for you. One was taken last winter and the other was taken over the summer. I hope these are helpful in some way. We will work to compile more photos from the rest of the community at the meeting on Friday night.

Tami Bayer

Jan Zimmerman - Fwd: Meadowbrook Rd

From: Bill Moller <mollabolla@yahoo.com>
To: Jan Zimmerman <JZimmerman@waterboards.ca.gov>
Date: 10/24/2011 8:34 PM
Subject: Fwd: Meadowbrook Rd
Attachments: MX-2600N_20111024_103555.pdf; MX-2600N_20111024_103615.pdf

Hello Ms Zimmerman

Attached for your files is a copy of all information delivered to Ms Gibson at Dept Of Fish and Game regarding her request for items. If you need anything further please advise.

Thx. Bill Moller

Begin forwarded message:

From: "Jill Holmes" <jill@kadtec.com>
Date: October 24, 2011 10:23:32 AM PDT
To: <mollabolla@yahoo.com>
Subject: scans from kadtec

Thank you,

Jill A. Holmes
Office Manager - Kadtec
Voice: 909-336-6970
Fax: 909-337-2211
jill@kadtec.com
Send US Mail to:
Kadtec
PO Box 6885
Crestline, CA 92325

Arimol Group Inc.
Bill Moller, President
PO Box 2895
Lake Arrowhead, CA. 92352

Joanna Gibson
Environmental Scientist
CA Department of Fish & Game
Inland Deserts Region
3602 Inland Empire Blvd.
Suite C-220
Ontario, CA 91764

Oct 20, 2011

Dear Ms. Gibson:

Our firm, Arimol Group Inc., on June 1, of this year purchased a total of 21 acres of property from Concordia University known as the Arrowhead Lutheran Camp with numerous buildings and vacant land. In July, 2011 we had a Inspection from the San Bernardino Health Dept and one of their corrections was to have a Fire Dept inspection of the grounds and buildings. We arranged that inspection on August 2, and I met with Fire Inspector, Catherine Iglesias from the San Bernardino Fire Dept. We walked the property and she advised me that we must clear all brush with-in 100 ft. of any building, remove trees that are 4 inches or smaller with-in 100 ft of any building, and to cut all branches and limbs off the larger trees up to a height of 8 ft. off the ground for fire clearance. When completed to call for inspection.

Attached is a copy of a notice that was sent out from San Bernardino County Environmental health-Land Use Services Dept/ Fire Hazard Abatement. 385 N. Arrowhead Ave., First Floor, San Bernardino, CA. 92415

This is not the original order sent to Concordia University prior to us purchasing the property, only a copy that is sent out by Land Use Services demanding that clearance work was to be completed by July 26, 2011, and this is one reason once we were notified of this problem, we proceeded Immediately to begin to clear all the weeds, grasses, brush etc. on our properties prior to the Fire Dept inspection, after being notified that if we didn't clear everything, the County would send a Company in to do the clearing and charge us a undisclosed amount of dollars.

This Notice is a Fire Hazard Abatement Program and is conducted by the County on behalf of Lake Arrowhead Fire. Authority for these rules is contained in the San Bernardino County Code, Title 2, Division 3, Chapter 3, Section 23.0301.

No one from the County of San Bernardino authorized me to clear the entire property. We did not clear the entire property, we only cleared the brush from the perimeter of the property, and approx 60 percent of the property was already a graded vacant lot and has been for years, it has been used as a sports field.

On Wednesday, Oct. 19, I received a call from the Dept of Building & Safety requesting a grading plan of the site. I will be submitting this plan to the Building Dept on Monday morning, Oct 24 and obtaining a grading permit per their request.

We have not moved any dirt on or off the site, only the brush for the fire clearance.

I have included that grading plan along with the other information you requested that we are sending to you and the California Lahontan Regional Water Quality Control Board, Jan Zimmerman, via regular mail. On your copy of the plan I have showed the houses that are within the 100 ft fire clearance required and the proposed houses we intend on building on the site.

After your review and inspection of the site, please advise us what is needed from us to correct and resolve any issues that you feel we need to correct.

Thank you



Bill Moller

First American Title

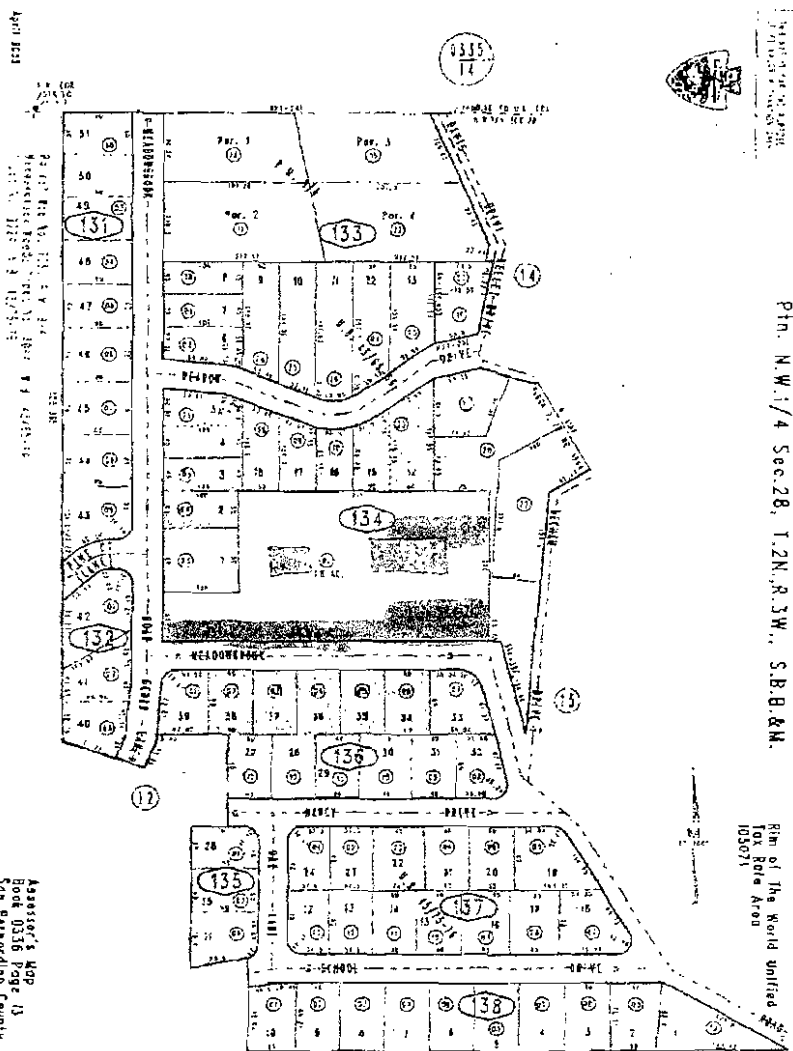

Plat. N.W. 1/4 Sec. 28, T. 2N, R. 3W., S.B.B. & M.

Plat of the World United for Role Area 105071

0358-13

- - Brush Cleared
- ◻ - new Proposed Building
- ⊗ - Houses within 100' of Brush removed.

Assessor's Map Book 0356 Page 13 San Bernardino County

Order Number: D623-3741829 Page Number: 9

YOU ARE HEREBY NOTIFIED TO REMOVE FROM YOUR PROPERTY (INCLUDING PARKWAYS, ROADS AND EASEMENTS) SPECIFIC MENTIONED ITEMS DESCRIBED BELOW WHICH CONSTITUTE A FIRE HAZARD.

- Item(s) WEEDS AND GRASSES-Annual growth must be cut to 4 inches or less in designated areas.
TREE TRIMMINGS/BRUSH ON THE GROUND-must be completely removed from your property.
- Location(s) Fence lines and/or property boundaries.
Areas surrounding residence or other structures.
Vacant portions/rear portions of property.
Remove pile or piles of combustible material.
Roadside and parkways.
Complete abatement of above hazards required.

*****IMPORTANT***IMPORTANT***IMPORTANT*****

IF SAID ITEMS ARE NOT REMOVED OR ABATED BY 07/26/2011 A DULY DESIGNATED OFFICER MAY ORDER SAID ITEMS REMOVED OR ABATED. IF THIS AGENCY HAS THE ABOVE SAID ITEMS ABATED OR REMOVED, THE ACTUAL COST PLUS HIGHER ADMINISTRATIVE CHARGES SHALL BE LEVIED AND ASSESSED AGAINST THE PROPERTY AS A SPECIAL ASSESSMENT LIEN, OR BILLED DIRECTLY TO THE PROPERTY OWNER.

Any questions regarding this notice must be brought forth prior to the last date to REMOVE, and directed to the agency officer whose name and address appear below. The agency officer will answer any questions and/or arrange for a hearing. Pursuant to San Bernardino Code, Section 23.040, any appeal to this Notice must be filed in writing with the enforcement officer listed below within the time for compliance of this notice. If you clear your parcel after the time for compliance of this notice, a \$2.00 fee may be added as a special assessment lien. A \$2.00 fee will be assessed if a warrant is obtained for property entry to abate the hazards.

BE ADVISED THAT REGROWTH AND/OR RE-ESTABLISHMENT OF LISTED HAZARDS AFTER THE FIRST REMOVAL SHOULD NOT BE PERMITTED DURING THE FIRE SEASON, OR ABATEMENT CREWS MAY CLEAR THE HAZARDS WITHOUT ADDITIONAL NOTIFICATION. IF YOU DESIRE TO BE NOTIFIED AGAIN, YOU MUST REQUEST A LETTER OF COMPLIANCE UPON THE COMPLETION OF REQUIRED WORK. If you receive notices on adjacent parcels of property and you wish them abated as one piece of land, contact this office, in writing, prior to the expiration date shown above. If you do not make prior arrangements with us and the work is done by the agency shown on this notice, the adjacent parcels will be billed separately for cost of abatement and administrative charges. Also, it is necessary that these arrangements be renewed, in writing, each time a notice is issued.

FIRE HAZARD OFFICER

385 N. ARROWHEAD

SAN BERNARDINO, CA 924150185

(909)-387-4044

Message Phone

(000)-000-0000

Date Mailed

06/24/2011

Office Hours

8am - 5:00pm

First Inspection Date

06/21/2011

COST TO EXCEED:

\$0.00

REMARKS:

Jan Zimmerman - Re: Grading at 1031 Meadowbrook Road, Lake Arrowhead

From: Serenitylodge <serenitylodgearrowhead@yahoo.com>
To: Jan Zimmerman <JZimmerman@waterboards.ca.gov>
Date: 10/18/2011 3:51 PM
Subject: Re: Grading at 1031 Meadowbrook Road, Lake Arrowhead
CC: Bill <serenitylodgearrowhead@yahoo.com>, Kadtec Bryant <bryant2662@yahoo...>

Hello Ms Zimmerman

I see you have read the correspondence between Ms Gibson and myself. To add to that information provided the parcel in question is 1.8 acres. The brush we have removed around the perimeter of the property only is for sure under a acre. We also were doing a survey and topo on the property and needed to clear the brush for our surveyor so he could see the lay of the land. The survey should be complete by the end of the week and I will submit a copy to you and Ms Gibson for review. Also I am putting together the items Ms Gibson requested from me and sub

Urging to her at the end of the week. I will copy you also on that information. We do plan on building on the site in the near future. I do apologize for any disturbance to the land thT I was unaware I was doing and agree to resolve any issues you feel need corrected after you do your inspection.

Thank you

Bill Moller

On Oct 18, 2011, at 10:11 AM, Jan Zimmerman <JZimmerman@waterboards.ca.gov> wrote:

Mr. Moller,

On October 17, 2011, Lahontan Regional Water Quality Control Board staff received a complaint regarding recent grading activities at your site located on Meadow Brook Road in Lake Arrowhead. Please be advised that construction activities that disturb more than one acre of land (or those projects that are part of a larger common plan of development that cumulatively is greater than one acre) are required to be covered under the Statewide General Permit for Discharges of Storm Water Associated with Construction Activity (Construction General Permit Order No. 2009-0009-DWQ). Information regarding the Construction General Permit and the requirements, including preparation and implementation of a site-specific Stormwater Pollution Prevention Plan (SWPPP), can be found on the State Water Resources Control Board website at http://www.waterboards.ca.gov/water_issues/programs/stormwater/construction.shtml. Coverage under the Construction General Permit must be obtained electronically through the online SMARTS system, which can be accessed at http://www.waterboards.ca.gov/water_issues/programs/stormwater/databases.shtml#const_db. Keep in mind that new State regulations require that only qualified and certified individuals prepare and implement the components of the SWPPP. Specific questions regarding the Construction General Permit can be directed to Mary Dellavalle in our office at 760/241-7365, mdellavalle@waterboards.ca.gov.

In addition, it appears that your grading and vegetation clearing has disturbed at least two natural drainage channels that traverse your property. Impacts to natural drainage channels (grading and infilling) and culvert installation changes the dynamics of the flows (hydromodification), which often results in impacts to water quality both upstream and downstream. Any grading, infilling, or disturbance to a surface water (streambed alteration type activities) triggers a permitting action through the Regional Water Board in addition to any permitting action that may be required by the California Department of Fish and Game. Also, if the surface waters are tributary to a water of the

U.S., for example Lake Arrowhead, such disturbance would also likely trigger a permitting action through the Army Corps of Engineers under section 404 of the federal Clean Water Act. Information regarding permitting requirements for projects that impact surface waters can be found on our website at http://www.waterboards.ca.gov/lahontan/water_issues/programs/clean_water_act_401/index.shtml. Specific questions regarding these types of projects should be directed to me, Jan Zimmerman, at 760/241-7376.

I intend to inspect your site this week to observe current site conditions and to discern whether any permitting requirements are warranted for your project. In the interim, we recommend at minimum that you provide immediate protection for the culvert inlets and outlets on your property so that flow is maintained through the pipe (and not diverted) and to prevent sediment or debris from blocking flows and/or being carried downstream from your site.

If you have any questions, please do not hesitate to contact either myself or my supervisor, Patrice Copeland (760/241-7404; pcopeland@waterboards.ca.gov).

Thank you.

Jan M. Zimmerman, PG
Engineering Geologist
Lahontan Regional Water Quality Control Board

Phone: 760/241-7376
Fax: 760/241-7308
zimmerman@waterboards.ca.gov

>>> Joanna Gibson <JGIBSON@dfg.ca.gov> 10/17/2011 12:56 PM >>>
Mr. Moller,

The Department of Fish and Game (Department) was recently made aware of grading activities on your property at 1031 Meadowbrook Road, Lake Arrowhead, CA. You indicated that the San Bernardino County Fire Department inspected the property and directed you to clear all brush within 100-feet of all buildings? Please provide me with a copy of this directive. Also, please provide the name and contact information for the person who authorized grading of the entire property from the County of San Bernardino.

The Department understands that grading activities may have encroached on ephemeral streams on the property. Please note that Section 1602 of the California Fish and Game Code requires an entity or person to notify the Department and obtain an agreement prior to conducting a project that may impact a lake, river, stream, drainage, or other watercourse and associated riparian vegetation (please note that the presence of water does not determine the Department's jurisdiction). Please go to the following link to read more about our Lake and Streambed Alteration Program: <http://www.dfg.ca.gov/habcon/1600/>.

Please cease all activities within the Department's jurisdiction immediately. After I have received the requested information I will contact you to arrange a site visit.

If you have any questions, please contact me.

Joanna Gibson
Environmental Scientist
CA Department of Fish and Game
Inland Deserts Region

Jan Zimmerman - Re: Grading at 1031 Meadowbrook Road, Lake Arrowhead

From: Jan Zimmerman
To: Gibson, Joanna
Date: 10/17/2011 2:05 PM
Subject: Re: Grading at 1031 Meadowbrook Road, Lake Arrowhead
CC: Copeland, Patrice

Joanna,

Thank you for the cc. We received a complaint this morning and will be following up with a site visit this week. We will coordinate with you regarding any of our concerns pertaining to the site, construction activities to date and proposed, impacts to waters of the State, etc. Please forward to us any of the requested correspondence that you receive from Mr. Moller.

Thanks!

Jan M. Zimmerman, PG
Engineering Geologist
Lahontan Regional Water Quality Control Board

Phone: 760/241-7376
Fax: 760/241-7308
jjzimmerman@waterboards.ca.gov

>>> Joanna Gibson <JGIBSON@dfg.ca.gov> 10/17/2011 12:56 PM >>>
Mr. Moller,

The Department of Fish and Game (Department) was recently made aware of grading activities on your property at 1031 Meadowbrook Road, Lake Arrowhead, CA. You indicated that the San Bernardino County Fire Department inspected the property and directed you to clear all brush within 100-feet of all buildings? Please provide me with a copy of this directive. Also, please provide the name and contact information for the person who authorized grading of the entire property from the County of San Bernardino.

The Department understands that grading activities may have encroached on ephemeral streams on the property. Please note that Section 1602 of the California Fish and Game Code requires an entity or person to notify the Department and obtain an agreement prior to conducting a project that may impact a lake, river, stream, drainage, or other watercourse and associated riparian vegetation (please note that the presence of water does not determine the Department's jurisdiction). Please go to the following link to read more about our Lake and Streambed Alteration Program: <http://www.dfg.ca.gov/habcon/1600/>.

Please cease all activities within the Department's jurisdiction immediately. After I have received the requested information I will contact you to arrange a site visit.

If you have any questions, please contact me.

Joanna Gibson
Environmental Scientist
CA Department of Fish and Game
Inland Deserts Region

From: Bill Moller <serenitylodgearrowhead@yahoo.com>
To: "jgibson@dfg.ca.gov" <jgibson@dfg.ca.gov>, "serenitylodgearrowhead@yahoo...
Date: 10/13/2011 9:41 PM
Subject: Lake Arrowhead
Attachments: F&G 6.JPG; F&G 5.JPG; F&G 4.JPG; F&G 3.JPG; F&G 2.JPG; F&G 1.JPG

Hello Ms. Gibson

Attached are pictures regarding the compliant you received of the water drainage w discussed over the phone after your Game Warden, Rick Fischer met with me on the property at 1031 Meadowbrook Road

I previously met with the SB County Fire Dept for an inspection of our grounds and they directed us to clear all brush with-in 100 foot of all buildings, so we proceeded to do so, not knowing we needed to contact your agency. I apologize for that error.

Attached are 6 pictures showing the 2 culverts from across the street entering one larger culvert that travels underground through our property. We cleared all the brush above grade and disposed of it. The brush had grown up to 20 ft in height over the years all over the property and was indeed a danger to the community.

We purchased this property in June of this year.

We do plan on building on the property and will submit plans to you when we do so.

If we need to do anything further please feel free to contact me.

Thank you

Bill Moller Phone 424-634-2331

EXHIBIT NO. 2

INSPECTION REPORT: SERENITY LODGE, LAKE ARROWHEAD

COMPLAINT DATE: October 17, 2011

INSPECTION DATE: October 21, 2011

INSPECTOR: Jan M. Zimmerman, Engineering Geologist

WDID: Unregulated, complaint

TYPE: Dredge & Fill/Stormwater

DISCHARGER: Serenity Lodge

DISCHARGER CONTACT: Bill Moller

DISCHARGER ADDRESS: Unknown, Lake Arrowhead

FACILITY NAME: Serenity Lodge

FACILITY ADDRESS: 1031 Meadow Brook Road, Lake Arrowhead

FIELD OBSERVATIONS AND COMMENTS

On Friday October 21, 2011, Water Board staff performed an inspection of the site to observe current conditions of the site. The inspection was performed in response to a complaint received on October 17, 2011. The complainant, a nearby resident, alleged that grading of the site and infilling of two natural drainage channels, both tributary to Lake Arrowhead, had occurred. Staff arrived onsite at approximately 1pm.

The site is located at the northeast corner of Meadow Brook Road and Cedar Court within the Crest Park neighborhood of Lake Arrowhead. The site is approximately 1.8 acres of undeveloped land and is surrounded by residential properties to the north, east, and south. To the west is Serenity Lodge, a commercial facility, which was reportedly recently purchased by the current owner in June 2011. The owner of Serenity Lodge also owns the project site. According to the Google Earth aerial photograph dated February 1, 2009, the site appeared to be traversed from southwest to the northeast by a drainage channel, and the majority of the parcel appeared to be covered with mature trees and vegetation.

At the time of the inspection, the site was devoid of vegetation except for several large trees remaining around the perimeter of the site (photo 1). No equipment was operating and no one was onsite at the time of the inspection. Upstream drainage crosses Meadow Brook Road via underground culverts and enters the site at the southwest corner of the property (photo 2 and 3). The drainage enters a 36-inch corrugated metal culvert, which was constructed with a concrete headwall and buried below the existing ground surface of the site (photo 4). The onsite culvert discharges to a natural drainage channel along the eastern perimeter of the site (photo 5), the confluence of which is near right-angles. Grading and disturbance within the natural drainage channel was observed during the inspection (photo 6), and stockpiled soils and grubbed vegetation were noted along the top of bank. The drainage in the eastern channel enters an existing concrete culvert (photo 7), which discharges to a steep-walled canyon drainage channel that, at the time of the inspection, had flowing water.

No soil or erosion control best management practices (BMPs) were implemented, and no culvert inlet and outlet protection was provided at the time of the inspection.

At around 2 pm, staff was met by Mr. Curtis Bayer, a nearby resident concerned about the grading and current status of the site. According to Mr. Bayer, the grading and disturbance began October 6, 2011, and installation of the 36-inch culvert was completed by October 7, 2011. Mr. Bayer stated that prior to the disturbance, the natural drainage channel traversed the site from southwest to northeast, was approximately 20-feet in width, and was flanked by mature vegetation.

ACTION RECOMMENDED

- Immediately implement stabilization and erosion control BMPs to ensure that sediment does not leave the site;
- Provide protection around the inlets and outlets for all onsite culverts;
- Evaluate the confluence of the culvert and the natural drainage channel on the eastern side of the site and calculate flow volumes and velocities which should be used to design the appropriate slope protection, energy dissipation, and channel protection at the point of discharge;
- Apply for and obtain coverage under the Construction General Permit for Stormwater Discharges (2009-0009-DWQ), which includes the development and implementation of a site-specific Stormwater Pollution Prevention Plan;
- Consult with United States Army Corps of Engineer staff to determine if the project impacts a water of the U.S.;
- Discharger must offer sufficient mitigation to compensate for loss of beneficial uses as a result of project implementation.

INSPECTION PHOTOGRAPHS Photos taken by J.M. Zimmerman 10/21/2011.



Photo 1. View looking east across the site. Trees to left and right of photograph roughly define north and south property boundaries.



Photo 2. View of one of two culverts that convey offsite drainage under the roadway and discharges at the southwest corner of the site.



Photo 3. View of natural drainage channel upstream from site. Drainage enters culvert that discharges onsite (refer to photo 2).



Photo 4. View of culvert and concrete headwall that conveys drainage across the site. This inlet is located approximately 10-feet downstream from the existing culvert discharge points in the southwestern corner of the site.



Photo 5. View looking west (upstream) across the site. The onsite culvert discharges to a natural drainage channel on the east side of the property (foreground). Rock cobbles and boulders placed on downstream side of discharge.



Photo 6. View upstream of natural drainage channel new culvert outlet to right of photograph. Note the grubbed vegetation and stockpiled soils and lack of stabilization or erosion control BMPs.



Photo 7. Onsite drainage enters an existing culvert in the northeastern corner of the site. This culvert discharges to a steep-walled canyon drainage.

U:\PATRICE UNIT\Jan\Inspections\SerenityLodge_10212011.doc

EXHIBIT NO. 3



Matthew Rodriguez
Secretary for
Environmental Protection

California Regional Water Quality Control Board Lahontan Region



Edmund G. Brown Jr.
Governor

Victorville Office

14440 Civic Drive, Suite 200, Victorville, California 92392
(760) 241-6583 • FAX (760) 241-7308
<http://www.waterboards.ca.gov/lahontan>

November 21, 2011

CERTIFIED MAIL No. 7009 1410 0001 7938 5137

Bill Moller, President
Arimol Group, Inc.
4173 Maritime Road
Rancho Palos Verdes, CA 90275
serenityconferencecenter@yahoo.com

NOTICE OF NON-COMPLIANCE WITH THE CALIFORNIA WATER CODE AND WITH THE GENERAL PERMIT FOR STORM WATER DISCHARGES ASSOCIATED WITH CONSTRUCTION ACTIVITIES, ORDER NO. 2009-0009-DWQ, 1031 MEADOW BROOK ROAD, LAKE ARROWHEAD, SAN BERNARDINO COUNTY

The California Regional Water Quality Control Board, Lahontan Region (Water Board) received a complaint on October 17, 2011, regarding grading in a natural drainage channel on the property located at 1031 Meadow Brook Road in the Crest Park community of Lake Arrowhead. Water Board staff inspected the site on October 21, 2011, and observed recent grading and construction activities across a majority of the 1.8 acre site. Staff observed a corrugated metal pipe culvert buried within a natural drainage channel on the site, as well as evidence of recent grading and fill placement within a secondary drainage channel along the perimeter of the site. Several violations were observed during that inspection, as outlined below.

- Evidence of unauthorized dredging, filling, and/or excavating in two separate drainage channels, both waters of the State, was observed. These types of activities have the potential to degrade water quality and constitute a discharge of waste¹ as defined in California Water Code section 13050. Discharging waste to a water of the State without regulatory authorization is a violation of sections 13160 and 13260 of the California Water Code.
- Evidence of grading, grubbing, and vegetation clearing over an area greater than one acre was observed. Projects that disturb more than one acre of land are required to obtain coverage under the Statewide General Permit for Discharges of Storm Water Associated with Construction Activity Order No. 2009-0009-DWQ

¹ "Waste" is defined in the *Water Quality Control Plan for the Lahontan Region (Basin Plan)* to include any waste or deleterious material including, but not limited to, waste earthen materials (such as soil, silt, sand, clay, rock, or other organic or mineral material) and any other waste as defined in the California Water Code, section 13050(d).

(Construction General Permit). Failure to obtain coverage is a violation of the section 402(p) of the federal Clean Water Act.

- Disturbed soils were exposed across the site. Unprotected, stockpiled soils were observed along the top of the bank of a natural drainage channel in the eastern portion of the site. No slope stabilization or erosion control Best Management practices (BMPs) were observed. At a minimum, the Construction General Permit requires that an **effective combination of erosion and sediment controls** be implemented on all disturbed areas during the rainy season. These disturbed areas include rough-graded roadways, slopes, and building pads. In order to prevent discharge of pollutants, including sediment, a full range of sediment and erosion control BMPs must be considered. Please ensure that erosion and sediment control BMPs are properly implemented and maintained along all disturbed areas at this site to prevent soils from eroding and sediment discharging from the site.
- On October 18, 2011, staff contacted you via email and instructed you to "provide immediate protection for the culvert inlets and outlets on your property so that flow is maintained through the pipe (and not diverted) and to prevent sediment or debris from blocking flows and/or being carried downstream from your site." At the time of the inspection, there were no BMPs implemented nor was there evidence that BMPs had previously been implemented at the culvert inlets and outlets.

You are in violation of the California Water Code and the Clean Water Act. We request that you address the problems outlined above immediately.

No later than **December 9, 2011**, you must submit the information outlined below to the Water Board's office in Victorville. Failure to submit the information requested below may result in enforcement action, including civil monetary penalties of up to \$5,000 per violation for each day of violation.

- Verification that you have filed a Notice of Intent (NOI) for coverage under the Construction General Permit electronically with the State Water Resources Control Board through the online SMARTS system, which can be accessed at http://www.waterboards.ca.gov/water_issues/programs/stormwater/databases.shtml#const_db;
- Submit a signed copy of the site-specific Storm Water Pollution Prevention Plan (SWPPP) developed for this site. A copy of the SWPPP must be maintained at the site at all times until grading and construction are complete. Keep in mind that new State regulations require that only qualified and certified individuals prepare and implement the components of the SWPPP;
- Proof that you have implemented an **effective combination of erosion and sediment control BMPs** at this site. These erosion and sediment control BMPs

must be implemented and maintained throughout grading and construction activities at this site; and

- Submit a **complete** *Application For Clean Water Act Section 401 Water Quality Certification And/Or Waste Discharge Requirements For Projects Involving Discharge Of Dredged And/Or Fill Material To Waters Of The U.S. And/Or Waters Of The State* (Application). The Application must fully describe the proposed discharge and construction within surface water areas. The Application can be accessed online at www.waterboards.ca.gov/lahontan/water_issues/programs/clean_water_act_401/index.shtml. A copy of the Application and the instructions for completing the Application are enclosed for your reference.

Be advised that pursuant to California Water Code, section 13261, failure to file a complete Application before discharging to surface water, or discharging without regulatory authorization, may result in substantial civil or criminal penalties. In addition, failure to obtain coverage under the Construction General Permit may result in an additional penalty of \$5,000 under section 13399.33(a)(1) of the California Water Code.

Please direct specific questions regarding the Construction General Permit to Mary Dellavalle, Environmental Scientist, in our office at (760) 241-7365, mdellavalle@waterboards.ca.gov. For all other questions regarding this letter, please contact Jan Zimmerman, Engineering Geologist, at (760) 241-7376 (jjzimmerman@waterboards.ca.gov).

Sincerely,



Patrice Copeland, PG
Senior Engineering Geologist
Chief, S. Basin Land Disposal Unit

Enc: (1) Application for 401 WQC/Dredge and Fill
(2) Instructions for Completing the Application

cc w/o enc: Daniel Swenson, United States Army Corps of Engineers
(via email, Daniel.P.Swenson@usace.army.mil)
Joanna Gibson, California Department of Fish and Game
(via email, JGIBSON@dfg.ca.gov)
Scott Ferguson, Lahontan Water Board (SLT)
Mary Dellavalle, Lahontan Water Board (VVL)
Don Baker, San Bernardino County Building and Safety
(via email, dbaker@lusd.sbcounty.gov)

JZ\rc\U:\NOV Letters\NNC_Serenity_LA.docx

California Environmental Protection Agency

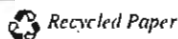

EXHIBIT NO. 4

Jan Zimmerman - Meadowbrook Road

From: Jan Zimmerman
To: mollabolla@yahoo.com
Date: 1/27/2012 4:42 PM
Subject: Meadowbrook Road
CC: Brandt, Jeff; Copeland, Patrice; Pankratz, Shannon L SPL; bryant2662@...

Mr. Moller,

Today I reinspected your property at 1031 Meadowbrook Road, Crest Park. The intent of the inspection was to document the condition of the site and to determine compliance with our verbal order of 01/20/2012 to install an effective combination of sediment and erosion control best management practices (BMPs) to stabilize the disturbed areas. On 01/20/2012, I specifically requested that BMPs be placed at the inlet and outlet of the newly installed culvert, particularly sediment and erosion control BMPs on the slope opposite the point of discharge from the pipe culvert. At the time of my inspection, the only BMPs observed onsite were staked straw waddles along the southern portion of the site. No BMPs were observed at the inlet and no controls were observed at the outlet. The current condition of this site poses a significant threat to water quality and measures must be taken immediately to stabilize the exposed soils and to prevent unauthorized discharge to waters of the State. We request that you implement an effective combination of erosion and sediment control BMPs to stabilize the entire site by February 3, 2012, or within 24 hours of a forecasted rain event, whichever comes first. Please notify this office via email when BMP installation is complete. Please include a photographic log with your notification to document the implementation.

If you have any questions, please do not hesitate to contact me.

Jan M. Zimmerman, PG
Engineering Geologist
Lahontan Regional Water Quality Control Board

Phone: 760/241-7376
Fax: 760/241-7308
jzimmerman@waterboards.ca.gov

EXHIBIT NO. 5

Randall Morlan - Meadowbrook Road, Crest Park - Inspection 02/06/2012

From: Jan Zimmerman
To: mollabolla@yahoo.com
Date: 2/6/2012 5:29 PM
Subject: Meadowbrook Road, Crest Park - Inspection 02/06/2012
CC: Brandt, Jeff; Copeland, Patrice; Don - LUS Baker; Pankratz, Shannon L...
Attachments: Notice of Non-Comp with Cal. Water Code, 1031 Meadow Brook Road 11-21-2011.pdf

Mr. Moller,

I met with Bryant Bergeson at your site on Meadowbrook Road in Crest Park. The best management practices (BMPs) in place were inadequate to protect the inlet and outlet of the culvert and the straw waddle onsite was improperly installed and inadequate to stabilize the remainder of the disturbed areas on the site. The following compliance items were clearly discussed with Mr Bergeson.

1. Culvert outlet: inadequate BMPs; need to pull back debris and soil from the top of slope and install a combination of BMPs to keep sediment in place; rooted vegetation will remain in-place, only uprooted vegetation will be removed. Needs to be done today, 02/06/2012.
2. Culvert inlet: inadequate BMPs; need to add another layer of hay bales or layer other BMP to keep sediment from falling into the creek. Needs to be done today, 02/06/2012.
3. Cut slope on southern perimeter of the site: straw waddle is inadequate BMP to stabilize the sediment that can slough from the exposed cut; a combination of BMPs is needed to stabilize the exposed slopes and to prevent concentrating flows.
4. South drainage with stockpiled debris: the debris needs to be removed to restore flows; remove hay bales at outlet of drainage and allow flows to dissipate onto the site. Consider placing a series of straw waddles or gravel bags to dissipate flows across the site.
5. Active construction site: repair silt fencing and install properly (stapled on upstream side).
6. Stabilize entire site using a combination of BMPs to dissipate flows across the site; may want to consider a temporary basin to detain flows and desilt.
7. The project is greater than 1 acre, start the Notice of Intent process now and begin developing a Stormwater Pollution Prevention Plan (SWPPP). The SWPPP must identify the temporary BMPs to stabilize the site during construction as well as permanent BMPs to manage stormwater post-construction.
8. Restoring the creek channel to pre-construction condition would not require a 401 permit; however any deviation from restoring the creek to original condition would require a 401 permit and a review under the California Environmental Quality Act.
9. Water Board staff may re-inspect the site tomorrow (02/07/2012) during rain specifically to observe the site and to take water samples from the inlet and outlet of the culvert.

Items 1 and 2 need to be done immediately (02/06/2012). Items number 3-7 need to be done or in progress by 02/08/2012. Please keep in mind that in order for BMPs to be effective, they must be installed properly. Generally, a combination of BMPs is more effective than a single type of BMP, especially for a large, complex site such as this one. Attached is another copy of our original Notice of Non-Compliance from November 2011. Mr. Bergeson stated that he did not have a copy of that correspondence.

Please respond to this email and let me know if you understand the above directives.

As always, should you have any questions, please do not hesitate to contact me.

Thank you.

Jan M. Zimmerman, PG
 Engineering Geologist

EXHIBIT NO. 6

Jan Zimmerman - Serenity-Crest Park Inspection 03/16/2012

From: Jan Zimmerman
To: mollabolla@yahoo.com
Date: 3/16/2012 1:09 PM
Subject: Serenity-Crest Park Inspection 03/16/2012
CC: Brandt, Jeff; Copeland, Patrice; Plaziak, Mike; bryant2662@yahoo.com; dbaker@lUSD.sbcounty.gov; jgibson@dfg.ca.gov

Mr. Moller,

I inspected your Crest Park site this morning and met with the site manager Bobby Rabun. I noted new construction on the western portion of the site adjacent to the creek (pipe culvert) and the spring that had been diverted. The footings had been dug for the foundation but no concrete had been poured. This construction appears to be within 30-feet of the headwall of the new pipe culvert. Has this work been authorized by the County? Today, I walked the site with Mr. Rabun and pointed out to him the areas that need BMP maintenance or placement of additional BMPs to stabilize the disturbed soils on the site. It is imperative that the BMPs be installed and maintained in light of the forecasted storm for this weekend.

1. There is still stockpiled soil along the top of the slope at the outlet of the culvert pipe. This soil will need to be removed eventually, but in the interim I recommend that plastic sheeting be placed and staked along the banks to keep the sediment and debris from being washed into the channel. Straw waddle or silt fencing should be placed at the top of as a second line of defense to prevent erosion of the channel banks. **This area needs to be your number 1 priority.**
2. Straw waddle needs to be staked and the ends need to overlap to provide coverage and be effective (it also needs to be trenched in, but I forgot to tell Mr. Rabun so I am letting you know now). Along the southern portion of the site the majority of the straw waddle is crushed and needs to be replaced and the ends do not overlap. Most if not all of the straw waddle on the southern end of the site needs to be reset or replaced and then restaked.
3. Silt fencing needs to be tacked on the up-slope side of the stake and the bottom of the fence needs to be trenched in to provide a sediment "catch" and be effective. Most of the silt fencing on site is tacked on the downslope side of the stake and is not trenched in. There are many areas along the southern boundary of the site where the bottom of the fence is hanging above the ground in excess of 10-12 inches and therefore is not acting as an effective BMP. The silt fencing will need to be reinstalled correctly.
4. The placement of the straw waddle across the top of the graded pad in the main part of the meadow area is good. Additional rows of straw waddle should be placed (arcuate-shaped pointing downslope) to capture and slow the flows as they move from west to east across the site.
5. Concentrated flows should be discouraged through the use of waddle, sand bags, hay bales, etc.

Please let me know if you have any questions regarding my recommendations above. Please keep us posted on the intensity of the storm at your site and whether or not the BMPs have failed or are still functioning.

Thank you.

Jan M. Zimmerman, PG

EXHIBIT NO. 7

Jan Zimmerman - Serenity, Crest Park - BMPs (April 10, 2012)

From: Jan Zimmerman
To: mollabolla@yahoo.com
Date: 4/10/2012 11:39 AM
Subject: Serenity, Crest Park - BMPs (April 10, 2012)
CC: Brandt, Jeff; Copeland, Patrice; Drabandt, Laura; Ferguson, Scott; Plaziak, Mike; bryant2662@yahoo.com; dbaker@lusd.sbcounty.gov; jgibson@dfg.ca.gov
Attachments: CrestPark_NOAA weather forecast.pdf

Mr. Moller,

Per our Cleanup and Abatement Order dated March 14, 2012, you were required to obtain coverage under the Statewide General Permit for Construction Stormwater forthwith, and implement a site-specific Stormwater Pollution Prevention Plan (SWPPP) no later than April 13, 2012. As of today, the coverage under the Statewide General Permit for Construction Stormwater has not been granted for this site. I am aware, however, that a Notice of Intent was initiated on April 9, 2012, for "Serentiy Lodge, 1031 A Meadowbrook Road, Crest Park" under the owner name Nevada Irrigation District. Please explain why the owner information is listed as an entity other than Arimol Group.

Rain is forecasted for tonight with a mix of rain and snow forecasted for the remainder of the week (through Saturday). Please see the attached weather forecast. It is imperative that an appropriate mix of sediment and erosion control BMPs be installed and maintained in light of these forecasted storms. Our recommendations outlined below are based upon our observations during our last site inspection on April 2, 2012. We urge you to consult with a qualified SWPPP developer (QSD) to guide you in the selection and proper installation of appropriate BMPs for your site.

1. At the eastern side of your site, the plastic sheeting placed along the streambanks at the outfall of the pipe culvert is in need of maintenance. We suggest that you use gravel bags to hold the sheeting in place in lieu of boulders and cobbles, which may tear or rip the plastic. Straw waddle or silt fencing should be placed at the top of slope to act as a second line of defense to prevent erosion of the channel banks and discharge of sediment into the streambed. Previously placed straw waddle should be replaced and/or restaked so that sheet flows across the site are not funneled through a single point of discharge. **This area needs to be your number 1 priority.**
2. Straw waddle needs to be trenched in, staked, and the ends overlapped to provide coverage and be effective. Along the southern portion of the site the majority of the straw waddle is crushed and needs to be replaced and the ends do not overlap. Most if not all of the straw waddle on the southern end of the site needs to be reset or replaced and then restaked.
3. The placement of the straw waddle across the top of the graded pad in the main part of the meadow area is good for the most part. However, there were some areas where the waddle ends do not overlap. Please ensure that the waddle is placed properly, as outlined in no. 2 above. Additional rows of straw waddle should be placed (arcuate-shaped pointing down gradient) to capture and slow the flows as they move from west to east across the site.
4. Concentrated flows should be discouraged through the use of waddle, gravel bags, hay bales, etc.

Please let me know if you have any questions regarding our recommendations above. Please keep us posted on the intensity of the storm events at your site and whether or not the BMPs functioned properly during the storm (s) and what maintenance or additional BMPs may be needed in anticipation of future storm events.

EXHIBIT NO. 8

COPY

AS 00011166	1/18
RECEIVED	APR 19 2012
FILE	

RECEIVED
APR 23 2012
By [Signature]

April 13, 2012

Ms. Lauri Kemper
 Assistant Executive Officer
 California Regional Quality Control Board – Lahontan Region
 14440 Civic Drive, Suite 200
 Victorville, CA 92392

RE: CLEANUP AND ABATEMENT ORDER NO. R6V-2012-0008

Ms. Kemper:

Per the above order, Arimol Group, Inc. has retained Montgomery & Associates, Inc. to develop a Storm Water Pollution Prevention Plan (SWPPP) and obtain coverage under the Construction General Permit via SMARTS today. Montgomery & Associates, Inc. were on site for a field visit on Tuesday, April 10, 2012, and assure us the SWPPP will be uploaded in SMARTS today and the NDI will be processed at the State Water Resources Control Board later today.

Montgomery & Associates, Inc. has also been retained as the QSD/QSP for compliance activities, including inspections, REAPs, sampling, annual reporting, etc. Montgomery & Associates, Inc. will be on site on Thursday, April 19, 2012 to review the SWPPP implementation and forward the technical report to you by April 20, 2012 per the above Order.

I do wish to note that I still do not agree with the determination that this is "common development". The permits are issued separately and there are different ownerships of some parcels. Should it be determined coverage was not necessary for some, or all, of these projects, I intend to terminate coverage at that time. It is my opinion that the disturbance is less than one acre.

These actions outlined above suffice Order items 1-4.

We have Montgomery & Associates, Inc. selecting a sub-consultant to handle items 5-9, and we request a meeting or conference call next week to discuss a reasonable schedule to understand and complete these tasks. Please contact me directly to schedule the meeting or conference call.

Thank you for your attention to this matter.

Sincerely,

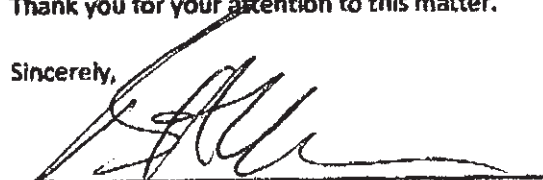

Bill Moller, President
 Arimol Group, Inc.

Enforcement File: Serenity Lodge (Arimol Group)

EXHIBIT NO. 9



State Water Resources Control Board

NOTICE OF INTENT

GENERAL PERMIT TO DISCHARGE STORM WATER
ASSOCIATED WITH CONSTRUCTION ACTIVITY
(WQ ORDER No. 2009-0009-DWQ)



WDID: 6B36C363433

Risk Level: Level2

Property Owner Information

Name: Arimol Group Inc
Address: PO Box 44
Address 2:
City/State/Zip: Torrance CA 90507

Type: Private Business
Contact Name: Gerald Montgomery
Title:
Phone #: 916-476-4903
Email: gerald@montgomery-assoc.com

Contractor/Developer Information

Name: Arimol Group Inc
Address: PO Box 44
Address 2:
City/State/Zip: Torrance CA 90507

Contact Name: Gerald Montgomery
Title:
Phone #: 916-476-4903
Email: gerald@montgomery-assoc.com

Construction Site Information

Site Name: 1031 A Meadowbrook Road
Address: 1031 A Meadowbrook Road
City/State/Zip: Crest Park CA 92326
County: San Bernardino
Latitude: 34.23428 Longitude: -117.20346

Contact Name: Gerald Montgomery
Title:
Site Phone #: 916-476-4903
Email: gerald@montgomery-assoc.com

Total Size of Construction Area: 2.4
Total Area to be Disturbed: 0.3

Construction Start: October 01, 2011
Complete Grading:
Final Stabilization: September 30, 2012

Risk Values

R: 98.4 K: 0.24 LS: 7.39 Beneficial Uses/303(d): No

Type of Construction: *Residential

Receiving Water:

Qualified SWPPP Developer: Gerald Montgomery

Certification #: 00051

RWQCB Jurisdiction: Region 6B - Victorville

Phone: 760-241-6583

Email: r6b_stormwater@waterboards.ca.gov

Certification

Name Bill Moller

Date: April 13, 2012

Title: Legally Responsible Person

EXHIBIT NO. 10

Jan Zimmerman - Serenity Inspection - April 20, 2012

From: Jan Zimmerman
To: Bill Moller
Date: 4/20/2012 5:11 PM
Subject: Serenity Inspection - April 20, 2012
CC: Brandt, Jeff; Copeland, Patrice; Don - LUS Baker; Gerald Montgomery; Pankratz, Shannon L SPL; Plaziak, Mike; jgibson@dfg.ca.gov

Mr. Moller,

As we discussed during my inspection today, you have agreed to address the following and provide photo documentation of the corrections by April 23, 2012.

1. At the culvert outlet the debris and soil should be pulled back from the top of slope and a combination of BMPs installed to keep sediment in place. The plastic sheeting that is there now is "ok," but the rock boulders holding the sheeting in place should be replaced with gravel bags. Once the soil and debris is removed, other slope protection, such as jute matting or erosion control blankets would be effective and allow for infiltration.
2. Concentrated flows in the eastern portion of the site need to be mitigated. Staff recommended a series of straw waddles and/or gravel bags, placed like check dams, to disperse flows, slow runoff velocities, and filter sediment.
3. Straw waddle BMPs, particularly in the southern portion of the site, are in need of maintenance. The flattened waddles need to be replaced, and the unstaked waddles need to be trenched-in, staked, and overlapped at both ends.
4. Secondary containment, such as straw waddle or gravel bags, should be provided for the debris stockpile in the western portion of the site. Adequate secondary containment should be provided for the portable toilet.

In addition, I spoke with Mike Plaziak regarding your request to remove the stockpiled soil from the top of the slope along the stream channel in the eastern portion of the site. Mr. Plaziak authorizes the removal of this soil and debris so long as the removal proceeds without any additional impact or discharge of sediment to the stream channel. No equipment other than hand tools must be allowed to enter the channel and no sediment or debris must be allowed to fall back or into the channel. This material may be reused onsite or hauled offsite. Any stockpiled materials must be secured with appropriate sediment and erosion control BMPs.

If you have any questions, please do not hesitate to contact me.

Thank you.

Jan M. Zimmerman, PG
Engineering Geologist
Lahontan Regional Water Quality Control Board

Phone: 760/241-7376
Fax: 760/241-7308
jzimmerman@waterboards.ca.gov

EXHIBIT NO. 11

Jan Zimmerman - Arimol Group, Crest Park - Water Board Inspection 06/07/2012

From: Jan Zimmerman
To: mollabolla@yahoo.com; mollacorp@aol.com
Date: 6/11/2012 5:06 PM
Subject: Arimol Group, Crest Park - Water Board Inspection 06/07/2012
CC: Brandt, Jeff; Copeland, Breeanna; Copeland, Patrice; Pankratz, Shannon L SPL; Plaziak, Mike; dbaker@lUSD.sbcounty.gov; jgibson@dfg.ca.gov

Mr. Moller,

This email is a summary of the items discussed with Mr. Gomes during our inspection of your site in Crest Park on 06/07/2012.

1. Straw waddle and silt fencing BMPs were observed to be in need of maintenance. Perform BMP inspections and provide maintenance, as outlined in the SWPPP.
2. The portable toilet did not have adequate secondary containment. Install adequate containment per specifications in the SWPPP.
3. Hydraulic oils and asphalt emulsion stored on the southern portion of the site were observed to be partially used and stored directly on the soil. No secondary containment was observed. Hazardous materials need to be provided adequate containment per the specifications outlined in the SWPPP.
4. The plastic sheeting used as slope protection in the eastern portion of the site is showing signs of deterioration. The sheeting should be replaced with some other materials (i.e. jute matting) before the plastic is deteriorated to the point that it becomes a nuisance. Your QSD should be able to provide you with acceptable alternatives.
5. Debris on the site should be centralized and containment BMPs provided until such time that the waste can be hauled offsite.
6. A copy of the SWPPP was available onsite. The SWPPP contained copies of inspection reports. We would like you to also include with the SWPPP documentation or copies of SWPPP training records (sign in sheets would be acceptable). It is important that site personnel be trained in SWPPP procedures.
7. A copy of our Cleanup and Abatement Order should be kept onsite and made available to Water Board staff for review.
8. The corrugated metal pipe at the point of discharge for the south spring, which is located at the end of the asphalt driveway on the west side of the site, appears to have been replaced with white plastic pipe and moved to a point further downgradient from the original point of discharge. The replacement of this pipe and moving of the point of discharge is a new impact that was not authorized by the Water Board.

Items 1, 2, and 3 need to be addressed immediately. Please provide an explanation for the apparent new impacts to the spring as described in item 8 by June 15, 2012.

This email will be followed by written notification of the items listed above. If you have any questions, please do not hesitate to contact me.

Thank you.

Jan M. Zimmerman, PG
Engineering Geologist
Lahontan Regional Board

Phone: 760/241-7376
Fax: 760/241-7308
jzimmerman@waterboards.ca.gov

EXHIBIT NO. 12

Jan Zimmerman - Re: Arimol Group, Crest Park - Water Board Inspection 06/07/2012

From: Mollacorp <mollacorp@aol.com>
To: Jan Zimmerman <JZimmerman@waterboards.ca.gov>, Jorge Beltran <jorge@montgomery-
assoc.com>
Date: 6/14/2012 11:58 AM
Subject: Re: Arimol Group, Crest Park - Water Board Inspection 06/07/2012

Ms Zimmerman

We completed items 1-2-3 on your list on Tuesday. As to number 8 we did a repair with 4 inch pipe when a truck backed over the old 12 corrugated rusted pipe. I ordered a new piece of 12 inch corrugated 8 ft long when it is delivered and we install I will take a picture and send to you. Thx. Bill

On Jun 11, 2012, at 5:06 PM, Jan Zimmerman <JZimmerman@waterboards.ca.gov> wrote:

Mr. Moller,

This email is a summary of the items discussed with Mr. Gomes during our inspection of your site in Crest Park on 06/07/2012.

1. Straw waddle and silt fencing BMPs were observed to be in need of maintenance. Perform BMP inspections and provide maintenance, as outlined in the SWPPP.
2. The portable toilet did not have adequate secondary containment. Install adequate containment per specifications in the SWPPP.
3. Hydraulic oils and asphalt emulsion stored on the southern portion of the site were observed to be partially used and stored directly on the soil. No secondary containment was observed. Hazardous materials need to be provided adequate containment per the specifications outlined in the SWPPP.
4. The plastic sheeting used as slope protection in the eastern portion of the site is showing signs of deterioration. The sheeting should be replaced with some other materials (i.e. jute matting) before the plastic is deteriorated to the point that it becomes a nuisance. Your QSD should be able to provide you with acceptable alternatives.
5. Debris on the site should be centralized and containment BMPs provided until such time that the waste can be hauled offsite.
6. A copy of the SWPPP was available onsite. The SWPPP contained copies of inspection reports. We would like you to also include with the SWPPP documentation or copies of SWPPP training records (sign in sheets would be acceptable). It is important that site personnel be trained in SWPPP procedures.
7. A copy of our Cleanup and Abatement Order should be kept onsite and made available to Water Board staff for review.
8. The corrugated metal pipe at the point of discharge for the south spring, which is located at the end of the asphalt driveway on the west side of the site, appears to have been replaced with white plastic pipe and moved to a point further downgradient from the original point of discharge. The replacement of this pipe and moving of the point of discharge is a new impact that was not authorized by the Water Board.

Items 1, 2, and 3 need to be addressed immediately. Please provide an explanation for the apparent new impacts to the spring as described in item 8 by June 15, 2012.

This email will be followed by written notification of the items listed above. If you have any questions, please do not hesitate to contact me.

Thank you.

Jan M. Zimmerman, PG
Engineering Geologist
Lahontan Regional Board

Phone: 760/241-7376
Fax: 760/241-7308
jzimmerman@waterboards.ca.gov

EXHIBIT NO. 13



Lahontan Regional Water Quality Control Board

June 20, 2012

WDID No. 6B36C363433

Arimol Group, Inc.
P.O. Box 44
Torrance, CA 90507

Certified Mail: 7009 0820 0001 6638 9267

Bill Moller, President
Arimol Group, Inc.
4173 Maritime Road
Rancho Palos Verdes, CA 90275

Certified Mail: 7009 0820 0001 6638 9274

NOTICE OF VIOLATION OF CLEANUP AND ABATEMENT ORDER NO. R6V-2012-0008, ARIMOL GROUP, INC., LAKE ARROWHEAD, SAN BERNARDINO COUNTY

The California Regional Water Quality Control Board, Lahontan Region (Water Board) issued Cleanup and Abatement Order (CAO) No. R6V-2012-0008 to Arimol Group, Inc. (Discharger) on March 15, 2012. The CAO requires the Discharger to clean up and abate the discharge and threatened discharge of waste earthen materials to surface waters of the Mojave Hydrologic Unit from the development site located at the northeast corner of Meadowbrook Road and Cedar Court in Lake Arrowhead (Site). The CAO also requires the Discharger to submit technical reports addressing past and proposed site development and associated environmental impacts, and restoration plans for surface waters that have been affected by recent (since 2011 property acquisition) development activities. Water Board staff has determined that the Discharger is failing to comply with multiple CAO requirements. This Notice of Violation is being issued to identify the CAO requirements the Discharger has, and in some situations, continues to violate, as described below.

VIOLATIONS

1. **Violation of Order D.1** – The Discharger failed to “forthwith” (immediately) submit a Notice of Intent (NOI) for coverage under the Statewide General Permit for Discharges of Storm Water Associated with Construction Activity, Order No. 2009-0009-DWQ (Construction General Permit). The Discharger submitted the NOI on April 13, 2012, 29 days following the issuance of the CAO.
2. **Violation of Order D.2** – The Discharger failed to submit a fully **signed** copy of its April 13, 2012 site-specific Storm Water Pollution Prevention Plan (SWPPP). The SWPPP submitted to the Water Board did not include the name, title, or contact information for, or signature of, the Legally Responsible Person (SWPPP section 100.2, page 5). This is an ongoing violation that has yet to be addressed.

3. **Violation of Order D.3** – The Discharger failed to completely implement the site-specific SWPPP by April 13, 2012, as documented in the Discharger's SWPPP implementation report submitted to the Water Board on April 20, 2012. The Discharger's SWPPP implementation report identifies best management practices (BMPs) that had yet to be installed/constructed (e.g., secondary containment for the portable toilet and perimeter controls for debris stockpiles), and that were incorrectly installed/constructed (e.g., straw waddles and siltation fences). Failure to completely implement all SWPPP elements by April 13, 2012 is a violation of Order D.3. The site conditions described in the Discharger's SWPPP implementation report also constitute a failure to implement and maintain an effective combination of erosion and sediment control BMPs in violation of the Construction General Permit.

4. **Violation of Order D.5** – The Discharger's representative submitted a second technical report to the Water Board on April 20, 2012. The purpose of this technical report (development impacts report) is to provide a site development plan that describes, illustrates, and quantifies past (since property acquisition in 2011) and proposed site development and its associated land and surface water impacts. The CAO provides significant detail related to the minimum content requirements for this technical report. The Discharger's development impacts report does not satisfy the minimum content requirements identified by the CAO. The Discharger is therefore, in violation of Order D.5.

For surface waters, the report only identifies the creek section that has been placed in a 30-inch diameter culvert. The report fails to identify the location and extent of all surface waters that, at a minimum, include:

- the creek that has been placed in the 30-inch diameter culvert;
- existing springs (e.g. two springs on the western portion of the Site that have been diverted);
- the natural drainage channel located on the Site's eastern perimeter;
- and the "wet meadow" and "willow" habitats associated with the creek that has been placed in the 30-inch diameter culvert and are discussed in the Discharger's restoration plan.

The report also fails to identify a building structure that is currently under construction at the Site, and also fails to describe access and parking facilities (e.g., roads, walking paths, parking areas) to and throughout the Site. There is no discussion/description of past disturbance or of future development and its impacts. Additionally, the 11" x 17" site plan is largely illegible due to the extent of reduction, making it unacceptable.

5. **Violation of Order D.6** – The Discharger’s representative submitted to the Water Board a report titled “Streambed Restoration Plan for Effected Waters of the US on the 1031 Meadowbrook Road Project.” on April 26, 2012. The purpose of this report as identified in significant detail by the CAO is to provide a restoration plan that describes and illustrates:
- how the creek that has been placed in the 30-inch diameter culvert will be restored to pre-project conditions;
 - how two existing springs located on the western portion of the Site will be restored to pre-project conditions; and
 - how the natural drainage channel on the Site’s eastern perimeter will be restored to pre-project conditions.

The Discharger’s April 26, 2012 restoration plan simply discusses the Discharger’s intent to keep the 30-inch diameter culvert and associated concrete headwall in place and creating creek habitat adjacent to the section of creek that has been placed in the culvert. Additionally, disturbed areas adjacent to this creek would be hydroseeded and/or planted with willows. This proposal does not meet the CAO requirements to restore the creek to pre-project conditions.

The report also incorrectly states that the two springs were simply placed in new culverts on the same alignments as the culverts that were replaced. Water Board staff disputes this claim and asserts that the new culverts were installed on new alignments. The new culvert alignments are now drying out (eliminating) the riparian and wetland (surface water) habitat that the springs had been supporting prior to installing the new culverts. Lastly, the report contains no discussion regarding restoration of the natural drainage channel on the Site’s eastern perimeter.

NEXT STEPS

The violations identified above are subject to additional enforcement action, including the Water Board assessing administrative civil liabilities. Water Board staff will be issuing an Administrative Civil Liability Complaint (Complaint) for these and other violations associated with Arimol Group, Inc.’s 1031-A Meadowbrook Road project. Water Board staff anticipates issuing the Complaint in mid-August 2012, and scheduling a public hearing at the Water Board’s November 2012 meeting. I strongly encourage Arimol Group, Inc. to take the actions described below, as soon as possible.

1. Submit to the Water Board’s Victorville office a copy of the site-specific SWPPP with all required signatures and associated information for the signatories.
2. Fully implement all site-specific SWPPP elements.
3. Submit to the Water Board’s Victorville office a technical report documenting all SWPPP-implementation/maintenance activities have been completed in an attempt

to fully implement the site-specific SWPPP. The technical report shall include a narrative description of, an implementation schedule for, photo-documentation of, and a legible site plan illustrating the location and extent of such activities. The technical report must be signed by the Discharger or authorized representative.

4. Submit to the Water Board's Victorville office a technical report that fully addresses the report deficiencies cited in Violation No. 4. above, and fully satisfies the minimum content requirements of the report as described in detail by CAO Order D.5. The technical report must be signed by the Discharger or authorized representative.
5. Submit to the Water Board's Victorville office a technical report for the Executive Officer's approval that provides a Surface Water Restoration Plan that fully addresses the report deficiencies cited in Violation No. 5, above, and fully satisfies the plan requirements as described in detail by CAO Order D.6. Order D.6, in part, clearly states that the Surface Water Restoration Plan is to include a plan for removing the 30-inch diameter culvert and associated concrete headwall and restoring the affected creek section to its natural hydrologic conditions. The technical report must be signed by the Discharger or authorized representative.

As stated above, Water Board staff will be issuing an Administrative Civil Liability Complaint near mid-August 2012. The violations, as described herein, are subject to administrative civil liability pursuant to California Water Code (CWC) sections 13268, 13350, or 13385, and/or referral to the Attorney General of the State of California for such legal action as she may deem appropriate. The violations cited above are subject to liabilities of up to \$1,000, \$5,000, and \$10,000 per violation for each day of violation, depending upon the CAO Order, permit requirement, or state and/or federal law/regulation being violated by Arimol Group, Inc.'s actions or failures to act.

Water Board staff is continuing to evaluate Arimol Group, Inc.'s response to Cleanup and Abatement Order No. R6V-2012-0008 and other enforcement actions issued by Water Board staff. The potential liability the Water Board is authorized to assess against Arimol Group, Inc. continues to increase with each day of non-compliance.

If you have questions, please contact Mike Plaziak at (760) 241-6583 (mplaziak@waterboards.ca.gov). You may also contact Patrice Copeland, Senior Engineering Geologist, at (760) 241-7404 (pcopeland@waterboards.ca.gov), or Jan Zimmerman, Engineering Geologist, at (760) 241-7376 (jjimmeman@waterboards.ca.gov).

Lauri Kemper
Assistant Executive Officer

Enclosure: Cleanup and Abatement Order No. R6V-2012-0008

cc: Mail List

EXHIBIT NO. 14

Zimmerman, Jan@Waterboards

From: Zimmerman, Jan@Waterboards
Sent: Monday, August 20, 2012 5:06 PM
To: Gerald Montgomery
Cc: Copeland, Patrice@Waterboards; Bill Moller <mollacorp@aol.com>
(mollacorp@aol.com)
Subject: RE: Checking in on Arimol

Jerry,

I did inspect the site on August 9th. We do recommend that Mr. Moller remove the plastic sheeting in the eastern portion of the site so that the area can revegetate under the current favorable conditions. Vegetation growth is high across the site and removing the plastic would be a benefit. Jute matting or some other temporary BMP would need to be used until the vegetation established sufficient coverage. Hydraulic oils and other potentially hazardous materials continue to be stored on the ground without adequate secondary containment. These materials need to be provided adequate secondary containment per the specifications outlined in the SWPPP. Deteriorated straw bales at the inlet and outlet of the pipe culvert need to be removed or replaced. The sediment and erosion control plan should be reviewed and revised, as necessary, based on current site conditions (i.e. high vegetation growth, construction needs, etc.). The SWPPP contained some inspection reports, the most current being dated July 18, 2012, weeks between July 18th and August 9th were missing. In addition, there were no training records for site personnel or subcontractors regarding stormwater training, spill response, BMPs, etc. The SWPPP needs to be current and include copies of training records for site stormwater personnel.

Will your staff be there next week, or is the plan to be onsite on the 31st? Was there measurable rain this past Friday at the site? Other areas in the San Bernardino Mountains experienced flash flooding and debris flows.

If you have any questions, please let me know. Thanks.

Jan M. Zimmerman, PG
Engineering Geologist
Lahontan Regional Water Quality Control Board

Ph: 760/241-7376
Fx: 760/241-7308
<http://www.waterboards.ca.gov/lahontan/>

-----Original Message-----

From: Gerald Montgomery [mailto:gerald@montgomery-assoc.com]
Sent: Wednesday, August 15, 2012 8:06 AM
To: Zimmerman, Jan@Waterboards
Subject: Checking in on Arimol

Hey Jan,

I understand you were at the site last week. I was wondering your impressions and if you need anything from us? I'm sending my senior staffer down there next week again as we get closer to bad weather to make sure they are on top of it with supplies and such.

Thanks, and have a great rest of the week.

Jerry

Sent from my iPhone

Confidentiality Notice: The information in this transmission (including any attachments) is intended only for the person or entity to which it is addressed and may contain confidential and/or privileged material. If you are not the intended recipient, any review, retransmission, dissemination or other use of, or taking any action in reliance upon this information is prohibited. The user of this information is NOT authorized to copy, attach, transmit, or include this information in any bid or proposal without the authors explicit authorization. If you have received this in error, please contact Montgomery & Associates, Inc. at 916-476-4903 and destroy all copies of the original message.

EXHIBIT NO. 15

Zimmerman, Jan@Waterboards

From: Zimmerman, Jan@Waterboards
Sent: Thursday, August 23, 2012 9:02 AM
To: Bill Moller <mollacorp@aol.com> (mollacorp@aol.com)
Cc: Copeland, Patrice@Waterboards; jgibson@dfg.ca.gov; Scoralle, Lisa@Waterboards; Shannon.L.Pankratz@usace.army.mil; Gerald Montgomery (gerald@montgomery-assoc.com)
Subject: FW: Jute 2
Attachments: photo.JPG

Bill,

Thank you for the photograph showing that the plastic has been removed from the channel side slopes on the eastern portion of the site. Please ensure that the jute mat BMP is installed properly, i.e. rolled from the top, trenched in (anchored at the top), and tacked per industry standard specifications. Those specifications are found online at <http://www.cabmphandbooks.com/Documents/Construction/EC-7.pdf> as well as in Section O of your Stormwater Pollution Prevention Control Plan. Your QSD/QSP should advise you on installation.

Thank you.

Jan M. Zimmerman, PG
Engineering Geologist
Lahontan Regional Water Quality Control Board

Ph: 760/241-7376
Fx: 760/241-7308
<http://www.waterboards.ca.gov/lahontan/>

-----Original Message-----

From: Bill Moller [<mailto:mollacorp@aol.com>]
Sent: Thursday, August 23, 2012 8:16 AM
To: Zimmerman, Jan@Waterboards
Subject: Jute 2

Both sides complete

EXHIBIT NO. 16



Lahontan Regional Water Quality Control Board

October 19, 2012

WDID 6B36C363433

Arimol Group, Inc.
P.O. Box 44
Torrance, CA 90507

Bill Moller, President
Arimol Group, Inc.
4173 Maritime Road
Rancho Palos Verdes, CA 90275

COMMENTS ON REVISED GRADING PLAN SUBMITTAL AND NOTICE OF CONTINUED VIOLATION OF CLEANUP AND ABATEMENT ORDER R6V-2012-0008, ARIMOL GROUP, INC., LAKE ARROWHEAD, SAN BERNARDINO COUNTY

The California Regional Water Quality Control Board, Lahontan Region (Water Board) received revised Grading Plans from Arimol Group, Inc. (Arimol) on September 28, 2012, as related to the development site located at the northeast corner of Meadowbrook Road and Cedar Court in Lake Arrowhead (Site). The revised Grading Plans were submitted in response to Cleanup and Abatement Order R6V-2012-0008 (CAO) and our letter dated August 29, 2012, which authorized partial implementation of the Surface Water Restoration Plan. Water Board staff has reviewed the revised Grading Plan submittal and has determined the plan sheets are inconsistent with respect to existing and proposed development on the Site and with our prior comments on the Surface Water Restoration Plan. It is imperative that you address our comments and concerns outlined below. This letter also serves as notice that the requirements of the CAO continue to be violated until such time that Arimol provides sufficient information to fully comply with the outstanding requirements of Orders D.5 and D.6 of the CAO.

COMMENTS ON REVISED GRADING PLAN SUBMITTAL

Arimol submitted four revised Grading Plan sheets to Water Board staff for review on September 28, 2012: Site Plan, sheet C-1; Streambed Grading Plan, sheet C-2; Flood Control Grading Plan, sheet C-3; and Grading Plan, sheet C-4. Water Board staff has determined the plan sheets are inconsistent with respect to prior plans submitted, inconsistent with existing and proposed development on the Site, and inconsistent with our prior comments on the Surface Water Restoration Plan. Our comments and concerns are outlined below.

1. Proposed structures are shown on sheet C-4, Grading Plan. Water Board staff in no way is authorizing any future building locations, grading, or development on the Site, other than restoring the culverted stream channel as previously authorized in our letter dated August 29, 2012. Future development of the Site may require Arimol to comply with additional requirements of the California Environmental Quality Act, the Porter-Cologne Water Quality Control Act, and the Federal Clean Water Act.

The topography shown on sheet C-1, Site Plan, is significantly different from the topography shown on all previous plans and drawings submitted to the Water Board. The Surveyor's Statement, listed in the lower right hand corner of sheet C-1, states that the topography shown was accurate as of September 2011, and represents the historic topographic contour of the Site prior to commencing ground disturbance activities in October 2011. Please explain the inconsistency in plan topography between this sheet and other plan sheets previously submitted to the Water Board, and verify whether or not the topographic survey as shown on this plan sheet accurately depicts the historical topography of the site in September 2011.

2. A comparison between sheet C-2, Streambed Grading Plan, and sheet C-1, Site Plan, indicates that significant grading has occurred in the eastern portion of the Site since September 2011. This is inconsistent with what Arimol reported to Water Board staff in prior submittals dated October 2011 and in December 2011. Please provide a detailed account of the grading activities that have occurred on the Site since Arimol acquired the property. Please provide the correct date of the topographic survey as shown on sheets C-2, C-3, and C-4.
3. The plan sheets are inconsistent with respect to proposed and existing development. Proposed structures are shown on the Grading Plan (sheet C-4), yet several existing structures (i.e. 977 and 995 Meadowbrook Road) are not shown on any of the other plan sheets. The plan sheets must clearly identify historical, existing, and proposed structures and grades. The plan sheets need to be consistent with each other and consistent with the existing and proposed development on the Site.
4. The plan sheets fail to identify all walking paths, access roads, parking areas, concrete patios, driveways, to and throughout the Site, and other impervious or disturbed areas as a result of existing or planned Site development. The plan sheets must account for all proposed and existing development on the Site.

REQUIRED INFORMATION

The information provided to date does not fully comply with the requirements of CAO Orders D.5 and D.6. Until Arimol provides sufficient information to fully comply with the requirements of Orders D.5 and D.6 of the CAO, no additional restoration activities, other than those specified in our letter dated August 29, 2012, are authorized.

Order D.5 – CAO Order D.5 requires Arimol to fully identify all pre-development (historical) surface water features on the Site and to quantify impacts to those features from both existing and planned development of the Site. Arimol must submit the following information to fully comply with the requirements of Order D.5.

1. The Site includes five contiguous parcels: Assessor's Parcel Number (APN) 0336-134-02, -03, and -05 and APN 0336-131-08 and -09. The development of these parcels constitutes "a plan of common development," as defined in the CAO. All maps, plan sheets, figures, drawings, and discussions, as relevant to the Site, must include the inclusive area that constitutes the entire Site with the Site boundary clearly labeled.
2. In order to accurately define the location, type and extent of all historical surface water features on the Site, Arimol must perform a surface water delineation based on a **combination** of file review and on-site field surveys. A scaled site plan illustrating the location and extent of all surface waters on the Site, including the extent and types of vegetation associated with those surface waters, must be included.
 - a. Surface water features include streams and drainage channels (natural and man-made), springs, seeps, wetlands, etc. The historical extent of all surface waters on the Site must be delineated.
 - b. The spring drainages are known to have historically been characterized by dense willow shrub, which may be classified as part of the shrub wetland habitat identified in the eastern portion of the site. The spring drainages and extent of riparian buffer need to be further defined.
 - c. All historical surface water features must be quantified in terms of area, with linear features (i.e. channels and drainages) further characterized by length of channel, width of channel bed, and depth of channel.
 - d. Historical topographic contours, as shown on the, sheet C-1, Site Plan, must be used as a base for determining historic extent of surface water features on the Site. For example, based on topographic contours as shown on sheet C-1, it appears that the wet meadow area in the eastern portion of the Site likely extended much farther to the south than what is currently shown on sheet C-2, Streambed Grading Plan.

Order D.6 – Once Arimol identifies the historic surface water features on the Site and quantifies the Site development impacts to those resources (CAO Order D.5), CAO Order D. 6 requires Arimol to develop a Surface Water Restoration Plan that will restore the impacted surface water features to pre-development (historical) conditions. In order to fully comply with CAO Order D.6, Arimol must provide a Surface Water Restoration Plan that **mirrors** an accurate depiction of the historical surface water conditions identified for the Site. Any deviation thereof would constitute a project, not restoration, and would require Arimol to comply with additional requirements of the California Environmental Quality Act, the Porter-Cologne Water Quality Control Act, and the Federal Clean Water Act. The Surface Water Restoration Plan must include a **narrative discussion** of said plans as well as engineered drawings.

NEXT STEPS

I strongly encourage Arimol Group, Inc. to take the actions described below, as soon as possible. Continued violations of the CAO are subject to additional enforcement action with liabilities of up to \$10,000 per violation for each day of violation.

1. Begin restoration activities by removing the 30-inch corrugated metal pipe culvert and concrete headwall and restoring the streambed to its historical flow path as authorized in our letter dated August 29, 2012. No other restoration activities or development are authorized.
2. Submit to the Water Board's Victorville office a response to our comments on the revised Grading Plan submittal of September 28, 2012, as outlined above, and provide updated Grading Plans, as appropriate.
3. Concurrently with restoration and until permanent measures are in place, an effective combination of temporary sediment and erosion control best management practices (BMPs) must be implemented to stabilize all disturbed soils on the Site, in accordance with the site-specific Stormwater Pollution Prevention Plan (SWPPP). The BMPs must be correctly installed and maintained so that they remain effective in preventing prevent sediment-laden storm water discharges off the Site or into surface waters.
4. Submit to the Water Board's Victorville office a technical report that fully satisfies the minimum content requirements as described in detail by CAO Order D.5. The technical report must be signed by Arimol or authorized representative.
5. Submit to the Water Board's Victorville office a technical report for the Executive Officer's approval that provides a Surface Water Restoration Plan that fully satisfies the plan requirements as described in detail by CAO Order D.6.

If you have questions, please contact me at (760) 241-6583 (mplaziak@waterboards.ca.gov). You may also contact my staff, Patrice Copeland, Senior Engineering Geologist, at (760) 241-7404 (pcopeland@waterboards.ca.gov), or Jan Zimmerman, Engineering Geologist, at (760) 241-7376 (jjzimmerman@waterboards.ca.gov).



Mike Plaziak, PG
Supervising Engineering Geologist

Enclosures: 1. CAO R6V-2012-0008
2. Water Board letter dated August 29, 2012

cc w/enc: Mail List

JZ/rp \Arimol(Serenity)\Arimol_GradePlan_10-12-2012.docx

EXHIBIT NO. 17

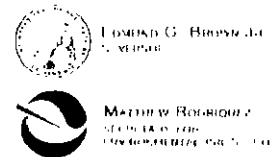

State Water Resources Control Board

TO: Anna Kathryn Benedict
Senior Staff Counsel
Office of Enforcement

FROM: Gerald Horner
Economist
Office of Research, Planning and Performance
916 341-5279
ghorner@waterboards.ca.gov

DATE: November 21, 2012

SUBJECT: ECONOMIC BENEFIT OF NONCOMPLIANCE OF CLEANUP AND ABATEMENT ORDER NO. R6V-2012-0008, ARIMOL GROUP, INC., LAKE ARROWHEAD, SAN BERNADINO COUNTY

This memo is in response to your request of July 09, 2012 for a determination of Arimol Group Inc. (Arimol) economic benefit resulting from the discharger's violation of the Cleanup and Abatement Order R6V-2012-0008 and the discharger's violation of the Notice of Non-Compliance for the discharge of waste to waters of the state as well as failure to obtain coverage under the Statewide General Permit for Discharges of Storm Water Associated with Construction Activity, Order NO. 2009-0009-DWQ. This memo analyzes the economic benefit realized by Arimol for: 1) failure to comply with discharge of waste to waters regulations, 2) failure to obtain coverage under the Statewide General Permit for Discharges of Storm Water Associated with Construction Activity, and 3) violation of Cleanup and Abatement Order NO. R6V-2012-0008. The results of this analysis are to be used to determine the minimum amount of the assessed liability in Administrative Civil Liability (ACL) Complaint No. R6V-2012-0049 pursuant to California Water Code section 13268. ACL's may be imposed for violations of California Water Code (CWC) section 13267, and CWC section 13323 and authorizes the Executive Officer to issue a complaint.

The Porter-Cologne Act requires that certain civil liabilities be set at a level that accounts for any "economic benefit or savings" violators gained through their violations. To establish the amount of civil liabilities, the Office of Enforcement uses a "Penalty Calculation Methodology" that addresses the economic benefit of noncompliance.¹

Summary

The total economic benefit of operating the expansion of the Serenity Conference and Retreat Center (Serenity) by not complying with environmental regulations is \$573,342. Procedures used in estimating the economic benefit of noncompliance are detailed in the following sections.

¹ Water Quality Enforcement Policy, Office of Enforcement, State Water Resources Control Board, May 20, 2010, Page 9-21.

The BEN Model

The U.S. Environmental Protection Agency developed the BEN computer model to calculate the economic benefit a discharger derives from delaying and/or avoiding compliance with environmental regulations.² The next section describes the structure of the BEN model and details the procedures used in calculating the economic benefit of noncompliance.

Economic Benefit Overview

Economic benefit represents the financial gains that a violator accrues by delaying and/or avoiding expenditures to meet mandated pollution control requirements. Funds not spent on environmental compliance are available for other profit-making activities or, alternatively, a defendant avoids the costs associated with obtaining additional funds for environmental compliance. Economic benefit represents the amount by which a defendant is financially better off from not having complied with environmental requirements in the specified timeframe. The appropriate economic benefit calculation should represent the amount of money that would make the violator indifferent between compliance and noncompliance. If the civil penalty does not recover at least this economic benefit, then the violator will retain an economic gain and have no financial incentive to comply. Because of the precedent of this retained gain, other regulated companies may see an economic advantage in similar noncompliance, and the penalty will fail to deter potential violators. Economic benefit does not represent compensation to the enforcement agency as in a typical "damages" calculation for a tort case, but instead is the minimum amount by which the violator must be penalized so as to return it to the financial position it would have been in had it complied on time.

BEN Model Methodology

The economic benefit calculation must incorporate the economic concept of the "time value of money." Stated simply, a dollar today is worth more than a dollar tomorrow, because you can invest today's dollar to start earning a return immediately. Thus, the further in the future the dollar is, the less it is worth in "present-value" terms. Similarly, the greater the time value of money (i.e., the greater the "discount" or "compound" rate used to derive the present value), the lower the present value of future costs.

To calculate a violator's economic benefit, BEN uses standard financial cash flow and net present value analysis techniques, based on modern and generally accepted financial principles. First, BEN calculates the costs of complying on-time and of complying late, adjusted for inflation (price adjusted), depreciation, and tax deductibility. To compare the on-time and delayed compliance costs in a common measure, BEN calculates the present value of both streams of costs, or "cash flows," as of the date of initial noncompliance. BEN derives these values by discounting the annual cash flows at an average cost of capital throughout this time period.

BEN then subtracts the delayed-case present value from the on-time-case present value to determine the initial economic benefit as of the noncompliance date. Finally, BEN compounds this initial economic benefit forward to the penalty payment date at the same cost of capital to determine the final economic benefit of noncompliance. The BEN model focuses exclusively on the economic benefit from delayed and/or avoided costs (its analysis encompasses only the

² BEN Version 4.7.0 was developed under the direction of Jonathan Libber, BEN/ABEL Coordinator, Office of Enforcement and Compliance Assurance, U.S. EPA. Technical assistance provided to EPA by Industrial Economics, Incorporated (IEC), Cambridge, MA.

cost differential between compliance and noncompliance). BEN, thereby, employs a simplifying assumption that the finances of a violator's compliant and noncompliant conditions are identical but for the compliance cost differential.

Pollution control expenditures can include: (1) capital investments (e.g., pollution control equipment); (2) one-time nondepreciable expenditures (e.g., setting up a reporting system, or acquiring land); and (3) annually-recurring costs (e.g., operating and maintenance costs, or groundwater monitoring costs). Each of these expenditures can be either delayed or avoided. BEN's baseline assumption is that capital investments and one-time nondepreciable expenditures are merely delayed over the period of noncompliance, whereas annual costs are avoided entirely over this period. BEN does allow, however, analysis of any combination of delayed and avoided expenditures.

BEN calculates the violator's discount/compound rate based on entity type and financial information from the date of noncompliance to the penalty payment date. As noted above, the discount/compound rate quantifies the time value of money. BEN discounts and compounds all cash flows at the cost of capital, averaged over the time period from the noncompliance date to the compliance or penalty payment date, whichever is later. To calculate an average discount/compound rate for a trust, BEN uses the cost of debt for a privately owned entity.

BEN derives a violator's economic benefit in several steps. First, BEN price adjusts compliance costs from the cost estimate date to the date when they would have been expended had the violator complied on time (on-time scenario) and to the date when they will be expended as the violator comes into compliance (delay scenario). Next, BEN uses these costs to compute the total cost of complying on-time and of complying late, adjusted for inflation, depreciation, and taxes. BEN also calculates the present value of both scenarios as of the date of initial noncompliance, so that they can be compared in a common metric. Then, BEN subtracts the delayed scenario present value from the on-time scenario present value to determine the initial economic benefit as of the noncompliance date. Finally, BEN compounds³ this initial economic benefit forward to the penalty payment date.

All costs must be price adjusted to the date of noncompliance using an inflation index. Inflation indices are more precise than an annual inflation rate, but they require an index value for every relevant month. Therefore, BEN contains a database of monthly index values for several price indices from 1987 to 2029. Annual updates keep indices current and add future values. For projected future inflation, BEN extrapolates each cost index forward in time at a forecasted rate, based upon projections from industry groups and government agencies.

Net Revenue Gained from Noncompliance and Annual Recurring Costs

The BEN model has three categories of avoided or delayed costs: 1) capital investment; 2) one-time nondepreciable expenditures; and 3) annual recurring costs.

By not complying with the specified regulations, Arimol benefits by realizing additional income associated with the conference and retreat center, and also by avoiding Section 404 permit costs.

Conference and Retreat Center Lost Income:

Completion of the Serenity project would have been delayed by at least six months if environmental regulations were observed. That would have resulted in a loss of net revenue

³ Compounding is the process of adding earned interest to the principal so that, from that moment on, the interest that has been added also earns interest. The alternative is simple interest where interest is not added to the principal. The use of compounding interest is standard practice in finance and economics.

from the Conference and Retreat Center. The loss of net revenue was estimated by using typical revenue and costs from an comparable facilities located in southern California.

The business plan is to construct six structures and to convert two existing structures suitable for 42 guests. Arimol recently purchased a number of properties in the area subject to the ACL and permits were issued by San Bernardino County for the construction of six residential structures (Table 1). Each unit is designed to house six guests.

Table 1. Serenity Facilities Under Construction by The Arimol Group Located on the Site Subject to the ACL.

<u>Address</u>	<u>Assessors Parcel</u>		<u>Status</u>	<u>Floor Area</u>	
	<u>Number</u>	<u>Permit</u>		<u>(sq. ft.)</u>	<u>Rent/mo.*</u>
1031(A) Meadowbrook Dr	0336-134-02	B201109433	Under const.	12,497	\$9,965
1031(B) Meadowbrook Dr	0336-134-02	B201109431	Under const.	1,976	\$1,576
995 Meadowbrook Dr	0336-134-03	B201108443	Under const.	2,054	\$1,638
977 Meadowbrook Dr	0336-134-05	B201108361	Under const.	2,052	\$1,636
986 Meadowbrook Dr	0336-131-09	B201108673	Under const.	1,993	\$1,589
974 Meadowbrook Dr	0336-131-08	B201108660	Under const.	2,000	\$1,595
Totals				22,572	\$17,999

Source: San Bernardino County Assessors Office.

* \$0.80/sf/month. Average of nine advertised monthly rental rates for similar single family houses. http://www.mountainnews.com/classifieds/housing/rent/ad_0db6cf27-8708-5760-997b-91cbd37d6f05.html, and <http://www.trulia.com/rental/3093667630-366-Rainier-Rd-Lake-Arrow-head-CA-92352>, Sept. 27, 2012.

Arimol also purchased a number of properties located in close proximity to the subject site with existing structures that could be converted to guest facilities or where additional structures could be constructed (Table 2).

Table 2. Arimol Group, Inc. Properties Located in Close Proximity to the Site Subject to the ACLC.

<u>Address</u>	<u>Assessors Parcel</u>		<u>Use</u>	<u>Zoned</u>
	<u>Number</u>			
Meadowbrook Road	0336-121-25*		Campground	Commercial
985 Meadowbrook Road	0336-134-04		SFR [#]	Residential
Meadowbrook Road	0336-132-01		Vacant	Residential
1006 Meadowbrook Road	0336-132-02		SFR [#]	Residential
Meadowbrook Road	0336-132-03		Vacant	Residential
1010 Meadowbrook Road	0336-136-01		SFR [#]	Residential
Jewel Drive, Crestline	0339-192-10		Vacant	Residential

* Lot size reported as being between 14 and 25 acres.

[#] Single family residence

All parcels purchased in 2011.

Total annual net revenue for the conference and retreat facility is estimated at \$921,200 (Table 3). This assumes a 90 percent occupancy rate, monthly staff costs of \$88,333 and operations and maintenance costs of \$29,900 per month.

Table 3. Operating Revenue, Costs and Net Revenue for Serenity Conference and Retreat Center, Lake Arrowhead, San Bernardino County, CA.

Revenue (month)		
Guest capacity		42
Assumed occupancy rate		90%
Assumed occupancy		38
Revenue/guest (month)		<u>\$5,000</u>
Total Revenue (month)		\$190,000
Costs (month)		
<u>Staff costs</u>		
Manager	\$8,333	
Assistant manager	\$6,250	
Recreation staff (3)	\$16,250	
Contracted staff services	\$25,000	
On site chef	\$5,000	
Office manager	\$5,000	
Operations staff (7)	<u>\$17,500</u>	
Total staff costs		\$83,333
<u>Operation and maintenance</u>		
Food costs (\$20/day)	\$22,800	
Utilities	\$2,100	
Miscellaneous	<u>\$5,000</u>	
Total O&M costs		<u>\$29,900</u>
Total Monthly Costs		\$113,233
Total Monthly Net Revenue		\$76,767
Total Annual Net Revenue		\$921,200

The BEN model estimated the conference and retreat income benefit of noncompliance at \$389,400 (Table 4). Critical assumptions of the analysis are: the date of noncompliance, 10/1/2011; the date of compliance, 6/1/2012; and a penalty payment date of 2/15/2013.⁴

⁴ The BEN Help System, Overview: Economic Benefit: Context, Theory and Methodology. "Sales can be entered as a "cost" in BEN, which will then calculate the profit's after-tax net present value."

Table 4. The Serenity Conference and Retreat Income Benefit of Noncompliance with Environmental Regulations.

BEN Results

Version 4.7.0

Serenity-Arimol Group	Lost Retreat Income
Present Values as of Noncompliance Date (NCD),	
	<u>01-Oct-2011</u>
A) On-Time Capital & One-Time Costs	\$0
B) Delay Capital & One-Time Costs	\$0
C) Avoided Annually Recurring Costs	\$355,191
D) Initial Economic Benefit (A-B+C)	\$355,191
E) Final Econ. Ben. at Penalty Payment Date,	
	15-Feb-2013
	\$389,400

C-Corporation w/ CA tax rates

Average Discount/Compound Rate	6.9%
Average Discount/Compound Rate Calculated By:	BEN
Compliance Date	01-Jun-2012

Capital Investment:

Estimated Cost of Capital Equipment	\$0
Capital Investment Delayed Not Avoided	
Cost Estimate Date	N/A
Cost Index for Inflation: N/A	
Consider Future Replacement (Useful Life)	N/A (N/A)

One-Time, Nondepreciable Expenditure:

Estimated Cost1	\$0
One-Time Expenditure Delayed Not Avoided	
Cost Estimate Date	N/A
Cost Index for Inflation: N/A	
Tax Deductible?	N/A

Annually Recurring Costs:

Estimated Cost	\$921,200
Cost Estimate Date	25-Sep-2012
Cost Index for Inflation: FALSE	

D:\My Documents\Enforcement\Benefits of Noncompliance\Serenity Lodge-Arimol\BEN4.7.0SerenityRetreat110612.xls]Print
11/6/2012 15:24

Income, Permits and Mitigation-Total Benefit of Noncompliance

The developer failed to file for several permits before altering a stream bed and several wetlands located on the property, and failed to perform mitigation practices.⁵ The costs, noncompliance dates, compliance dates, penalty payment dates, and economic benefit of noncompliance for the various infractions are presented in Table 5. The BEN model result tables for the 401/404 permit fees, the on-site mitigation, and the NPDES Permit Fees are attached.

Table 5. Serenity Conference and Retreat Center Total Benefit of Noncompliance

	<u>Cost/Income</u>	<u>Cost Estimate</u>	<u>Date of</u>			<u>Benefit of Noncompliance</u>
			<u>Noncompliance</u>	<u>Compliance</u>	<u>Penalty Payment</u>	
Conference and Retreat Income/yr	\$921,200	9/25/2012	10/1/2011	6/1/2012	2/15/2013	\$389,400
401/404 Permit Fees Avoided	\$250,000	10/1/2012	6/1/2011	11/1/2013	2/15/2013	\$162,854
On-site Mitigation Delayed	\$270,000	10/1/2012	6/1/2011	11/1/2013	2/15/2013	\$20,731
NPDES Permit Fees Delayed	\$20,000	10/1/2012	10/1/2011	4/13/2012	2/15/2013	\$357
						<u>\$573,342</u>

Source: BEN Version 4.7.0, 11/21/12

The total benefit of noncompliance is \$573,342.

Attachments: BEN Model result sheets.

⁵ Lisa Scoralie, Lahontan Regional Water Quality Control Board. 10/24/2012.

Attachment 1. 401/404 Permit Fees Avoided Benefit of Noncompliance.

BEN Results

Version 4.7.0

Serentiy-Arimol Group	401/404 Permit Fees Avoided
Present Values as of Noncompliance Date (NCD),	
	<u>01-Jun-2011</u>
A) On-Time Capital & One-Time Costs	\$145,271
B) Delay Capital & One-Time Costs	\$0
C) Avoided Annually Recurring Costs	\$0
D) Initial Economic Benefit (A-B+C)	\$145,271
E) Final Econ. Ben. at Penalty Payment Date,	
	<u>15-Feb-2013</u> \$162,854

C-Corporation w/ CA tax rates

Average Discount/Compound Rate	6.9%
Average Discount/Compound Rate Calculated By:	BEN
Compliance Date	01-Nov-2013

Capital Investment:

Estimated Cost of Capital Equipment	\$0
Capital Investment Delayed Not Avoided	
Cost Estimate Date	N/A
Cost Index for Inflation: N/A	
Consider Future Replacement (Useful Life)	N/A (N/A)

One-Time, Nondepreciable Expenditure:

Estimated Cost 1	\$250,000
One-Time Avoided	
Cost Estimate Date	01-Oct-2012
Cost Index for Inflation: FALSE	
Tax Deductible?	Y

Annually Recurring Costs:

Estimated Cost	\$0
Cost Estimate Date	N/A
Cost Index for Inflation: N/A	

D:\My Documents\Enforcement\Benefits of Noncompliance\Serenity Lodge-Arimol\BEN4.7.0Serenity401-404Permit110612.xls]Print
11/6/2012 16:20

Attachment 2. On-site Mitigation Delayed Benefits of Noncompliance.

BEN Results

Version 4.7.0

Serentiy-Arimol Group	On-site Mitigation Delayed
<u>Present Values as of Noncompliance Date (NCD),</u>	<u>01-Jun-2011</u>
A) On-Time Capital & One-Time Costs	\$156,893
B) Delay Capital & One-Time Costs	\$138,400
C) Avoided Annually Recurring Costs	\$0
D) Initial Economic Benefit (A-B+C)	\$18,492
E) Final Econ. Ben. at Penalty Payment Date,	
15-Feb-2013	\$20,731

C-Corporation w/ CA tax rates

Average Discount/Compound Rate	6.9%
Average Discount/Compound Rate Calculated By:	BEN
Compliance Date	01-Nov-2013

Capital Investment:

Estimated Cost of Capital Equipment	\$0
Capital Investment Delayed Not Avoided	
Cost Estimate Date	N/A
Cost Index for Inflation: N/A	
Consider Future Replacement (Useful Life)	N/A (N/A)

One-Time, Nondepreciable Expenditure:

Estimated Cost1	\$270,000
One-Time Expenditure Delayed Not Avoided	
Cost Estimate Date	01-Oct-2012
Cost Index for Inflation: FALSE	
Tax Deductible?	Y

Annually Recurring Costs:

Estimated Cost	\$0
Cost Estimate Date	N/A
Cost Index for Inflation: N/A	

D:\My Documents\Enforcement\Benefits of Noncompliance\Serenity Lodge-Arimol\BEN4.7.0SerenityMitigation110612.xls]Print
11/6/2012 16:22

Attachement 3. NPDES Permit Fees Delayed Benefit of Noncompliance.

BEN Results

Version 4.7.0

Serentiy-Arimol Group	NPDES Permit Fees Delayed
Present Values as of Noncompliance Date (NCD),	
	<u>01-Oct-2011</u>
A) On-Time Capital & One-Time Costs	\$11,674
B) Delay Capital & One-Time Costs	\$11,348
C) Avoided Annually Recurring Costs	\$0
D) Initial Economic Benefit (A-B+C)	\$325
E) Final Econ. Ben. at Penalty Payment Date,	
15-Feb-2013	\$357

C-Corporation w/ CA tax rates

Average Discount/Compound Rate	6.9%
Average Discount/Compound Rate Calculated By:	BEN
Compliance Date	13-Apr-2012

Capital Investment:

Estimated Cost of Capital Equipment	\$0
Capital Investment Delayed Not Avoided	
Cost Estimate Date	N/A
Cost Index for Inflation: N/A	
Consider Future Replacement (Useful Life)	N/A (N/A)

One-Time, Nondepreciable Expenditure:

Estimated Cost 1	\$20,000
One-Time Expenditure Delayed Not Avoided	
Cost Estimate Date	01-Oct-2012
Cost Index for Inflation: FALSE	
Tax Deductible?	Y

Annually Recurring Costs:

Estimated Cost	\$0
Cost Estimate Date	N/A
Cost Index for Inflation: N/A	

D:\My Documents\Enforcement\Benefits of Noncompliance\Serenity Lodge-Arimol\BEN4.7.0SerenityNPDESPermits110612.xls\Print
11/6/2012 16:23

SECTION V

LIST OF DOCUMENTS INCLUDED BY REFERENCE

LIST OF DOCUMENTS INCLUDED BY REFERENCE

1. Water Quality Control Plan for the Lahontan Region (Basin Plan)
2. California Water Code
3. California Code of Regulations
4. California Environmental Quality Act
5. Federal Clean Water Act
6. Construction General Permit (Order No. 2009-0009-DWQ)
7. State Water Resources Control Board, Water Quality Enforcement Policy, Effective May 20, 2010
8. Water Board Files for Arimol Group, Inc. – Serenity Lodge (excluding all privileged documents). Documents include, but are not limited to, the following:

Document No.	Description
1	Miscellaneous Water Board file contents: initial communications with Bill Moller/Arimol Group, Inc., electronic mail (“email”), photos, and other documents (includes California Dept. of Fish and Game (CDFG) October 17, 2011 email to Arimol, Water Board October 18, 2011 Staff Enforcement Letter (SEL) email to Arimol, etc.
2	Water Board staff’s 2 nd Site Inspection Report for January 20, 2012 Site Inspection
3	Water Board Inspection Report for staff’s 4 th Site Inspection on February 6, 2012
4	Water Board Cleanup and Abatement Order (CAO) No. R6V-2012-0008, dated March 15, 2012
5	CAO Certified Mail Receipt signed by Bill Moller on March 23, 2012
6	Arimol Engineer’s April 10, 2012 email to Water Board and Water Board staff’s April 11, 2012 response
7	Arimol Group, Inc. Storm Water Pollution Prevention Plan (SWPPP) dated April 13, 2012
8	Arimol Group, Inc. SWPPP Amendment No. 1, dated April 18, 2012

Continued next page

Continued from previous page

9	Arimol Group, Inc. SWPPP Amendment No. 2, dated April 19, 2012
10	Water Board Inspection Report for staff's 7 th Site Inspection on April 20, 2012
11	PMC's technical report dated April 20, 2012 (partial response to Cleanup and Abatement Order (CAO) No. R6V-2012-0008 - Order D.5)
12	PMC's Streambed Restoration Plan dated April 26, 2012 (partial response to CAO Order D.6)
13	Water Board Inspection Report for staff's 8 th Site Inspection on June 7, 2012
14	Arimol Group, Inc. SWPPP Amendment No. 3, dated June 8, 2012
15	PMC supplemental information email submittal dated July 20, 2012, provides additional information regarding April 20, 2012 technical report, and a revised Surface Water Restoration Plan
16	PMC supplemental information submittal dated July 20, 2012, hard copy of above received July 26, 2012, includes oversized plans (not identical to above) and a July 20, 2012 supplemental submittal to CDFG that includes a Habitat Mitigation and Monitoring Plan
17	Water Board Inspection Report for staff's 9 th Site Inspection on August 9, 2012
18	Arimol Group, Inc. SWPPP Amendment No. 4, dated August 28, 2012
19	Water Board letter dated August 29, 2012 conditionally authorizing a portion of the Surface Water Restoration Plan
20	Arimol Group, Inc. SWPPP Amendment No. 5, dated September 21, 2012
21	Copy of Arimol Group, Inc.'s September 2012 Revised Grading Plan Submittal to San Bernardino County (received by Water Board on September 28, 2012 from Bill Moller)
22	Water Board Inspection Report for staff's 10 th Site Inspection on October 11, 2012
23	State Board Economist's Economic Benefit Analysis dated October 25, 2012
24	Water Board Administrative Civil Liability Complaint No. R6V-2012-0049, dated October 26, 2012
25	Water Board and San Bernardino County November 2012 email communications regarding status of Arimol grading plans/permit