

# NEXT TOPICS

1. Plume Update
2. Investigation Status
3. Remediation Activities

# Plume Status

- Good news along western boundary
- Not so good news along Summerset Rd & south of Thompson Rd
- All other areas are generally the same as before

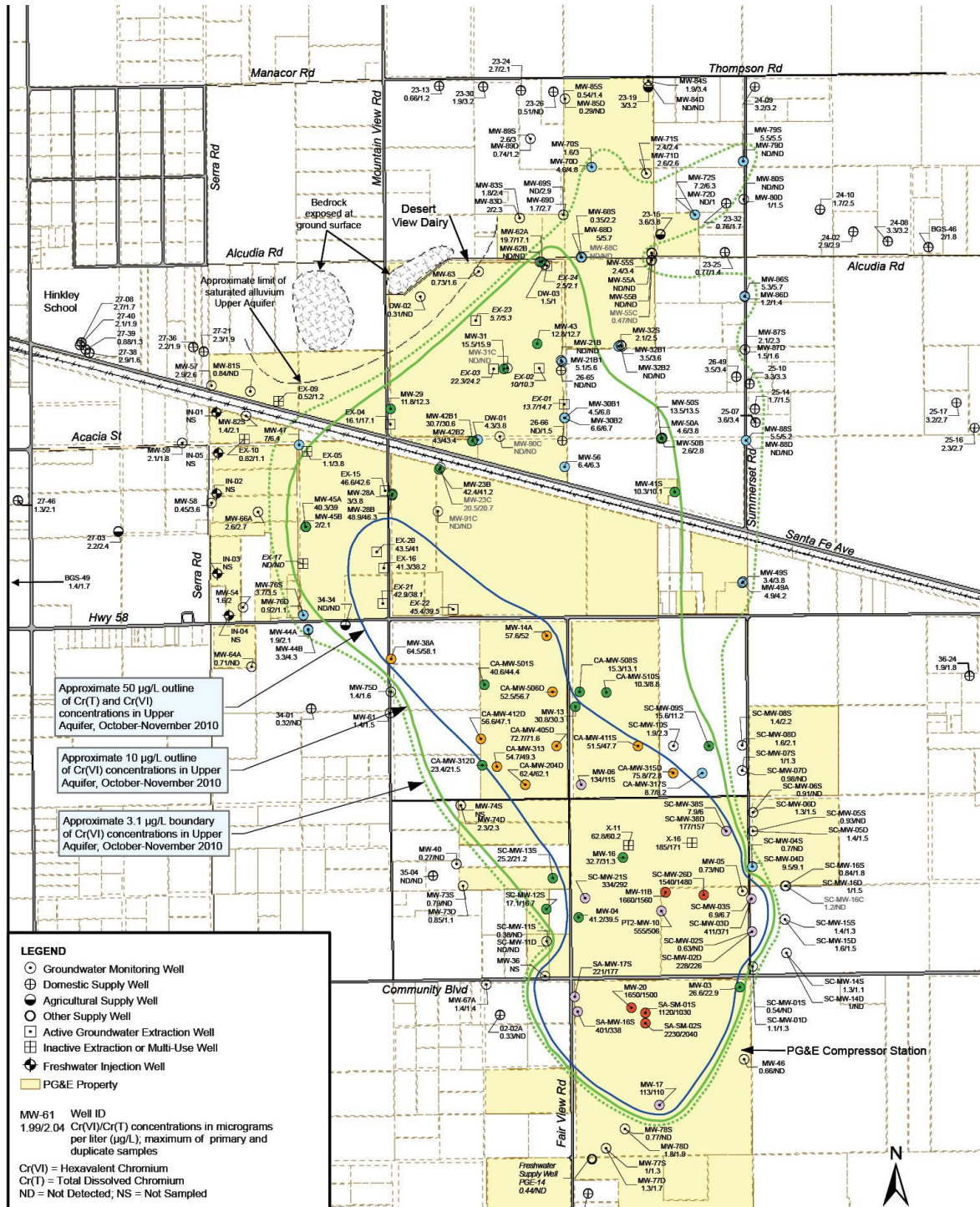

- LEGEND**
- Groundwater Monitoring Well
  - ⊕ Domestic Supply Well
  - ⊖ Agricultural Supply Well
  - ⊙ Other Supply Well
  - ⊠ Active Groundwater Extraction Well
  - ⊡ Inactive Extraction or Multi-Use Well
  - ⊕ Freshwater Injection Well
  - PG&E Property

MW-61 Well ID  
 1.99/2.04 Cr(VI)/Cr(T) concentrations in micrograms per liter (µg/L); maximum of primary and duplicate samples  
 Cr(VI) = Hexavalent Chromium  
 Cr(T) = Total Dissolved Chromium  
 ND = Not Detected; NS = Not Sampled



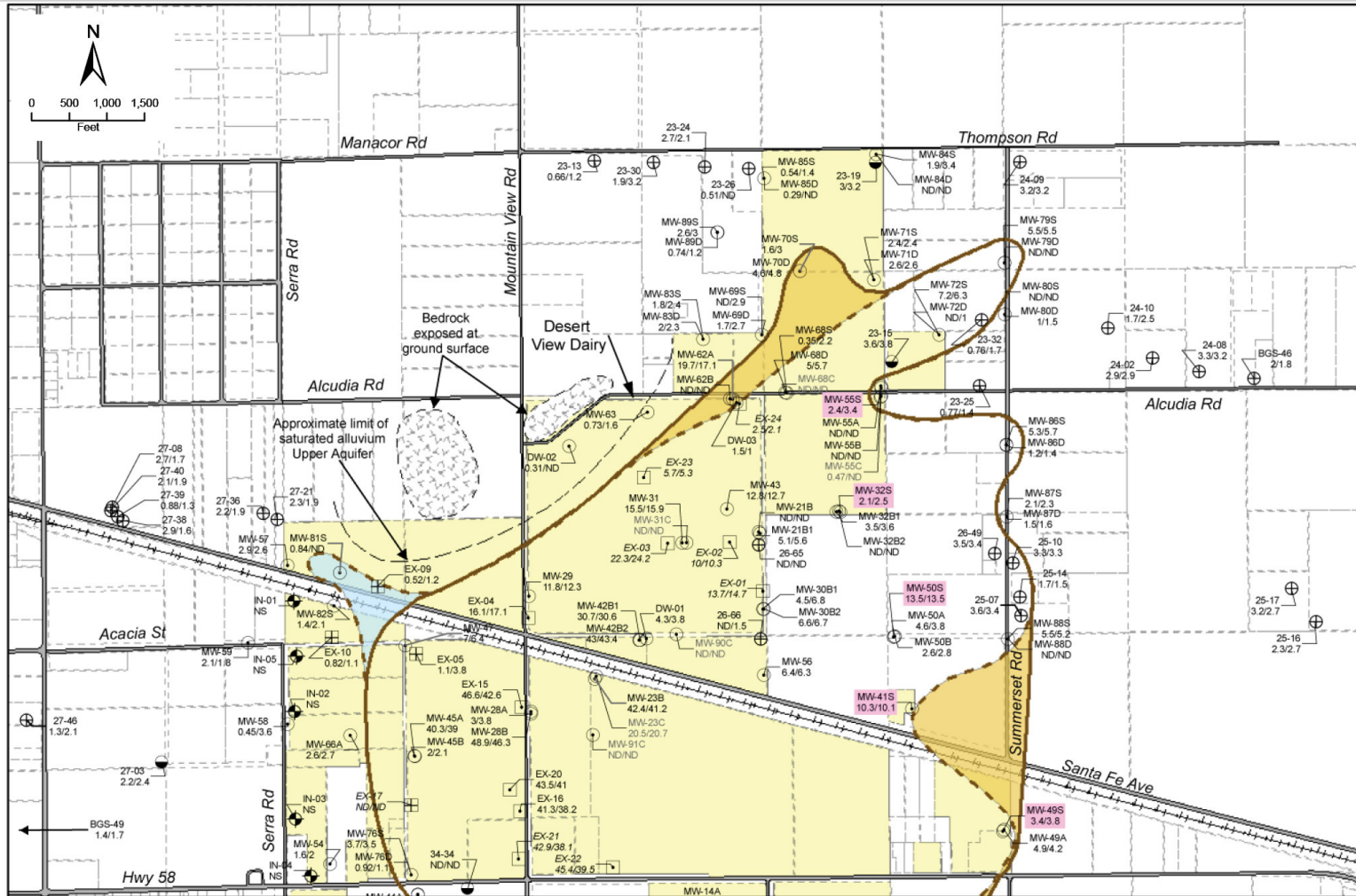

- LEGEND**
- 3.1 ppb Cr(VI) Boundary, October-November 2010
  - - - 3.1 ppb Cr(VI) Boundary, August 2010
  - Area where Boundary reduced
  - Area where Boundary increased
  - PG&E Property
  - New monitoring well installed after August 2010 sampling

**PLUME BOUNDARY CHANGES  
AUGUST AND OCTOBER-NOVEMBER 2010  
GROUNDWATER MONITORING  
PG&E GROUNDWATER REMEDIATION PROJECT  
HINKLEY, CALIFORNIA**

See Figure 4 for additional map notes

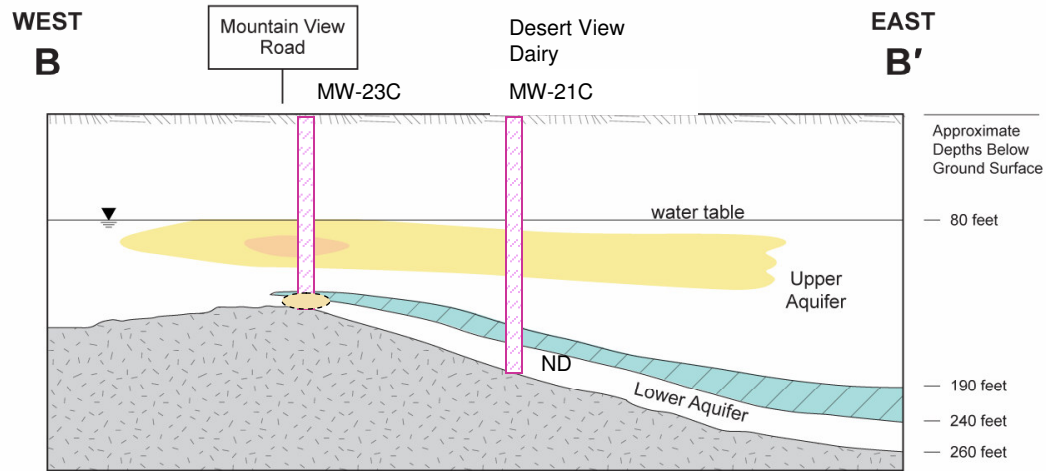
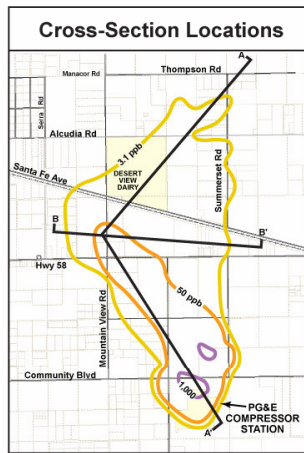
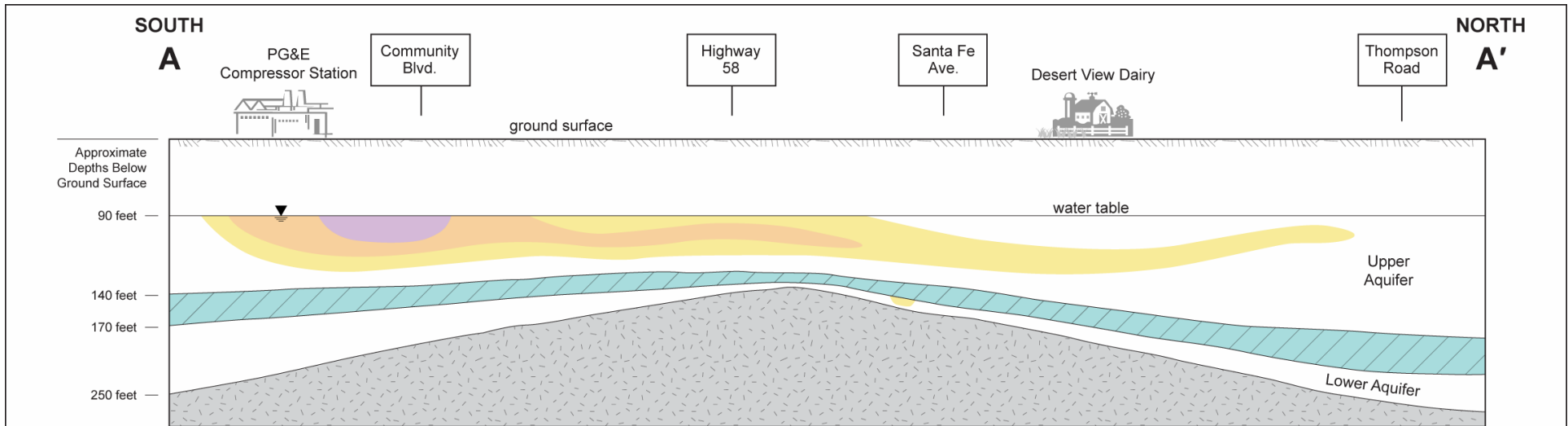

# Investigation Status

- Northern and eastern plume boundary investigation on-going
  - Report due by Feb. 15
- Lower aquifer investigation delayed but on-going
  - Report deadline extended from Jan. 31 to Feb. 28



**Chromium Plume Extent, October-November 2010**

- 3.1 to 50 parts per billion (ppb)
- 50 to 1,000 ppb
- greater than 1,000 ppb

-  Groundwater Table
-  Blue Clay Aquitard
-  Granitic Bedrock

**CONCEPTUAL CROSS-SECTIONS OF  
GROUNDWATER CHROMIUM PLUME  
(NOT TO SCALE)  
PG&E GROUNDWATER REMEDIATION PROJECT  
HINKLEY, CALIFORNIA**

# Remediation Activities

Plume containment using contaminated groundwater:

1. PG&E planning to re-start alfalfa fields at Gorman property using drag drip irrigation (start date: late-Feb.)
2. PG&E planning to add a alfalfa field at Cottrill property, west of DVD (start: spring)
3. PG&E considering to re-start the former Ranch LTU, near former Nelson Dairy, south of Santa Fe Rd (start: spring or summer)

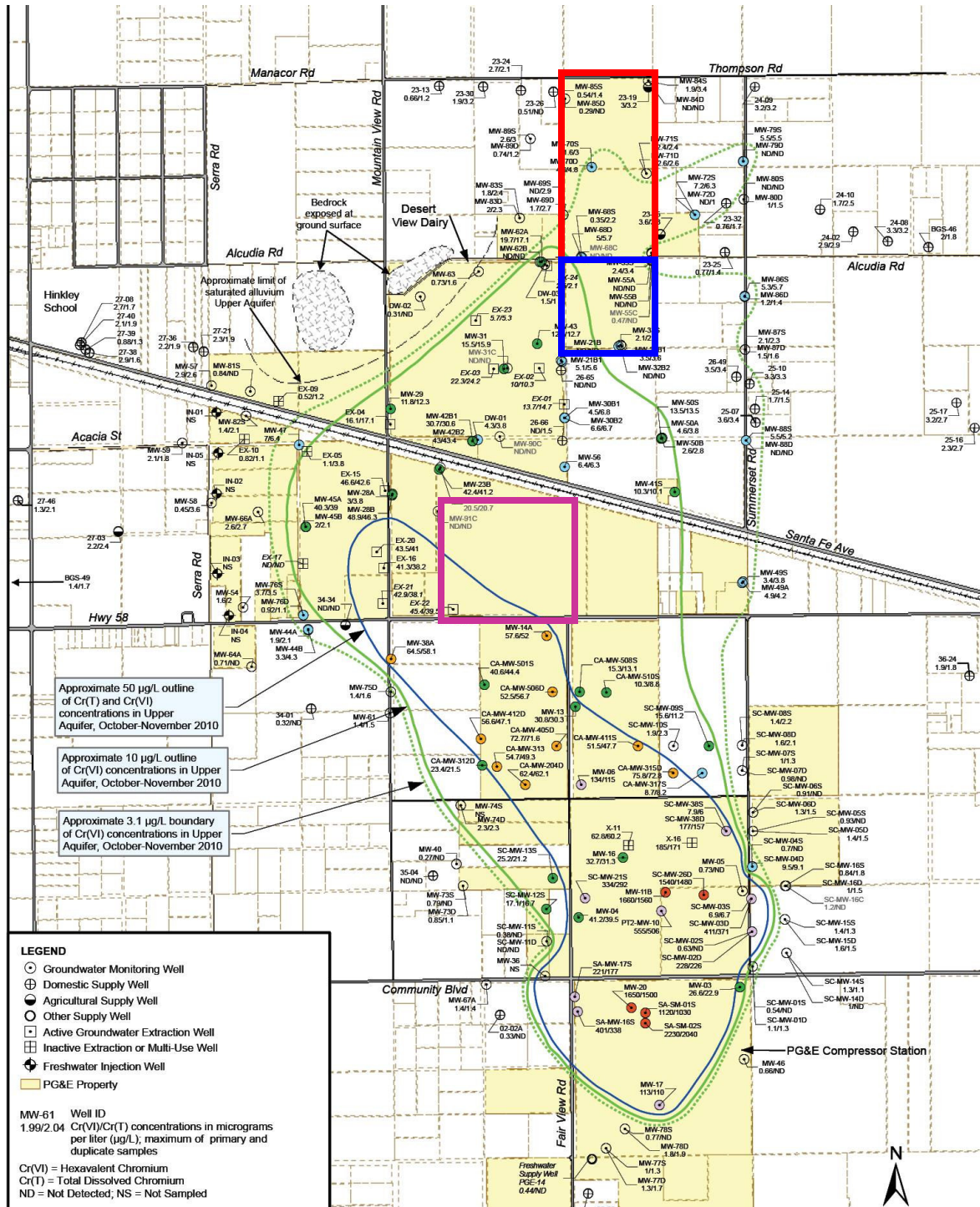

**LEGEND**

- Groundwater Monitoring Well
- ⊕ Domestic Supply Well
- ⊖ Agricultural Supply Well
- ⊙ Other Supply Well
- ⊠ Active Groundwater Extraction Well
- ⊡ Inactive Extraction or Multi-Use Well
- ⊕ Freshwater Injection Well
- PG&E Property

MW-61 Well ID  
 1.99/2.04 Cr(VI)/Cr(T) concentrations in micrograms per liter (µg/L); maximum of primary and duplicate samples

Cr(VI) = Hexavalent Chromium  
 Cr(T) = Total Dissolved Chromium  
 ND = Not Detected; NS = Not Sampled

Approximate 50 µg/L outline of Cr(T) and Cr(VI) concentrations in Upper Aquifer, October-November 2010

Approximate 10 µg/L outline of Cr(VI) concentrations in Upper Aquifer, October-November 2010

Approximate 3.1 µg/L boundary of Cr(VI) concentrations in Upper Aquifer, October-November 2010

Bedrock exposed at ground surface

Approximate limit of saturated alluvium Upper Aquifer

Freshwater Supply Well  
 FSE-14  
 0.44ND

PG&E Compressor Station





ANY QUESTIONS?

