

**STATE OF CALIFORNIA
CALIFORNIA REGIONAL WATER QUALITY CONTROL BOARD,
LOS ANGELES REGION**

ORDER NO. 97-011

**WASTE DISCHARGE REQUIREMENTS
for
COUNTY OF LOS ANGELES DEPARTMENT OF PUBLIC WORKS
(Manning Pit Sediment Placement Site)
(File 61-101)**



The California Regional Water Quality Control Board, Los Angeles Region (Regional Board), finds:

1. The County of Los Angeles Department of Public Works (hereafter "discharger") operates a Sediment Placement Site, located at the south end of former sand and gravel quarry, referred to as "Manning Pit". Manning Pit is situated approximately 700 feet south of Arrow Highway, on the west side of Vincent Avenue, City of Irwindale, as shown on "Figure 1", which is incorporated herein and made part of this Order. The Sediment Placement Site's latitude is 34°06' 12"; its longitude is 117° 55' 38" at the entrance to the Manning Pit.
2. The far southwest area of the Manning Pit is operated and maintained by the discharger as a ground water recharge facility. The 25-acre northern portion of Manning Pit is used as an inert landfill, owned and operated by the City of Irwindale, and is subject to waste discharge requirements (Order No. 91-015) adopted by the Regional Board on January 28, 1991.
3. The Sediment Placement Site is subject to waste discharge requirements (Order No. 85-75) adopted by the Regional Board on November 25, 1985, which allow for the disposal of material removed from debris basins that has been deposited in those basins by natural causes. This material does not contain soluble pollutants in concentrations that exceed applicable water quality objectives. All surface vegetation is grubbed and cleared from the debris basins so that the resulting average organic content of the debris is less than five percent.
4. The total capacity of this 45-acre Sediment Placement Site is 4.2 million cubic yards. Disposal operations are intermittent, depending upon the season and storm flows.
5. A review of the current waste discharge requirements was conducted by Regional Board staff in accordance with Subsection 13263(e) of the California Water Code.

These waste discharge requirements have been revised to include additional and updated findings, updated standard provisions, and a revised monitoring and reporting program.

December 4, 1996
Revised December 30, 1996

**County of Los Angeles Department
of Public Works
Manning Pit Sediment Placement Site
Order No. 97-011**

File No. 61-101

6. This project is categorically exempt from the provisions of the California Environmental Quality Act (CEQA) in accordance with Title 14, California Code of Regulations, Chapter 3, Subsection 15304(c).
7. The Sediment Placement Site overlies the westerly portion of the Main San Gabriel Valley Ground Water Basin. The site is underlain by unconsolidated sands, gravels, cobbles, and boulders which readily transmit water.
8. The Regional Board adopted a revised Water Quality Control Plan for the Los Angeles Region on June 13, 1994. The Water Quality Control Plan contains beneficial uses and water quality objectives for surface and ground waters of the Main San Gabriel Basin. Beneficial uses of the ground water include municipal, domestic, and agricultural supply, and industrial service and process supply. The requirements contained in this Order, as they are met, will be in conformance with the goals of the Water Quality Control Plan.

The Regional Board has notified the discharger and interested agencies and persons of its intent to adopt waste discharge requirements for this discharge and has provided them with an opportunity to submit their written views and recommendations.

The Regional Board, in a public meeting, heard and considered all comments pertaining to the discharge and to the tentative requirements.

IT IS HEREBY ORDERED that the County of Los Angeles Department of Public Works (the discharger) shall comply with the following:

A. Discharge Specifications

1. Disposal at this Sediment Placement Site shall only be conducted by the County of Los Angeles or by persons authorized to act on behalf of the County. The disposal of wastes other than those resulting from cleaning of the debris basins or other flood control facilities is prohibited.
2. Wastes disposed of at this disposal site shall be limited to material removed from debris basins or other flood control facilities that have been deposited by natural causes.

**County of Los Angeles Department
of Public Works
Manning Pit Sediment Placement Site
Order No. 97-011**

File No. 61-101

3. The discharger shall remove and relocate at a legal point of disposal any wastes which are discharged in violation of these requirements. For the purpose of these requirements, a legal point of disposal is defined as one for which Waste Discharge Requirements have been established by a California Regional Water Quality Control Board, and is in full compliance therewith.

B. Prohibitions

1. Surface vegetation that has been grubbed and cleared from the debris basins or other flood control facilities shall not be disposed of at this site.
2. No hazardous wastes, designated wastes, or liquid wastes shall be deposited at this disposal site.
3. No nonhazardous solid wastes (decomposable organic refuse such as, but not necessarily limited to, ordinary household and commercial refuse, tin cans, metals, paper and paper products, cloth and clothing, wood and wood products, construction wastes, lawn clippings, sod, shrubbery, hair, hide, bones, dead animals, roofing paper, tar paper, plasterboard, tires, unquenched ashes mixed with refuse, market refuse, garbage, etc.) shall be deposited at this disposal site.
4. No materials of a toxic nature such as insecticides, poisons, or radioactive materials, shall be deposited at this disposal site.
5. No asbestos or asbestos products shall be deposited at this disposal site.
6. Wastes deposited at this disposal site shall be confined thereto, and shall not be permitted to enter drainage ditches or watercourses.
7. Erosion of deposited materials by surface flow shall be prevented.
8. Neither the discharge nor any treatment of wastes shall cause pollution or nuisance.

C. Provisions

1. The discharger shall take any and all necessary measures to prevent unauthorized disposal of wastes at this disposal site by instituting a waste-load-checking program. A workplan outlining this program must be submitted to the Executive Officer for approval within 90 days after adoption of this Order.

**County of Los Angeles Department
of Public Works
Manning Pit Sediment Placement Site
Order No. 97-011**

File No. 61-101

2. Personnel operating this disposal site must be made aware of the provisions of this Order.
3. The discharger shall file with this Regional Board a report of any material change or proposed change in the character, location, boundaries or quantity of this waste discharge at least 120 days prior to the date of such proposed change.
4. In the event of any change in name of operator, or in control or ownership of land or disposal site facilities owned or controlled by the discharger, the discharger shall:
 - a. - Notify this Regional Board in writing of such a change; and
 - b. Notify the succeeding owner or operator by letter, a copy of which shall be filed with this Regional Board, of the existence of this Order.
5. Ninety days prior to cessation of disposal operations at this disposal site, the discharger shall submit a technical report to the Regional Board describing the methods and controls to be used to assure protection of the quality of receiving waters during final operations and with any proposed subsequent use of the land. Such methods and controls shall comply with the foregoing waste discharge requirements. The report shall be prepared under the direct supervision of a California-Registered Geologist or Civil Engineer, or a California-Certified Engineering Geologist.
6. This Regional Board considers the property owner to have continuing responsibility for correcting any problems which may arise in the future as a result of this waste discharge or water applied to this disposal site during subsequent use of the land for other purposes.
7. These requirements do not exempt the operator of this disposal site from compliance with any other laws, regulations, or ordinances which may be applicable; they do not legalize this disposal site, and they leave unaffected any further constraint on the disposal of wastes at this disposal site which may be contained in other statutes or required by other agencies.
8. In accordance with the California Water Code, the discharger shall furnish, under penalty of perjury, technical monitoring program reports; such reports shall be submitted in accordance with specifications prepared by the Executive Officer, which specifications are subject to periodic revisions as may be warranted.

County of Los Angeles Department
of Public Works
Manning Pit Sediment Placement Site
Order No. 97-011

File No. 61-101

9. According to Section 13263 of the California Water Code, these requirements are subject to periodic review and revision by this Regional Board.
10. Order No. 85-75, adopted by the Regional Board on November 25, 1985, is hereby rescinded.

I, John Norton, Acting Executive Officer, do hereby certify that the foregoing is a full, true, and correct copy of an Order adopted by the California Regional Water Quality Control Board, Los Angeles Region on January 27, 1997.

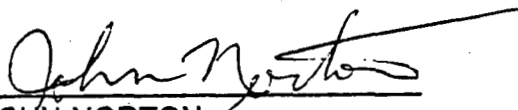
JOHN NORTON
Acting Executive Officer

BPBJ

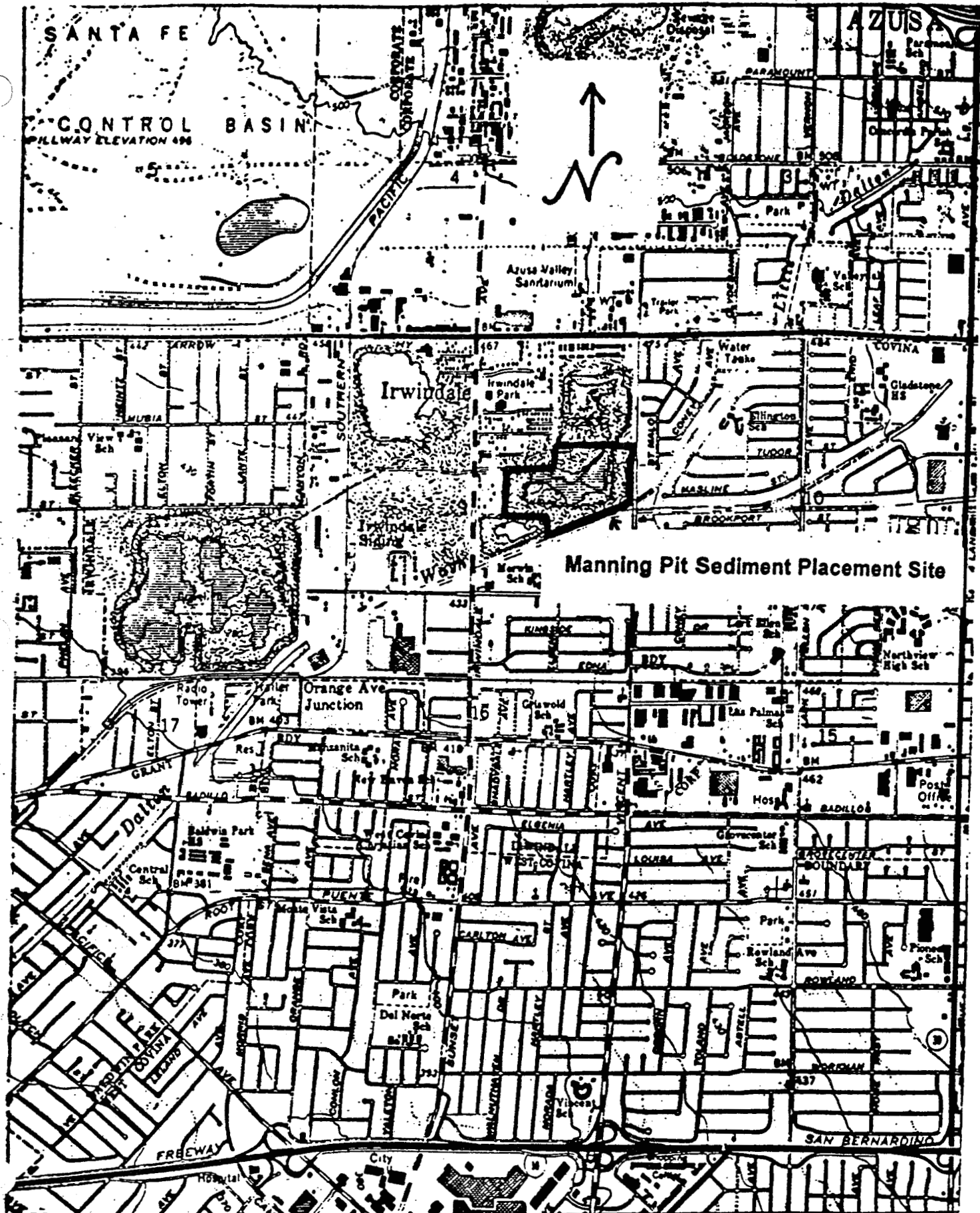

Figure 1. Map showing location of the Manning Pit Sediment Placement Site

Scale: One inch = 2000 feet

CALIFORNIA REGIONAL WATER QUALITY CONTROL BOARD,
LOS ANGELES REGION

MONITORING AND REPORTING PROGRAM NO. 3066
for
COUNTY OF LOS ANGELES DEPARTMENT OF PUBLIC WORKS
(Manning Pit Sediment Placement Site)

(File No. 61-101)

The County of Los Angeles Department of Public Works (discharger) shall implement this Monitoring and Reporting Program beginning in the first quarter immediately following adoption of these Waste Discharge Requirements.

I. WASTE DISPOSAL REPORTING

- A. Monitoring reports shall be submitted to the Regional Board by the dates in the following schedule:

<u>Reporting Period</u>	<u>Report Due</u>
January - March	April 15
April - June	July 15
July - September	October 15
October - December	January 15

- B. Each monitoring report shall contain the following information for each reporting period:
1. A tabular list of the estimated average monthly quantities (in cubic yards and tons) and types of materials deposited each month. If no wastes were deposited during the quarter, the report shall so state.
 2. A map depicting the areas of the site where the above materials were deposited. If filling has started in a new area, the report shall so state.
 3. An estimate of the remaining capacity (in cubic yards and tons), and the remaining life of the disposal site in years and months.
 4. A certification that all wastes deposited were deposited in compliance with the Regional Board's requirements, and that no wastes were deposited outside of the boundaries of the disposal site as specified in the Regional Board's requirements.
 5. A description of the location and an estimate of the seepage rate or flow of all known seeps and springs at the disposal site.

**COUNTY OF LOS ANGELES DEPARTMENT
OF PUBLIC WORKS
MANNING PIT SEDIMENT PLACEMENT SITE
Monitoring and Reporting Program
CI No. 3066**

Order No. 97-011

- C. A load-checking-program workplan is due to the Regional Board within ninety (90) days after the adoption of this Monitoring and Reporting Program which details any and all necessary measures to prevent unauthorized disposal of wastes at this disposal site.
- D. The discharger shall report all unacceptable (to this site) wastes inadvertently received at this disposal site and their disposition. The following details shall be included:
1. The source (if known), of the unacceptable wastes and date received and/or discovered.
 2. Identification of waste (if known) and the amount of waste.
 3. The name and address of the hauler who removed the waste from this disposal site.
 4. The ultimate point of disposal for the waste.
 5. The discharger's actions to prevent recurrence of the attempted depositing of unacceptable wastes by this source or individual (if applicable).
- If no unacceptable wastes were received or discovered during the reporting period, the report shall so state.
- E. This Monitoring and Reporting Program includes the attached "Standard Provisions Applicable to Waste Discharge Requirements. If there is any conflict between provisions stated herein and the "Standard provisions Applicable to Waste Discharge Requirements", these provisions stated herein will prevail.

Ordered by:

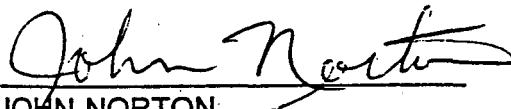
JOHN NORTON
Acting Executive Officer

Date:

January 27, 1997