

State of California
CALIFORNIA REGIONAL WATER QUALITY CONTROL BOARD
LOS ANGELES REGION

MONITORING AND REPORTING PROGRAM NO. 7514
FOR
CASITAS VALLEY RANCH/EMILY THOMSON
(Septic Tank/Leachfield System)
(Order No. 95-043)
(File No. 95-001)

The Casitas Valley Ranch/Emily Thomson (Discharger) shall implement this monitoring program on the effective date of this Order.

Monitoring reports shall be submitted semi-annually by the dates in the following schedule:

<u>Reporting Period</u>	<u>Report due</u>
January - June	July 31
July - December	January 31

The first semi-annual monitoring report under this program shall be submitted by July 31, 1995.

By January 31st of each year, beginning January 31, 1996, the Discharger shall submit an annual report to the Board. The report shall contain summaries of the monitoring data obtained during the previous year. In addition, the Discharger shall discuss the compliance record and the corrective actions taken or planned which may be needed to bring the discharge into full compliance with the Waste Discharge Requirements.

General Provisions for Reporting

For every item where the requirements are not met, the Discharger shall submit a statement of the actions undertaken, or proposed, which will bring the discharge into full compliance with requirements at the earliest time and submit a timetable for correction.

If no wastes were discharged during the reporting period, the report shall so state.

The semi-annual reports shall contain the following information:

- a. Average and maximum daily waste flow for each month of the quarter.
- b. Estimated population served during each month of the reporting period.

- c. A statement relative to compliance with discharge specifications during the reporting period.
- d. If discharge of waste does not occur during the reporting period, a statement to that effect shall be submitted.
- e. Results of at least weekly observations in the disposal area for any overflow or surfacing of wastes, other visible effects of the waste discharge, and odor effects. Observations shall be made on different days of the week, including at least one Saturday and one Sunday in each month. The day and date (i.e., Sunday, September 10) of the observations shall be reported along with any abnormalities observed.

Monitoring reports shall be signed by:

- a. In the case of a corporation, by a principal Executive Officer at least of the level of vice-president, or his duly authorized representative, if such representative is responsible for the overall operation of the facility from which the discharge originates.
- b. In the case of a partnership, by a general partner;
- c. In the case of a sole partnership, by the proprietor;
- d. In the case of a municipal, State or other public facility, by either a principal Executive Officer, ranking elected official, or other duly authorized employee.

Each report shall contain the following declaration:

"I certify under penalty of law that I have personally examined and am familiar with the information submitted in this document and all attachments and that, based on my inquiry of those individuals immediately responsible for obtaining the information, I believe that the information is true, accurate, and complete. I am aware that there are significant penalties for submitting false information, including the possibility of fine and imprisonment [California Water Code Sections 13263, 13267, and 13268]. Executed on the _____ day of _____ at _____

Signature

Title"

Wastes Hauling Reporting

In the event that wastes are hauled to a legal disposal site, the name and address of the hauler of the wastes shall be reported, along with types and quantities hauled during the reporting period and the location of final point of disposal. If no wastes are hauled during the reporting period, a statement to that effect shall be submitted and shall include a statement relative to disposal of wastes during the reporting period.

Operation and Maintenance Report

The Discharger shall file a technical report with this Board, not later than 30 days after receipt of these Waste Discharge Requirements, relative to the operation and maintenance program for this facility. The information to be contained in the report shall include, as a minimum, the following:

- a. The name and address of the person or company responsible for operation and maintenance of the facility.
- b. Type of maintenance (preventive or corrective).
- c. Frequency of maintenance, if preventive.

These records and reports are public documents and shall be made available for inspection during normal business hours at the office of the California Regional Water Quality Control Board, Los Angeles Region.

Robert P. Ghirelli

ROBERT P. GHIRELLI, D.Env.
Executive Officer

Date: April 3, 1995

/DAB

**CALIFORNIA REGIONAL WATER QUALITY CONTROL BOARD
LOS ANGELES REGION**

CENTRE PLAZA DRIVE
MONTEREY PARK, CA 91754-2156
(213) 266-7500
FAX: (213) 266-7600



April 5, 1995

Ms. Emily Thomson-Beedy
Casitas Valley Ranch
4866 Casitas Pass Road
Ventura, CA 93001

original

**WASTE DISCHARGE REQUIREMENTS FOR CASITAS VALLEY RANCH, VENTURA
CALIFORNIA (File No. 95-001, CI 7514)**

Our letter dated February 21, 1995, transmitted tentative Waste Discharge Requirements for your discharge of domestic and commercial wastewater.

Pursuant to Division 7 of the California Water Code, this Regional Board at a public meeting held on April 3, 1995, reviewed the tentative requirements, considered all factors in the case, and adopted Order No. 95-043 (copy attached) relative to this waste discharge.

<u>Project</u>	<u>File No.</u>	<u>Order No.</u>	<u>Monitoring & Reporting Program No.</u>
Casitas Valley Ranch/ Emily Thomson	95-001	95-043	7514

The "Monitoring and Reporting Program" requires you to implement the monitoring program on the effective date of the Order. Your first monitoring report under this Program is due by July 31, 1995. All monitoring reports should be sent to the Regional Board, ATTN: Technical Support Unit.

Please reference all technical and monitoring reports to our Compliance File No. CI-7514. We would appreciate if you would not combine other reports, such as progress or technical reports, with your monitoring reports but would submit each type of report as a separate document.

Standard Provisions (revised November 7, 1990), which are part of these requirements, are enclosed for the addressee only. However, these are on file in our office, and a copy will be sent to you upon request.

Ms. Emily Thomson-beedy
April 5, 1995
Page 2

If you have any questions, please call me at (213) 266-7586.

David A. Bacharowski

DAVID A. BACHAROWSKI
Environmental Specialist IV
Subsurface Regulation Unit

Enclosures

cc: Archie Matthews, Division of Water Quality, State Water
Resources Control Board
Jorge Leon, Office of Chief Counsel, State Water Resources
Control Board
Department of Water Resources
Michael Kiado, Environmental Management Branch, California
Department of Health Services
Gary Yamamoto, Office of Drinking Water-Public Supply Branch
Department of Health Services
South Coast Air Quality Management District Ventura County
Darrell Siegrist, Ventura County Department of Environmental
Health
Gary Hales, Ventura County Department of Environmental Health
Ventura County Planning Department
Ventura County Regional Sanitation District
Ventura County, Department of Public Works, Flood Control and
Drainage Division
Ventura County, Department of Public Works, Water and
Sanitation Division

State of California
CALIFORNIA REGIONAL WATER QUALITY CONTROL BOARD
LOS ANGELES REGION

ORDER NO. 95-043

WASTE DISCHARGE REQUIREMENTS
FOR
CASITAS VALLEY RANCH/EMILY THOMSON
(Septic Tank/Leachfield System)
(File No. 95-001)

The California Regional Water Quality Control Board, Los Angeles Region, finds:

1. The Casitas Valley Ranch/Emily Thomson (hereinafter Discharger) has filed a Report of Waste Discharge with this Board for the discharge of domestic and commercial wastes associated with cheese making.
2. The Discharger proposes to discharge up to 300 gallons per day of domestic, cheese processing, and washwater wastes to a septic tank/leachfield disposal system at 4866 Casitas Pass Road, Ventura (Figure No. 1). Any sludge will be hauled offsite to a legal disposal site, as necessary.
3. The facility is located in Section 33, Township 4N, Range 24 W, San Bernardino Base and Meridian. (The facility's approximate latitude is 34° 23' 46"N and its longitude is 119° 24' 52"W).
4. Casitas Municipal Water District supplies domestic water for this facility.
5. The septic tank/leachfield disposal system is located in the Pitas Point Hydrologic Unit of the Santa Clara River Basin and overlies the Pitas Point Groundwater area.
6. The beneficial uses of groundwater within the Pitas Point Groundwater area are municipal and domestic supply, industrial service and potentially process supply, and agricultural supply.

Groundwater in the vicinity generally contains water of poor quality, and is not extracted and used for domestic, industrial, or agricultural purposes in any significant quantities.

7. No water wells are located within or near the area of discharge.

February 15, 1995

8. Percolation tests indicate that the site will sustain subsurface disposal.
9. The site is located in an unsewered area of Ventura. To date no public sewers have been scheduled for construction in the vicinity of the project.
10. The Board adopted a revised Water Quality Control Plan for the Santa Clara River Basin on October 22, 1990. The plan contains beneficial uses but does not specify water quality objectives for groundwater in this area. The requirements contained in this Order, as they are met, will be in conformance with the goals and objectives of the Water Quality Control Plan.
11. This project involves a minor alteration to land and, as such, is exempt from the provisions of the California Environmental Quality Act (Public Resources Code, Section 21100 et seq.) in accordance with California Code of Regulations, Title 14, Chapter 3, Section 15304.

The Board has notified the Discharger and interested agencies and persons of its intent to adopt Waste Discharge Requirements for this discharge, and has provided them with an opportunity to submit their written views and recommendations.

The Board, in a public meeting, heard and considered all comments pertaining to the discharge and to the tentative requirements.

IT IS HEREBY ORDERED that Casitas Valley Ranch/Emily Thomson shall comply with the following:

A. EFFLUENT LIMITATIONS

1. Wastes discharged shall be limited to domestic, cheese processing, and washwater wastes only. No water softener regeneration brine or industrial wastewaters shall be discharged at this location.
2. Wastes shall be disposed of underground in accordance with local ordinances controlling the construction and operation of private sewage disposal systems, and in accordance with all rules and regulations of the Ventura County Environmental Health Department.
3. Radioactivity of the wastes discharged shall not exceed the limits specified in the current version of Title 22, California Code of Regulations, Chapter 15, Article 5, Sections 64441 and 64443, or subsequent revisions.

4. The effluent discharged shall not contain heavy metals, arsenic, or cyanide in concentrations exceeding the limits contained in the current California Drinking water Standards.
5. Any wastes that do not meet the foregoing requirements shall be held in impervious containers, transferred elsewhere, and the final discharge shall be at a legal point of disposal.
6. There shall be no discharge of wastes to surface water or watercourses at any time.

B. GENERAL REQUIREMENTS

1. In no case may the septic tank/leachfield disposal systems extend to within 10 feet of the zone of historic or anticipated high groundwater level. The Discharger must submit certification that the septic tank/leachfield disposal systems meet this requirement.
2. No part of the septic tank/leachfield disposal system shall be closer than 150 feet to any water well, or closer than 100 feet to any stream, channel or other watercourse.
3. Adequate facilities shall be provided to divert storm water away from the facility and from areas where any potential pollutants are stored.
4. The septic tank/leachfield disposal system shall be maintained in such a manner so that at no time will wastes be permitted to surface or overflow at any location.
5. The septic tank/leachfield disposal systems shall be protected from damage by storm flows, runoff or surf.
6. Odors of sewage origin shall not be perceivable beyond the limits of the property owned or controlled by the Discharger.
7. Neither the treatment nor the discharge of waste shall create a condition of pollution, contamination, or nuisance, or problems due to breeding of mosquitos, midges, flies, or other pests.
8. Wastes discharged shall at no time contain any substance in concentrations toxic to human, plant, or aquatic life.

9. Wastes discharged shall not impart tastes, odors, color, foaming or other objectionable characteristics to receiving groundwater.
10. Wastes shall not be disposed of in geologically unstable areas or so as to cause earth movement.
11. There shall be no onsite disposal of sludge. Any offsite disposal of sewage or sludge shall be made only to a legal point of disposal. For purposes of this Order, a legal disposal site is one for which requirements have been established by a California Regional Water Quality Control Board, and which is in full compliance therewith. Any sewage or sludge handling shall be in such a manner as to prevent its reaching surface waters or watercourses.

B. PROVISIONS

1. This facility shall be compatible with regional sewerage plans.
2. Within six months after a community wastewater collection (sewer) system becomes available, the Discharger shall connect to the community sewer system and properly close the septic tank/leachfield disposal system.
3. A copy of these Waste Discharge Requirements shall be maintained at the office of the Discharger so as to be made available at all times to operating personnel.
4. The Discharger shall comply with all rules and regulations of the Ventura County Department of Health Services for collection, treatment, construction, operation, and maintenance of the domestic sewage disposal systems.
5. Any discharge of wastewater at any point(s) other than specifically described in this Order is prohibited, and constitutes a violation of the Order.
6. After notice and opportunity for a hearing, this Order may be terminated or modified for cause, including, but not limited to:
 - (a) Violation of any term or condition contained in this Order;
 - (b) Obtaining this Order by misrepresentation, or failure to disclose all relevant facts;

- (c) A change in any condition that requires either a temporary or permanent reduction or elimination of the authorized discharge.
7. The Discharger shall furnish, within a reasonable time, any information the Regional Board may request to determine whether cause exists for modifying, revoking and reissuing, or terminating this Order. The Discharger shall also furnish to the Regional Board, upon request, copies of records required to be kept by this Order.
 8. The Discharger shall take all reasonable steps to minimize or prevent any discharge that has a reasonable likelihood of adversely affecting human health or the environment.
 9. This Order does not alleviate the responsibility of the Discharger to obtain other necessary local, state, and federal permits to construct facilities necessary for compliance with this Order; nor does this Order prevent imposition of additional standards, requirements, or conditions by any other regulatory agency. Expansion of this facility from its current capacity shall be contingent upon issuance of all necessary permits, including a Conditional Use Permit.
 10. Prior to any necessary repair to the septic tank/leachfield disposal system, an engineer's analysis is required as to the completeness and determination of the effectiveness of the proposed repair work.
 11. The Discharger shall file a written report with this Board within 90 days after the average dry-weather wastewater flow for any month equals or exceeds 90 percent of the design capacity of the septic tank and leachfield disposal system. The report shall detail provisions to cope with flows in excess of that figure.
 12. The Discharger shall file with the Regional Board technical reports on self-monitoring work performed according to the detailed specifications contained in the Monitoring and Reporting Program, as directed by the Executive Officer. The results of any monitoring done more frequently than required at the location and/or times specified in the Monitoring and Reporting Program shall be reported to the Regional Board.
 13. For any extension or expansion of the septic tank/leachfield disposal system, the Discharger shall submit a report detailing the extension or expansion for the approval of the Executive Officer. Following construction, as-built drawings shall be submitted to the

Executive Officer for approval prior to disposal of treated domestic wastewater.

14. The Discharger shall notify this Board, within 24 hours by telephone, of any adverse condition resulting from this discharge; written confirmation shall follow within one week.
15. The Discharger shall notify the Board by telephone immediately of any bypassing, overflow, or surfacing of wastes. Written confirmation shall follow within one week and shall include information relative to the location, estimated volume, date and time, duration, cause, and remedial measures taken to effect cleanup and/or to prevent recurrence
16. The Regional Board shall be notified, in writing, one week prior to the date that any discharges commence onsite.
17. The Discharger shall submit complete as-built construction and operation details of the septic tank/leachfield disposal system, to the Board within 30 days after installation of the subsurface disposal system. Any addition and/or modifications made to the system shall be provided to this Regional Board within 90 days of the system upgrade or modification.
18. This Order includes "Standard Provisions Applicable to Waste Discharge Requirements". If there is any conflict between provisions stated herein and the "Standard Provisions Applicable to Waste Discharge Requirements", those provisions stated herein will prevail.

I, Robert P. Ghirelli, Executive Officer, do hereby certify that the foregoing is a full, true, and correct copy of an Order adopted by the California Regional Water Quality Control Board, Los Angeles Region, on April 3, 1995.

ROBERT P. GHIRELLI, D.Env.
Executive Officer

/DAB

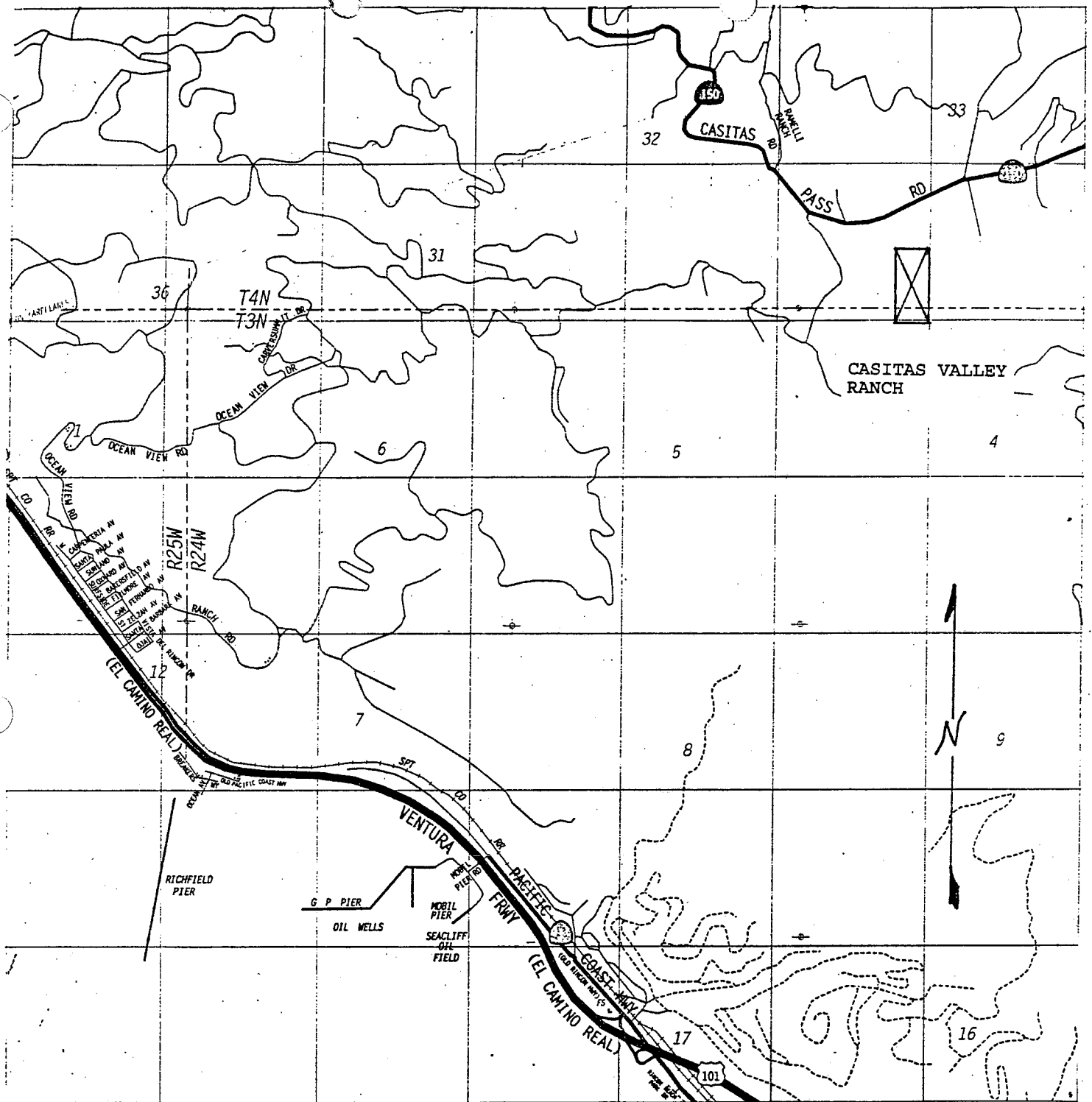

Figure No. 1- Casitas Valley Ranch