

State of California
CALIFORNIA REGIONAL WATER QUALITY CONTROL BOARD
LOS ANGELES REGION
320 West 4th Street, Suite 200, Los Angeles
FACT SHEET
WASTE DISCHARGE REQUIREMENTS
FOR
GOLDEN STATE WATER COMPANY
(San Antonio Filter Plant)
NPDES NO. CAG994003
CI-7986

FACILITY LOCATION

2355 E. Grand Avenue
Ojai, CA 93023

FACILITY MAILING ADDRESS

1140 Los Olivos Avenue
Los Osos, CA 93402

PROJECT DESCRIPTION

Golden State Water Company (GSWC) operates the San Antonio Filter Plant at 2355 E. Grand Avenue, Ojai, California. General NPDES Permit No. CAG994003 (Order No. R4-2004-0058) was issued to GSWC on February 7, 2005 for the discharge of filter backwash water, redevelopment and start-up wastewater to San Antonio Creek from the facility. The filtration plant filters groundwater from numerous wells located in the adjacent well field. GSWC submitted a Notice of Intent (NOI) form, and analytical results of wastewater samples to continue enrollment under the General NPDES Permit No. CAG994003, Order No. R4-2009-0047, which was adopted by the Board on April 2, 2009. The existing enrollment under Order No. R4-2004-0058, is superseded by this new permit.

VOLUME AND DESCRIPTION OF DISCHARGE

Up to 900,000 gallons per day of filter backwash water, well redevelopment and start-up wastewater are discharged from three outfalls to San Antonio Creek: Discharge Point M-001 (Latitude 34°27'10", Longitude 119°13'18"); Discharge Point M-002 (Latitude 34°27'10", Longitude 119°13'22"); Discharge Point M-003 (Latitude 34°27'12", Longitude 119°13'21") which flows to the Ventura River, a water of the United States. The site location map is shown as Figure 1.

APPLICABLE EFFLUENT LIMITATIONS

Based on the information provided in the NPDES Application Supplemental Requirements, the following constituents in the Table below have been determined to show reasonable potential to exist in the discharge. The wastewater discharged from the subject site flows into the Ventura River between Camino Cielo Road and Casitas Vista Road. Therefore, the discharge limitations specified in Attachment B.2.b. are applicable to the discharge.

October 6, 2009

This Table lists the specific constituents and effluent limitations applicable to the discharge.

Constituents	Units	Discharge Limitations	
		Daily Maximum	Monthly Average
Total Suspended Solids	mg/L	150	50
Total Dissolved solids	mg/L	800	---
Turbidity	NTU	150	50
BOD ₅ 20°C	mg/L	30	20
Oil and Grease	mg/L	15	10
Settleable Solids	ml/L	0.3	0.1
Residual Chlorine	mg/L	0.1	---
Sulfate	mg/L	300	---
Chloride	mg/L	60	---
Boron	mg/L	1.0	---
Nitrogen*	mg/L	5.0	---
Iron	µg/L	300	---
Manganese	µg/L	50	---
Methylene Blue Active Substances (MBAS)	mg/L	0.5	---

* Nitrate-nitrogen plus nitrite-nitrogen

FREQUENCY OF DISCHARGE

The discharge of wastewater at this facility is intermittent.

REUSE OF WATER

It is not economically feasible to haul all the wastewater for off-site disposal. It is not feasible to discharge the water to the sanitary sewer system. There are no other feasible reuse options for the discharge. Therefore, the wastewater is discharged to the creek in compliance with the requirements of the attached order.

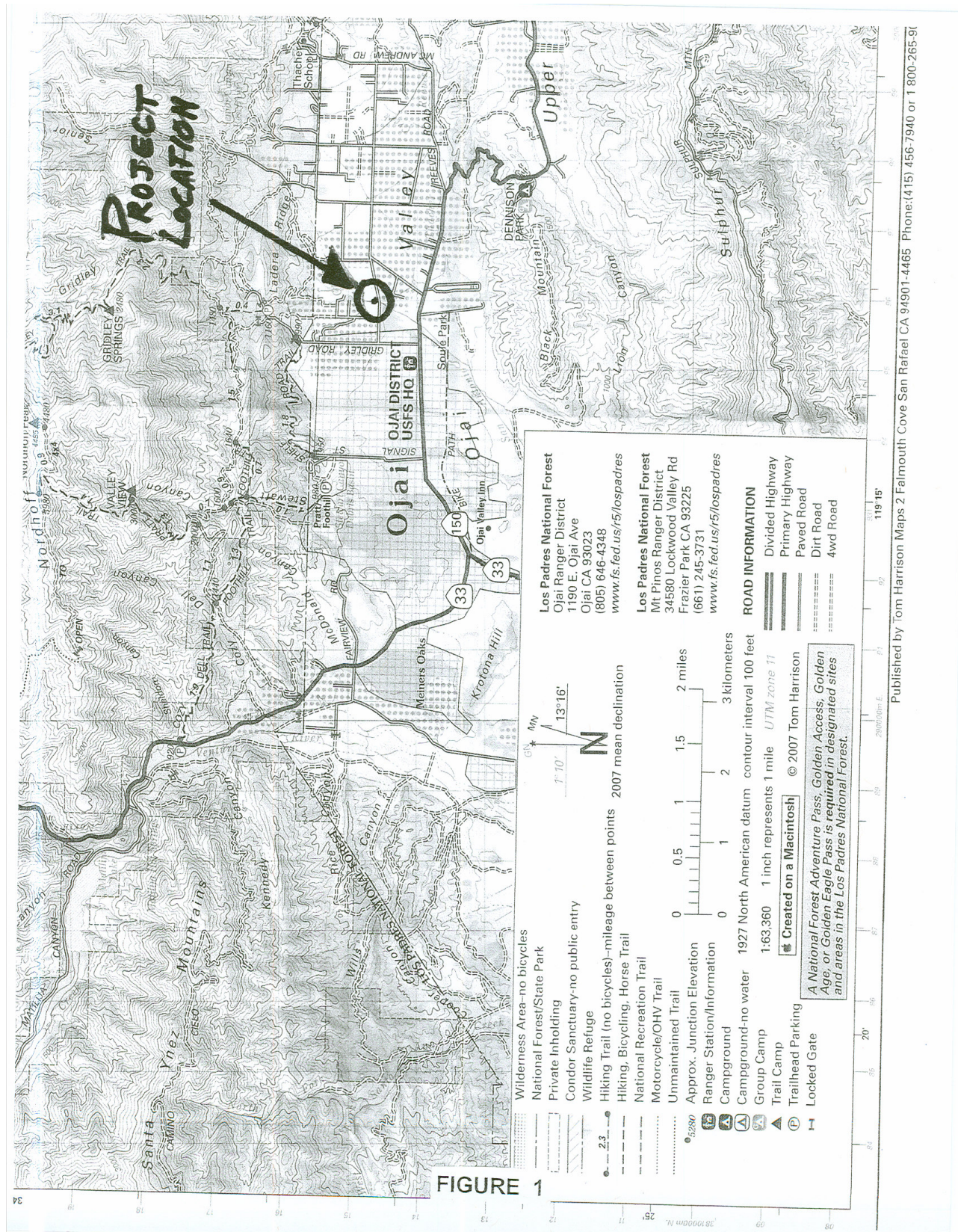

Published by Tom Harrison Maps 2 Falmouth Cove San Rafael CA 94901-4465 Phone:(415) 456-7940 or 1 800-265-91