

12 November 2024

Frank Bosch  
Calaveras Timber Trails Association  
P.O. Box 362  
Avery, CA 95224

**CERTIFIED MAIL**  
**9589-0710-5270-0591-2554-42**

**NOTICE OF APPLICABILITY  
GENERAL WASTE DISCHARGE REQUIREMENTS FOR  
SMALL DOMESTIC WASTEWATER TREATMENT SYSTEMS  
ORDER WQ 2014-0153-DWQ  
FOR  
CALAVERAS TIMBER TRAILS ASSOCIATION  
CALAVERAS COUNTY**

On 8 May 2021, the Calaveras Timber Trails Association (hereafter Discharger) submitted a Report of Waste Discharge (RWD) describing the onsite wastewater treatment facility (Facility) in Calaveras County. The discharge has been regulated by Waste Discharge Requirements (WDRs) Order 98-006, which was adopted on 23 January 1998. Based on information provided in the RWD, the wastewater treatment system and discharge are consistent with the requirements of the State Water Resources Control Board (State Water Board) *General Waste Discharge Requirements for Small Domestic Wastewater Treatment Systems, Order WQ 2014- 0153-DWQ* (General Order). This Notice of Applicability (NOA) serves as formal notice that upon rescission of Order 98-006 at an upcoming Central Valley Water Board meeting, the discharge shall be regulated pursuant to the General Order and this NOA. You are hereby assigned Order WQ 2014-0153-DWQ-R5384 for the discharge. A copy of the [General Order](#) is enclosed and also available at:

[https://www.waterboards.ca.gov/centralvalley/board\\_decisions/adopted\\_orders/general\\_order/s/wq-2014-0153-dwq.pdf](https://www.waterboards.ca.gov/centralvalley/board_decisions/adopted_orders/general_order/s/wq-2014-0153-dwq.pdf)

You should familiarize yourself with the entire General Order and its attachments, which describe mandatory discharge and monitoring requirements. The General Order contains operational and reporting requirements by wastewater system type. Sampling, monitoring, and reporting requirements applicable to your treatment and disposal methods must be completed in accordance with the appropriate treatment system sections of the General Order and the attached Monitoring and Reporting Program (MRP) WQ 2014-0153-DWQ-R5384. The Discharger is responsible for all the applicable requirements that exist in the General Order and this NOA.

**EXISTING FACILITY AND DISCHARGE DESCRIPTION**

Calaveras Timber Trails Association, a private camping community, owns and operates the Facility at 1071 Avery Sheep Ranch Road, Avery, Calaveras County, as shown on attachment A, which is incorporated herein. The Assessor's Parcel Numbers (APNs) for this facility are 034-001-038, 039 in Section 13, T4N, R14E, MDB&M. The campground has 500 individual campsites occupying 134 acres. The campground is utilized as a vacation facility

by its members. The onsite domestic wastewater is generated from 17 toilet/shower facilities, a recreational vehicle (RV) septic pump station, cooking and dining facilities, a recreation center with kitchen and restroom facilities, and two permanent mobile homes.

The Facility consists of a headworks (comminutor and bar rack), an activated sludge package plant (with an aeration, clarification, aerobic digestion and chlorination system), a storage pond, a 3.42-acre land application area (LAA), and a 0.68-acre leachfield. The package treatment plant has a total capacity of 28,900 gallons. The storage pond has a capacity of 162,000 gallons based on two feet of freeboard. Secondary disinfected effluent is stored in the storage pond prior to being applied to the LAA via sprinklers or leachfield. The site plan and flow schematic are shown on Attachments B, and C, respectively, which are incorporated herein.

### SITE-SPECIFIC REQUIREMENTS

The Discharger shall comply with all applicable sections in the General Order, including:

1. Requirements A. Prohibitions

2. Requirements B.1.a.

The Discharger shall comply with the following flow limit: The total effluent flow entering the storage pond shall not exceed **19,000 gallons per day (gpd)** as an average dry weather flow defined as the total flow for the months of July through September divided by 92 days.

3. Requirements B.1.b. through B.1.I

For Section B.1.I, the Discharger shall comply with the following setback requirements listed in in Table 3 of the General Order:

Equipment or Activity	Domestic Well	Flowing Stream	Ephemeral Stream Drainage	Property Line	Lake or Reservoir
Septic Tank, Aerobic Treatment Unit, Treatment System, or Collection System	150 ft.	50 ft.	50 ft.	5 ft.	200 ft.
Impoundment	150 ft.	150 ft.	150 ft.	50 ft.	200 ft.
LAA	100 ft.	50 ft.	50 ft.	50 ft.	200 ft.
Leach Field	100 ft.	100 ft.	50 ft.	5 ft.	200 ft.

4. Requirements B.4 Activated Sludge System

5. Requirements B.5 Pond Systems

6. Requirements B.6.Subsurface Disposal Systems
7. Requirements B.7.Land Application Systems
8. Requirements B.8 Sludge/Solids/Biosolids Disposal
9. Requirements C. Groundwater and Surface Water Limitations
- 10.Provision E.2 and E.3

On 27 September 2019, Senate Bill 317 was signed by the Governor adding Section 25210.2 to the California Health and Safety Code, which contains chemical sale, use, and discharge prohibitions for RV chemical wastes to land, as of 1 January 2022. The Discharger shall post, in a conspicuous location, a notice stating the following:

"The State of California prohibits the use of products in RV holding tanks, including deodorizers, that contain bronopol, dowicil, formalin, formaldehyde, glutaraldehyde, paraformaldehyde, para-dichlorobenzene, benzene, toluene, xylene, ethylene glycol, 1, 1, 1-trichloroethane, trichloroethylene, or perchloroethylene. These chemicals can inhibit biological activity in onsite wastewater treatment systems and threaten groundwater and drinking water wells, and are strictly forbidden. Please use bacteria- or enzyme-based products."

The Discharger shall certify compliance with the above notification posting in the first annual report.

### **SALT AND NITRATE CONTROL PROGRAMS**

The Central Valley Water Board adopted Basin Plan amendments incorporating new programs for addressing ongoing salt and nitrate accumulation in the Central Valley at its 31 May 2018 Board Meeting. The Basin Plan amendments were conditionally approved by the State Water Resources Control Board on 16 October 2019 (Resolution 2019-0057) and by the Office of Administrative Law on 15 January 2020 (OAL Matter No. 2019-1203-03).

- a. For salinity, dischargers that are unable to comply with stringent salinity requirements will instead need to meet performance-based requirements and participate in a basin-wide effort to develop a long-term salinity strategy for the Central Valley. The Discharger, with CV-SALTS ID 1863, has opted to participate in the Prioritization and Optimization (P&O) Study.
- b. For the Nitrate Control Program, the Facility falls outside of any prioritized Groundwater Basin, so no action is required at this time.

As these strategies are implemented, the Central Valley Water Board may find it necessary to modify the requirements of this NOA to ensure the goals of the Salt and Nitrate Control

Programs are met. More information regarding this regulatory planning process can be found on the Central Valley Water Board CV-SALTS website ([https://www.waterboards.ca.gov/centralvalley/water\\_issues/salinity](https://www.waterboards.ca.gov/centralvalley/water_issues/salinity)).

### **MONITORING AND REPORTING PROGRAM**

WDRs Order 98-006 will be rescinded at an upcoming Central Valley Water Board meeting. Effective upon the first day of the month following rescission of WDRs Order 98-006, the Discharger shall comply with MRP WQ 2014-0153-DWQ-R5384, which is incorporated herein.

### **ENFORCEMENT**

Please review this NOA carefully to ensure that it completely and accurately reflects the discharge. Discharge of wastes other than those described in this NOA is prohibited. Prior to allowing changes to the wastewater strength, generation rate, or to the method of waste disposal, you must contact the Central Valley Water Board to determine if submittal of a Report Waste Discharge is required.

The Discharger generates the waste subject to the terms and conditions of Water Quality Order WQ 2014-0153-DWQ-R5384 and maintains exclusive control over the discharge. As such, the Discharger is primarily responsible for compliance with this NOA, MRP, and General Order, with all attachments. Failure to comply with the requirements in the General Order or this NOA could result in an enforcement action as authorized by provisions of the California Water Code.

### **DOCUMENT SUBMITTAL**

All monitoring reports and other correspondence should be converted to searchable Portable Document Format (PDF) and submitted electronically. Documents that are less than 50 MB should be emailed to:

centralvalleysacramento@waterboards.ca.gov.

To ensure that your submittal is routed to the appropriate staff person, the following information should be included in the body of the email or any documentation submitted to the mailing address for this office:

Facility Name: Calaveras Timber Trails Association  
Program: Non-15 Compliance  
Order: WQ 2014-0153-DWQ-R5384  
CIWQS Place ID: CW- 213002

Documents that are 50 MB or larger should be transferred to a CD, DVD, or flash drive and mailed to:

WQ 2014-0153-DWQ-R5384  
CALAVERAS TIMBER TRAILS ASSOCIATION  
CALAVERAS COUNTY

5

Central Valley Regional Water Quality Control Board  
ECM Mailroom  
11020 Sun Center Drive, Suite 200  
Rancho Cordova, CA 95670

Now that the NOA has been issued, the Board's Compliance and Enforcement section will take over management of your case. Kenny Croyle is your new point of contact for any questions about the General Order. If you find it necessary to make a change to your permitted operations, Kenny will direct you to the appropriate Permitting staff. You may contact Kenny at (916) 464-4676 or at [kcroyle@waterboards.ca.gov](mailto:kcroyle@waterboards.ca.gov).

Original Digitally Signed by John J. Baum  
on Date: 2024.11.12 13:31:56-08'00'

---

for Patrick Pulupa  
Executive Officer

Enclosure: Water Quality Order WQ 2014-0153-DWQ  
Monitoring and Reporting Program WQ 2014-0153-DWQ-R5384  
Attachment A, Location Map  
Attachment B, Site Plan  
Attachment C, Site Plan B  
Staff Review Memorandum

cc w/out enc: Calaveras County Environmental Health Department, San Andreas  
Howard Hold, Central Valley Water Board, Rancho Cordova (via email)

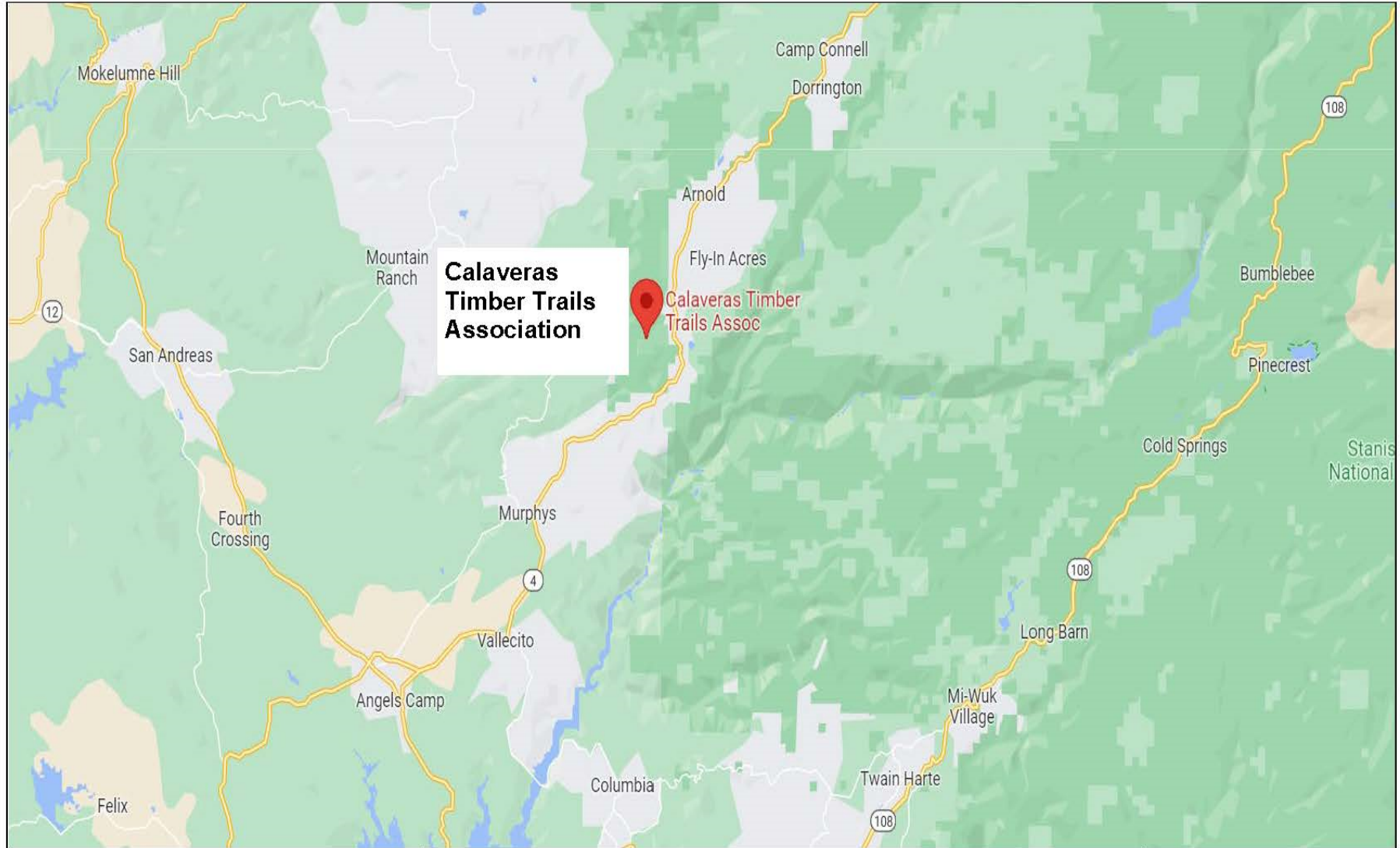

<p>Drawing Reference: Google Map</p>	<p><b>LOCATION MAP</b> <b>CALAVERAS TIMBER TRAILS ASSOCIATION</b> <b>CALAVERAS COUNTY</b></p>	<p><b>NO SCALE</b></p>
--	---	------------------------

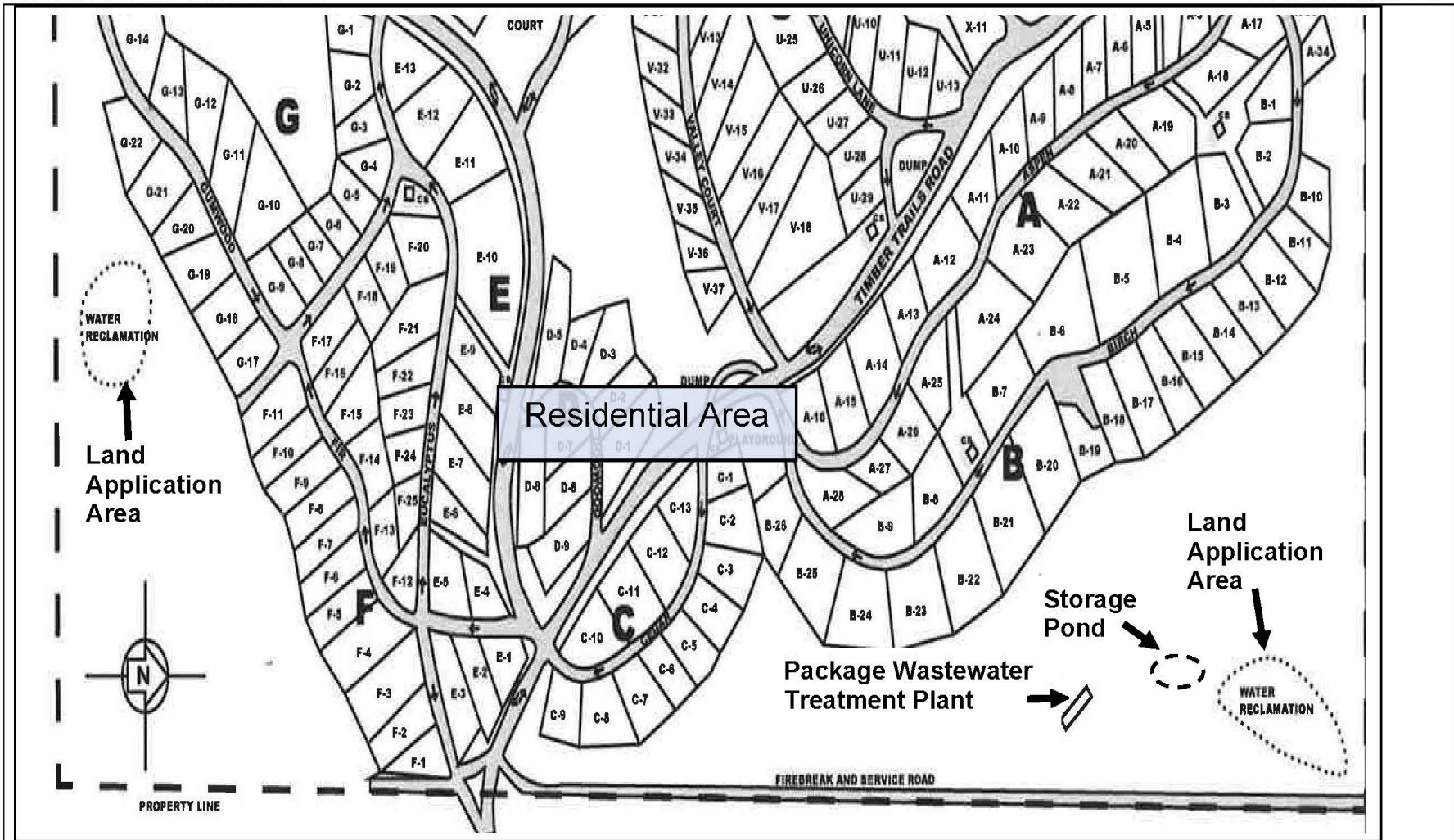

Drawing Reference:  
Calaveras Timber Trails Association,  
Report of Waste Discharge,  
May 2021

**SITE PLAN**  
CALAVERAS TIMBER TRAILS ASSOCIATION  
CALAVERAS COUNTY

NO SCALE

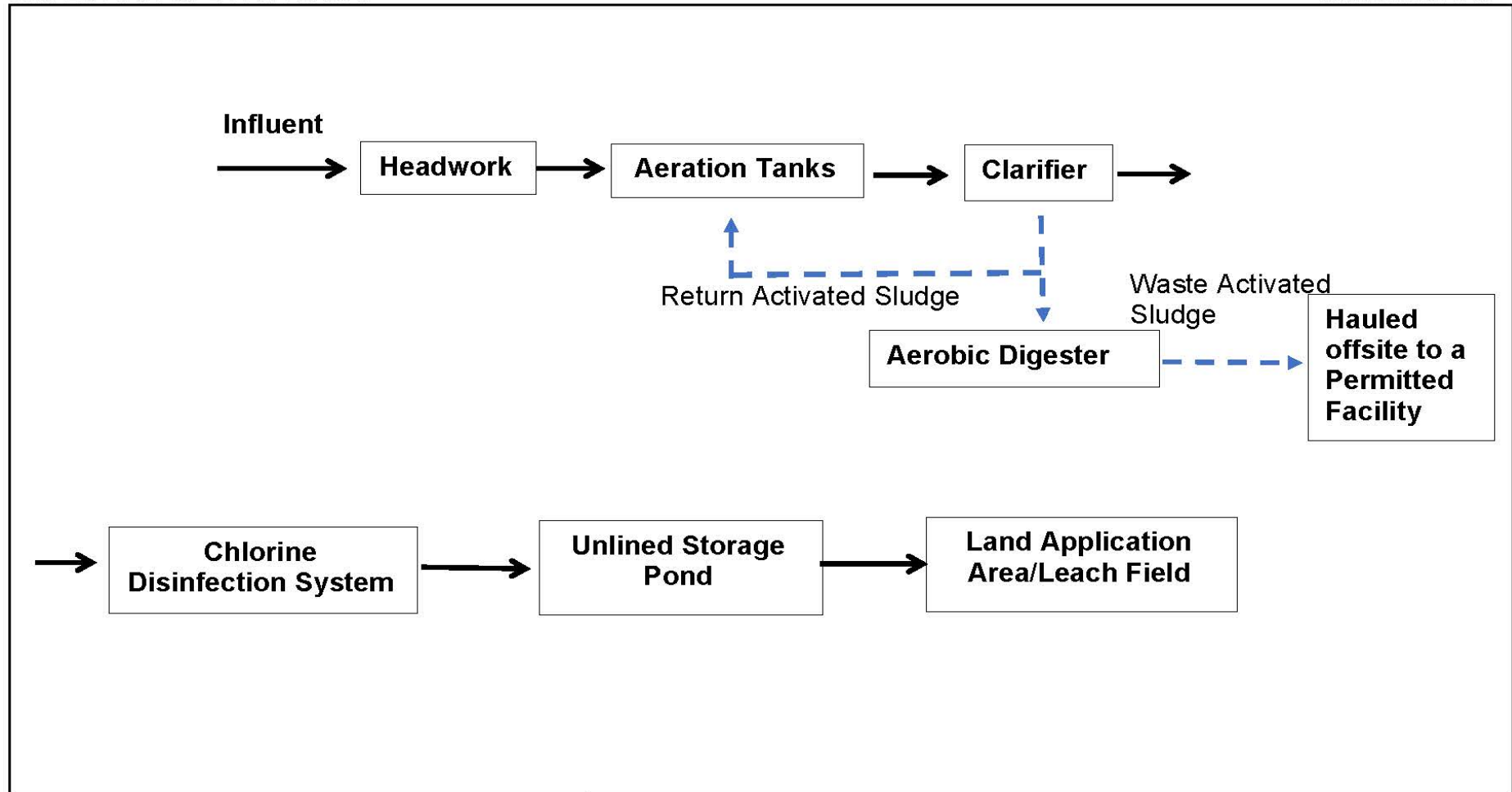

Reference:  
Calaveras Timber Trails Association, Report of Waste Discharge, May 2021

**PROCESS SCHEMATIC**  
CALAVERAS TIMBER TRAILS ASSOCIATION  
CALAVERAS COUNTY



**FROM:** Scott Armstrong  
Senior Engineering Geologist

**DATE:** 19 July 2024

***APPLICABILITY OF COVERAGE UNDER STATE WATER RESOURCES CONTROL BOARD ORDER WQ 2014-0153-DWQ; GENERAL WASTE DISCHARGE REQUIREMENTS FOR SMALL DOMESTIC WASTEWATER TREATMENT SYSTEMS; CALAVERAS TIMBER TRAILS ASSOCIATION; CALAVERAS COUNTY***

On 8 May 2021, the Calaveras Timber Trails Association (hereafter Discharger) submitted a Report of Waste Discharge for the wastewater treatment facilities at the Calaveras Timber Trails Association community to obtain coverage under the State Water Resources Control Board (State Water Board) General Waste Discharge Requirements for Small Domestic Wastewater Treatment Systems, Order WQ 2014-0153-DWQ (General Order). This memorandum provides a summary of the applicability of this discharge for coverage under the General Order.

**REGULATORY BACKGROUND**

Waste Discharge Requirements (WDRs) 98-006, adopted by the Central Valley Regional Water Quality Control Board (Central Valley Water Board) on 23 January 1998, prescribes requirements for wastewater treatment and disposal at Calaveras Timber Trails Association community. WDRs Order 98-006 will be rescinded at an upcoming Central Valley Water Board meeting. Effective upon rescission of Order 98-006, the discharge described in this NOA shall be regulated pursuant to the General Order.

WDRs Order 98-006 has a flow limit of 23,750 gallons per day as a monthly average dry weather discharge flow. The RWD requests to reduce the discharge flow limit less than 20,000 gpd as an ADWF. This Order contains an effluent ADWF limit of 19,000 gpd.

**EXISTING FACILITY AND DISCHARGE DESCRIPTION**

The drinking water supply is provided by the Calaveras County Water District. Based on the Calaveras County Water District's 2023 Annual Water Quality Report, the drinking water has a TDS concentration of 24 mg/L (electrical conductivity 60.2  $\mu$ mhos/cm).

The Facility consists of a headworks, an activated sludge package plant (with an aeration, clarification, aerobic digestion and chlorination system), a 162,000-gallon storage pond, a 3.42-acre land application area (LAA), and a 0.68-acre leachfield.

Wastewater enters the first of two aeration tanks filled with activated sludge before passing into the clarifier. At the clarifier, return activated sludge is pumped back to the aeration tank and waste activated sludge is sequestered in the aerobic digester. The clarified effluent passes over a weir and is dosed with a chlorine solution before entering the chlorine contact tank. The chlorinated secondary effluent flows by gravity into a wet well/ storage pond prior to application to either the LAA or leach field. The LAA has a tailwater collection system that returns irrigation runoff back into the storage pond.

Solid waste removed from bar screens is hauled offsite to a permitted landfill. Solids and grit are removed from the pump station wet well semi-annually and pumped into the aerobic digester of the treatment plant. Waste activated sludge in the aerobic digester is pumped out by a local septage hauler on an as-needed basis to a permitted facility.

Based on Discharger's effluent Semi-annual Monitoring Reports for May and November 2023, the effluent quality is summarized below:

Dates	Monthly Average Flow Rate (gpd)	BOD (mg/L)	Total Suspended Solids (mg/L)	Specific Conductance (µs/cm)
May 2023	5,400	27	14	270
November 2023	2,100	8.4	16	380

Based on the above table, the monthly averages in May and November in 2023 are 5,400 and 2,100 gpd, respectively, which are much less than the flow limit of 19,000 gpd in this Order.

#### SALT AND NITRATE CONTROL PROGRAMS

The Central Valley Water Board adopted Basin Plan amendments incorporating new programs for addressing ongoing salt and nitrate accumulation in the Central Valley at its 31 May 2018 Board Meeting. The Basin Plan amendments were conditionally approved by the State Water Board on 16 October 2019 (Resolution 2019-0057) and by the Office of Administrative Law on 15 January 2020 (OAL Matter No. 2019-1203-03).

For nitrate, dischargers that are unable to comply with stringent nitrate requirements will be required to take on alternate compliance approaches that involve providing replacement drinking water to persons whose drinking water is affected by nitrates. Dischargers may comply with the new nitrate program either individually or collectively with other dischargers. For the Nitrate Control Program, the facility falls within Non-Prioritized Groundwater Basins. Notices to Comply for Non-Prioritized Basins will be issued within two to four years after the effective date of the Nitrate Control Program.

For salinity, dischargers that are unable to comply with stringent salinity requirements will instead need to meet performance-based requirements and participate in a basin-wide effort to develop a long-term salinity strategy for the Central Valley. The Discharger, with CV-SALTS ID 1863, has opted to participate in the Prioritization and Optimization (P&O) Study.

As these strategies are implemented, the Central Valley Water Board may find it necessary to modify the requirements of this Order to ensure the goals of the Salt and Nitrate Control Programs are met. This order may be amended or modified to incorporate newly applicable requirements. More information regarding this regulatory planning process can be found on the [Central Valley Water Board CV-SALTS website](https://www.waterboards.ca.gov/centralvalley/water_issues/salinity) ([https://www.waterboards.ca.gov/centralvalley/water\\_issues/salinity](https://www.waterboards.ca.gov/centralvalley/water_issues/salinity)).